

11/20/02 10AM

PUB. SEWER STATUS VERIFIED BY

NA

ISSUE DATE: 11/8/02

# PERMIT

P 517992-A

APPROVAL DATE: 11/20/02

A REPAIR A03198

**ON-SITE SEWAGE DISPOSAL SYSTEM  
HOWARD COUNTY HEALTH DEPARTMENT  
BUREAU OF ENVIRONMENTAL HEALTH**

03-297446

Fogles Septic Clean, Inc

IS PERMITTED TO

INSTALL

☐

ALTER ☒

ADDRESS: 580 Obrecht Road, Sykesville

PHONE NUMBER: 410-795-5670

SUBDIVISION: River Park Estates

LOT NUMBER: 5

ADDRESS: 1121 River Road

PROPERTY OWNER: Craig Vaselaros

SEPTIC TANK CAPACITY (GALLONS):

existing 1000 g?

PUMP CHAMBER CAPACITY (GALLONS):

NA

NUMBER OF BEDROOMS:

3

SQUARE FEET PER BEDROOM:

$180 \times 3 = 540 \div 2 = 270 \times .24 = 64.8'$

LINEAR FEET OF TRENCH REQUIRED:

65±

TRENCHES:	Trench to be 2 feet wide. Inlet 3 feet below original grade. Bottom maximum depth 10 feet below original grade. Effective area begins at 3-4 feet below original grade. 7 feet of stone below distribution pipe.
LOCATION:	
PURPOSE:	Existing septic system has failed. Call for inspection when ground is opened so sanitarian can recommend repair.

PLANS APPROVED:

Steven R. Krieg

DATE:

11/20/02

NOTE: PERMIT VOID AFTER 2 YEARS

NOTE: CONTRACTOR RESPONSIBLE FOR SCHEDULING A PRE-CONSTRUCTION INSPECTION FOR ALL INSTALLATIONS

NOTE: WATERTIGHT SEPTIC TANKS REQUIRED

NOTE: ALL PARTS OF SEPTIC SYSTEM SHALL BE 100 FEET FROM ANY WATER WELL

NOTE: MANHOLE RISERS REQUIRED ON ALL SEPTIC TANKS AND PUMP CHAMBERS

**NEITHER THE HOWARD COUNTY COUNCIL NOR THE HEALTH DEPARTMENT IS  
RESPONSIBLE FOR THE SUCCESSFUL OPERATION OF ANY SYSTEM  
PERMITTEE RESPONSIBLE FOR OBTAINING FINAL APPROVAL ON THIS PERMIT  
CALL 410-313-2640 FOR INSPECTION OF SEPTIC SYSTEM**

P517992-A

NOT TO SCALE

INDEXED

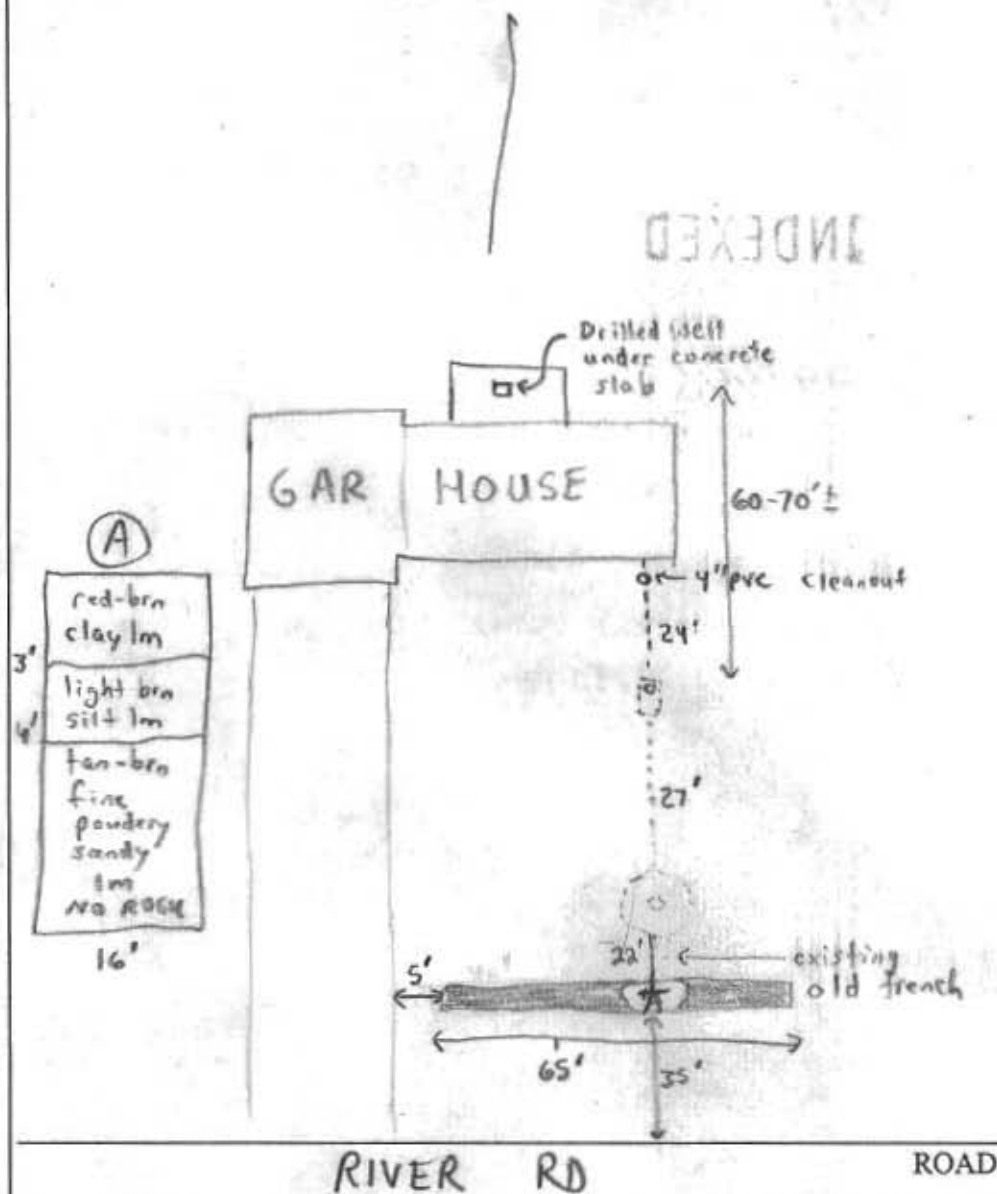

TRENCH/DRAINFIELD DATA		
WIDTH	INLET	BOTTOM
2	3-4	10'
NUMBER OF TRENCHES		
7		
TOTAL LENGTH		
65'		
ABSORPTION AREA		
4554 sq ft		
DISTRIBUTION BOX LEVEL		
NA		
DISTRIBUTION BOX BAFFLE		
NA		
DISTRIBUTION BOX PORT		
NA		

SEPTIC TANK DATA	
SEPTIC TANK 1 LEVEL	existing
CAPACITY	1000? GAL
SEAM LOC	Midseam?
TANK LID DEPTH	?
BAFFLES	OK
BAFFLE FILTER	NA
MANHOLE LOC	NA
6" PORT LOC	lid on front
WATERTIGHT TEST	NA
SEPTIC TANK 2 LEVEL	NA
CAPACITY	GAL
SEAM LOC	
TANK LID DEPTH	
BAFFLES	
BAFFLE FILTER	
MANHOLE LOC	
6" PORT LOC	
WATERTIGHT TEST	

PRE-CONSTRUCTION 11/20/02 - MET CONTRACTOR (KENNY MAYNE) DUG PERC HOLE IN LOCATION (A) INSTALL AS DISCUSSED. A DRILLED WELL WAS OBSERVED INSTALLATION - >100' SLIGHTLY DOWNSLOPE OF PROPOSED SEPTIC BUT NOT IN DIRECT DRAINAGE PATH OK - (FA/SRK)

INSTALLATION - 11/20/02 - OK TO COVER ALL WORK - (SRK)

FINAL INSPECTOR Steron R. King DATE OF APPROVAL 11/20/02

2/9  
Fee Paid \$  
Receipt #P

SEPTIC SYSTEM REPAIR / UPGRADE / EVALUATION REQUEST

Please fill out this form completely and check off the reason for the request:

Date requested: 10/22/09

Reason for Request

Failing System (includes surface discharge or inadequate treatment zone) \_\_\_\_\_

Has the contractor verified through excavation/pumping evaluation, that there are no pipe blockages?

In support of a building permit. Type of building addition: \_\_\_\_\_

\*System relocation for proposed addition for setback compliance \_\_\_\_\_

\*Verification of adequate system capacity per COMAR 26.04.02.02D (4) \_\_\_\_\_

To replace collapsed septic tank or upgrade tank capacity ☒

To replace collapsed drywell

\*\*\*\*\*  
Septic Contractor:

Contractor's Address:

Contractor's Phone #:

Property Address:

Property (Subdivision) & Lot #

Owner's Name:

Is public sewer available/nearby:

Names of Any Previous Owners:

Year House Built:

# of Existing Bedrooms:

# of Bedrooms after completion of addition: \_\_\_\_\_

Has this request been discussed previously with a Sanitarian, who? \_\_\_\_\_

*If public sewer is close, further research will be performed to verify availability and possible hook up to public sewer.*

A Sanitarian will be in contact within three business days depending upon the urgency of the situation to coordinate the scheduling of the repair /upgrade/evaluation. No inspection will be performed without fee collection at the office.

Environmental Sanitarian tentatively assigned \_\_\_\_\_

FAX TO 410-313-2648

## FILE INQUIRY NOTES

[illegible]

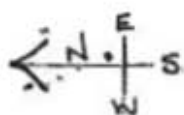

Scale: 1" = 50'

Neighbor  
1127  
River Rd

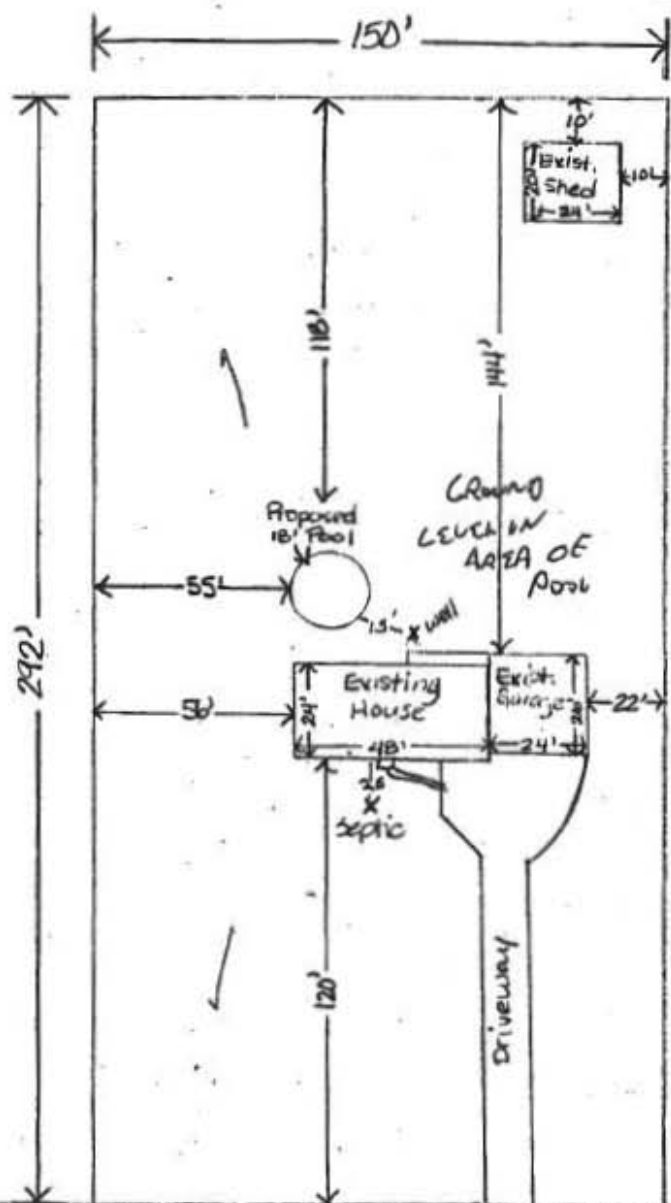

- Dimension of Property: 150' x 292'
- Distance from front of pool to front property line = 152'
- Distance from center of front street to pool = 162'
- Distance from well to pool = 18'
- Distance from house to well = 15'
- Distance from corner of lot to nearest state road = 1056'

3RD Election District

Property zoned residential

No access to public water or sewer

6/9/97

BRI SEPTIC CLEANOUT IS UNDER YARD ORNAMENT IN FRONT OF HOUSE

WELL IS CAPPED - owner says no pit, 1' from house, 7' from porch

PROPOSED POOL IS NO CLOSER TO WELL THAN

EXISTING HOUSE SEPTIC

OK TO APPROVE

JH

River Rd.

1127 River Rd.  
Lot 4  
River Park Estates  
Lot 4, Parcel 97, Sect I

State Road 32