

C1 48274	SEQUENCE NO. (MDE USE ONLY)	STATE OF MARYLAND WELL COMPLETION REPORT FILL IN THIS FORM COMPLETELY PLEASE TYPE	THIS REPORT MUST BE SUBMITTED WITHIN 45 DAYS AFTER WELL IS COMPLETED.
1 2 3 4 5 6 (THIS NUMBER IS TO BE PUNCHED IN COLS. 3-6 ON ALL CARDS)	DATE RECEIVED MM <u>04</u> DD <u>10</u>		COUNTY NUMBER <u>13</u>
ST/CO USE ONLY DATE RECEIVED MM <u>04</u> DD <u>10</u>	DATE WELL COMPLETED MM <u>03</u> DD <u>26</u>		PERMIT NO. FROM "PERMIT TO DRILL WELL" <u>H0-17-0267</u>
OWNER <u>Ricourt Ernesto</u>		Depth of Well <u>500</u> (TO NEAREST FOOT)	OK <u>4/10/18 SC</u>
WELL SITE ADDRESS <u>5253 Talbots Landing</u>		TOWN <u>Ellicott City, MD 21043</u>	LOT <u>10P</u>
SUBDIVISION _____		SECTION _____	LOT <u>10P</u>

WELL LOG Not required for driven wells STATE THE KIND OF FORMATIONS PENETRATED, THEIR COLOR, DEPTH, THICKNESS AND IF WATER BEARING	GROUTING RECORD WELL HAS BEEN GROUTED (Circle Appropriate Box) TYPE OF GROUTING MATERIAL (Circle one) CEMENT <u>CM</u> BENTONITE CLAY <u>BC</u> NO. OF BAGS <u>33</u> NO. OF POUNDS <u>1,650</u> GALLONS OF WATER <u>627</u> DEPTH OF GROUT SEAL (to nearest foot) from <u>0</u> ft. to <u>500</u> ft. (enter 0 if from surface)	C3 PUMPING TEST HOURS PUMPED (nearest hour) <u>N/A</u> PUMPING RATE (gal. per min.) <u>N/A</u> METHOD USED TO MEASURE PUMPING RATE <u>N/A</u> WATER LEVEL (distance from land surface) BEFORE PUMPING <u>40</u> ft. WHEN PUMPING <u>N/A</u> ft. TYPE OF PUMP USED (for test) <input checked="" type="checkbox"/> air <input type="checkbox"/> piston <input type="checkbox"/> turbine <input type="checkbox"/> centrifugal <input type="checkbox"/> rotary <input type="checkbox"/> other (describe below) <input type="checkbox"/> jet <input type="checkbox"/> submersible																																																																																																				
<table border="1" style="width:100%; border-collapse: collapse;"> <thead> <tr> <th rowspan="2">DESCRIPTION (Use additional sheets if needed)</th> <th colspan="2">FEET</th> <th rowspan="2">check if water bearing</th> </tr> <tr> <th>FROM</th> <th>TO</th> </tr> </thead> <tbody> <tr> <td>Top soil</td> <td>0</td> <td>1</td> <td></td> </tr> <tr> <td>Silt, Brown trace of sand trace of mica</td> <td>1</td> <td>12</td> <td></td> </tr> <tr> <td>Weathered Rock Gray</td> <td>12</td> <td>40</td> <td></td> </tr> <tr> <td>Rock Gray hard</td> <td>40</td> <td>500</td> <td>✓</td> </tr> </tbody> </table>	DESCRIPTION (Use additional sheets if needed)	FEET		check if water bearing	FROM	TO	Top soil	0	1		Silt, Brown trace of sand trace of mica	1	12		Weathered Rock Gray	12	40		Rock Gray hard	40	500	✓	CASING RECORD casing types insert appropriate code below <table border="1" style="width:100%; border-collapse: collapse;"> <tr> <td><u>ST</u> STEEL</td> <td><u>CO</u> CONCRETE</td> </tr> <tr> <td><u>PL</u> PLASTIC</td> <td><u>OT</u> OTHER</td> </tr> </table> MAIN CASING TYPE Nominal diameter top (main) casing (nearest inch) Total depth of main casing (nearest foot) 60 61 62 63 64 65 66 67 68 69 70	<u>ST</u> STEEL	<u>CO</u> CONCRETE	<u>PL</u> PLASTIC	<u>OT</u> OTHER	OTHER CASING (if used) diameter depth (feet) inch from to EACH CASING																																																																										
DESCRIPTION (Use additional sheets if needed)		FEET			check if water bearing																																																																																																	
	FROM	TO																																																																																																				
Top soil	0	1																																																																																																				
Silt, Brown trace of sand trace of mica	1	12																																																																																																				
Weathered Rock Gray	12	40																																																																																																				
Rock Gray hard	40	500	✓																																																																																																			
<u>ST</u> STEEL	<u>CO</u> CONCRETE																																																																																																					
<u>PL</u> PLASTIC	<u>OT</u> OTHER																																																																																																					
NUMBER OF UNSUCCESSFUL WELLS: <u>0</u>	SCREEN RECORD screen type or open hole Insert appropriate code below <table border="1" style="width:100%; border-collapse: collapse;"> <tr> <td><u>ST</u> STEEL</td> <td><u>BR</u> BRASS</td> <td><u>HO</u> OPEN HOLE</td> </tr> <tr> <td><u>PL</u> PLASTIC</td> <td><u>OT</u> OTHER</td> <td></td> </tr> </table>		<u>ST</u> STEEL	<u>BR</u> BRASS	<u>HO</u> OPEN HOLE	<u>PL</u> PLASTIC	<u>OT</u> OTHER																																																																																															
<u>ST</u> STEEL	<u>BR</u> BRASS	<u>HO</u> OPEN HOLE																																																																																																				
<u>PL</u> PLASTIC	<u>OT</u> OTHER																																																																																																					
WELL HYDROFRACTURED <input checked="" type="checkbox"/> YES <input type="checkbox"/> NO	DEPTH (nearest ft.) <table border="1" style="width:100%; border-collapse: collapse;"> <tr> <td>1</td><td>2</td><td>3</td><td>4</td><td>5</td><td>6</td><td>7</td><td>8</td><td>9</td><td>10</td><td>11</td><td>12</td><td>13</td><td>14</td><td>15</td><td>16</td><td>17</td><td>18</td><td>19</td><td>20</td><td>21</td><td>22</td><td>23</td><td>24</td><td>25</td><td>26</td><td>27</td><td>28</td><td>29</td><td>30</td><td>31</td><td>32</td><td>33</td><td>34</td><td>35</td><td>36</td><td>37</td><td>38</td><td>39</td><td>40</td><td>41</td><td>42</td><td>43</td><td>44</td><td>45</td><td>46</td><td>47</td><td>48</td><td>49</td><td>50</td><td>51</td><td>52</td><td>53</td><td>54</td><td>55</td><td>56</td><td>57</td><td>58</td><td>59</td><td>60</td><td>61</td><td>62</td><td>63</td><td>64</td><td>65</td><td>66</td><td>67</td><td>68</td><td>69</td><td>70</td><td>71</td><td>72</td><td>73</td><td>74</td><td>75</td><td>76</td><td>77</td><td>78</td><td>79</td><td>80</td><td>81</td><td>82</td><td>83</td><td>84</td><td>85</td><td>86</td><td>87</td><td>88</td><td>89</td><td>90</td><td>91</td><td>92</td><td>93</td><td>94</td><td>95</td><td>96</td><td>97</td><td>98</td><td>99</td><td>100</td> </tr> </table>		1	2	3	4	5	6	7	8	9	10	11	12	13	14	15	16	17	18	19	20	21	22	23	24	25	26	27	28	29	30	31	32	33	34	35	36	37	38	39	40	41	42	43	44	45	46	47	48	49	50	51	52	53	54	55	56	57	58	59	60	61	62	63	64	65	66	67	68	69	70	71	72	73	74	75	76	77	78	79	80	81	82	83	84	85	86	87	88	89	90	91	92	93	94	95	96	97	98	99	100
1	2	3	4	5	6	7	8	9	10	11	12	13	14	15	16	17	18	19	20	21	22	23	24	25	26	27	28	29	30	31	32	33	34	35	36	37	38	39	40	41	42	43	44	45	46	47	48	49	50	51	52	53	54	55	56	57	58	59	60	61	62	63	64	65	66	67	68	69	70	71	72	73	74	75	76	77	78	79	80	81	82	83	84	85	86	87	88	89	90	91	92	93	94	95	96	97	98	99	100			
I HEREBY CERTIFY THAT THIS WELL HAS BEEN CONSTRUCTED IN ACCORDANCE WITH COMAR 26.04.04 "WELL CONSTRUCTION" AND IN CONFORMANCE WITH ALL CONDITIONS STATED IN THE ABOVE CAPTIONED PERMIT, AND THAT THE INFORMATION PRESENTED HEREIN IS ACCURATE AND COMPLETE TO THE BEST OF MY KNOWLEDGE.	LAND SURFACE (circle appropriate box and enter casing height) <input checked="" type="checkbox"/> above <input type="checkbox"/> below <u>3</u> (nearest foot)																																																																																																					
DRILLERS LIC. NO. <u>M WD 567</u> DRILLER'S SIGNATURE (MUST MATCH SIGNATURE ON APPLICATION) LIC. NO. <u>D</u>	LATITUDE <u>39.732849</u> LONGITUDE <u>76.451048</u> (DEFAULT COORD. WGS 84)																																																																																																					
SITE SUPERVISOR (sign. of driller or journeyman responsible for sitework if different from permittee)	Pursuant to §10-624 of the State Govt. Article of the Maryland Code personal info. requested on this form is used in processing this form pursuant to COMAR 26.04.04. Failure to provide the info. may result in this form not being processed. You have the right to inspect, amend, or correct this form. The Maryland Department of the Environment is subject to the Maryland Public Information Act. This form may be made available on the Internet via MDE's website and is subject to inspection or copying, in whole or in part, by the public and other governmental agencies, if not protected by federal or state law.																																																																																																					

B 1 <div style="border: 1px solid black; padding: 5px; font-size: 24px; text-align: center;">53514</div>	SEQUENCE NO. (MDE USE ONLY)	STATE OF MARYLAND APPLICATION FOR PERMIT TO DRILL WELL <div style="border: 1px solid black; padding: 5px; font-size: 24px; text-align: center;">562916</div> please type	STATE PERMIT NUMBER <div style="border: 1px solid black; padding: 5px; font-size: 24px; text-align: center;">H0-17-0267</div> fill in this form completely
Date Received (APA) <div style="border: 1px solid black; padding: 5px; font-size: 24px; text-align: center;">03/06/18</div>		B 3 LOCATION OF WELL <div style="border: 1px solid black; padding: 5px; font-size: 24px; text-align: center;">Howard County</div>	
OWNER INFORMATION <div style="border: 1px solid black; padding: 5px;"> <div style="display: flex; justify-content: space-between;"> <div> 15 Last Name <div style="border: 1px solid black; padding: 2px;">Ricourt</div> </div> <div> Owner <div style="border: 1px solid black; padding: 2px;">Ernesto</div> </div> <div> First Name <div style="border: 1px solid black; padding: 2px;">Ernesto</div> </div> </div> <div style="display: flex; justify-content: space-between; margin-top: 10px;"> <div> 36 Street or RFD <div style="border: 1px solid black; padding: 2px;">5253 Talbots Landing</div> </div> <div> 55 <div style="border: 1px solid black; padding: 2px;">Ellicott City MD 21043</div> </div> </div> <div style="display: flex; justify-content: space-between; margin-top: 10px;"> <div> 57 Town <div style="border: 1px solid black; padding: 2px;">Ellicott City</div> </div> <div> 70 State <div style="border: 1px solid black; padding: 2px;">MD</div> </div> <div> 72 Zip <div style="border: 1px solid black; padding: 2px;">21043</div> </div> </div> </div>		<div style="border: 1px solid black; padding: 5px;"> 23 SUBDIVISION <div style="border: 1px solid black; padding: 2px;">Ellicott City</div> </div>	
DRILLER INFORMATION <div style="border: 1px solid black; padding: 5px;"> <div style="display: flex; justify-content: space-between;"> <div> Driller's Name <div style="border: 1px solid black; padding: 2px;">Jeff Corron</div> </div> <div> MWD 567 <div style="border: 1px solid black; padding: 2px;">MWD 567</div> </div> </div> <div style="display: flex; justify-content: space-between; margin-top: 10px;"> <div> Firm Name <div style="border: 1px solid black; padding: 2px;">Chesapeake Geosystems, Inc.</div> </div> <div> Address <div style="border: 1px solid black; padding: 2px;">6720 Ft. Smallwood Rd Balt.</div> </div> </div> <div style="display: flex; justify-content: space-between; margin-top: 10px;"> <div> Signature <div style="border: 1px solid black; padding: 2px;">Jeff Corron</div> </div> <div> Date <div style="border: 1px solid black; padding: 2px;">3/2/18</div> </div> </div> </div>		B 4 SOURCES OF DRILLING WATER <div style="border: 1px solid black; padding: 5px;"> 1. municipal 2. 3. </div>	
B 2 WELL INFORMATION <div style="border: 1px solid black; padding: 5px;"> <div style="display: flex; justify-content: space-between;"> <div> APPROX. PUMPING RATE (GAL. PER MIN.) <div style="border: 1px solid black; padding: 2px;">N/A</div> </div> <div> 8 <div style="border: 1px solid black; padding: 2px;">N/A</div> </div> </div> <div style="display: flex; justify-content: space-between; margin-top: 10px;"> <div> AVERAGE DAILY QUANTITY NEEDED (GAL. PER DAY) <div style="border: 1px solid black; padding: 2px;">N/A</div> </div> <div> 14 <div style="border: 1px solid black; padding: 2px;">N/A</div> </div> </div> </div>		<div style="border: 1px solid black; padding: 5px;"> 5253 Talbots Landing 11 STREET ADDRESS <div style="border: 1px solid black; padding: 2px;">30</div> </div> <div style="border: 1px solid black; padding: 5px; text-align: center;"> ON WHICH SIDE OF ROAD (CIRCLE APPROPRIATE BOX) <div style="display: flex; justify-content: space-around; align-items: center;"> <div style="text-align: center;">NORTH W E</div> <div style="text-align: center;">WEST S EAST</div> </div> <div style="display: flex; justify-content: space-around; margin-top: 10px;"> <div> 34 <div style="border: 1px solid black; padding: 2px;">21</div> </div> <div> 37 <div style="border: 1px solid black; padding: 2px;">FT</div> </div> </div> <div style="display: flex; justify-content: space-around; margin-top: 10px;"> <div> DISTANCE FROM ROAD <div style="border: 1px solid black; padding: 2px;">ENTER FT OR MI</div> </div> <div> 38 <div style="border: 1px solid black; padding: 2px;">39</div> </div> </div> </div>	
USE FOR WATER (CIRCLE APPROPRIATE BOX) <div style="border: 1px solid black; padding: 5px;"> <div style="display: flex; flex-direction: column; gap: 5px;"> <div><input type="checkbox"/> DOMESTIC POTABLE SUPPLY & RESIDENTIAL IRRIGATION</div> <div><input type="checkbox"/> FARMING (LIVESTOCK WATERING & AGRICULTURAL IRRIGATION)</div> <div><input type="checkbox"/> INDUSTRIAL, COMMERCIAL, DEWATERING</div> <div><input type="checkbox"/> PUBLIC WATER SUPPLY WELL</div> <div><input type="checkbox"/> TEST, OBSERVATION, MONITORING</div> <div><input type="checkbox"/> OPEN LOOP GEOTHERMAL</div> <div><input checked="" type="checkbox"/> CLOSED LOOP GEOTHERMAL</div> </div> </div>		NOT TO BE FILLED IN BY DRILLER HEALTH DEPARTMENT APPROVAL <div style="border: 1px solid black; padding: 5px;"> <div style="display: flex; justify-content: space-between;"> <div> COUNTY NAME <div style="border: 1px solid black; padding: 2px;">Howard</div> </div> <div> COUNTY NO. <div style="border: 1px solid black; padding: 2px;">13</div> </div> </div> <div style="display: flex; justify-content: space-between; margin-top: 10px;"> <div> STATE SIGNATURE <div style="border: 1px solid black; padding: 2px;">[Signature]</div> </div> <div> INSERT S <div style="border: 1px solid black; padding: 2px;">[Signature]</div> </div> </div> <div style="display: flex; justify-content: space-between; margin-top: 10px;"> <div> DATE ISSUED <div style="border: 1px solid black; padding: 2px;">3/16/18</div> </div> <div> CO SIGNATURE <div style="border: 1px solid black; padding: 2px;">[Signature]</div> </div> </div> <div style="display: flex; justify-content: space-between; margin-top: 10px;"> <div> 43 <div style="border: 1px solid black; padding: 2px;">[Signature]</div> </div> <div> 48 <div style="border: 1px solid black; padding: 2px;">[Signature]</div> </div> </div> </div>	
APPROXIMATE DEPTH OF WELL <div style="border: 1px solid black; padding: 5px;"> <div style="display: flex; justify-content: space-between;"> <div> 24 <div style="border: 1px solid black; padding: 2px;">480</div> </div> <div> 28 <div style="border: 1px solid black; padding: 2px;">FEET</div> </div> </div> </div>		PROPOSED LOCATION OF WELL ON LOT SHOW PERMANENT STRUCTURES SUCH AS BUILDINGS, SEPTIC SYSTEM, ROADS AND/OR LANDMARKS AND INDICATE NOT LESS THAN TWO DISTANCE MEASUREMENTS TO WELL <div style="border: 1px solid black; padding: 5px;"> </div>	
APPROXIMATE DIAMETER OF WELL <div style="border: 1px solid black; padding: 5px;"> <div style="display: flex; justify-content: space-between;"> <div> 24 <div style="border: 1px solid black; padding: 2px;">6</div> </div> <div> 28 <div style="border: 1px solid black; padding: 2px;">INCH</div> </div> </div> </div>		METHOD OF DRILLING (circle one) <div style="border: 1px solid black; padding: 5px;"> <div style="display: flex; flex-wrap: wrap;"> <div style="width: 50%;"> BORED (or Augered) <div style="border: 1px solid black; padding: 2px;">AIR-ROTARY</div> </div> <div style="width: 50%;"> JETTED <div style="border: 1px solid black; padding: 2px;">AIR-PERCUSION</div> </div> <div style="width: 50%;"> Jetted & DRIVEN <div style="border: 1px solid black; padding: 2px;">ROTARY (Hydraulic Rotary)</div> </div> <div style="width: 50%;"> 37 CABLE <div style="border: 1px solid black; padding: 2px;">REVERSE-ROTARY</div> </div> <div style="width: 50%;"> DRIVE-POINT <div style="border: 1px solid black; padding: 2px;">[Signature]</div> </div> </div> </div>	
REPLACEMENT OR DEEPEENED WELLS (CIRCLE APPROPRIATE BOX) <div style="border: 1px solid black; padding: 5px;"> <div style="display: flex; flex-direction: column; gap: 5px;"> <div><input checked="" type="checkbox"/> THIS WELL WILL NOT REPLACE AN EXISTING WELL</div> <div><input type="checkbox"/> THIS WELL WILL REPLACE A WELL THAT WILL BE ABANDONED AND SEALED</div> <div><input type="checkbox"/> THIS WELL WILL REPLACE A WELL THAT WILL BE USED AS A STANDBY-CONTACT LOCAL APPROVING AUTHORITY FOR POLICY ON STANDBY WELLS</div> <div><input type="checkbox"/> THIS WELL WILL DEEPEEN AN EXISTING WELL</div> </div> </div>		<div style="border: 1px solid black; padding: 5px;"> PERMIT NUMBER OF WELL TO BE REPLACED OR DEEPEENED (IF AVAILABLE) <div style="display: flex; justify-content: space-between;"> <div> 41 <div style="border: 1px solid black; padding: 2px;">[Signature]</div> </div> <div> 52 <div style="border: 1px solid black; padding: 2px;">[Signature]</div> </div> </div> </div>	
Not to be filled in by driller (MDE OR COUNTY USE ONLY) <div style="border: 1px solid black; padding: 5px;"> <div style="display: flex; justify-content: space-between;"> <div> APPROX. PERMIT NUMBER <div style="border: 1px solid black; padding: 2px;">G</div> </div> <div> PERMIT No. <div style="border: 1px solid black; padding: 2px;">H0-17-0267</div> </div> </div> </div>			
SPECIAL CONDITIONS <div style="border: 1px solid black; padding: 5px;"> NOTE: APPROVING AUTHORITIES SHOULD USE SEPARATE SHEET IF NEEDED </div>			



ERNESTO RICOURT
5253 Tatbots Landing
Ell.cott city Md 21043



1 well @ 500'
w/ 1.25" closed LOOP
GEOTHERMAL

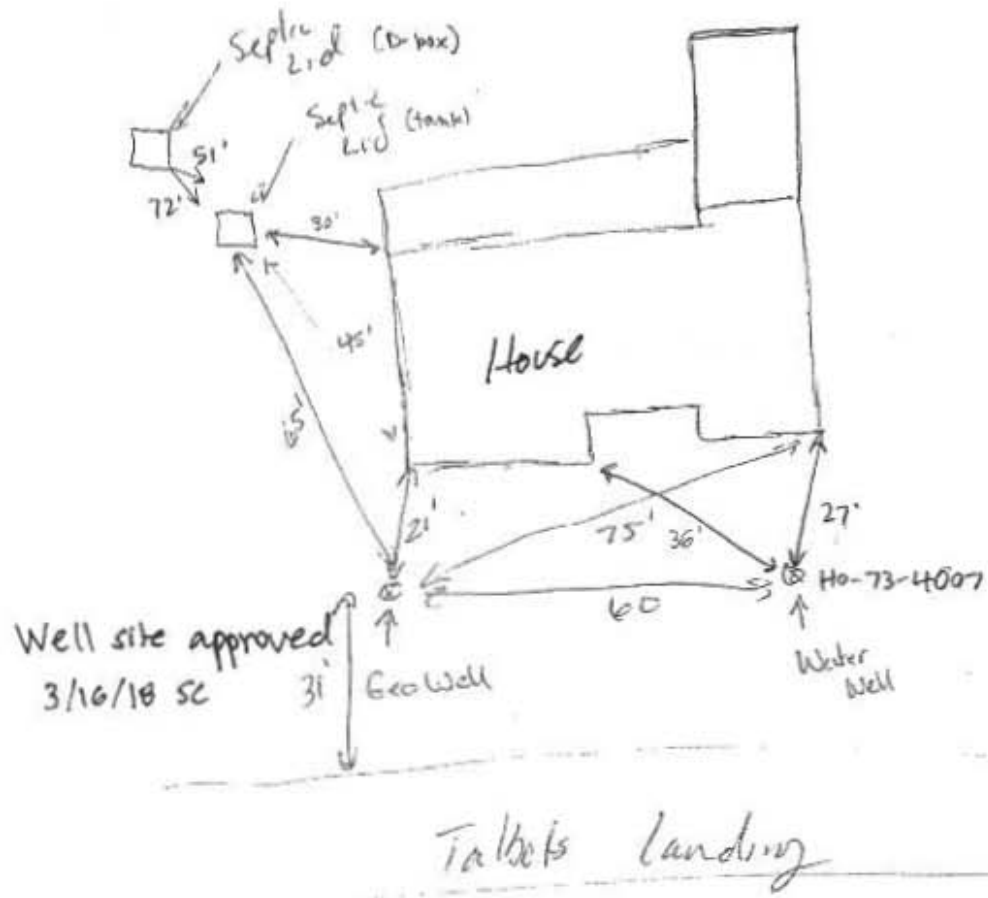

WELL SCHEMATIC FORM

GROUND SURFACE

PERMANENT OUTER CASING

CONFINING UNIT

PERMANENT OUTER CASING (if area contaminated)

MATERIAL _____

DIAMETER _____

LENGTH _____

DEPTH INTO CONFINING UNIT _____

TUBE CASING (if not regular, single loop)

ATTACH HORIZONTAL SCHEMATIC

NUMBER OF TUBES PER BOREHOLE _____

DIAMETER OF TUBES _____

MATERIAL _____

SHAPE AND LENGTH _____

TUBE CONNECTION METHOD _____

TUBE CONNECTION MATERIAL _____

LOOP PIPE CASING (regular, single loop)

MATERIAL HDPE? YES ☒ NO ☐

DIAMETER 1.25"

LENGTH 500

GROUT

MATERIAL Bentonite slurry

PERMEABILITY _____

WATER / GROUT RATIO 24 gal / 50 lbs

PERCENT SOLIDS 20%

TREMIE GROUTED FROM BOTTOM OF BOREHOLE? YES ☒ NO ☐

USING A POSITIVE DISPLACEMENT PUMP? YES ☒ NO ☐

DEPTH TO THE BOTTOM OF HOLE 500'

DIAMETER OF BOREHOLE 6"

WELL ADDRESS 5253 Talbots
Landing Ellicott City
Md 21043

LOT NUMBER: _____

SQUARE NUMBER: _____

WELL OWNER: Ernesto Ricourt

OWNER ADDRESS: 5253 Talbots
Landing Ellicott
City Md 21043



HOWARD COUNTY HEALTH DEPARTMENT

62916

DATE 3/10/18

Received From

PHONE # 410-789-5020

For

☐ CASH

☒ CHECK

NO.

3838

Well Permit / 5253
1000/land
One hundred sixty Dollars

\$

1100/12

Received By

[Signature]