

Bureau of Environmental Health
8930 Stanford Boulevard, Columbia, MD 21045
Main: 410-313-2640 | Fax: 410-313-2648
TDD 410-313-2323 | Toll Free 1-866-313-6300
www.hchealth.org
Facebook: www.facebook.com/hocohealth

Maura J. Rossman, M.D., Health Officer

RECEIPT DATE: 9/18/18

ONSITE SEWAGE DISPOSAL SYSTEM

P 564008

APPROVAL DATE: 11/28/18 SEC

PERMIT:

REPAIR

A

PROPERTY ADDRESS: 14070 Stevens Valley Court

SUBDIVISION:

LOT:

TAX ID: 04-313666

CONTRACTOR: South Carroll Backhoe

EMAIL: scbackhoe@comcast.net

CONTRACTOR ADDRESS: 4410 Salem Bottom Road, Westminster, MD 21157

PHONE: 410-596-3618

PROPERTY OWNER: Megan and Matt Wessel

EMAIL:

OWNER ADDRESS: 14070 Stevens Valley Court, Glenwood, MD 21738

PHONE: 301-366-9040

SEPTIC TANK SIZE (GALLONS): 1250 (ex) PUMP CHAMBER CAPACITY (GALLONS):

PUMP SIZE:

NUMBER OF BEDROOMS: 4 HOUSE SQ. FT.

APPLICATION RATE: 0.8

DISTRIBUTION SYSTEM: GRAVITY FED ☒

LOW PRESSURE DOSED ☐

TRENCHES:	LINEAR FEET REQUIRED:	<u>135'</u>	INLET DEPTH:	<u>5'</u>
	TRENCH WIDTH:	<u>2'</u>	MAXIMUM BOTTOM DEPTH:	<u>9'</u>
	MINIMUM SPACE BETWEEN TRENCHES:	<u>10'</u>	EFFECTIVE AREA BEGINNING DEPTH:	<u>4'</u>
LOCATION:	TO BE STAKED BY SANITARIAN DURING PRE-CONSTRUCTION INSPECTION.			
NOTES:	Install 2-60" trenches below existing trench. Drywell must be pumped + abandoned ^{3-45'}			

ISSUED BY: Sarah Collins

ISSUE DATE: 11/13/18

EXPIRATION DATE: 11/13/19

NOTE: CONTRACTOR MUST SCHEDULE A PRE-CONSTRUCTION INSPECTION PRIOR TO BEGINNING ANY INSTALLATION

NOTE: CONTRACTOR MUST SCHEDULE AN INSPECTION AND GAIN APPROVAL OF ALL COMPONENTS PRIOR TO COVERING

NOTE: STONE MUST BE APPROVED BY HEALTH DEPARTMENT AND GRAVEL TICKET MUST BE AVAILABLE FOR REVIEW.

NOTE: WATERTIGHT SEPTIC TANKS REQUIRED

NOTE: ALL PARTS OF SEPTIC SYSTEM SHALL BE AT LEAST 100 FEET DOWNGRADIENT FROM ANY WATER WELL

NOTE: MANHOLE RISERS REQUIRED ON ALL SEPTIC TANKS AND PUMP CHAMBERS

NOTE: AN ELECTRICAL PERMIT IS REQUIRED FOR INSTALLATION OF ANY ELECTRICAL COMPONENTS OF THE SYSTEM

☐ ELECTRICAL PERMIT ISSUED E N/A

NOTE: THE HCHD DOES NOT WARRANTY ANY SYSTEM AND CANNOT GUARANTEE THE PERFORMANCE OF THIS SYSTEM AS DESIGNED. BY ACCEPTING THIS PERMIT, THE OWNER AND/OR APPLICANT ACKNOWLEDGE THAT THE SPECIFICATIONS DETAILED IN THIS DESIGN ARE ONE POSSIBLE OPTION AND THAT THE HCHD WILL REVIEW OTHER PROPOSALS. YOU HAVE THE OPTION TO SEEK THE ADVICE OF A QUALIFIED DESIGN CONSULTANT OR PROFESSIONAL ENGINEER FOR FURTHER GUIDANCE.

NOTE: MDE RECOMMENDS SEPTIC TANKS, BAT, AND OTHER PRETREATMENT UNITS BE PUMPED AT A FREQUENCY ADEQUATE TO ENSURE THAT SOLIDS ARE NOT DISCHARGED TO THE DISPOSAL AREA

NEITHER THE HOWARD COUNTY COUNCIL NOR THE HEALTH DEPARTMENT IS RESPONSIBLE FOR THE SUCCESSFUL OPERATION OF ANY SYSTEM.

PERMITTEE RESPONSIBLE FOR OBTAINING FINAL APPROVAL ON THIS PERMIT.

CALL 410-313-1771 TO SCHEDULE INSPECTIONS.

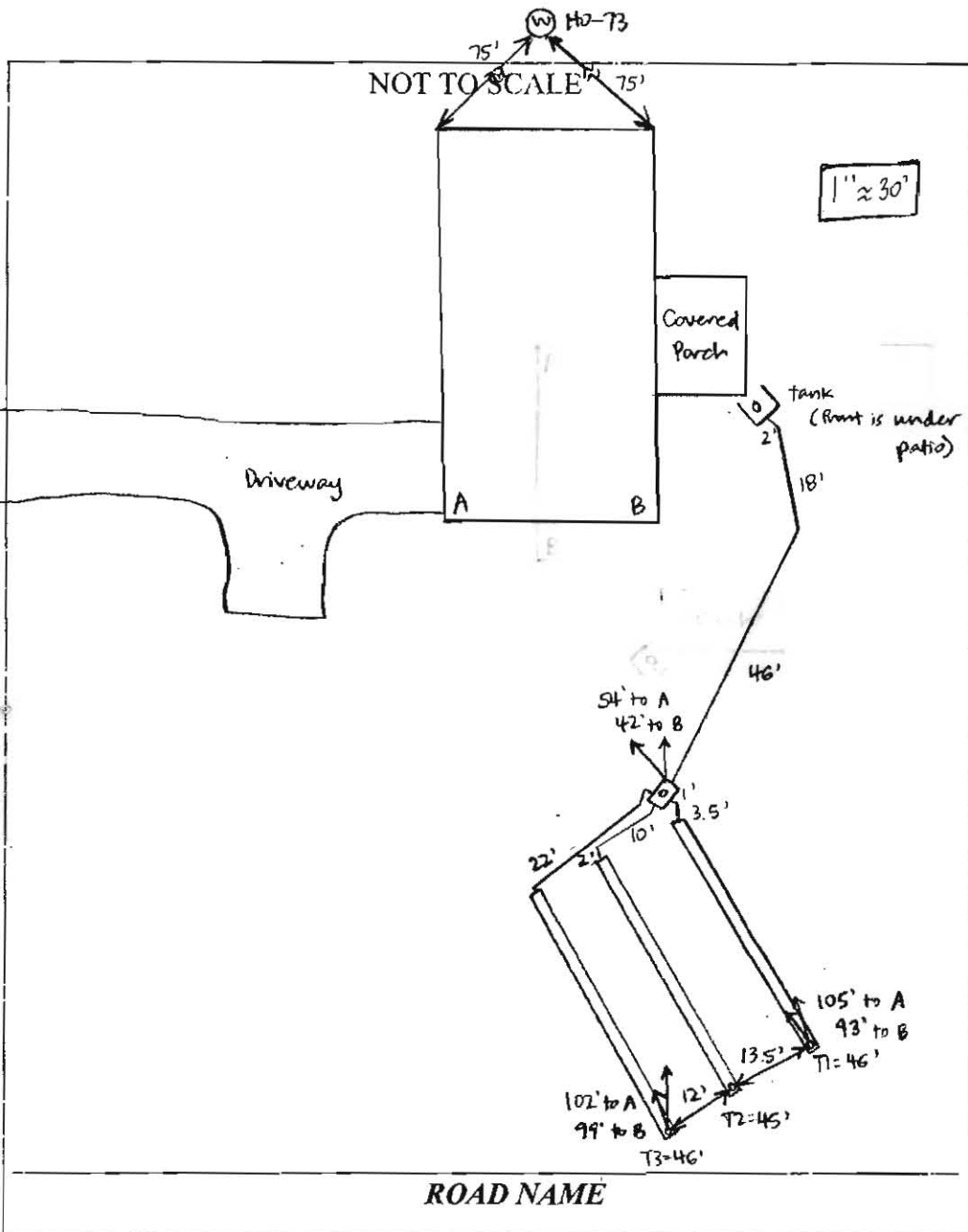

TRENCH/DRAINFIELD DATA		
WIDTH	INLET	BOTTOM
2'	4'	8'
NUMBER OF TRENCHES	3	
TOTAL LENGTH	137'	
ABSORPTION AREA	417' + SIDEWALL	
DISTRIBUTION BOX LEVEL	YES	
DISTRIBUTION BOX BAFFLE	YES	
DISTRIBUTION BOX PORT	YES	

SEPTIC TANK DATA	
SEPTIC TANK I LEVEL	existing
MANUFACTURER	?
CAPACITY	1250 GAL
SEAM LOC	MID
TANK LID DEPTH	2.5'
BAFFLES	REAR ✓
BAFFLE FILTER	NO
MANHOLE LOC	—
6" PORT LOC	REAR
WATERTIGHT TEST	NO
SLOTTED	NO
DATE ON LID	—

PUMP/SEPTIC TANK LEVEL	
MANUFACTURER	—
CAPACITY	— GAL
SEAM LOC	—
TANK LID DEPTH	—
BAFFLES	—
BAFFLE FILTER	—
MANHOLE LOC	—
6" PORT LOC	—
WATERTIGHT TEST	—
SLOTTED	—
DATE ON LID	—

PRE-CONSTRUCTION:

11/15/18 Met S. Carroll on site for layout. Shot contour and laid out 3x45' trenches. T3 may cross perc hole - cannot tell exact location due to snow on ground. (SC)

INSTALLATION:

11/19/18 Septic tank uncovered by contractor. Outlet pipe ~3.5' depth, should make 5' or shallower inlet at trenches. (SC) 11/20/18 Drywell pumped. S. Carroll filling with dirt. D-box set + connected to tank. First two trenches installed. T1 left open at ends for inspection and T2 left open. 2' wide, 3.5' to stone. S. Carroll could make 4' inlet so bottom is 8'. Tank has terracotta baffle at rear. (SC) 11/28/18 T3 dug. S. Carroll adding stone. 2' wide, 4' inlet, 8' bottom. Levelled spread levelers in D-box. (SC) 11/28/18 T3 complete + left open for inspection. (SC)