



HOWARD COUNTY HEALTH DEPARTMENT

64701

DATE 12/18/18

PS

Received
From

PHONE #

301 370-4121

Legacy Septic &
Excavation LLC

For

Ropeier Permit/12305

Seagssville MD
KO.

☐ CASH

☒ CHECK

NO.

49119

One hundred sixty-five

Dollars

\$

165.00

Received By

A King

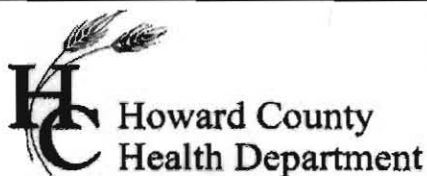

Bureau of Environmental Health
8930 Stanford Boulevard, Columbia, MD 21045
Main: 410-313-2640 | Fax: 410-313-2648
TDD 410-313-2323 | Toll Free 1-866-313-6300
www.hchealth.org
Facebook: www.facebook.com/hocohealth

Maura J. Rossman, M.D., Health Officer

RECEIPT DATE: 12/8/18

ONSITE SEWAGE DISPOSAL SYSTEM

P 564701

APPROVAL DATE: 12/20/18 SEC

PERMIT:

REPAIR

A 564068

PROPERTY ADDRESS: 12325 SCAGGSVILLE ROAD, FULTON, MD 20759

SUBDIVISION: _____

LOT: _____

TAX ID: 05-352797

CONTRACTOR: LEGACY SEPTIC AND EXCAVATION

EMAIL: _____

CONTRACTOR ADDRESS: 1538 MANCHESTER ROAD, WESTMINSTER, MD 21157

PHONE: (410)840-8766

PROPERTY OWNER: LESTER E HAWKES AND WIFE (dec.)

EMAIL: _____

OWNER ADDRESS: 12325 SCAGGSVILLE ROAD, FULTON, MD 20759

PHONE: (443)350-4261

SEPTIC TANK SIZE (GALLONS): 1000 EXISTS

PUMP CHAMBER CAPACITY (GALLONS): 1000

PUMP SIZE: TBD

NUMBER OF BEDROOMS: 3

HOUSE SQ. FT. 1500

APPLICATION RATE: 1.2

DISTRIBUTION SYSTEM: GRAVITY FED ☒

LOW PRESSURE DOSED ☐

TRENCHES:	LINEAR FEET REQUIRED: <u>104</u>	INLET DEPTH: <u>2</u>
	TRENCH WIDTH: <u>3</u>	MAXIMUM BOTTOM DEPTH: <u>3.5</u>
	MINIMUM SPACE BETWEEN TRENCHES: <u>10</u>	EFFECTIVE AREA BEGINNING DEPTH: <u>2.5</u>
LOCATION:	TO BE STAKED BY SANITARIAN DURING PRE-CONSTRUCTION INSPECTION WHICH IS REQUIRED.	
NOTES:	A PUMP TANK IS NEEDED AND A PUMP, EITHER 0.3 HP OR 0.5 HP. TOTAL DYNAMIC HEAD WILL BE 25 TO 30 FEET DEPENDING ON DELIVERY RATE OF PUMP. FORCE MAIN MAY BE AS LONG AS 520 FEET ± 5 FEET. DISTRIBUTION BOX WILL BE IN AREA NEAR BACK-LEFT PROPERTY CORNER. TWO 52-FT TRENCHES ARE TO BE INSTALLED ON CONTOUR. TRENCHES SHOULD BEGIN AT 10-FT PROPERTY LINE SETBACK AND EACH ONE END NEAR TEST LOCATION 'F'. INSTALL OBSERVATION PIPES AT DISTAL ENDS OF EACH TRENCH. INSTALL MANHOLE ON SEPTIC TANK.	

ISSUED BY: R BRICKER

ISSUE DATE: 12/8/18

EXPIRATION DATE: 12/18/19

NOTE: CONTRACTOR MUST SCHEDULE A PRE-CONSTRUCTION INSPECTION PRIOR TO BEGINNING ANY INSTALLATION

NOTE: CONTRACTOR MUST SCHEDULE AN INSPECTION AND GAIN APPROVAL OF ALL COMPONENTS PRIOR TO COVERING

NOTE: STONE MUST BE APPROVED BY HEALTH DEPARTMENT AND GRAVEL TICKET MUST BE AVAILABLE FOR REVIEW.

NOTE: WATERTIGHT SEPTIC TANKS REQUIRED

NOTE: ALL PARTS OF SEPTIC SYSTEM SHALL BE AT LEAST 100 FEET DOWNGRADIENT FROM ANY WATER WELL

NOTE: MANHOLE RISERS REQUIRED ON ALL SEPTIC TANKS AND PUMP CHAMBERS

NOTE: AN ELECTRICAL PERMIT IS REQUIRED FOR INSTALLATION OF ANY ELECTRICAL COMPONENTS OF THE SYSTEM

☐ ELECTRICAL PERMIT ISSUED ☒ E See note on back

NOTE: THE HCHD DOES NOT WARRANTY ANY SYSTEM AND CANNOT GUARANTEE THE PERFORMANCE OF THIS SYSTEM AS DESIGNED. BY ACCEPTING THIS PERMIT, THE OWNER AND/OR APPLICANT ACKNOWLEDGE THAT THE SPECIFICATIONS DETAILED IN THIS DESIGN ARE ONE POSSIBLE OPTION AND THAT THE HCHD WILL REVIEW OTHER PROPOSALS. YOU HAVE THE OPTION TO SEEK THE ADVICE OF A QUALIFIED DESIGN CONSULTANT OR PROFESSIONAL ENGINEER FOR FURTHER GUIDANCE.

NOTE: MDE RECOMMENDS SEPTIC TANKS, BAT, AND OTHER PRETREATMENT UNITS BE PUMPED AT A FREQUENCY ADEQUATE TO ENSURE THAT SOLIDS ARE NOT DISCHARGED TO THE DISPOSAL AREA

NEITHER THE HOWARD COUNTY COUNCIL NOR THE HEALTH DEPARTMENT IS RESPONSIBLE FOR THE SUCCESSFUL OPERATION OF ANY SYSTEM.

PERMITTEE RESPONSIBLE FOR OBTAINING FINAL APPROVAL ON THIS PERMIT.

CALL 410-313-1771 TO SCHEDULE INSPECTIONS.

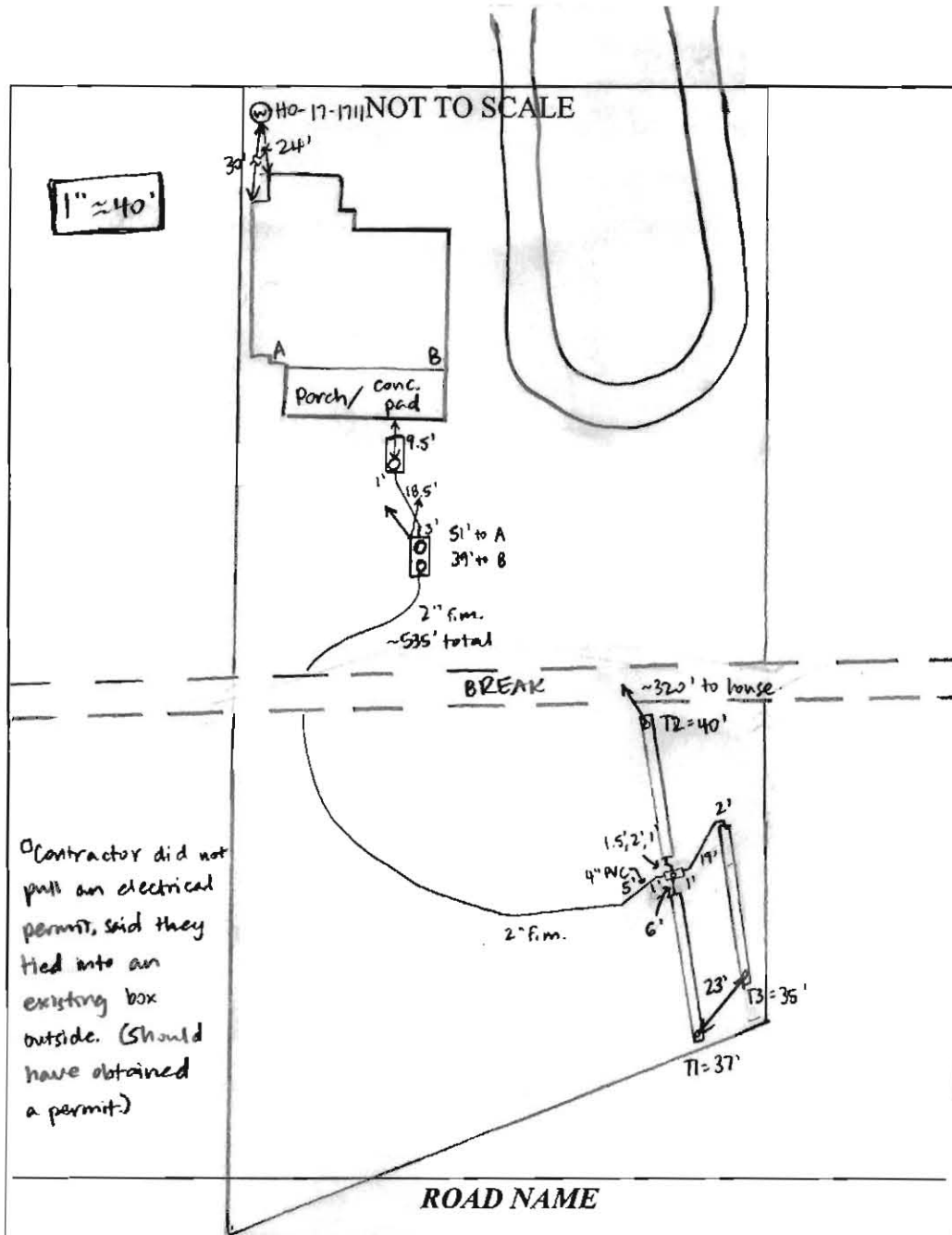

TRENCH/DRAINFIELD DATA		
WIDTH	INLET	BOTTOM
3'	2'	3.5'
NUMBER OF TRENCHES		3
TOTAL LENGTH		112'
ABSORPTION AREA		336' + SIDEWALL
DISTRIBUTION BOX LEVEL		YES
DISTRIBUTION BOX BAFFLE		YES
DISTRIBUTION BOX PORT		YES

SEPTIC TANK DATA	
SEPTIC TANK I LEVEL (existing)	
MANUFACTURER	?
CAPACITY	_____ GAL
SEAM LOC	MID
TANK LID DEPTH	0.5-1'
BAFFLES	YES
BAFFLE FILTER	NO
MANHOLE LOC	REAR
6" PORT LOC	NONE
WATERTIGHT TEST	NO
SLOTTED	NO
DATE ON LID	—
PUMP/SEPTIC TANK LEVEL YES	
MANUFACTURER	BAYSTAR
CAPACITY	1000 GAL
SEAM LOC	TOP
TANK LID DEPTH	0.5'
BAFFLES	NO
BAFFLE FILTER	NO
MANHOLE LOC	FRONT + REAR
6" PORT LOC	NONE
WATERTIGHT TEST	NO
SLOTTED	NO
DATE ON LID	—
Pump: Gould's WED311M (1/3 hp)	

PRE-CONSTRUCTION:

12/18/18 Met Legacy on site for layout. Shot contour and laid out 2 x 52' trenches between porch holes F + G. Force main will run through areas of slow porcs. (S)

Δ (12/22/18 cont'd) D-box does not have a baffle - Legacy put in a brick to break up flow while on site. [Corrective action + completed.] Alarm sounds, pump pumps effluent to D-box. (S)

* Homeowner says they got 4" + of rain over the weekend.

INSTALLATION: 12/19/18 Pump tank set. Force main installed most of the way up to the area of the trenches. Tank hole + force main trench flooded with water.* Legacy hit water @ 3' while digging upper trench - Robert Bricker on site to look at soils. Dug a few holes to 3.5' to look for water. Install 3 x 35' trenches close to E property line. Some water @ end of lowest trench @ 2.5', likely coming off tree roots. (S) 12/19/18 T1 + T2 installed, 1.5' to stone + 3' wide, left open for inspection. Using laser to check depths. (S) 12/20/18 Pump tank connected to septic tank + D-box/trenches. T3 installed, left open for inspection - 1.5' to stone, 3' wide. Several outlets installed to drain water along f.m. Δ

FINAL INSPECTOR Sarah Collins DATE OF APPROVAL 12/20/18



Bureau of Environmental Health

8930 Stanford Boulevard, Columbia, MD 21045

Main: 410-313-2640 | Fax: 410-313-2648

TDD 410-313-2323 | Toll Free 1-866-313-6300

www.hchealth.org

Facebook: www.facebook.com/hocohealth

Twitter: HowardCoHealthDep

Maura J. Rossman, M.D., Health Officer

SEWAGE DISPOSAL SYSTEM SPECIFICATIONS WORKSHEET

Address: 12325 Scaggsville Road (3-bedroom SFD)

Subdivision: Pre-construction meeting required
Call to schedule.

Initial system: Application rate: 1.2 Effective area beginning depth: 2.5 Bottom maximum depth: 3.5

~~1" Replacement:~~ Application rate: Effective area beginning depth: Bottom maximum depth:

~~2" Replacement:~~ Application rate: Effective area beginning depth: Bottom maximum depth:

Trench Inverts at 2 feet depth. Trench width, 3 ft.

Design Flow = 150 gallons per day per bedroom

Design flow ÷ application rate = square footage of drainfield required

Linear length of trench required = drainfield square footage x sidewall reduction percentage ÷ trench width

Sidewall reduction credit formula:

$$\frac{W + 2}{W + 1 + 2D} \times 100 = \text{Percent of length of standard trench where } W = \text{trench width and } D = \text{depth between effective area beginning depth and trench bottom.}$$

Standard design requirements:

- Trenches must be located to provide room for 3 systems in the disposal area
- All trenches must be equal length unless low pressure dosed
- All trenches must be on contour
- Tank and trenches must be placed as shallow as possible while maintaining 2% fall in pipe from house and at least 18" cover over trenches. If 2% fall from house is not possible, the minimum allowable fall is 1%.
- Minimum trench spacing: 10' for all trenches utilizing sidewall reduction credit. Additional spacing may be necessary for any trench using over 3.5' of effective sidewall. In those cases, the spacing formula is $2D + W$ up to a maximum spacing of 18'.
- Minimum trench spacing for trenches with no sidewall credit (bottom area only) is 6' for a 2' wide trench and 9' for a 3' wide trench (spacing is measured edge to edge)
- Maximum trench length is 100'
- Maximum pipe depth is 4'

Additional requirements: 'For Repair System'
A 1000-gal (minimum) Pump tank is needed. A 0.3Hp or 0.5Hp Pump
Pump to Distribution Box located in area of
back-left property corner. Two 52 ft Trenches to be
installed near location 'F'.

Approved: R Bricker Date: 12/11/2018

JW 6/14/2018

About 520 ft of Force Main is needed.