

APPLICATION

page 1

PERCOLATION TESTING

A 48/46A
P _____

HOWARD COUNTY HEALTH DEPARTMENT
BUREAU OF ENVIRONMENTAL HEALTH
P.O. BOX 476 ELLICOTT CITY, MARYLAND 21043
TELEPHONE. 461-9933

PAGUEN OK
PROPOSED SUBDIVISION
FROM APPROVED LOT,
SEE A17459 FOR
CURRENTLY APPROVED AREA,
CW

DISTRICT _____

DATE 5-12-92

TO: THE COUNTY HEALTH OFFICER
ELLICOTT CITY, MARYLAND

I, HEREBY, APPLY FOR THE NECESSARY TEST IN ORDER TO CONSTRUCT (OR RECONSTRUCT) A SEWAGE DISPOSAL SYSTEM.

PROPERTY OWNER MARIA E. HUMPHRIES

ADDRESS 6465 ROXBILL COURT GLENWOOD PHONE 854-6465
MD. 21738

PROSPECTIVE BUYER _____

ADDRESS _____ PHONE _____

PROPERTY LOCATION:

SUBDIVISION COLEMAN - CLEARCH LOT NO. 7A
7B (New Lot)

ROAD AND DESCRIPTION TRIADDELPHIA MILL RD WEST OF KALMIA DR.

TAX MAP 27 PARCEL # 96

SIZE OF LOT 5.590 AC.± TYPE BLDG S.F.D.
(SINGLE FAMILY DWELLING OR COMMERCIAL)

THE SYSTEM INSTALLED UNDER THIS APPLICATION IS ACCEPTABLE ONLY UNTIL PUBLIC FACILITIES BECOME AVAILABLE. I FULLY UNDERSTAND THE

FEE CONNECTED WITH THE FILING OF THIS PERC TEST APPLICATION IS NON-REFUNDABLE UNDER ANY CIRCUMSTANCES. I ALSO AGREE TO COMPLY

WITH ALL M.O.S.H.A. REQUIREMENTS IN TESTING THIS LOT. Zacharia Y. Fisch (agent)
(SIGNATURE OF APPLICANT)

APPROVED BY _____ FOR _____ DATE _____

REJECTED BY _____ FOR _____ DATE _____

HOLD PENDING FURTHER TESTS _____ DATE _____

REASONS FOR REJECTION OR HOLDING _____

HD-216

THIS IS NOT A PERMIT

A48146

COUNTY #

SOIL PROFILE

0'

Hole 02

Red-Red Brn
variegated
EL

2

Reddish brown
loam (fine)
and structure
appropriate that
crumble to
loam

11

Hole 03

Red hcl

3 1/2'

Red brown loam
same
as
Hole+str
variegated
Brittle
Spherulite

11'

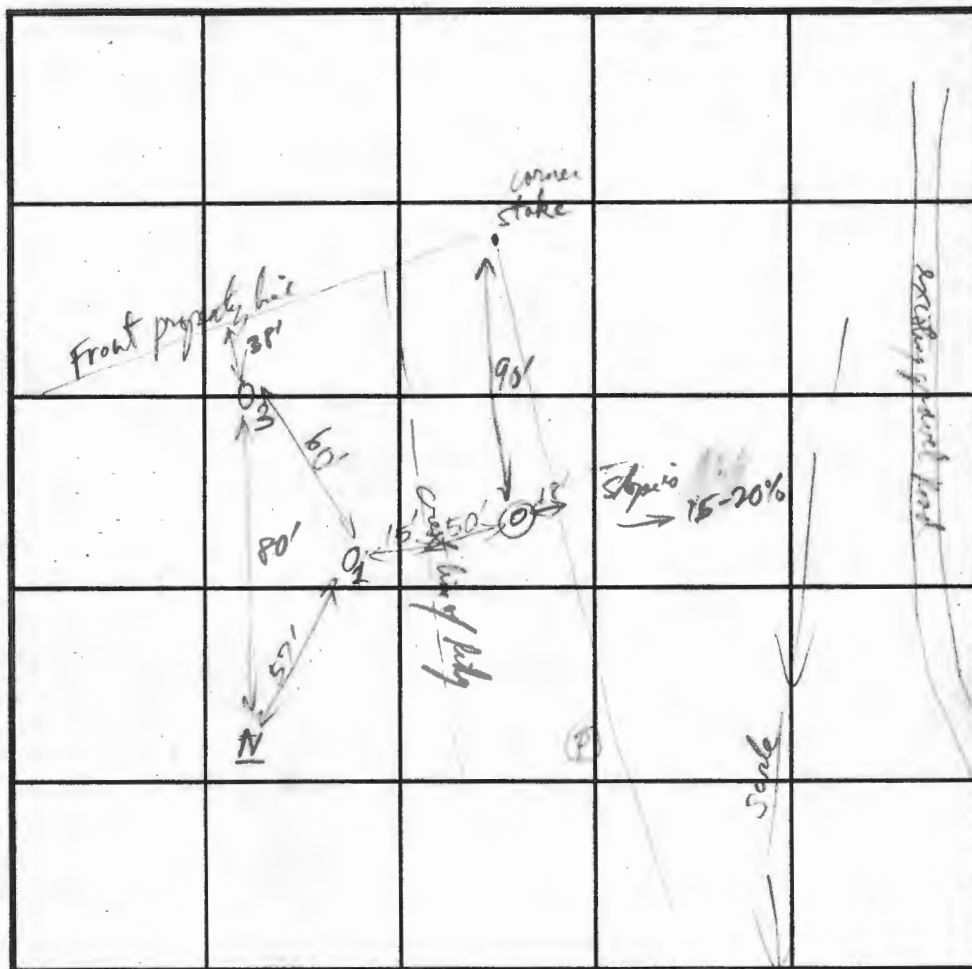

INDICATE NORTH - NAME ADJOINING ROADWAY AS BASE LINE.

SOIL PROFILE

0'

DATE	TEST NO.	DEPTH	PRE-WET		TEST - 1" DROP		TIME
			START	STOP	START	STOP	
11/6/92	(O)	Repsid @ 6 1/2'	Vertical Mica Schist bed	(80-90% bed)			2 1/2 (5 min)
	(P)	Nit Test					
	O2	V 11'	Thin Vertical Vein of Quartz + white silt	Visual 0.5			Ans
	O3	4'	12:39:00	12:40:30	12:40:30	12:43:15	3 min
		V 11'					

REMARKS More area for previously approved SDA but none on western slope of lot

TYPE OF SOIL _____

TESTED BY Handy ALSO PRESENT _____TRENCH DESIGN DATA: AVERAGE PERCOLATION TIME 5 min TRENCH WIDTH 3'INLET DEPTH 3 MAXIMUM BOTTOM DEPTH 5 SQ. FT/BEDROOM 180

APPLICATION

PERCOLATION TESTING

HOWARD COUNTY HEALTH DEPARTMENT
BUREAU OF ENVIRONMENTAL HEALTH
P.O. BOX 476 ELLICOTT CITY, MARYLAND 21043
TELEPHONE 461-9933

DISTRICT _____

DATE _____

Page 3
A 48146A
P 48146A

TO: THE COUNTY HEALTH OFFICER
ELLICOTT CITY, MARYLAND

I, HEREBY, APPLY FOR THE NECESSARY TEST IN ORDER TO CONSTRUCT (OR RECONSTRUCT) A SEWAGE DISPOSAL SYSTEM.

PROPERTY OWNER Maria E. Humphries

ADDRESS _____ PHONE _____

PROSPECTIVE BUYER _____

ADDRESS _____ PHONE _____

PROPERTY LOCATION:

SUBDIVISION Coleman - Leard LOT NO 7/15

ROAD AND DESCRIPTION Trinidad Mill Rd

TAX MAP 27 PARCEL # 96

SIZE OF LOT _____ TYPE BLDG _____
(SINGLE FAMILY DWELLING OR COMMERCIAL)

THE SYSTEM INSTALLED UNDER THIS APPLICATION IS ACCEPTABLE ONLY UNTIL PUBLIC FACILITIES BECOME AVAILABLE. I FULLY UNDERSTAND THE
FEE CONNECTED WITH THE FILING OF THIS PERC TEST APPLICATION IS NON-REFUNDABLE UNDER ANY CIRCUMSTANCES. I ALSO AGREE TO COMPLY
WITH ALL M.O.S.H.A. REQUIREMENTS IN TESTING THIS LOT.

(SIGNATURE OF APPLICANT)

APPROVED BY _____ FOR _____ DATE _____

REJECTED BY _____ FOR _____ DATE _____

HOLD PENDING FURTHER TESTS _____ DATE _____

REASONS FOR REJECTION OR HOLDING _____

THIS IS NOT A PERMIT

Low's Baby Off
Down

page 3

H66.17

SOIL PROFILE

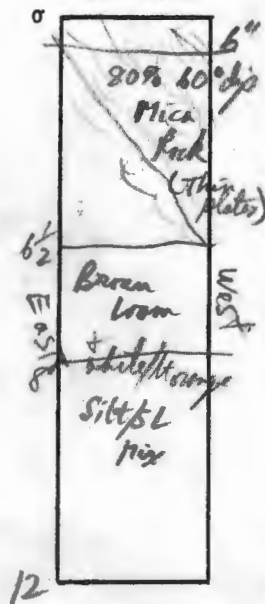

see page 2 for other Test Hole positions
+ page 1

Hole N is on lot 1 (Cold PA)
Hole M is on lot 1 (Cold PA)

Hole N

3' Strong Brn to dark Brn
5.5% 4/16-4/8
SICL mfr
Strong Brn
7.5% 5/16
Mica
Loam
12' Begin Str
Sediments

INDICATE NORTH - NAME ADJOINING ROADWAY AS BASE LINE.

DATE	TEST NO.	DEPTH	PRE-WET		TEST - 1" DROP		TIME
			START	STOP	START	STOP	
6-12-92	(M)	@ 2'	1:36:00	1:39:00	1:39:00	1:43:00	4 mins
		@ 8' ✓ 12'	1:13:00	1:21	1:21	1:33	12 mins ?
	N	@ 4'	1:12:30	1:14:00	1:14:00	1:17:00	3 min
		✓ 12'					

REMARKS _____

TYPE OF SOIL _____

TESTED BY R. R. R. ALSO PRESENT _____

APPLICATION

PERCOLATION TESTING

HOWARD COUNTY HEALTH DEPARTMENT
BUREAU OF ENVIRONMENTAL HEALTH
P.O. BOX 476 ELLICOTT CITY, MARYLAND 21043
TELEPHONE: 461-9933

DISTRICT _____

DATE _____

TO: THE COUNTY HEALTH OFFICER
ELLICOTT CITY, MARYLAND

I, HEREBY, APPLY FOR THE NECESSARY TEST IN ORDER TO CONSTRUCT (OR RECONSTRUCT) A SEWAGE DISPOSAL SYSTEM.

PROPERTY OWNER Maria E. Humphries

ADDRESS _____ PHONE _____

PROSPECTIVE BUYER _____

ADDRESS _____ PHONE _____

PROPERTY LOCATION:

SUBDIVISION Coleman-Leach LOT NO. 7A/7B

ROAD AND DESCRIPTION Triadelphia Mill Rd

TAX MAP 27 PARCEL # 96

SIZE OF LOT _____ TYPE BLDG _____

(SINGLE FAMILY DWELLING OR COMMERCIAL)

THE SYSTEM INSTALLED UNDER THIS APPLICATION IS ACCEPTABLE ONLY UNTIL PUBLIC FACILITIES BECOME AVAILABLE. I FULLY UNDERSTAND THE FEE CONNECTED WITH THE FILING OF THIS PERC TEST APPLICATION IS NON-REFUNDABLE UNDER ANY CIRCUMSTANCES. I ALSO AGREE TO COMPLY WITH ALL M.O.S.H.A. REQUIREMENTS IN TESTING THIS LOT.

(SIGNATURE OF APPLICANT)

APPROVED BY _____ FOR _____ DATE _____

REJECTED BY _____ FOR _____ DATE _____

HOLD PENDING FURTHER TESTS _____ DATE _____

REASONS FOR REJECTION OR HOLDING _____

THIS IS NOT A PERMIT

APPLICATION

Page 1

A 17459
P 48146B

PERCOLATION TESTING

HOWARD COUNTY HEALTH DEPARTMENT
BUREAU OF ENVIRONMENTAL HEALTH
P.O. BOX 476 ELLICOTT CITY, MARYLAND 21043
TELEPHONE 461-9933

PREVIEW OK
NO FEE REQ'D,
PREVIOUS SUCCESSFUL
TEST HISTORY,
H.O. REQUESTS CONFIRMATION TESTS
TO CONFIRM APPROVED LOCATION,
(W)

DISTRICT _____

DATE 5-18-92

TO: THE COUNTY HEALTH OFFICER
ELLICOTT CITY, MARYLAND

I, HEREBY, APPLY FOR THE NECESSARY TEST IN ORDER TO CONSTRUCT (OR RECONSTRUCT) A SEWAGE DISPOSAL SYSTEM.

PROPERTY OWNER MARIA E. HUMPHRIES

ADDRESS 6465 ROXMILL COURT, GLENWOOD MD. 21738 PHONE 854-6465

PROSPECTIVE BUYER _____

ADDRESS _____ PHONE _____

PROPERTY LOCATION:

SUBDIVISION COLEMAN - LEARCH LOT NO. Final 7B 7A (Retest)

ROAD AND DESCRIPTION TRIADELPHIA MILL RD. WEST OF Kalmia Drive.

TAX MAP 27 PARCEL # 96

SIZE OF LOT 4.699 AC. ± TYPE BLDG S.F.D.
(SINGLE FAMILY DWELLING OR COMMERCIAL)

THE SYSTEM INSTALLED UNDER THIS APPLICATION IS ACCEPTABLE ONLY UNTIL PUBLIC FACILITIES BECOME AVAILABLE. I FULLY UNDERSTAND THE

FEE CONNECTED WITH THE FILING OF THIS PERC TEST APPLICATION IS NON-REFUNDABLE UNDER ANY CIRCUMSTANCES. I ALSO AGREE TO COMPLY

WITH ALL M.O.S.H.A. REQUIREMENTS IN TESTING THIS LOT. Zacharia Y. Hysch (agent)

Test the A + B are Near lot 1 (but are on lot 2 of 7B) (SIGNATURE OF APPLICANT)

APPROVED BY _____ FOR _____ DATE _____

REJECTED BY _____ FOR _____ DATE _____

HOLD PENDING FURTHER TESTS _____ DATE _____

REASONS FOR REJECTION OR HOLDING _____

HD-216

THIS IS NOT A PERMIT

Hole A

SOIL PROFILE

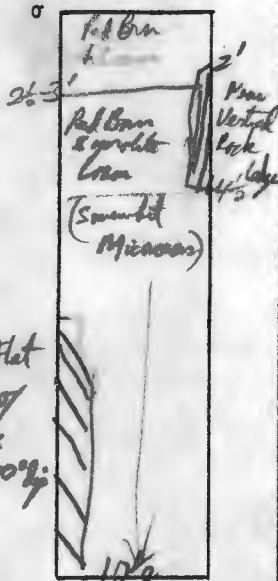

Thin flat
flaggy
Gneiss
@ 60-70%

beds are
large flat flags 1/2-1" thick
w/ thin 1/2-1" soil between
flags. (hard & sandy parts)

Hole D

Brn + Red Clay
loam
wavy boundary
Begin olive Brn
Channery loam
25-35% f-v
channery
(small pocket
of white tile)
Midwell
(3' down)

Hole E

Red Brn CL
Red Brn Loam
micaceous
4' East side
white/tt
11 1/2' silt-sil
Tale

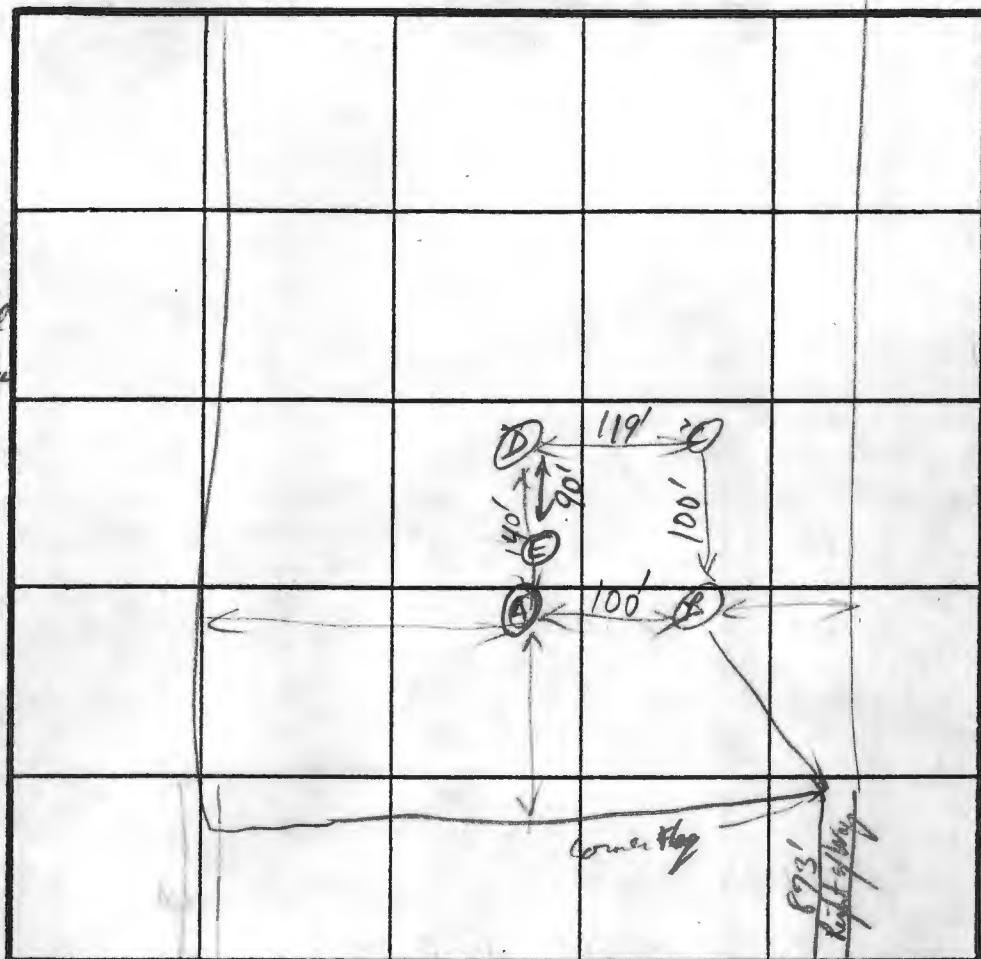

INDICATE NORTH - NAME ADJOINING ROADWAY AS BASE LINE.

Hole B

Hole A

Similar to
Hole A
but only one
low rocky pocket

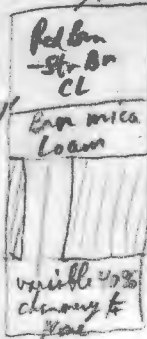

5' thin
micaceous
16' (seim)
only

all
post hole
digger
size of
holes

DATE	TEST NO.	DEPTH	PRE-WET		TEST - 1" DROP		TIME
			START	STOP	START	STOP	
6-10-92	#1 A	3'	11:01:50	11:23:00	pulls only 1/2'	drop in 25 min	Fail
		4 1/2'	11:13	11:22:50	11:23:00	11:38:00	15 min
		10 1/2'	Rock ledge on one side walk only @ 6 1/2 ft Rock Pockets @ 2 ft + deeper -				
	#4 B	@ 3'	11:25	11:35	11:35	1/2 @ 12:01	Too Slow
		@ 5 1/2'	11:52	12:00	12:00:40	12:12:30	12 min
		13'	Rocky (50%)				
	#3 C	@ 3'	11:36:30	11:37:40	11:37:40	11:40	2 min
		@ 5 1/2'	11:54:00	11:55:30	11:55:20	11:57:40	2 min
		13'					
	#2 D	3'	11:43	11:59	No Movement		Too Slow
		@ 5 1/2'	12:02:00	12:10:00	12:10:00	12:21:00	11 min
		12'					
	E	@ 5 1/2'	12:25:00	12:27:11	12:27:11	12:30:21	3 min
		11 1/2'					

peak in
Rock (diggable)

PASS

PASS

PASS

PASS

Hole C

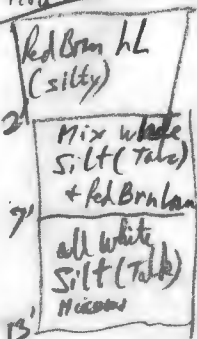

REMARKS Back is Gneiss for Micaceous

TYPE OF SOIL

TESTED BY

R/Pirley

ALSO PRESENT

William

+ 4 Fyock's