

5/10/79 or  
5/11/79

# PERMIT

SEWAGE DISPOSAL SYSTEM

MARYLAND STATE DEPARTMENT OF HEALTH\*

HOWARD COUNTY

ELLICOTT CITY

DISTRICT 5th

DATE 4/26/79

P 29747  
A 26550

**INDEXED**

Jim Brittingham

IS PERMITTED TO INSTALL X ALTER

ADDRESS 3004 N. Rogers Avenue, Ellicott City, Md. 21043

PHONE 461-1870

SUBDIVISION

ROAD Triadelphia Mill Road

LOT C

PROPERTY OWNER Clare I. Guernsey

ADDRESS 513 N. Horners Lane, Rockville, Md.

PHONE: 340-8425- Mohh

SPECIFICATIONS 3 Bedrooms - 1000 Gallon

384-0854 WORK

4 Bedrooms - 1250 Gallon

SEPTIC TANK CAPACITY \_\_\_\_\_ GALLONS

DRAIN FIELD \_\_\_\_\_ DEPTH \_\_\_\_\_ FEET, BOTTOM AREA \_\_\_\_\_ SQ. FT.

DEEP TRENCH \_\_\_\_\_ DEPTH \_\_\_\_\_ FEET, BOTTOM AREA \_\_\_\_\_ SQ. FT.

SEEPAGE PITS \_\_\_\_\_ ABSORBENT SIDE-WALL AREA 120 SQ. FT. per bedroom

INLET PIPE 6 FT. BELOW ORIGINAL GRADE. MAXIMUM DEPTH 14 FT. BELOW ORIGINAL GRADE

EFFECTIVE DEPTH AT \_\_\_\_\_ FT. BELOW ORIGINAL GRADE.

LOCATE DISPOSAL AREA \_\_\_\_\_ FT. FROM \_\_\_\_\_ LOT LINE AND \_\_\_\_\_ FT. FROM \_\_\_\_\_ LOT LINE AS SEEN WHEN  
FACING LOT FROM

Locate Dry Well 134 feet from the front lot line and 196 feet from the right lot line as seen when facing the lot from the front lot line.

NOTE: The front lot line is the line which is 654.78 ft long and runs runs South 41° 20 ft 58 East.

PLANS APPROVED BY Raymond Hodges

DATE 12/6/77

COVER NO WORK UNTIL INSPECTED AND APPROVED.

NEITHER THE HOWARD COUNTY COUNCIL NOR THE HEALTH DEPARTMENT IS RESPONSIBLE FOR THE SUCCESSFUL OPERATION OF ANY SYSTEM.

NOTE: IF TRENCH IS USED CALL FOR INSPECTION BEFORE PLACING GRAVEL IN TRENCH.

NOTE: NO DRY WELL SHALL EXCEED 15 FOOT IN DIAMETER.

NOTE: ALL PIPE FROM HOUSE TO DISPOSAL AREA MUST BE CAST IRON.

PERMIT VOID AFTER THREE YEARS.

NOTE: INSTALL STAND PIPE ON SEPTIC TANK AND DRY WELL. STAND PIPES MUST BE 6 INCHES IN DIAMETER. CAST IRON, CONCRETE OR TERRA COTTA ACCEPTED.

\*INSTALLER IS RESPONSIBLE FOR OBTAINING FINAL APPROVAL ON THIS PERMIT.

DO. PERMITS SIGNED  
AND RETURNED 3/8/01  
BOO 28599. BR,  
Bathroom, Laundry RM.

A26550

99841

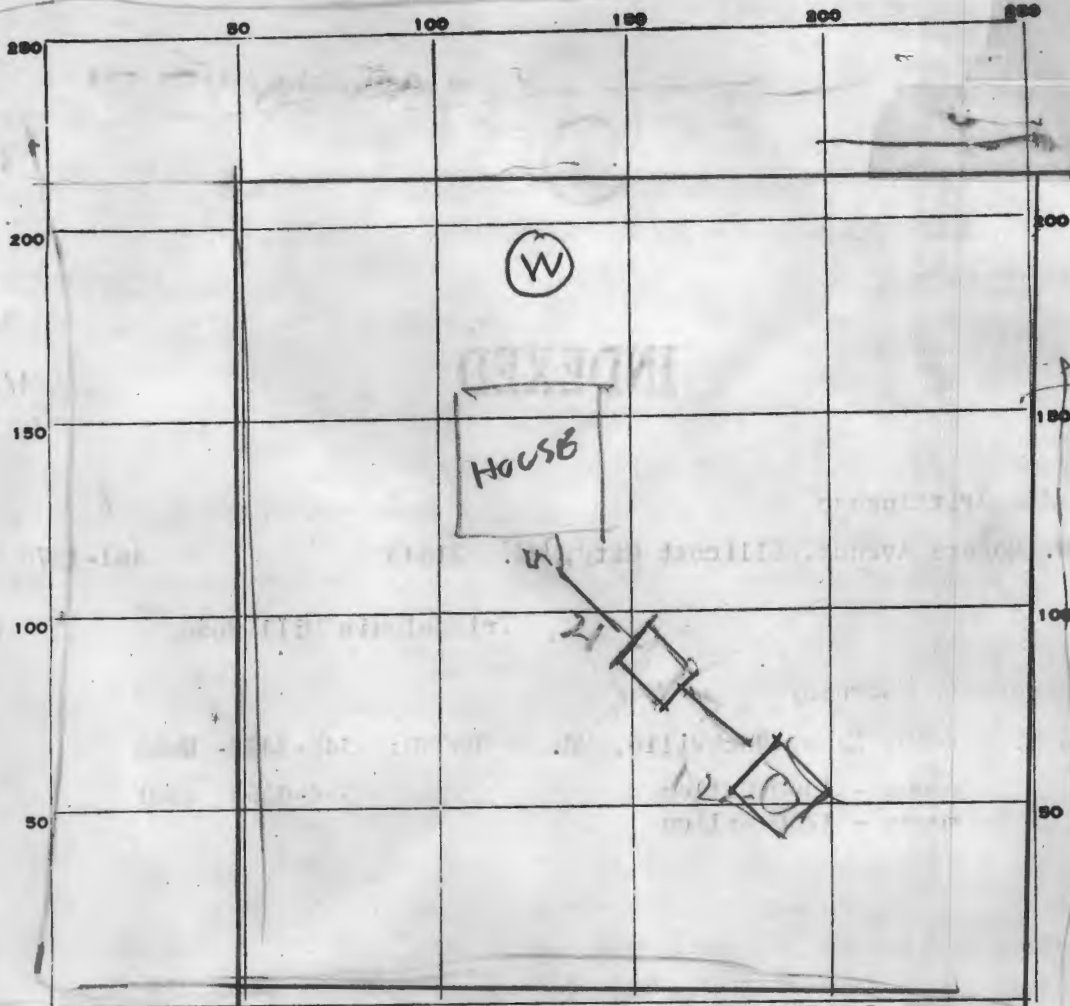

INDICATE NORTH. - NAME ADJOINING ROADWAY AS BASE LINE.

PERMIT CARD \_\_\_\_\_

SEPTIC TANK, LEVEL \_\_\_\_\_

CLEANOUTS \_\_\_\_\_

DISTRIBUTION BOX, LEVEL \_\_\_\_\_

TILE FIELD, DEPTH \_\_\_\_\_ FT. TRENCH WIDTH \_\_\_\_\_ FT.

GRAVEL DEPTH \_\_\_\_\_ IN. TOTAL LENGTH \_\_\_\_\_ FT.

NUMBER OF TRENCHES \_\_\_\_\_ TOTAL BOTTOM AREA \_\_\_\_\_

SEEPAGE PITS, INSIDE DIAMETER 60 FT. DEPTH BELOW INLET 7 FT.

ABSORBENT AREA 422 SQ. FT.

REMARKS

179 DW INLET 5F7  
3 BR 360 REQUIRED

DATE SYSTEM APPROVED

5/11/79

INSPECTOR

Raymond Hodger