

C 1 1958

SEQUENCE NO.
(MDE USE ONLY)STATE OF MARYLAND
WELL COMPLETION REPORT
FILL IN THIS FORM COMPLETELY
PLEASE TYPETHIS REPORT MUST BE SUBMITTED WITHIN
45 DAYS AFTER WELL IS COMPLETED.COUNTY
NUMBER

XIII

1 2 3 6
(THIS NUMBER IS TO BE PUNCHED
IN COLS. 3-6 ON ALL CARDS)

ST/CO USE ONLY

DATE Received

MM DD YY
01 27 13

DATE WELL COMPLETED

MM DD YY
4-30-08

Depth of Well

250

(TO NEAREST FOOT)

3 geo
wellsPERMIT NO.
FROM "PERMIT TO DRILL WELL"

H0-45-1596

OWNER

Whitken

Elliott

STREET OR RFD

last name 4070 Sharp Road

TOWN Glenelg

SUBDIVISION

The Heritage

SECTION

LOT 6

WELL LOG

Not required for driven wells

STATE THE KIND OF FORMATIONS PENETRATED, THEIR
COLOR, DEPTH, THICKNESS AND IF WATER BEARING

DESCRIPTION (Use additional sheets if needed)	FEET		check if water bearing
	FROM	TO	
top soil	0	2	
brown shale	2	44	
blue slate	44	250	

GROUTING RECORD

WELL HAS BEEN GROUTED
(Circle Appropriate Box)yes no
Y N
44 44

TYPE OF GROUTING MATERIAL (Circle one)

CEMENT CM BENTONITE CLAY BC

NO. OF BAGS 13 NO. OF POUNDS 1650

GALLONS OF WATER 312

DEPTH OF GROUT SEAL (to nearest foot)

from 48 TOP 52 ft. to 54 BOTTOM 58 ft.
(enter 0 if from surface)

CASING RECORD

casing
types
insert
appropriate
code
belowST CO
STEEL CONCRETE
PL OT
PLASTIC OTHERMAIN
CASING
TYPENominal diameter
top (main) casing
(nearest inch)Total depth
of main casing
(nearest foot)

60 61 63 64 66 70

EACH OTHER CASING (if used)
C diameter depth (feet)
S inch from to
I
Nscreen type
or open hole
(insert
appropriate
code
below)

SCREEN RECORD

ST BR HO
STEEL BRASS OPEN
HOLE
PL PL OT
PLASTIC OTHER

C 2 DEPTH (nearest ft.)

EACH SLOT SIZE 1 2 3
S diameter
N OF SCREEN (NEAREST
INCH)
56 60
from toGRAVEL PACK
IF WELL DRILLED
WAS FLOWING WELL
INSERT F IN BOX 68MDE USE ONLY
(NOT TO BE FILLED IN BY DRILLER)

T (E.R.O.S.) W Q

70 72 74 75 76
TELESCOPE LOG
CASING INDICATOR OTHER DATA

C 3

PUMPING TEST

HOURS PUMPED (nearest hour)

PUMPING RATE (gal. per min.)

METHOD USED TO
MEASURE PUMPING RATE

WATER LEVEL (distance from land surface)

BEFORE PUMPING 17 20 ft.

WHEN PUMPING 22 25 ft.

TYPE OF PUMP USED (for test)

A air P piston T turbine
27 27 27
C centrifugal R rotary O other
27 27 27 (describe
below)
J jet S submersible
27 27

PUMP INSTALLED

DRILLER INSTALLED PUMP YES NO
(CIRCLE) (YES or NO)IF DRILLER INSTALLS PUMP, THIS SECTION
MUST BE COMPLETED FOR ALL WELLS.TYPE OF PUMP INSTALLED
PLACE (A,C,J,P,R,S,T,O)
IN BOX 29.CAPACITY:
GALLONS PER MINUTE
(to nearest gallon) 31 35

PUMP HORSE POWER 37 41

PUMP COLUMN LENGTH
(nearest ft.) 43 47CASING HEIGHT (circle appropriate box
and enter casing height)+ above LAND SURFACE (nearest
foot)
- below 49 50 51

LOCATION OF WELL ON LOT

SHOW PERMANENT STRUCTURE SUCH AS
BUILDING, SEPTIC TANKS, AND /OR
LANDMARKS AND INDICATE NOT LESS
THAN TWO DISTANCES
(MEASUREMENTS TO WELL)

see attached

NUMBER OF UNSUCCESSFUL WELLS: 0

WELL HYDROFRACTURED

yes no
Y N

CIRCLE APPROPRIATE LETTER

A WELL WAS ABANDONED AND SEALED
WHEN THIS WELL WAS COMPLETED
E ELECTRIC LOG OBTAINED
P TEST WELL CONVERTED TO PRODUCTION
WELLI HEREBY CERTIFY THAT THIS WELL HAS BEEN CONSTRUCTED IN
ACCORDANCE WITH COMAR 26.04.04 "WELL CONSTRUCTION" AND
IN CONFORMANCE WITH ALL CONDITIONS STATED IN THE ABOVE
CAPTIONED PERMIT, AND THAT THE INFORMATION PRESENTED
HEREIN IS ACCURATE AND COMPLETE TO THE BEST OF MY
KNOWLEDGE.

DRILLERS LIC. NO.

MS D 163

DRILLERS SIGNATURE

(MUST MATCH SIGNATURE ON APPLICATION)

LIC. NO.

D

SITE SUPERVISOR (sign. of driller or journeyman
responsible for sitework if different from permittee)

DRILLER

B 1 <div style="border: 1px solid black; padding: 2px; font-size: 24px; font-weight: bold;">0727</div>	SEQUENCE NO. (MDE USE ONLY)	STATE OF MARYLAND APPLICATION FOR PERMIT TO DRILL WELL <div style="font-size: 24px; font-weight: bold;">528852</div> please type	STATE PERMIT NUMBER <div style="font-size: 24px; font-weight: bold;">40-95-1546</div> <small>fill in this form completely</small>
Date Received (APA) <div style="border: 1px solid black; padding: 2px;"> 8 MM DD YY 13 <div style="font-size: 24px; font-weight: bold;">Whitken Elliott</div> </div>		B 3 LOCATION OF WELL <div style="border: 1px solid black; padding: 2px;"> 8 COUNTY <div style="font-size: 24px; font-weight: bold;">Howard</div> </div>	
OWNER INFORMATION <div style="border: 1px solid black; padding: 2px;"> 15 Last Name <div style="font-size: 24px; font-weight: bold;">Whitken</div> </div> <div style="border: 1px solid black; padding: 2px;"> 34 Owner <div style="font-size: 24px; font-weight: bold;">Elliott</div> </div> <div style="border: 1px solid black; padding: 2px;"> 36 Street or RFD <div style="font-size: 24px; font-weight: bold;">4070 Sharp Road</div> </div> <div style="border: 1px solid black; padding: 2px;"> 55 Glenelg, MD 21737 </div>		<div style="border: 1px solid black; padding: 2px;"> 23 SUBDIVISION <div style="font-size: 24px; font-weight: bold;">The Heritage</div> </div> <div style="border: 1px solid black; padding: 2px;"> SECTION <div style="font-size: 24px; font-weight: bold;">6</div> </div> <div style="border: 1px solid black; padding: 2px;"> LOT <div style="font-size: 24px; font-weight: bold;">6</div> </div> <div style="border: 1px solid black; padding: 2px;"> 52 NEAREST TOWN <div style="font-size: 24px; font-weight: bold;">Glenelg</div> </div>	
DRILLER INFORMATION <div style="border: 1px solid black; padding: 2px;"> 76 Driller's Name <div style="font-size: 24px; font-weight: bold;">Daniel Patton</div> </div> <div style="border: 1px solid black; padding: 2px;"> 81 License No. <div style="font-size: 24px; font-weight: bold;">MS D1163</div> </div> <div style="border: 1px solid black; padding: 2px;"> Firm Name <div style="font-size: 24px; font-weight: bold;">Patton Well Drilling</div> </div> <div style="border: 1px solid black; padding: 2px;"> Address <div style="font-size: 24px; font-weight: bold;">6810 Cornell Road Baltimore, MD 21220</div> </div> <div style="border: 1px solid black; padding: 2px;"> Signature <div style="font-size: 24px; font-weight: bold;">Daniel Patton</div> </div> <div style="border: 1px solid black; padding: 2px;"> Date <div style="font-size: 24px; font-weight: bold;">3/12/08</div> </div>		B 4 <div style="border: 1px solid black; padding: 2px;"> 1 2 DIRECTION OF WELL FROM TOWN (CIRCLE BOX) </div> <div style="border: 1px solid black; padding: 2px;"> 11 NEAR WHAT ROAD <div style="font-size: 24px; font-weight: bold;">Sharp Road</div> </div> <div style="border: 1px solid black; padding: 2px;"> ON WHICH SIDE OF ROAD (CIRCLE APPROPRIATE BOX) </div> <div style="border: 1px solid black; padding: 2px;"> 34 47 37 DISTANCE FROM ROAD ENTER FT OR MI <div style="font-size: 24px; font-weight: bold;">FT</div> </div> <div style="border: 1px solid black; padding: 2px;"> TAX MAP: <div style="font-size: 24px; font-weight: bold;">21</div> BLK: <div style="font-size: 24px; font-weight: bold;">1B</div> PARCEL: <div style="font-size: 24px; font-weight: bold;">128</div> </div>	
B 2 WELL INFORMATION <div style="border: 1px solid black; padding: 2px;"> 1 2 APPROX. PUMPING RATE (GAL. PER MIN.) <div style="font-size: 24px; font-weight: bold;">N/A</div> </div> <div style="border: 1px solid black; padding: 2px;"> AVERAGE DAILY QUANTITY NEEDED (GAL. PER DAY) <div style="font-size: 24px; font-weight: bold;">N/A</div> </div>		USE FOR WATER (CIRCLE APPROPRIATE BOX) <div style="border: 1px solid black; padding: 2px;"> <input checked="" type="radio"/> DOMESTIC POTABLE SUPPLY & RESIDENTIAL IRRIGATION <input type="radio"/> FARMING (LIVESTOCK WATERING & AGRICULTURAL IRRIGATION) <input type="radio"/> INDUSTRIAL, COMMERCIAL, DEWATERING <input type="radio"/> PUBLIC WATER SUPPLY WELL <input type="radio"/> TEST, OBSERVATION, MONITORING <input checked="" type="radio"/> GEO-THERMAL <div style="font-size: 24px; font-weight: bold;">3-250' wells</div> </div>	
<div style="border: 1px solid black; padding: 2px;"> APPROXIMATE DEPTH OF WELL <div style="font-size: 24px; font-weight: bold;">250</div> FEET </div> <div style="border: 1px solid black; padding: 2px;"> APPROXIMATE DIAMETER OF WELL <div style="font-size: 24px; font-weight: bold;">6</div> INCH </div>		NOT TO BE FILLED IN BY DRILLER HEALTH DEPARTMENT APPROVAL <div style="border: 1px solid black; padding: 2px;"> COUNTY NAME <div style="font-size: 24px; font-weight: bold;">Howard</div> </div> <div style="border: 1px solid black; padding: 2px;"> COUNTY NO. <div style="font-size: 24px; font-weight: bold;">A22383</div> </div> <div style="border: 1px solid black; padding: 2px;"> STATE SIGNATURE _____ INSERT S → </div> <div style="border: 1px solid black; padding: 2px;"> DATE ISSUED <div style="font-size: 24px; font-weight: bold;">3/3/08</div> </div> <div style="border: 1px solid black; padding: 2px;"> CO SIGNATURE <div style="font-size: 24px; font-weight: bold;">[Signature]</div> </div> <div style="border: 1px solid black; padding: 2px;"> EXP. DATE <div style="font-size: 24px; font-weight: bold;">3/3/09</div> </div> <div style="border: 1px solid black; padding: 2px;"> NORTH GRID <div style="font-size: 24px; font-weight: bold;">519</div> </div> <div style="border: 1px solid black; padding: 2px;"> EAST GRID <div style="font-size: 24px; font-weight: bold;">798</div> </div>	
METHOD OF DRILLING (circle one) <div style="border: 1px solid black; padding: 2px;"> BORED (or Augered) <input checked="" type="radio"/> JETTED <input type="radio"/> JETTED & DRIVEN AIR-ROTary <input type="radio"/> AIR-PERCussion <input checked="" type="radio"/> ROTARY (Hydraulic Rotary) CABLE <input type="radio"/> REVERSE-ROTary <input type="radio"/> DRIVE-POINT other _____ </div>		<div style="border: 1px solid black; padding: 2px;"> SHOW MAJOR FEATURES OF BOX & LOCATE WELL WITH AN X <div style="text-align: center; font-size: 48px; font-weight: bold;">X</div> </div> <div style="border: 1px solid black; padding: 2px;"> SOURCES OF DRILLING WATER 1. _____ 2. _____ 3. _____ </div> <div style="border: 1px solid black; padding: 2px;"> WRITE THE BOX NUMBER FROM THE MAP HERE E <div style="font-size: 24px; font-weight: bold;">798</div> N <div style="font-size: 24px; font-weight: bold;">519</div> </div> <div style="border: 1px solid black; padding: 2px;"> DRAW A SKETCH BELOW SHOWING LOCATION OF WELL IN RELATION TO NEARBY TOWNS AND ROADS AND GIVE DISTANCE FROM WELL TO NEAREST ROAD JUNCTION </div>	
REPLACEMENT OR DEEPEMED WELLS (CIRCLE APPROPRIATE BOX) <div style="border: 1px solid black; padding: 2px;"> <input checked="" type="radio"/> THIS WELL WILL NOT REPLACE AN EXISTING WELL <input type="radio"/> THIS WELL WILL REPLACE A WELL THAT WILL BE ABANDONED AND SEALED <input checked="" type="radio"/> THIS WELL WILL REPLACE A WELL THAT WILL BE USED AS A STANDBY-CONTACT LOCAL APPROVING AUTHORITY FOR POLICY ON STANDBY WELLS <input type="radio"/> THIS WELL WILL DEEPEN AN EXISTING WELL </div> <div style="border: 1px solid black; padding: 2px;"> PERMIT NUMBER OF WELL TO BE REPLACED OR DEEPEMED (IF AVAILABLE) 41 _____ 52 </div>		<div style="border: 1px solid black; padding: 2px;"> APPROP. PERMIT NUMBER _____ G _____ </div> <div style="border: 1px solid black; padding: 2px;"> PERMIT No. <div style="font-size: 24px; font-weight: bold;">40-95-1546</div> </div>	
SPECIAL CONDITIONS <small>NOTE - APPROVING AUTHORITIES SHOULD USE SEPARATE SHEET IF NEEDED -</small> <div style="font-size: 24px; font-weight: bold; text-align: center;">Approved COMAR brat only bottom of top</div>			

Elliott & Janine Whithen
 4070 Sharp Road
 Glenelg, MD 21737
 410-489-6049

Sharp Road

Day Farm Road

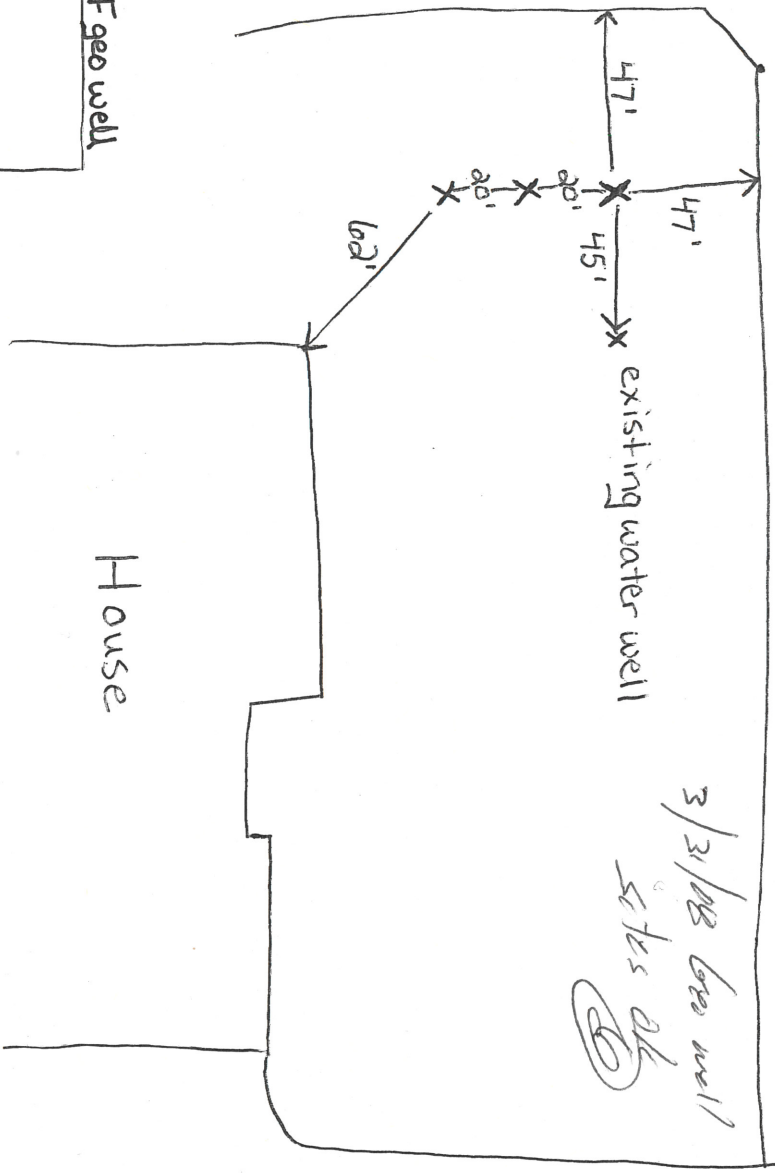

X cross section diagram of geo well

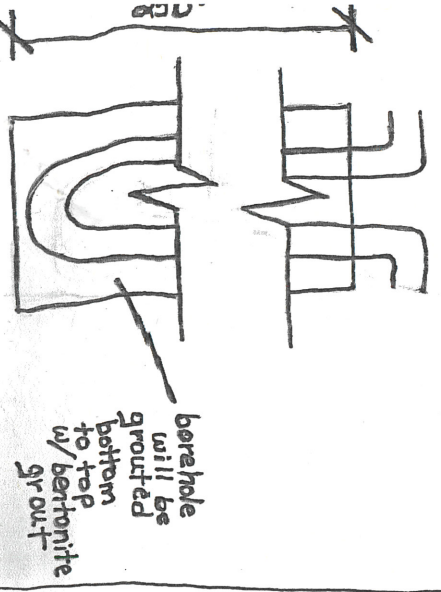

* well locations were staked by well driller