

11/20/02 10AM

PUB. SEWER STATUS VERIFIED BY

NA

ISSUE DATE: 11/8/02

PERMIT

P 517992-A

APPROVAL DATE: 11/20/02

A REPAIR A03198

**ON-SITE SEWAGE DISPOSAL SYSTEM
HOWARD COUNTY HEALTH DEPARTMENT
BUREAU OF ENVIRONMENTAL HEALTH**

03-297446

Fogles Septic Clean, Inc

IS PERMITTED TO INSTALL ☐ ALTER ☒

ADDRESS: 580 Obrecht Road, Sykesville

PHONE NUMBER: 410-795-5670

SUBDIVISION: River Park Estates

LOT NUMBER: 5

ADDRESS: 1121 River Road

PROPERTY OWNER: Craig Vaselaros

SEPTIC TANK CAPACITY (GALLONS):

existing 1000g?

PUMP CHAMBER CAPACITY (GALLONS):

NA

NUMBER OF BEDROOMS:

3

SQUARE FEET PER BEDROOM:

$180 \times 3 = 540 \div 2 = 270 \times .24 = 64.8'$

LINEAR FEET OF TRENCH REQUIRED:

65+

TRENCHES:	Trench to be 2 feet wide. Inlet 3 feet below original grade. Bottom maximum depth 10 feet below original grade. Effective area begins at 3-4 feet below original grade. 7 feet of stone below distribution pipe.
LOCATION:	
PURPOSE:	Existing septic system has failed. Call for inspection when ground is opened so sanitarian can recommend repair.

PLANS APPROVED:

Steven R. Krieg

DATE:

11/20/02

NOTE: PERMIT VOID AFTER 2 YEARS

NOTE: CONTRACTOR RESPONSIBLE FOR SCHEDULING A PRE-CONSTRUCTION INSPECTION FOR ALL INSTALLATIONS

NOTE: WATERTIGHT SEPTIC TANKS REQUIRED

NOTE: ALL PARTS OF SEPTIC SYSTEM SHALL BE 100 FEET FROM ANY WATER WELL

NOTE: MANHOLE RISERS REQUIRED ON ALL SEPTIC TANKS AND PUMP CHAMBERS

**NEITHER THE HOWARD COUNTY COUNCIL NOR THE HEALTH DEPARTMENT IS
RESPONSIBLE FOR THE SUCCESSFUL OPERATION OF ANY SYSTEM
PERMITTEE RESPONSIBLE FOR OBTAINING FINAL APPROVAL ON THIS PERMIT
CALL 410-313-2640 FOR INSPECTION OF SEPTIC SYSTEM**

P517992-A

INDEXED

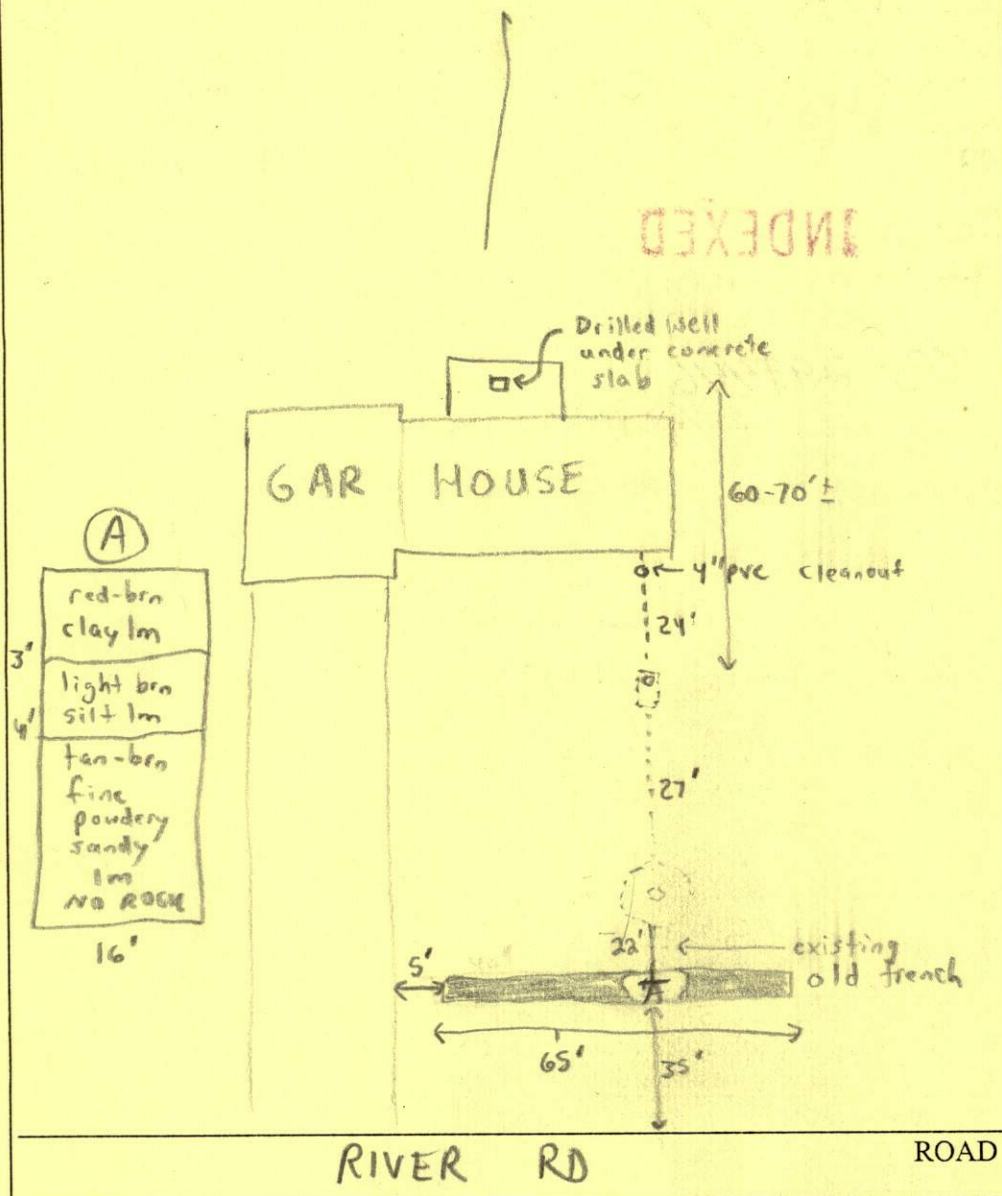

TRENCH/RAINFIELD DATA		
WIDTH	INLET	BOTTOM
2	3-4	10'
NUMBER OF TRENCHES		1
TOTAL LENGTH		65'
ABSORPTION AREA		455 ft ²
DISTRIBUTION BOX LEVEL		NA
DISTRIBUTION BOX BAFFLE		NA
DISTRIBUTION BOX PORT		NA

SEPTIC TANK DATA

SEPTIC TANK 1 LEVEL existing

CAPACITY 1000? GAL

SEAM LOC Midseam?

TANK LID DEPTH ?

BAFFLES OK

BAFFLE FILTER NA

MANHOLE LOC NA

6" PORT LOC lid on front

WATERTIGHT TEST NA

SEPTIC TANK 2 LEVEL NA

CAPACITY _____ GAL

SEAM LOC _____

TANK LID DEPTH _____

BAFFLES _____

BAFFLE FILTER _____

MANHOLE LOC _____

6" PORT LOC _____

WATERTIGHT TEST _____

PRE-CONSTRUCTION 11/20/02 - MET CONTRACTOR (KENNY MAYNE) DUG PERC HOLE
IN LOCATION (A) INSTALL AS DISCUSSED, A DRILLED WELL WAS OBSERVED
INSTALLATION - 7100' SLIGHTLY DOWNSLOPE OF PROPOSED SEPTIC BUT NOT
IN DIRECT DRAINAGE PATH OK - (FA/SRK)
INSTALLATION - 11/20/02 - OK TO COVER ALL WORK - (SRK)

FINAL INSPECTOR

DATE OF APPROVAL 11/26/02