

MB 8/19/19

## Search Result for HOWARD COUNTY

View Map		View GroundRent Redemption		View GroundRent Registration	
<b>Tax Exempt:</b>		<b>Special Tax Recapture:</b>			
<b>Exempt Class:</b>		NONE			
<b>Account Identifier:</b>		<b>District - 06 Account Number - 410995</b>			
Owner Information					
<b>Owner Name:</b>		8304 SHERWICK COURT LMTD PART C/O MIDLAND COMPANIES		<b>Use:</b>	INDUSTRIAL
<b>Mailing Address:</b>		1228 31ST ST NW STE 2 WASHINGTON DC 20007-3414		<b>Principal Residence:</b>	NO
				<b>Deed Reference:</b>	/02269/ 00423
Location & Structure Information					
<b>Premises Address:</b>		NW SHERWOOD CT JESSUP 20794-0000		<b>Legal Description:</b>	PAR B BL E S 1 SHERWICK CT BWIP ANNAPOLIS JT
<b>Map:</b>	<b>Grid:</b>	<b>Parcel:</b>	<b>Sub District:</b>	<b>Subdivision:</b>	<b>Section:</b>
0048	0001	0133		0000	
					<b>Block:</b>
					PAR B
					<b>Lot:</b>
					2020
					<b>Assessment Year:</b>
					Plat No:
					Plat Ref:
<b>Special Tax Areas:</b>		<b>Town:</b>		NONE	
		<b>Ad Valorem:</b>		104	
		<b>Tax Class:</b>			
<b>Primary Structure Built</b>	<b>Above Grade Living Area</b>	<b>Finished Basement Area</b>	<b>Property Land Area</b>	<b>County Use</b>	
1971	60000		3.6800 AC		
<b>Stories</b>	<b>Basement</b>	<b>Type</b>	<b>Exterior</b>	<b>Full/Half Bath</b>	<b>Garage</b>
		DISTRIBUTION WAREHOUSE			
Value Information					
	<b>Base Value</b>	<b>Value</b>	<b>Phase-in Assessments</b>		
		As of	As of	As of	
		01/01/2017	07/01/2019	07/01/2020	
<b>Land:</b>	801,500	801,500			
<b>Improvements</b>	2,555,100	2,555,100			
<b>Total:</b>	3,356,600	3,356,600	3,356,600		
<b>Preferential Land:</b>	0				
Transfer Information					
<b>Seller:</b> VALANOS GEORGE A		<b>Date:</b> 12/20/1990		<b>Price:</b> \$0	
<b>Type:</b> ARMS LENGTH IMPROVED		<b>Deed1:</b> /02269/ 00423		<b>Deed2:</b>	
<b>Seller:</b> SOVEREIGN TITLE CO		<b>Date:</b> 08/11/1988		<b>Price:</b> \$10,000	
<b>Type:</b> ARMS LENGTH IMPROVED		<b>Deed1:</b> /01867/ 00253		<b>Deed2:</b>	
<b>Seller:</b> SHERWICK LIMITED PARTNERSHIP		<b>Date:</b> 08/11/1988		<b>Price:</b> \$2,035,000	
<b>Type:</b> ARMS LENGTH IMPROVED		<b>Deed1:</b> /01867/ 00250		<b>Deed2:</b>	
Exemption Information					
<b>Partial Exempt Assessments:</b>	<b>Class</b>		07/01/2019	07/01/2020	
<b>County:</b>	000		0.00		
<b>State:</b>	000		0.00		
<b>Municipal:</b>	000		0.00	0.00	
<b>Tax Exempt:</b>		<b>Special Tax Recapture:</b>			
<b>Exempt Class:</b>		NONE			
Homestead Application Information					
<b>Homestead Application Status:</b> No Application					
Homeowners' Tax Credit Application Information					

1. This screen allows you to search the Real Property database and display property records.
2. Click **here** for a glossary of terms.
3. Deleted accounts can only be selected by Property Account Identifier.
4. The following pages are for information purpose only. The data is not to be used for legal reports or documents. While we have confidence in the accuracy of these records, the Department makes no warranties, expressed or implied, regarding the information.

# APPLICATION

SEWAGE DISPOSAL TESTING

STATE OF MARYLAND - DEPARTMENT OF HEALTH AND MENTAL HYGIENE

HOWARD COUNTY HEALTH DEPARTMENT  
ENVIRONMENTAL HEALTH SERVICES

P. O. BOX 473 ELLICOTT CITY, MARYLAND 21043  
TELEPHONE: 992-2330

A 32627

P \_\_\_\_\_

DISTRICT 6

DATE 4/5/83

TO: THE COUNTY HEALTH OFFICER  
ELLICOTT CITY, MARYLAND

I, HEREBY, APPLY FOR THE NECESSARY TEST IN ORDER TO CONSTRUCT (OR RECONSTRUCT) A SEWAGE DISPOSAL SYSTEM.

PROPERTY OWNER B.W.I.P. Inc.

ADDRESS 110 West Rd Towson, Md 21204 PHONE 296-6400

PROPERTY LOCATION:

SUBDIVISION Balto Wash Ind Pk LOT NO. B

ROAD AND DESCRIPTION North side of Patuxent Range Rd  
650' West of Dorsey Run Rd

SIZE OF LOT 500' x 1110' TYPE BLDG. \_\_\_\_\_ (NUMBER OF BEDROOMS)

THE SYSTEM INSTALLED UNDER THIS APPLICATION IS ACCEPTABLE ONLY UNTIL PUBLIC FACILITIES BECOME AVAILABLE. I FULLY UNDERSTAND THE FEE CONNECTED WITH THE FILING OF THIS PERC TEST APPLICATION IS NON-REFUNDABLE UNDER ANY CIRCUMSTANCES. I ALSO AGREE TO COMPLY WITH ALL M.O.S.H.A. REQUIREMENTS IN TESTING THIS LOT.

(SIGNATURE OF APPLICANT)

APPROVED BY \_\_\_\_\_ FOR \_\_\_\_\_ DATE \_\_\_\_\_

REJECTED BY \_\_\_\_\_ FOR \_\_\_\_\_ DATE \_\_\_\_\_

HOLD PENDING FURTHER TESTS \_\_\_\_\_ DATE \_\_\_\_\_

REASONS FOR REJECTION OR HOLDING 11 MAY 83 PERC OK HOLD FOR PERC  
CERT PLAT R/H FS SAID PUMP OK TO CSD  
FOR SEPT 12

## THIS IS NOT A PERMIT

SOIL PROFILE

0'

INDICATE NORTH - NAME ADJOINING ROADWAY AS BASE LINE.

DATE	TEST NO.	DEPTH	PRE-WET		TEST - 1" DROP		TIME
			START	STOP	START	STOP	

REMARKS \_\_\_\_\_

TYPE OF SOIL \_\_\_\_\_

TESTED BY \_\_\_\_\_ ALSO PRESENT \_\_\_\_\_

EH 12 10/9



# APPLICATION

SEWAGE DISPOSAL TESTING

STATE OF MARYLAND - DEPARTMENT OF HEALTH AND MENTAL HYGIENE

HOWARD COUNTY HEALTH DEPARTMENT  
ENVIRONMENTAL HEALTH SERVICES

P. O. BOX 476 ELLICOTT CITY, MARYLAND 21043  
TELEPHONE: 992-2330

A 32627

P \_\_\_\_\_

DISTRICT 6th

DATE 4/5/83

TO: THE COUNTY HEALTH OFFICER  
ELLICOTT CITY, MARYLAND

I, HEREBY, APPLY FOR THE NECESSARY TEST IN ORDER TO CONSTRUCT (OR RECONSTRUCT) A SEWAGE DISPOSAL SYSTEM.

PROPERTY OWNER

BWIP

ADDRESS

110 West Road, Towson, Md

PHONE

296-6408

PROPERTY LOCATION:

SUBDIVISION

LOT NO.

B.

ROAD AND DESCRIPTION

SIZE OF LOT

TYPE BLDG.

(NUMBER OF BEDROOMS)

THE SYSTEM INSTALLED UNDER THIS APPLICATION IS ACCEPTABLE ONLY UNTIL PUBLIC FACILITIES BECOME AVAILABLE. I FULLY UNDERSTAND THE FEE CONNECTED WITH THE FILING OF THIS PERC TEST APPLICATION IS NON-REFUNDABLE UNDER ANY CIRCUMSTANCES. I ALSO AGREE TO COMPLY WITH ALL M.O.S.H.A. REQUIREMENTS IN TESTING THIS LOT.

(SIGNATURE OF APPLICANT)

APPROVED BY

FOR

DATE

REJECTED BY

FOR

DATE

HOLD PENDING FURTHER TESTS

DATE

REASONS FOR REJECTION OR HOLDING

## THIS IS NOT A PERMIT

③

SOIL PROFILE

BED CLAY WITH STRAIN

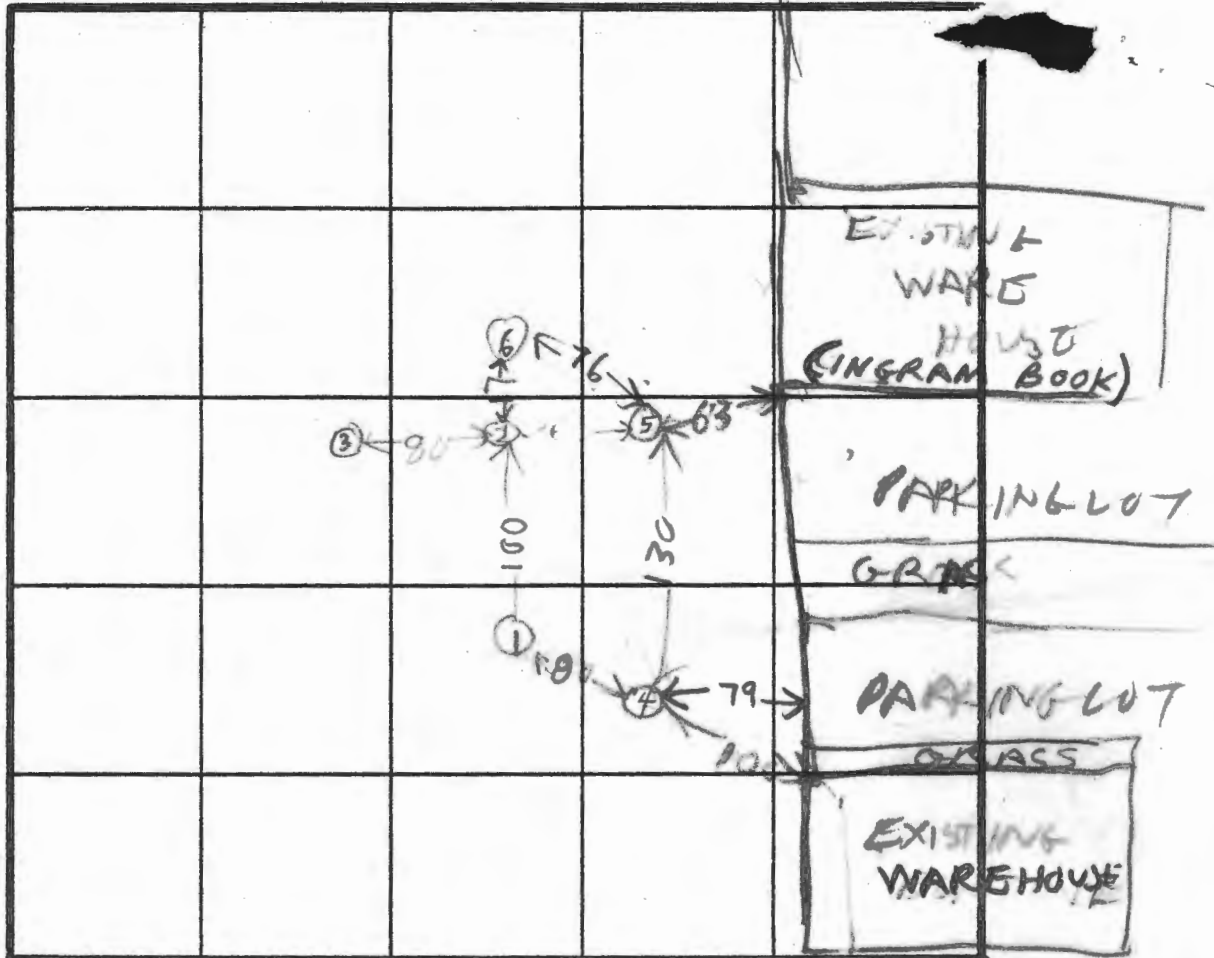

INDICATE NORTH - NAME ADJOINING ROADWAY AS BASE LINE.

PARK LOT

④  
CLAY SAND FILL MIX

BROWN CLAY SAND MIX

DATE	TEST NO.	DEPTH	PRE-WET		TEST - 1" DROP		TIME
			START	STOP	START	STOP	
5/11/03	1 S	3	1019	1022	1022	1025	5
	1 V	11	LOOKS OK	OK	ALL	SAND	
	2 S	3	1033	1033 1/2	1033 1/2	1034	1/2
	2 V	11	LOOKS OK	OK	ALL	SAND	
	3 V	9					
	4 S	4	1122	1123	1123	1125	2
	4 P	7 1/2	1201	1202	1202	1204	2
	4 V	12	LOOKS OK	OK			
	5 S	3	120	121	121	122	1
	3 V	11	LOOKS OK	OK	ALL	SAND	
5/11/03	6 V	11	ALL	SAND	LOOKS OK		

HOLE ELEVATION  
A  
5' HIGH  
12' LOW

REMARKS CITY WATER LOT ALMOST LEVEL

TYPE OF SOIL LOT NOT STAKED NEAR BY BUILDING USE

TESTED BY R. HODGES  
ALSO PRESENT SIM, LEE RON DIGGERS  
BUD ROESNER SURVEYOR

# APPLICATION

SEWAGE DISPOSAL TESTING

STATE OF MARYLAND - DEPARTMENT OF HEALTH AND MENTAL HYGIENE

HOWARD COUNTY HEALTH DEPARTMENT  
ENVIRONMENTAL HEALTH SERVICES

P. O. BOX 473 ELLICOTT CITY, MARYLAND 21043  
TELEPHONE: 992-2330

A 32628

P \_\_\_\_\_

DISTRICT 6

DATE 4/5/83

TO: THE COUNTY HEALTH OFFICER  
ELLICOTT CITY, MARYLAND

I, HEREBY, APPLY FOR THE NECESSARY TEST IN ORDER TO CONSTRUCT (OR RECONSTRUCT) A SEWAGE DISPOSAL SYSTEM.

PROPERTY OWNER BALP Inc

ADDRESS 110 West Rd Towson, Md 21204 PHONE 296-6400

PROPERTY LOCATION:

SUBDIVISION Balto. Wash-Ind. Pl. LOT NO. 6

ROAD AND DESCRIPTION N.W. cor. of Patuxent Range Rd

SIZE OF LOT 550' x 950' ± TYPE BLDG. 2 (NUMBER OF BEDROOMS)

THE SYSTEM INSTALLED UNDER THIS APPLICATION IS ACCEPTABLE ONLY UNTIL PUBLIC FACILITIES BECOME AVAILABLE. I FULLY UNDERSTAND THE FEE CONNECTED WITH THE FILING OF THIS PERC TEST APPLICATION IS NON-REFUNDABLE UNDER ANY CIRCUMSTANCES. I ALSO AGREE TO COMPLY WITH ALL M.O.S.H.A. REQUIREMENTS IN TESTING THIS LOT.

(SIGNATURE OF APPLICANT)

APPROVED BY \_\_\_\_\_ FOR \_\_\_\_\_ DATE \_\_\_\_\_

REJECTED BY \_\_\_\_\_ FOR \_\_\_\_\_ DATE \_\_\_\_\_

HOLD PENDING FURTHER TESTS \_\_\_\_\_ DATE \_\_\_\_\_

REASONS FOR REJECTION OR HOLDING 13 MAY 83 - Dig more SLOW PERC SOIL & WATER

H.S. SAID OK TO USE A PUMP FOR SEPTIC

SYSTEM

## THIS IS NOT A PERMIT

SOIL PROFILE

0'

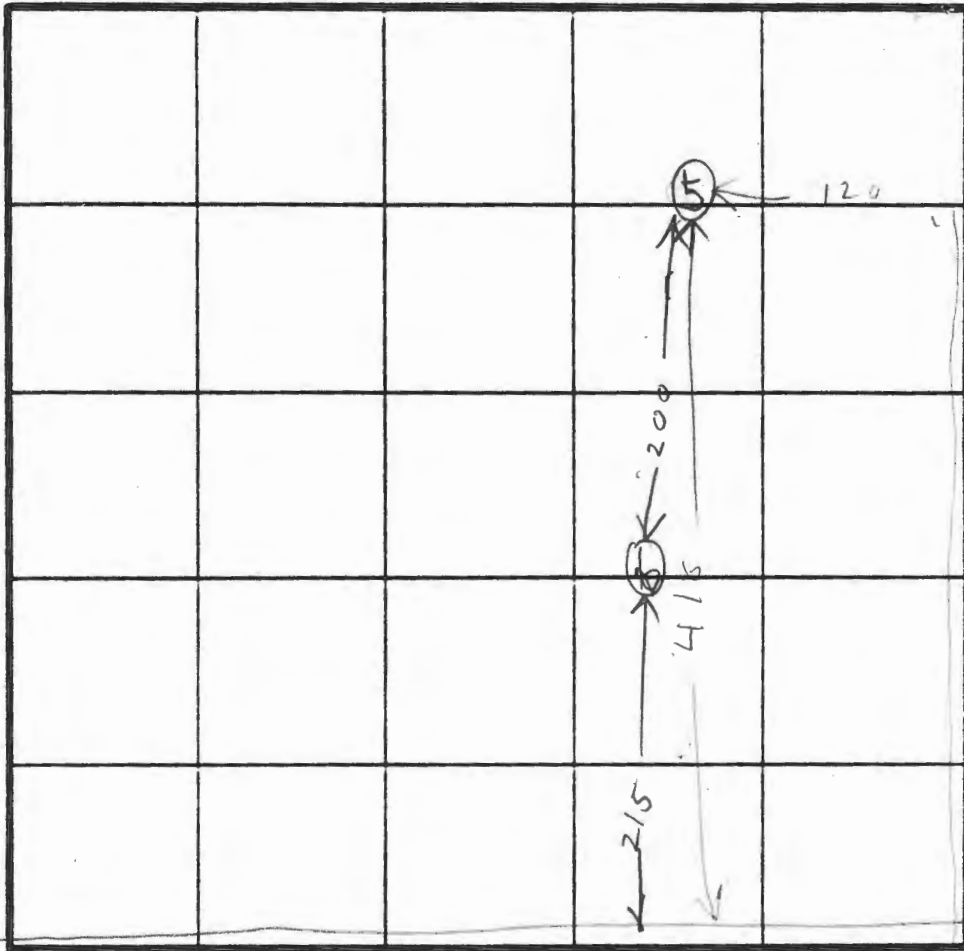

INDICATE NORTH - NAME ADJOINING ROADWAY AS BASE LINE.

*PATUXENT RANGE RD*

DATE	TEST NO.	DEPTH	PRE-WET		TEST - 1" DROP		TIME
			START	STOP	START	STOP	

REMARKS \_\_\_\_\_

TYPE OF SOIL \_\_\_\_\_

TESTED BY \_\_\_\_\_ ALSO PRESENT \_\_\_\_\_

*no*  
EH-T2 10/9

# APPLICATION

SEWAGE DISPOSAL TESTING

STATE OF MARYLAND - DEPARTMENT OF HEALTH AND MENTAL HYGIENE

HOWARD COUNTY HEALTH DEPARTMENT  
ENVIRONMENTAL HEALTH SERVICES

P. O. BOX 476 ELLICOTT CITY, MARYLAND 21043  
TELEPHONE: 992-2330

A 32628

P \_\_\_\_\_

DISTRICT 6

DATE 4/5/83

TO: THE COUNTY HEALTH OFFICER  
ELLICOTT CITY, MARYLAND

I, HEREBY, APPLY FOR THE NECESSARY TEST IN ORDER TO CONSTRUCT (OR RECONSTRUCT) A SEWAGE DISPOSAL SYSTEM.

PROPERTY OWNER BWIP Inc

ADDRESS 110 West Rd, Towson, Md 21204 PHONE 296-4400

PROPERTY LOCATION:

SUBDIVISION \_\_\_\_\_ LOT NO. C

ROAD AND DESCRIPTION \_\_\_\_\_

SIZE OF LOT \_\_\_\_\_ TYPE BLDG. \_\_\_\_\_ (NUMBER OF BEDROOMS)

THE SYSTEM INSTALLED UNDER THIS APPLICATION IS ACCEPTABLE ONLY UNTIL PUBLIC FACILITIES BECOME AVAILABLE. I FULLY UNDERSTAND THE FEE CONNECTED WITH THE FILING OF THIS PERC TEST APPLICATION IS NON-REFUNDABLE UNDER ANY CIRCUMSTANCES. I ALSO AGREE TO COMPLY WITH ALL M.O.S.H.A. REQUIREMENTS IN TESTING THIS LOT. \_\_\_\_\_

(SIGNATURE OF APPLICANT)

APPROVED BY \_\_\_\_\_ FOR \_\_\_\_\_ DATE \_\_\_\_\_

REJECTED BY \_\_\_\_\_ FOR \_\_\_\_\_ DATE \_\_\_\_\_

HOLD PENDING FURTHER TESTS \_\_\_\_\_ DATE \_\_\_\_\_

REASONS FOR REJECTION OR HOLDING \_\_\_\_\_

# THIS IS NOT A PERMIT

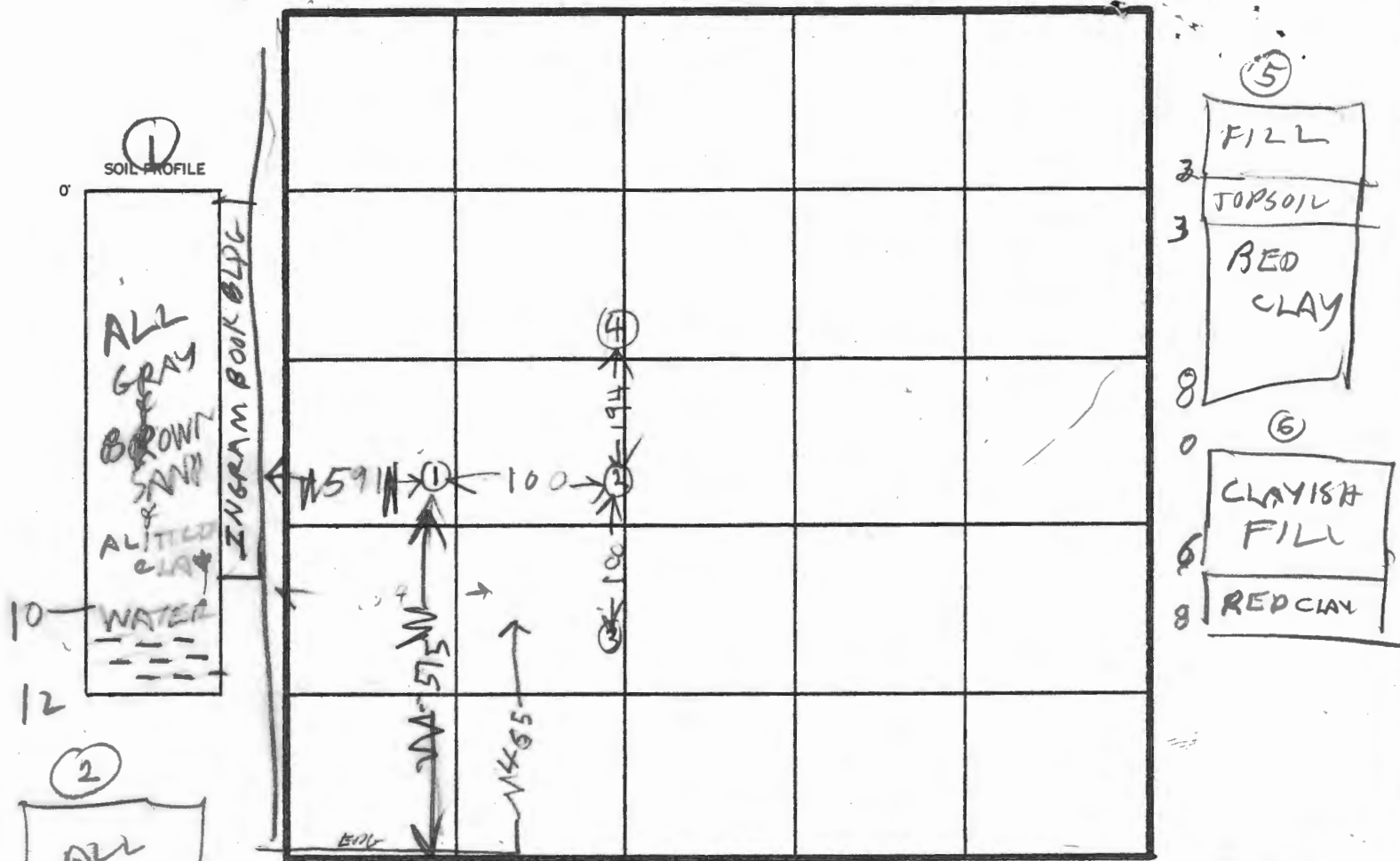

PATUXENT RANGE RD

JODORSON RUN RD

DATE	TEST NO.	DEPTH	PRE-WET		TEST - 1" DROP		TIME
			START	STOP	START	STOP	
5/1/83	1S	3"	1006	1016	1016	1025	9
	1V	12"	WATER		1017		
9	2S	2"	1022	1023	1023	1030	7
	2V	9"	WATER		8F7		
0	3V	7 1/2"	WATER				
	4V	6"	LOOKS BAD				
2 1/2	5V	8"	LOOKS BAD				
	6V	8"	LOOKS BAD				
3							
6							

REMARKS SEE PAGE 2 FOR HOLE ⑤ ⑥ LOCATION

TYPE OF SOIL

TESTED BY

R HODGES

ALSO PRESENT

# APPLICATION

HOWARD COUNTY HEALTH DEPARTMENT  
ENVIRONMENTAL HEALTH SERVICES

P. O. BOX 473 ELLICOTT CITY, MARYLAND 21043  
TELEPHONE: 992-2330

SEWAGE DISPOSAL TESTING

STATE OF MARYLAND - DEPARTMENT OF HEALTH AND MENTAL HYGIENE

A 32626

P \_\_\_\_\_

DISTRICT 6

DATE 4/5/83

TO: THE COUNTY HEALTH OFFICER  
ELLICOTT CITY, MARYLAND

I, HEREBY, APPLY FOR THE NECESSARY TEST IN ORDER TO CONSTRUCT (OR RECONSTRUCT) A SEWAGE DISPOSAL SYSTEM.

PROPERTY OWNER B.W. L.P. Inc

ADDRESS 110 West Rd Towson, Md. 21204 PHONE 296-6400

PROPERTY LOCATION:

SUBDIVISION Balto. Wash. Ind. Pl. LOT NO. A

ROAD AND DESCRIPTION S.W. cor. of Patuxent Range Rd

+ Dorsey Run Rd.

SIZE OF LOT 650' x 1500' ± TYPE BLDG. \_\_\_\_\_

(NUMBER OF BEDROOMS)

THE SYSTEM INSTALLED UNDER THIS APPLICATION IS ACCEPTABLE ONLY UNTIL PUBLIC FACILITIES BECOME AVAILABLE. I FULLY UNDERSTAND THE FEE CONNECTED WITH THE FILING OF THIS PERC TEST APPLICATION IS NON-REFUNDABLE UNDER ANY CIRCUMSTANCES. I ALSO AGREE TO COMPLY WITH ALL M.O.S.H.A. REQUIREMENTS IN TESTING THIS LOT.

(SIGNATURE OF APPLICANT)

APPROVED BY \_\_\_\_\_ FOR \_\_\_\_\_ DATE \_\_\_\_\_

REJECTED BY \_\_\_\_\_ FOR \_\_\_\_\_ DATE \_\_\_\_\_

HOLD PENDING FURTHER TESTS \_\_\_\_\_ DATE \_\_\_\_\_

REASONS FOR REJECTION OR HOLDING 4/20/83 BACKHOE NO SHOW RH

5/11/83 DIG MORE SLOW PERC & WATER

# THIS IS NOT A PERMIT

SOIL PROFILE

0'

INDICATE NORTH - NAME ADJOINING ROADWAY AS BASE LINE.

DATE	TEST NO.	DEPTH	PRE-WET		TEST - 1" DROP		TIME
			START	STOP	START	STOP	

REMARKS \_\_\_\_\_

TYPE OF SOIL \_\_\_\_\_

TESTED BY \_\_\_\_\_ ALSO PRESENT \_\_\_\_\_

EH 12 1079



# APPLICATION

SEWAGE DISPOSAL TESTING

STATE OF MARYLAND - DEPARTMENT OF HEALTH AND MENTAL HYGIENE

HOWARD COUNTY HEALTH DEPARTMENT  
ENVIRONMENTAL HEALTH SERVICES

P. O. BOX 476 ELLICOTT CITY, MARYLAND 21043  
TELEPHONE: 992-2330

A 32626

P \_\_\_\_\_

DISTRICT 6

DATE 4/5/83

TO: THE COUNTY HEALTH OFFICER  
ELLICOTT CITY, MARYLAND

I, HEREBY, APPLY FOR THE NECESSARY TEST IN ORDER TO CONSTRUCT (OR RECONSTRUCT) A SEWAGE DISPOSAL SYSTEM.

PROPERTY OWNER B W I P, Inc

ADDRESS 110 West Road, Towson, Md 21204 PHONE 296-6400

PROPERTY LOCATION:

SUBDIVISION \_\_\_\_\_ LOT NO. A

ROAD AND DESCRIPTION \_\_\_\_\_

SIZE OF LOT \_\_\_\_\_ TYPE BLDG. \_\_\_\_\_

(NUMBER OF BEDROOMS)

THE SYSTEM INSTALLED UNDER THIS APPLICATION IS ACCEPTABLE ONLY UNTIL PUBLIC FACILITIES BECOME AVAILABLE. I FULLY UNDERSTAND THE  
FEE CONNECTED WITH THE FILING OF THIS PERC TEST APPLICATION IS NON-REFUNDABLE UNDER ANY CIRCUMSTANCES. I ALSO AGREE TO COMPLY  
WITH ALL M.O.S.H.A. REQUIREMENTS IN TESTING THIS LOT. \_\_\_\_\_

(SIGNATURE OF APPLICANT)

APPROVED BY \_\_\_\_\_ FOR \_\_\_\_\_ DATE \_\_\_\_\_

REJECTED BY \_\_\_\_\_ FOR \_\_\_\_\_ DATE \_\_\_\_\_

HOLD PENDING FURTHER TESTS \_\_\_\_\_ DATE \_\_\_\_\_

REASONS FOR REJECTION OR HOLDING \_\_\_\_\_

## THIS IS NOT A PERMIT

5

RED  
GRAY  
BROWN  
CLAY

10 SAND  
12 CLAY

SOIL PROFILE

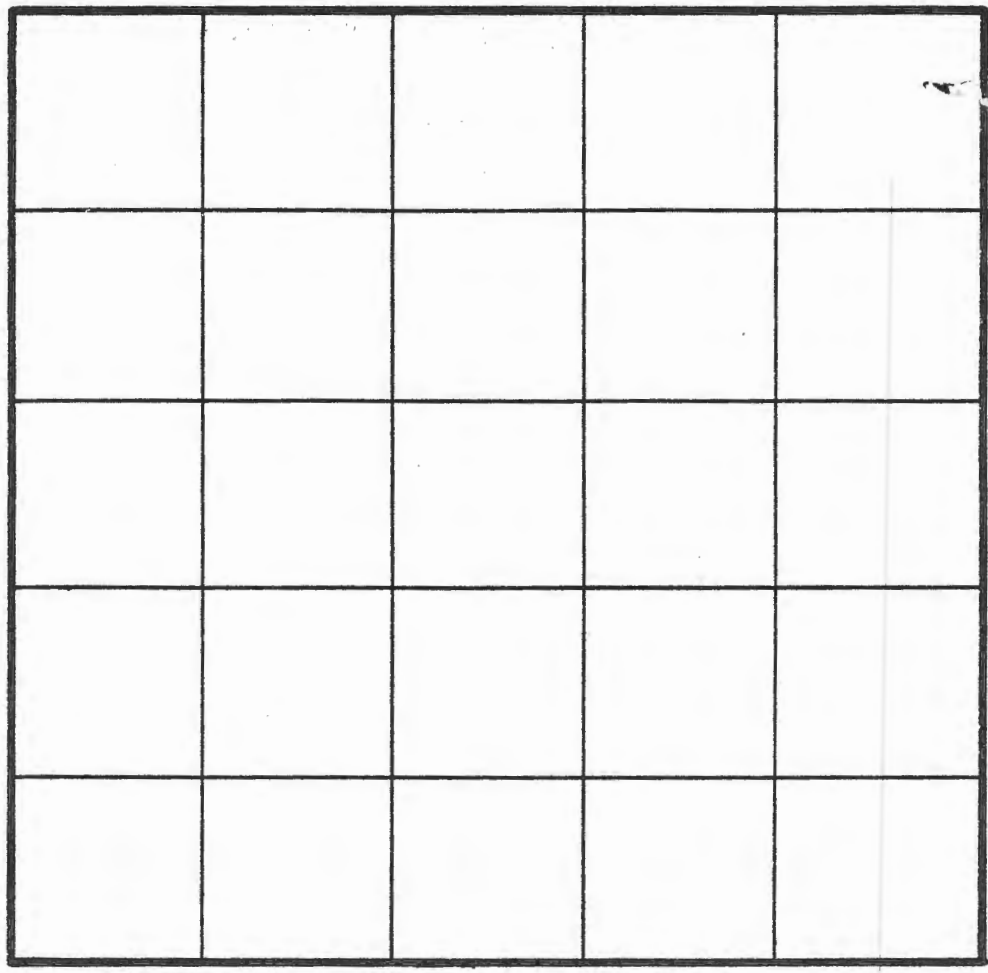

INDICATE NORTH - NAME ADJOINING ROADWAY AS BASE LINE.

TAN SAND

BLACK CLAY

WATER

CLAYISH  
FILL

BROWN  
CLAY

SANDY

DATE	TEST NO.	DEPTH	PRE-WET		TEST - 1" DROP		TIME
			START	STOP	START	STOP	
5/11/83	1V	5	ALL CLAY & FILL				
5/11/82	2V	10	LOOKS UNSATISFACTORY				
	3V	7 1/2	WATER 9 1/2 FT				
	4V	11	CLAY IS 4 FT ? UNSATISFACTORY				
	5V	12	LOOKS UNSATISFACTORY				

REMARKS

5/10/83 SURVEY OR WILL LOCATE ABOVE 5 UNSATISFACTORY  
HOLES LATER

TYPE OF SOIL

TESTED BY

Raymond Hodge

ALSO PRESENT

EH-12-1079





BALTIMORE WASHINGTON  
INDUSTRIAL PARK  
SALES PLAT  
THE ARUNDEL CORPORATION  
BALTIMORE, MD.

SCALE: 1"=200'	DRAWN: J.P.C.
DATE: 5-15-77	TRACED: H.B.
REV: 5/17/77, 6/29/79	CHECKED: D.S.K.
10/1/79, 5/1/80	APPROVED: D.S.K.

NOTE:  
PARCELS SOLD OR OCCUPIED SHOWN THUS: [Hatched Box] - 151.262 AC  
PARCELS RECORDED SHOWN THUS: [Solid Box] - 18.971 AC  
PARCELS FOR FUTURE DEVELOPMENT SHOWN ONLY - 66.406 AC

246.639 AC ± TOTAL NET SALEABLE AREA  
274.879 AC ± GROSS AREA OF TRACT