

MCB 8/19/19

Search Result for HOWARD COUNTY

View Map		View GroundRent Redemption		View GroundRent Registration	
Tax Exempt:		Special Tax Recapture:			
Exempt Class:		NONE			
Account Identifier:		District - 06 Account Number - 421741			
Owner Information					
Owner Name:	AMB SHERWICK LLC C/O PROLOGIS		Use:	INDUSTRIAL	
Mailing Address:	1800 WAZEE ST ATTN: TAX COORDINATOR DENVER CO 80202-		Principal Residence:	NO	
			Deed Reference:	/10640/ 00547	
Location & Structure Information					
Premises Address:		8301 SHERWICK CT JESSUP 20794-0000		Legal Description:	PAR E BL E 4.340 A 8301 SHERWICK CT BWIP ANNAPOLIS JT
Map:	Grid:	Parcel:	Sub District:	Subdivision:	Section:
0048	0002	0149		0000	
					Block:
					PAR E
					Lot:
					2020
					Assessment Year:
					Plat No:
					Plat Ref:
Special Tax Areas:			Town:		
			NONE		
			Ad Valorem:		
			104		
			Tax Class:		
Primary Structure Built		Above Grade Living Area		Finished Basement Area	
1974		75,000 SF		4.3400 AC	
Property Land Area		County Use			
4.3400 AC					
Stories	Basement	Type	Exterior	Full/Half Bath	Garage
		DISTRIBUTION WAREHOUSE			
Value Information					
Base Value		Value		Phase-in Assessments	
		As of		As of	
		01/01/2017		07/01/2019	
				As of	
				07/01/2020	
Land:	945,200	945,200			
Improvements	2,700,000	2,700,000			
Total:	3,645,200	3,645,200		3,645,200	
Preferential Land:	0				
Transfer Information					
Seller: REALTY ASSOC FUND V LP THE		Date: 04/20/2007		Price: \$5,958,956	
Type: ARMS LENGTH IMPROVED		Deed1: /10640/ 00547		Deed2:	
Seller: RREEF MIDAMERICA EAST V SEVEN INC		Date: 10/18/1999		Price: \$6,250,000	
Type: ARMS LENGTH MULTIPLE		Deed1: /04914/ 00004		Deed2:	
Seller: ROUSE AND ASSOCIATES		Date: 12/23/1988		Price: \$2,385,000	
Type: ARMS LENGTH IMPROVED		Deed1: /01933/ 00453		Deed2:	
Exemption Information					
Partial Exempt Assessments:		Class		07/01/2019	
County:		000		0.00	
State:		000		0.00	
Municipal:		000		0.00	
Tax Exempt:		Special Tax Recapture:			
Exempt Class:		NONE			
Homestead Application Information					
Homestead Application Status: No Application					

Homeowners' Tax Credit Application Status: No Application

Date:

1. This screen allows you to search the Real Property database and display property records.
2. Click **here** for a glossary of terms.
3. Deleted accounts can only be selected by Property Account Identifier.
4. The following pages are for information purpose only. The data is not to be used for legal reports or documents. While we have confidence in the accuracy of these records, the Department makes no warranties, expressed or implied, regarding the information.

APPLICATION

SEWAGE DISPOSAL TESTING

STATE OF MARYLAND - DEPARTMENT OF HEALTH AND MENTAL HYGIENE

HOWARD COUNTY HEALTH DEPARTMENT
ENVIRONMENTAL HEALTH SERVICES

P. O. BOX 473 ELLICOTT CITY, MARYLAND 21043
TELEPHONE: 992-2330

A 32627

P _____

DISTRICT 6

DATE 4/5/83

TO: THE COUNTY HEALTH OFFICER
ELLICOTT CITY, MARYLAND

I, HEREBY, APPLY FOR THE NECESSARY TEST IN ORDER TO CONSTRUCT (OR RECONSTRUCT) A SEWAGE DISPOSAL SYSTEM.

PROPERTY OWNER B.W.I.P. Inc.

ADDRESS 110 West Rd Towson, Md 21204 PHONE 296-6400

PROPERTY LOCATION:

SUBDIVISION Balto Wash Ind Pk LOT NO. B

ROAD AND DESCRIPTION North side of Patuxent Range Rd
650' West of Dorsey Run Rd

SIZE OF LOT 500' x 1110' TYPE BLDG. _____ (NUMBER OF BEDROOMS)

THE SYSTEM INSTALLED UNDER THIS APPLICATION IS ACCEPTABLE ONLY UNTIL PUBLIC FACILITIES BECOME AVAILABLE. I FULLY UNDERSTAND THE FEE CONNECTED WITH THE FILING OF THIS PERC TEST APPLICATION IS NON-REFUNDABLE UNDER ANY CIRCUMSTANCES. I ALSO AGREE TO COMPLY WITH ALL M.O.S.H.A. REQUIREMENTS IN TESTING THIS LOT.

(SIGNATURE OF APPLICANT)

APPROVED BY _____ FOR _____ DATE _____

REJECTED BY _____ FOR _____ DATE _____

HOLD PENDING FURTHER TESTS _____ DATE _____

REASONS FOR REJECTION OR HOLDING 11 MAY 83 PERC OK HOLD FOR PERC
CERT PLAT R/H FS SAID PUMP OK TO CSD
FOR SEPT 12

THIS IS NOT A PERMIT

SOIL PROFILE

0'

INDICATE NORTH - NAME ADJOINING ROADWAY AS BASE LINE.

DATE	TEST NO.	DEPTH	PRE-WET		TEST - 1" DROP		TIME
			START	STOP	START	STOP	

REMARKS _____

TYPE OF SOIL _____

TESTED BY _____ ALSO PRESENT _____

EH 12 10/9

APPLICATION

SEWAGE DISPOSAL TESTING

STATE OF MARYLAND - DEPARTMENT OF HEALTH AND MENTAL HYGIENE

HOWARD COUNTY HEALTH DEPARTMENT
ENVIRONMENTAL HEALTH SERVICES

P. O. BOX 476 ELLICOTT CITY, MARYLAND 21043
TELEPHONE: 992-2330

A 32627

P _____

DISTRICT 6th

DATE 4/5/83

TO: THE COUNTY HEALTH OFFICER
ELLICOTT CITY, MARYLAND

I, HEREBY, APPLY FOR THE NECESSARY TEST IN ORDER TO CONSTRUCT (OR RECONSTRUCT) A SEWAGE DISPOSAL SYSTEM.

PROPERTY OWNER BWIP

ADDRESS 110 West Road, Towson, Md PHONE 296-6408

PROPERTY LOCATION:

SUBDIVISION _____ LOT NO. B.

ROAD AND DESCRIPTION _____

SIZE OF LOT _____ TYPE BLDG. _____
(NUMBER OF BEDROOMS)

THE SYSTEM INSTALLED UNDER THIS APPLICATION IS ACCEPTABLE ONLY UNTIL PUBLIC FACILITIES BECOME AVAILABLE. I FULLY UNDERSTAND THE
FEE CONNECTED WITH THE FILING OF THIS PERC TEST APPLICATION IS NON-REFUNDABLE UNDER ANY CIRCUMSTANCES. I ALSO AGREE TO COMPLY
WITH ALL M.O.S.H.A. REQUIREMENTS IN TESTING THIS LOT. _____

(SIGNATURE OF APPLICANT)

APPROVED BY _____ FOR _____ DATE _____

REJECTED BY _____ FOR _____ DATE _____

HOLD PENDING FURTHER TESTS _____ DATE _____

REASONS FOR REJECTION OR HOLDING _____

THIS IS NOT A PERMIT

③

SOIL PROFILE

RED CLAY WITH STRAIL

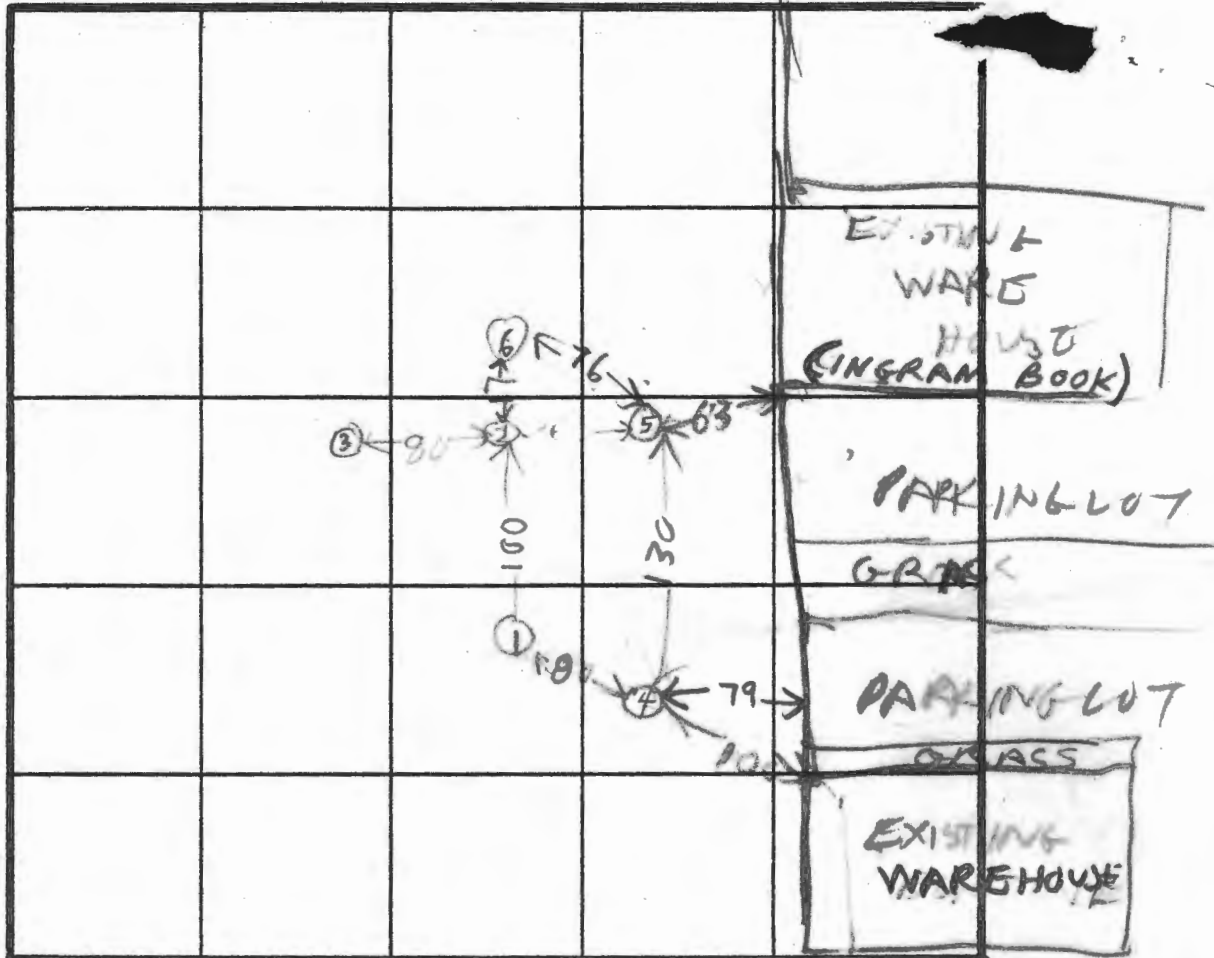

INDICATE NORTH - NAME ADJOINING ROADWAY AS BASE LINE.

PARK LOT

④
CLAY SAND FILL MIX

BROWN CLAY SAND MIX

DATE	TEST NO.	DEPTH	PRE-WET		TEST - 1" DROP		TIME
			START	STOP	START	STOP	
5/11/03	1 S	3	1019	1022	1022	1025	5
	1 V	11	LOOKS OK	OK	ALL SAND		
	2 S	3	1033	1033 1/2	1033 1/2	1034	1/2
	2 V	11	LOOKS OK	OK	ALL SAND		
	3 V	9					
	4 S	4	1122	1123	1123	1125	2
	4 P	7 1/2	1201	1202	1202	1204	2
	4 V	12	LOOKS OK	OK			
	5 S	3	120	121	121	122	1
	3 V	11	LOOKS OK	OK	ALL SAND		
5/11/03	6 V	11	ALL SAND	LOOKS OK			

HOLE ELEVATION
A
(54) HIGH
(126) LOW

REMARKS CITY WATER LOT ALMOST LEVEL

TYPE OF SOIL LOT NOT STAKED NEAR BY BUILDING USE

TESTED BY R. HODGES

ALSO PRESENT SIM, LEE RON DIGGERS
BUD ROESNER SURVEYOR

APPLICATION

SEWAGE DISPOSAL TESTING

STATE OF MARYLAND - DEPARTMENT OF HEALTH AND MENTAL HYGIENE

HOWARD COUNTY HEALTH DEPARTMENT
ENVIRONMENTAL HEALTH SERVICES

P. O. BOX 473 ELLICOTT CITY, MARYLAND 21043
TELEPHONE: 992-2330

A 32628

P _____

DISTRICT 6

DATE 4/5/83

TO: THE COUNTY HEALTH OFFICER
ELLICOTT CITY, MARYLAND

I, HEREBY, APPLY FOR THE NECESSARY TEST IN ORDER TO CONSTRUCT (OR RECONSTRUCT) A SEWAGE DISPOSAL SYSTEM.

PROPERTY OWNER BALP Inc

ADDRESS 110 West Rd Towson, Md 21204 PHONE 296-6400

PROPERTY LOCATION:

SUBDIVISION Balto. Wash-Ind. Pl. LOT NO. 6

ROAD AND DESCRIPTION N.W. cor. of Patuxent Range Rd

SIZE OF LOT 550' x 950' ± TYPE BLDG. 2 (NUMBER OF BEDROOMS)

THE SYSTEM INSTALLED UNDER THIS APPLICATION IS ACCEPTABLE ONLY UNTIL PUBLIC FACILITIES BECOME AVAILABLE. I FULLY UNDERSTAND THE FEE CONNECTED WITH THE FILING OF THIS PERC TEST APPLICATION IS NON-REFUNDABLE UNDER ANY CIRCUMSTANCES. I ALSO AGREE TO COMPLY WITH ALL M.O.S.H.A. REQUIREMENTS IN TESTING THIS LOT.

(SIGNATURE OF APPLICANT)

APPROVED BY _____ FOR _____ DATE _____

REJECTED BY _____ FOR _____ DATE _____

HOLD PENDING FURTHER TESTS _____ DATE _____

REASONS FOR REJECTION OR HOLDING 13 MAY 83 - Dig more SLOW PERC SOIL & WATER

H.S. SAID OK TO USE A PUMP FOR SEPTIC

SYSTEM

THIS IS NOT A PERMIT

SOIL PROFILE

0'

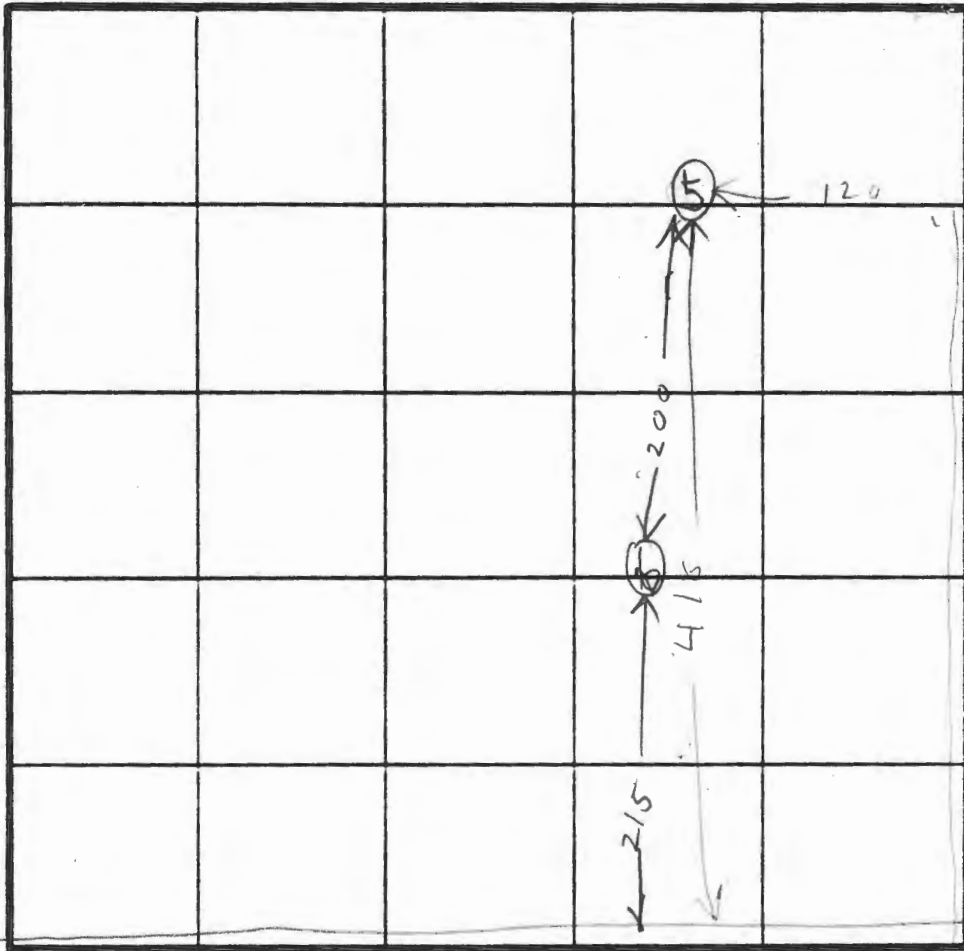

POORSEY RUN RD

INDICATE NORTH - NAME ADJOINING ROADWAY AS BASE LINE.

PATUXENT RANGE RD

DATE	TEST NO.	DEPTH	PRE-WET		TEST - 1" DROP		TIME
			START	STOP	START	STOP	

REMARKS _____

TYPE OF SOIL _____

TESTED BY _____ ALSO PRESENT _____

no
EH-T2 10/9

APPLICATION

SEWAGE DISPOSAL TESTING

STATE OF MARYLAND - DEPARTMENT OF HEALTH AND MENTAL HYGIENE

HOWARD COUNTY HEALTH DEPARTMENT
ENVIRONMENTAL HEALTH SERVICES

P. O. BOX 476 ELLICOTT CITY, MARYLAND 21043
TELEPHONE: 992-2330

A 32628

P _____

DISTRICT 6

DATE 4/5/83

TO: THE COUNTY HEALTH OFFICER
ELLICOTT CITY, MARYLAND

I, HEREBY, APPLY FOR THE NECESSARY TEST IN ORDER TO CONSTRUCT (OR RECONSTRUCT) A SEWAGE DISPOSAL SYSTEM.

PROPERTY OWNER BWIP Inc

ADDRESS 110 West Rd, Towson, Md 21204 PHONE 296-6400

PROPERTY LOCATION:

SUBDIVISION _____ LOT NO. C

ROAD AND DESCRIPTION _____

SIZE OF LOT _____ TYPE BLDG. _____ (NUMBER OF BEDROOMS)

THE SYSTEM INSTALLED UNDER THIS APPLICATION IS ACCEPTABLE ONLY UNTIL PUBLIC FACILITIES BECOME AVAILABLE. I FULLY UNDERSTAND THE FEE CONNECTED WITH THE FILING OF THIS PERC TEST APPLICATION IS NON-REFUNDABLE UNDER ANY CIRCUMSTANCES. I ALSO AGREE TO COMPLY WITH ALL M.O.S.H.A. REQUIREMENTS IN TESTING THIS LOT. _____

(SIGNATURE OF APPLICANT)

APPROVED BY _____ FOR _____ DATE _____

REJECTED BY _____ FOR _____ DATE _____

HOLD PENDING FURTHER TESTS _____ DATE _____

REASONS FOR REJECTION OR HOLDING _____

THIS IS NOT A PERMIT

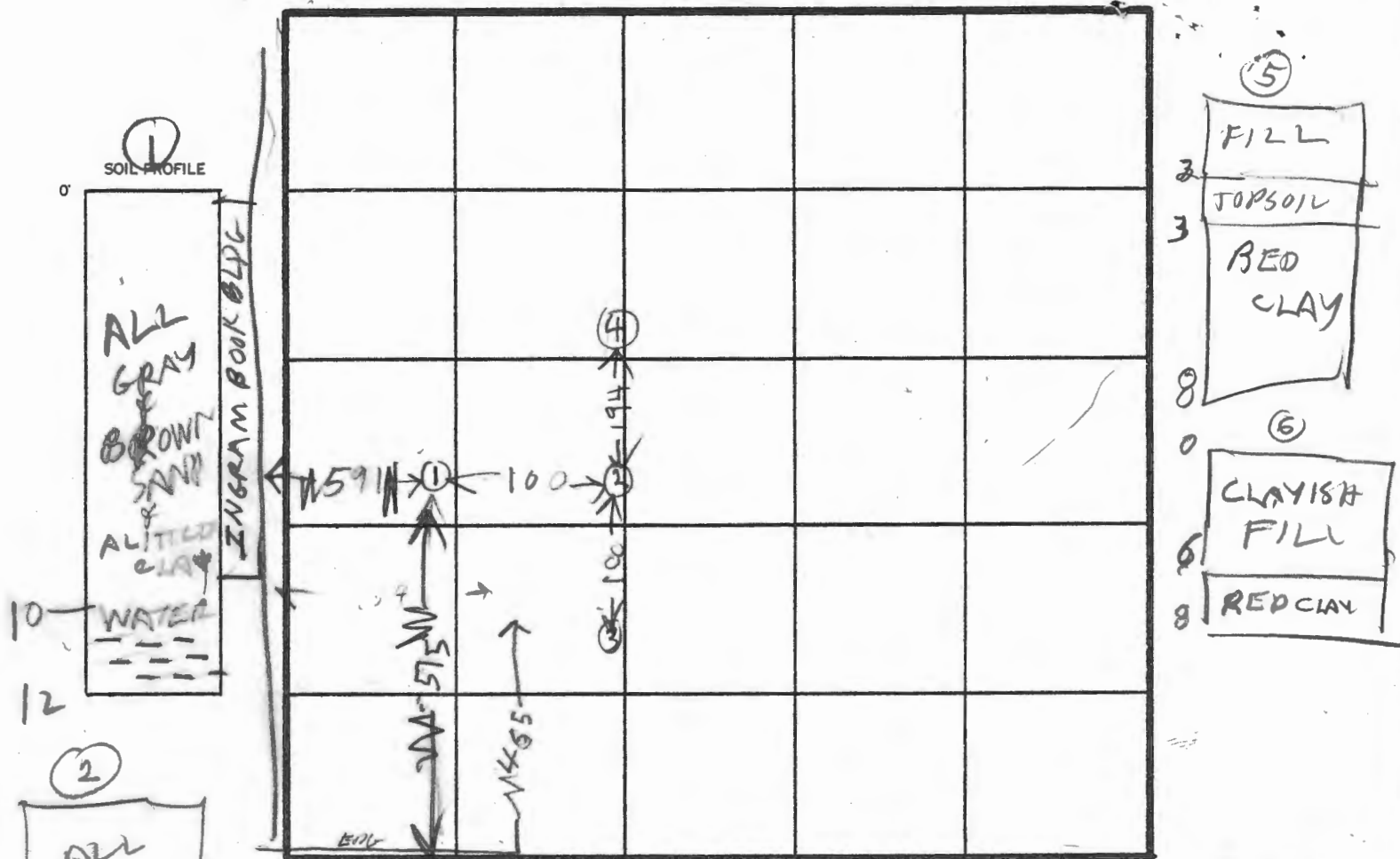

INDICATE NORTH - NAME ADJOINING ROADWAY AS BASE LINE.

PATUXENT RANGE RD

JODORSON RUN RD

DATE	TEST NO.	DEPTH	PRE-WET		TEST - 1" DROP		TIME
			START	STOP	START	STOP	
5/1/83	1S	3"	1006	1016	1016	1025	9
	1V	12"	WATER		1017		
9	2S	2"	1022	1023	1023	1030	7
	2V	9"	WATER		8F7		
0	3V	7 1/2"	WATER				
	4V	6"	LOOKS BAD				
2	5V	8"	LOOKS BAD				
	6V	8"	LOOKS BAD				
7 1/2							
9							
12							
15							
18							
21							

REMARKS SEE PAGE 2 FOR HOLE ⑤ ⑥ LOCATION

TYPE OF SOIL

TESTED BY

R HODGES

ALSO PRESENT

APPLICATION

HOWARD COUNTY HEALTH DEPARTMENT
ENVIRONMENTAL HEALTH SERVICES

P. O. BOX 473 ELLICOTT CITY, MARYLAND 21043
TELEPHONE: 992-2330

SEWAGE DISPOSAL TESTING

STATE OF MARYLAND - DEPARTMENT OF HEALTH AND MENTAL HYGIENE

A 32626

P _____

DISTRICT 6

DATE 4/5/83

TO: THE COUNTY HEALTH OFFICER
ELLICOTT CITY, MARYLAND

I, HEREBY, APPLY FOR THE NECESSARY TEST IN ORDER TO CONSTRUCT (OR RECONSTRUCT) A SEWAGE DISPOSAL SYSTEM.

PROPERTY OWNER B.W. L.P. Inc

ADDRESS 110 West Rd Towson, Md. 21204 PHONE 296-6400

PROPERTY LOCATION:

SUBDIVISION Balto. Wash. Ind. Pl. LOT NO. A

ROAD AND DESCRIPTION S.W. cor. of Patuxent Range Rd

+ Dorsey Run Rd.

SIZE OF LOT 650' x 1500' ± TYPE BLDG. _____

(NUMBER OF BEDROOMS)

THE SYSTEM INSTALLED UNDER THIS APPLICATION IS ACCEPTABLE ONLY UNTIL PUBLIC FACILITIES BECOME AVAILABLE. I FULLY UNDERSTAND THE FEE CONNECTED WITH THE FILING OF THIS PERC TEST APPLICATION IS NON-REFUNDABLE UNDER ANY CIRCUMSTANCES. I ALSO AGREE TO COMPLY WITH ALL M.O.S.H.A. REQUIREMENTS IN TESTING THIS LOT.

(SIGNATURE OF APPLICANT)

APPROVED BY _____ FOR _____ DATE _____

REJECTED BY _____ FOR _____ DATE _____

HOLD PENDING FURTHER TESTS _____ DATE _____

REASONS FOR REJECTION OR HOLDING 4/20/83 BACKHOE NO SHOW RH

5/11/83 DIG MORE SLOW PERC & WATER

THIS IS NOT A PERMIT

SOIL PROFILE

0'

INDICATE NORTH - NAME ADJOINING ROADWAY AS BASE LINE.

DATE	TEST NO.	DEPTH	PRE-WET		TEST - 1" DROP		TIME
			START	STOP	START	STOP	

REMARKS _____

TYPE OF SOIL _____

TESTED BY _____ ALSO PRESENT _____

EH 12 1079

APPLICATION

SEWAGE DISPOSAL TESTING

STATE OF MARYLAND - DEPARTMENT OF HEALTH AND MENTAL HYGIENE

HOWARD COUNTY HEALTH DEPARTMENT
ENVIRONMENTAL HEALTH SERVICES

P. O. BOX 476 ELLICOTT CITY, MARYLAND 21043
TELEPHONE: 992-2330

A 32626

P _____

DISTRICT 6

DATE 4/5/83

TO: THE COUNTY HEALTH OFFICER
ELLICOTT CITY, MARYLAND

I, HEREBY, APPLY FOR THE NECESSARY TEST IN ORDER TO CONSTRUCT (OR RECONSTRUCT) A SEWAGE DISPOSAL SYSTEM.

PROPERTY OWNER B W I P, Inc

ADDRESS 110 West Road, Towson, Md 21204 PHONE 296-6400

PROPERTY LOCATION:

SUBDIVISION _____ LOT NO. A

ROAD AND DESCRIPTION _____

SIZE OF LOT _____ TYPE BLDG. _____ (NUMBER OF BEDROOMS)

THE SYSTEM INSTALLED UNDER THIS APPLICATION IS ACCEPTABLE ONLY UNTIL PUBLIC FACILITIES BECOME AVAILABLE. I FULLY UNDERSTAND THE FEE CONNECTED WITH THE FILING OF THIS PERC TEST APPLICATION IS NON-REFUNDABLE UNDER ANY CIRCUMSTANCES. I ALSO AGREE TO COMPLY WITH ALL M.O.S.H.A. REQUIREMENTS IN TESTING THIS LOT. _____

(SIGNATURE OF APPLICANT)

APPROVED BY _____ FOR _____ DATE _____

REJECTED BY _____ FOR _____ DATE _____

HOLD PENDING FURTHER TESTS _____ DATE _____

REASONS FOR REJECTION OR HOLDING _____

THIS IS NOT A PERMIT

5

RED
GRAY
BROWN
CLAY

10 SAND
12 CLAY

SOIL PROFILE

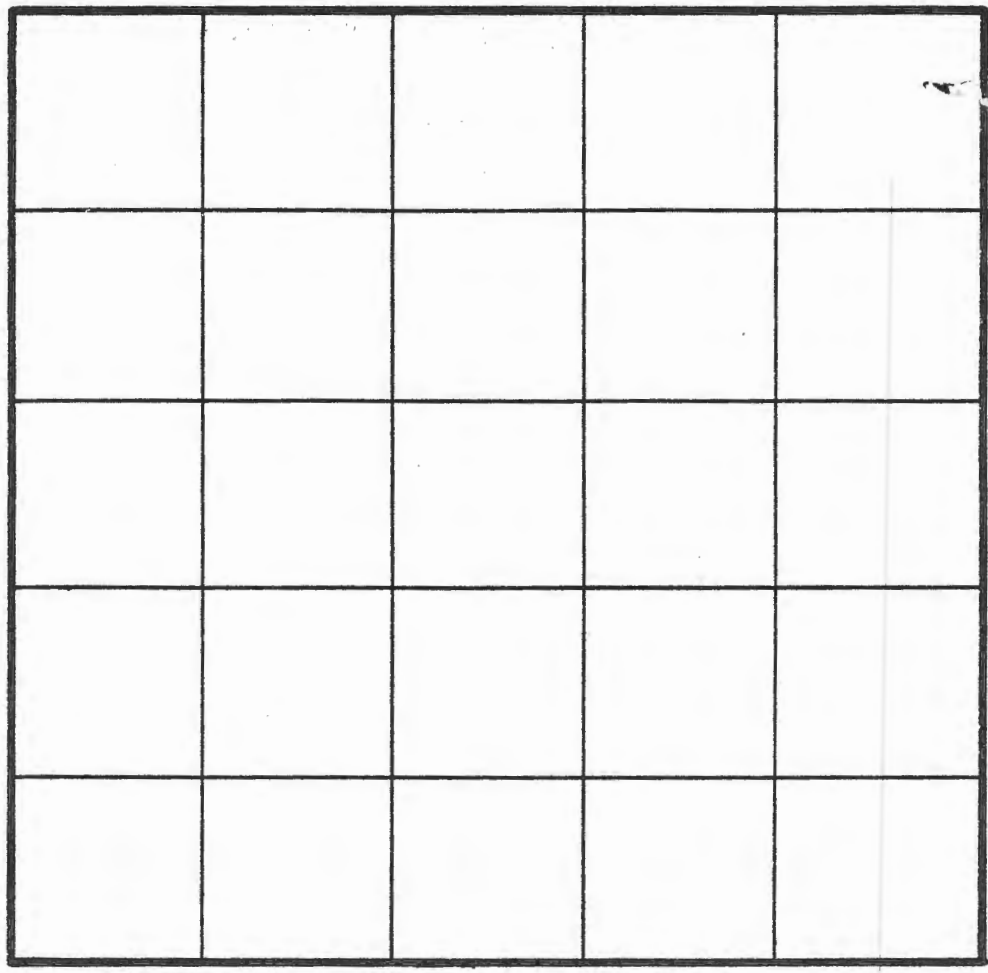

INDICATE NORTH - NAME ADJOINING ROADWAY AS BASE LINE.

TAN SAND

BLACK CLAY

WATER

CLAYISH FILL

BROWN CLAY

SANDY

DATE	TEST NO.	DEPTH	PRE-WET		TEST - 1" DROP		TIME	
			START	STOP	START	STOP		
5/11/83	1V	5	ALL CLAY & FILL					
5/11/82	2V	10	LOOKS UNSATISFACTORY					
	3V	7 1/2	WATER 9 1/2 FT CLAY IS 4 FT UNSATISFACTORY					
	4V	11	LOOKS UNSATISFACTORY					
	5V	12	LOOKS UNSATISFACTORY					

REMARKS

5/10/83 SURVEY OR WILL LOCATE ABOVE 5 UNSATISFACTORY HOLES LATER

TYPE OF SOIL

TESTED BY

Raymond Hodge

ALSO PRESENT

EH-12-1079



BALTIMORE WASHINGTON
INDUSTRIAL PARK
SALES PLAT
THE ARUNDEL CORPORATION
BALTIMORE, MD.

SCALE: 1"=200'	DRAWN: J.P.C.
DATE: 5-15-77	TRACED: H.B.
REV: 5/17/77, 6/29/79	CHECKED: D.S.K.
10/1/79, 5/1/80	APPROVED: D.S.K.

NOTE:
PARCELS SOLD OR OCCUPIED SHOWN THUS: [Hatched Box] - 151.262 AC
PARCELS RECORDED SHOWN THUS: [Solid Box] - 18.971 AC
PARCELS FOR FUTURE DEVELOPMENT SHOWN ONLY - [Dotted Box] - 66.406 AC

246.639 AC ± TOTAL NET SALABLE AREA
274.879 AC ± GROSS AREA OF TRACT