

APPLICATION

FOR PERCOLATION TESTING AND SITE EVALUATION

TEST DATE(S) _____ TEST TIME _____

AP 529566-A

AGENCY REVIEW: _____

DATE 9/15/08

DO NOT WRITE ABOVE THIS LINE

I HEREBY APPLY FOR THE NECESSARY TESTING/EVALUATION PRIOR TO ISSUANCE OF SEWAGE DISPOSAL SYSTEM PERMIT(S) TO:

CHECK AS NEEDED:

- ☐ CONSTRUCT NEW SEPTIC SYSTEM(S)
- ☐ REPAIR/ADD TO AN EXISTING SEPTIC SYSTEM
- ☐ REPLACE AN EXISTING SEPTIC SYSTEM

CHECK AS NEEDED:

- ☐ NEW STRUCTURE(S)
- ☐ ADDITION TO AN EXISTING STRUCTURE
- ☐ REPLACE AN EXISTING STRUCTURE

CHECK ONE:

- ☐ CREATE NEW LOT(S)
- ☐ BUILD ON AN EXISTING LOT IN A SUBDIVISION
- ☐ BUILD ON AN EXISTING PARCEL OF RECORD

IS THE PROPERTY WITHIN 2500' OF ANY RESERVOIR?

- ☐ YES
- ☐ NO

THE TYPE OF STRUCTURE IS:

- ☒ RESIDENTIAL WITH UNKNOWN PROPOSED BEDROOMS IN THE COMPLETED STRUCTURE (NOTE UNKNOWN IF APPROPRIATE)
- ☐ COMMERCIAL (PROVIDE DETAIL OF NUMBERS AND TYPES OF EMPLOYEES/ CUSTOMERS ON ACCOMPANYING PLAN)
- ☐ INSTITUTIONAL/GOVERNMENT (PROVIDE DETAIL OF NUMBERS AND TYPES OF EMPLOYEES/USERS ON ACCOMPANYING PLAN)

PROPERTY OWNER(S) GEORGE BOARMAN & TERESA BOARMAN

DAYTIME PHONE 301-854-2883 CELL 410-707-1976 FAX 301-854-0435

MAILING ADDRESS 12126 MARYLAND ROUTE 216 FULTON MARYLAND 20759
STREET CITY/TOWN STATE ZIP

APPLICANT GEORGE BOARMAN

DAYTIME PHONE 301-854-2883 CELL 410-707-1976 FAX 301-854-0435

MAILING ADDRESS 12126 MARYLAND ROUTE 216 FULTON MARYLAND 20759
STREET CITY/TOWN STATE ZIP

APPLICANT'S ROLE: DEVELOPER BUILDER BUYER RELATIVE/FRIEND REALTOR CONSULTANT

PROPERTY LOCATION
SUBDIVISION/PROPERTY NAME EAST SIDE OF MARYLAND ROUTE 32 OPPOSITE BURNINGWOOD ROAD LOT NO. 1

PROPERTY ADDRESS ANDREA DRIVE WEST FRIENDSHIP
STREET TOWN/POST OFFICE

TAX MAP PAGE(S) 22 GRID 8 PARCEL(S) 116 PROPOSED LOT SIZE 49,558'

AS APPLICANT, I UNDERSTAND THE FOLLOWING: THE SYSTEM INSTALLED SUBSEQUENT TO THIS APPLICATION IS ACCEPTABLE ONLY UNTIL PUBLIC SEWERAGE IS AVAILABLE. THIS APPLICATION IS COMPLETE WHEN ALL APPLICABLE FEES AND A SUITABLE SITE PLAN HAVE BEEN RECEIVED. I ACCEPT THE RESPONSIBILITY FOR COMPLIANCE WITH ALL M.O.S.H.A. AND "MISS UTILITY" REQUIREMENTS. APPROVAL IS BASED UPON SATISFACTORY REVIEW OF A PERC CERTIFICATION PLAN.

TEST RESULTS WILL BE MAILED TO APPLICANT.

George L Boorman
SIGNATURE OF APPLICANT

HOWARD COUNTY HEALTH DEPARTMENT, BUREAU OF ENVIRONMENTAL HEALTH, WELL AND SEPTIC PROGRAM
7178 COLUMBIA GATEWAY DRIVE COLUMBIA, MARYLAND 21046 (410) 313-2640 FAX (410) 313-2648
TDD (410) 313-2323 TOLL FREE 1-877-4MD-DHMH

A/P _____

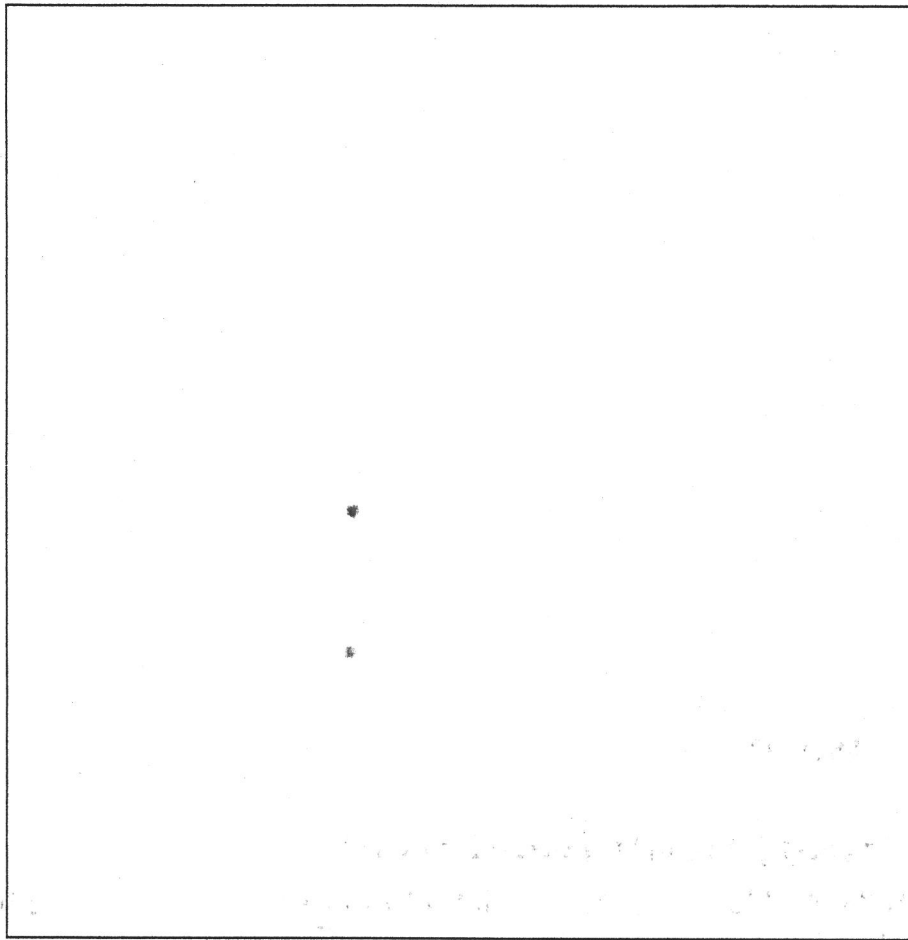

DATE	TEST #	DEPTH	START	BREAK 1" DROP	STOP 2" DROP	TIME OF 2ND INCH	P/F/H

REMARKS _____

SANITARIAN _____ BACKHOE _____ OTHERS _____

TEST HOLES USED IN SDA _____ AVG. PERC TIME _____ SQ. FT/BR _____

TRENCH WIDTH _____ INLET DEPTH _____ MAX. BOT DEPTH _____ EFFECTIVE SW _____

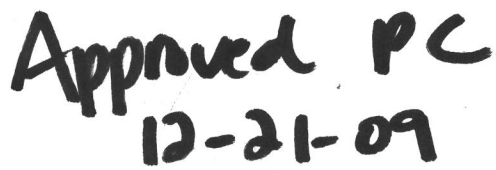

Approved PC
12-21-09

**FISHER, COLLINS
& CARTER, INC.**

**CIVIL ENGINEERING CONSULTANTS
and LAND SURVEYORS**

Transmittal

Terrell A. Fisher, P.E., L.S.
Earl D. Collins, P.E.
Charles J. Crovo, Sr., P.E., L.S.

Paul W. Kriebel, P.E.
Mark L. Robel, P.L.S.
Aldo M. Vitucci, P.E.
Frank Manalansan II, L.S.
Stephanie Tuite, RLA, P.E., LEED AP BD&C

Via: ☐ Fax ☐ Mail ☒ Messenger ☐ E-Mail ☐ To Be Picked Up
☐ Fax (original to follow via U.S. Mail)

To: **Howard County Health Department
Well and Septic Program**

Attn: **Mr. Jeff**

Fax:

Phone:

From: **Tony Fertitta**

CC:

Re: **Belvedere Estates Lot 1**

W.O.# **71160**

Date: **November 25, 2008**

Pages: **2** Page(s) Including this cover

We are forwarding: ☒ Prints ☐ Copy of Letter ☐ Specifications ☐ Shop drawings ☒ Other
☐ Urgent ☒ For your use ☐ As requested ☒ For Review & Comment

Remarks:

Dear Mr. Williams:

Attached, please find the following for your review:

- 1. One (1) original mylar of the Amended Percolation Certification Plan.**
- 2. Two (2) prints of the Amended Percolation Certification Plan.**
- 3. One (1) copy of your review comments.**

Should you have questions, or require additional information, please contact this office at 410-461-2855.

Very truly yours,

Tony

CONFIDENTIALITY NOTICE

This transmission contains confidential information which may be legally privileged, and is intended only for the use of the individual named above. If you are not the intended recipient, you are hereby notified that any distribution (except to the intended recipient), copying, or disclosure of this transmission is strictly prohibited.

Transmittal

Via: ☐ Fax ☐ Mail ☒ Messenger ☐ E-Mail ☐ To Be Picked Up
☐ Fax (original to follow via U.S. Mail)

To: **Howard County Health Department**
Well and Septic Program

Attn: **Hank Oswald**

Fax:

Phone:

From: **Tony Fertitta**

CC:

Re: **Belvedere Estates Lot 1**

W.O.# **71160**

Date: **March 13, 2019**

Pages: **2** **Page(s) Including this cover**

We are forwarding: ☒ Prints ☐ Copy of Letter ☐ Specifications ☐ Shop drawings ☒ Other
☐ Urgent ☒ For your use ☐ As requested ☒ For Review & Comment

Remarks:

Hank: Addressed your comments from your email.

Attached, please find the following for your review and approval:

- 1. One (1) original mylar of the Amended Percolation Certification Plan.**
- 2. Two (2) prints of the Amended Percolation Certification Plan.**

Should you have questions, or require additional information, please contact this office at 410-461-2855.

Very truly yours,

Tony

FCC

CONFIDENTIALITY NOTICE

This transmission contains confidential information which may be legally privileged, and is intended only for the use of the individual named above. If you are not the intended recipient, you are hereby notified that any distribution (except to the intended recipient), copying, or disclosure of this transmission is strictly prohibited.

LEGEND

- EXISTING 2' CONTOURS
- EXISTING 10' CONTOURS
- GL82
MLC2 SOIL LINES AND TYPES
- W DENOTES EXISTING WELL
- W DENOTES 1500 Sq.Ft. ALTERNATE WELL SITE

SOILS LEGEND

SOIL	NAME	CLASS
LaB	Legore silt loam, 3 to 8 percent slopes	C
LaC	Legore silt loam, 8 to 15 percent slopes	C

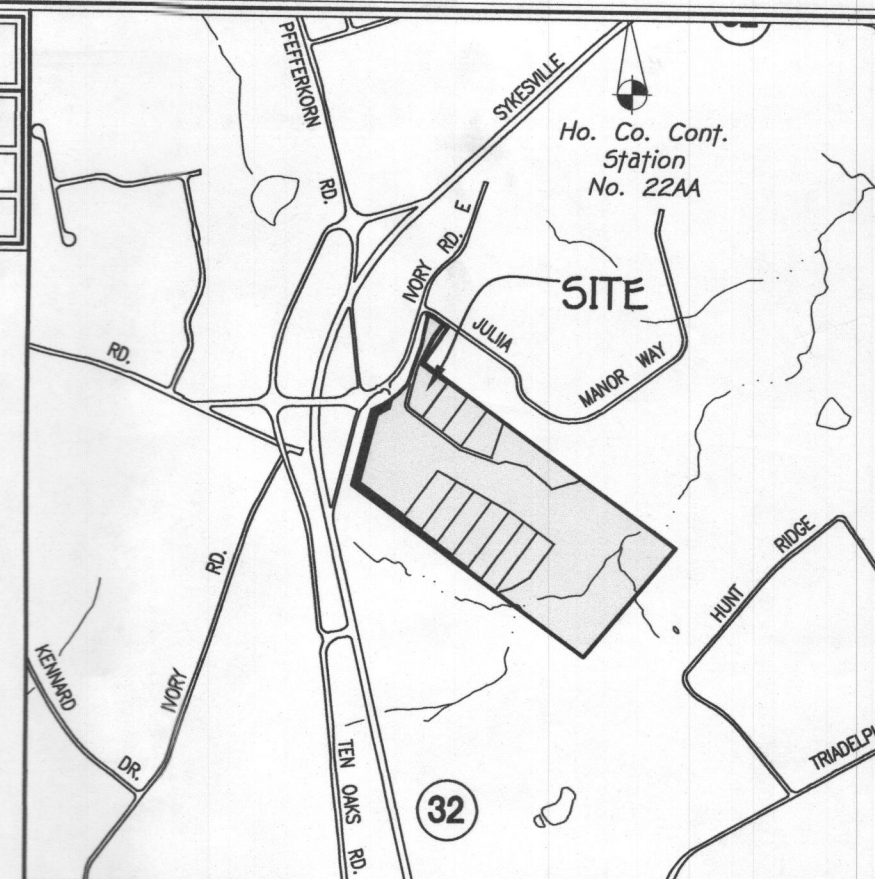

VICINITY MAP
SCALE : 1" = 1200'

GENERAL NOTES:

1. THE WELL HO-17-0010 HAS BEEN FIELD LOCATED AND IS ACCURATELY SHOWN.
2. ADJUSTMENTS TO SEPTIC EASEMENT AREA IS NOT PERMITTED WITHOUT ADDITIONAL TESTING.
3. THE LOT SHOWN HEREON COMPLIES WITH THE MINIMUM OWNERSHIP WIDTH AND LOT AREA AS REQUIRED BY THE MARYLAND STATE DEPARTMENT OF THE ENVIRONMENT.
4. EXISTING WELLS AND/OR SEWERAGE EASEMENTS WITHIN 100 FEET OF THE PROPERTY HAVE BEEN SHOWN FROM ALL REASONABLE EFFORTS.
5. ALL HOUSE SITES SHOWN COMPLY WITH MINIMUM BUILDING RESTRICTION REGULATIONS.
6. TOPOGRAPHY SHOWN IS ESTABLISHED AT TWO FOOT INTERVALS BASED ON A TOPOGRAPHIC SURVEY OF THE PROPERTY COMPLETED ON JUNE, 2009 AND SUPPLEMENTED WITH HOWARD COUNTY AERIAL TOPOGRAPHY DATED 2004.
7. BOUNDARY OUTLINE SHOWN IS BASED ON AVAILABLE DEED RESEARCH AND FIELD RUN SURVEY PERFORMED BY FISHER, COLLINS AND CARTER, INC. DATED OCTOBER, 2009.
8. ANY CHANGES TO A PRIVATE SEWERAGE EASEMENT SHALL REQUIRE A REVISED PERC CERTIFICATION PLAN.
9. PLAT NO. 21287
10. THERE IS A 5 BEDROOM LIMIT PER HOUSE FOR THE SHARED SEPTIC SYSTEM.

THE PURPOSE FOR THIS PLAN IS TO RELOCATE
1 ALTERNATE WELL SITE ON LOT 1.

PERC CERTIFICATION
I certify that the locations shown hereon are based on field locations done under my direct supervision and are correct to the best of my professional knowledge and belief.

Frank John Manalansan II
Signature of Professional Land Surveyor
Frank John Manalansan II, Professional Land Surveyor No. 21476 Expires 7/14/19
Date 3/25/19

APPROVED FOR PRIVATE WATER AND SHARED SEWERAGE SYSTEMS,
HOWARD COUNTY HEALTH DEPARTMENT.

William for Maura Roseman
COUNTY HEALTH OFFICER H.O. 9-
DATE 4/4/2019

REVISED PERC CERTIFICATION PLAN BELVEDERE ESTATES

13711 TERGE DRIVE

LOT 1

TAX MAP #22 ZONED: RC-DEO PARCELS NO.: 116 AND P\O 7
3RD ELECTION DISTRICT HOWARD COUNTY, MARYLAND
SCALE: 1"=50' DATE: MARCH 22, 2019

FISHER, COLLINS & CARTER, INC.
CIVIL ENGINEERING CONSULTANTS & LAND SURVEYORS
CENTENNIAL SQUARE OFFICE PARK - 10272 BALTIMORE NATIONAL PIKE
ELLICOTT CITY, MARYLAND 21042
(410) 461 - 2855