



Howard County
Health Department

Bureau of Environmental Health

8930 Stanford Boulevard, Columbia, MD 21045

Main: 410-313-2640 | Fax: 410-313-2648

TDD 410-313-2323 | Toll Free 1-866-313-6300

www.hchealth.org

Facebook: www.facebook.com/hocohealth

Maura J. Rossman, M.D., Health Officer

RECEIPT DATE: 11-12-19

ONSITE SEWAGE DISPOSAL SYSTEM

P 56457

APPROVAL DATE: 11/19/19

PERMIT: CONSTRUCTION

A

PROPERTY ADDRESS: 13876 Mill Creek Court

SUBDIVISION: Mill Creek

LOT: 13

TAX ID: _____

CONTRACTOR: South Carroll Backhoe

EMAIL: scbackhoe@comcast.com

CONTRACTOR ADDRESS: 4410 Salem Bottom Road, Westminster, MD 21157

PHONE: 410-596-3618

PROPERTY OWNER: NVR INC.

EMAIL: _____

OWNER ADDRESS: 9720 Patuxent Woods Drive, Columbia, MD 21046

PHONE: 410-379-5956

SEPTIC TANK SIZE (GALLONS): 2000

TANK MANUFACTURER: Babylon

PUMP MODEL: N/A

PUMP SIZE

N/A

PUMP TANK CAPACITY: N/A

DISTRIBUTION SYSTEM: ☒ GRAVITY

☐ PRESSURE DOSED

BEDROOMS: 5

APPLICATION RATE 1.2

TRENCHES:	LINEAR FEET REQUIRED: <u>94.7</u>	INLET DEPTH: <u>4</u>
	TRENCH WIDTH: <u>3</u>	MAXIMUM BOTTOM DEPTH: <u>8</u>
	MINIMUM SPACE BETWEEN TRENCHES: <u>10</u>	EFFECTIVE AREA BEGINNING DEPTH: <u>4.5</u>
LOCATION:	PER APPROVED SITE PLAN. SEWAGE DISPOSAL AREA AND TANK LOCATIONS MUST BE STAKED BY LICENSED SURVEYOR PRIOR TO PRE-CONSTRUCTION INSPECTION.	
NOTES:	LPZ Fall 2019	

ISSUED BY: Dana Bernard

ISSUE DATE: _____

EXPIRATION DATE: _____

NOTE: CONTRACTOR MUST SCHEDULE A PRE-CONSTRUCTION INSPECTION PRIOR TO BEGINNING ANY INSTALLATION

NOTE: CONTRACTOR MUST SCHEDULE AN INSPECTION AND GAIN APPROVAL OF ALL COMPONENTS PRIOR TO COVERING

NOTE: STONE MUST BE APPROVED BY HEALTH DEPARTMENT AND GRAVEL TICKET MUST BE AVAILABLE FOR REVIEW.

NOTE: WATERTIGHT TANKS REQUIRED

NOTE: ALL PARTS OF SEPTIC SYSTEM SHALL BE AT LEAST 100 FEET DOWNGRAIENT FROM ANY WATER WELL

NOTE: MANHOLE RISERS REQUIRED ON ALL SEPTIC TANKS AND PUMP CHAMBERS

NOTE: AN ELECTRICAL PERMIT IS REQUIRED FOR INSTALLATION OF ANY ELECTRICAL COMPONENTS OF THE SYSTEM

☒ ELECTRICAL PERMIT ISSUED E _____

NOTE: MDE RECOMMENDS SEPTIC TANKS, BAT, AND OTHER PRETREATMENT UNITS BE PUMPED AT A FREQUENCY ADEQUATE TO ENSURE THAT SOLIDS ARE NOT DISCHARGED TO THE DISPOSAL AREA

NEITHER THE HOWARD COUNTY COUNCIL NOR THE HEALTH DEPARTMENT IS RESPONSIBLE FOR THE SUCCESSFUL OPERATION OF ANY SYSTEM.

PERMITTEE RESPONSIBLE FOR OBTAINING FINAL APPROVAL ON THIS PERMIT.

CALL 410-313-1771 TO SCHEDULE INSPECTIONS.

NOT TO SCALE

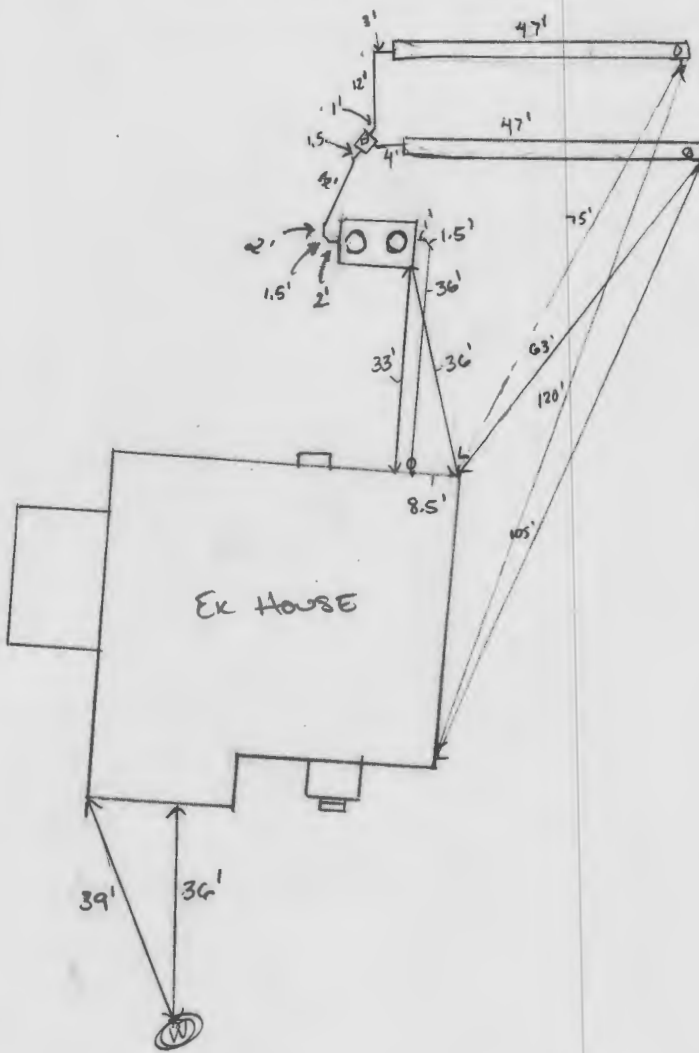

TRENCH/DRAINFIELD DATA

WIDTH INLET BOTTOM

3' 2' 8'

NUMBER OF TRENCHES 2

TOTAL LENGTH 94'

ABSORPTION AREA 282 sq ft + sidewalk

DISTRIBUTION BOX LEVEL 1.5'

DISTRIBUTION BOX BAFFLE 1.5'

DISTRIBUTION BOX PORT 1'

SEPTIC TANK DATA

SEPTIC TANK 1 LEVEL 1.5'

MANUFACTURER BABALON

CAPACITY 2000 GAL

SEAM LOC TOP

TANK LID DEPTH 27"

BAFFLES front + back

BAFFLE FILTER NO

MANHOLE LOC FRONT/BACK

6" PORT LOC -

WATERTIGHT TEST -

SLOTTED YES

DATE ON LID 09/23/2019

PUMP/SEPTIC TANK LEVEL -

MANUFACTURER -

CAPACITY - GAL

SEAM LOC -

TANK LID DEPTH -

BAFFLES -

BAFFLE FILTER -

MANHOLE LOC -

6" PORT LOC -

WATERTIGHT TEST -

SLOTTED -

DATE ON LID -

ROAD NAME

MILL CREEK COURT

PRE-CONSTRUCTION:

11/13/2019 TANK, SDA, TRENCHES STAKED. CONTOUR CONFIRMED.
~1-2' CUT AT DISTAL ENDS OF TRENCHES. CHECK FINAL GRADE. (+)

INSTALLATION: 11/14/2019 TANK SET (+) 11/15/2019 SHC AND SEWER LINE
INSTALLED TO TANK. UPPER TRENCH BEING CONSTRUCTED. (+)

11/19/19 D-box set, two trenches complete. (ST)

FINAL INSPECTOR

Susan Thomas

DATE OF APPROVAL

11/19/19

