

PERMIT NUMBER: B 20050410

DATE ACCEPTED:



RESIDENTIAL BUILDING PERMIT APPLICATION

HOWARD COUNTY DEPARTMENT OF INSPECTIONS, LICENSES, AND PERMITS
3430 COURT HOUSE DRIVE, ELLICOTT CITY, MD 21043 - PHONE: (410) 313-2455 OPTION #4
www.howardcountymd.gov

BUILDING SITE ADDRESS REQUIRED

Street Address: 3643 Laurel Hill, LLC Unit:
City: Unit 17A, Ellicott City, MD State: MD Zip Code: 21771
Subdivision/Village/Complex Name: Laurel Hill Estates SDP/WP/BA #: SP-17-90
Lot: 8 Tax Map: Parcel: Grading Permit #:

DESCRIPTION OF WORK REQUIRED

Existing Use: Vacant Lot Proposed Use: BED Estimated Cost: \$ 70,000
Trade Work to Be Completed (Separate Permits Required): ☐ Mechanical (HVACR) ☐ Electrical ☐ Plumbing ☐ None
New Entry of PD and all other work to be done in accordance with the building code.

PROPERTY OWNER INFORMATION REQUIRED

Owner(s) Name(s) (As it appears on tax records): NVR Inc. Primary Residence: ☐ Yes ☒ No
Owner's Street Address: 1726 Laurel Hill, Ellicott City, MD
City: Ellicott City State: MD Zip Code: 21771
Phone: 410-341-5950 Email: jcombs@nvrinc.com

APPLICANT NAME REQUIRED - INDIVIDUAL WHO SIGNS THIS APPLICATION

Business Name: Laurel Hill Estates, LLC Contact Name: Tim Keenan
Street Address: 1726 Laurel Hill, Ellicott City, MD
City: Ellicott City State: MD Zip Code: 21771
Phone: 410-341-7112 Email: tim.keenan@laurelhillmd.com

CONTRACTOR INFORMATION REQUIRED

Business Name: NVR Homes
Licensee's Name: NVR Inc. License #: 46
Street Address: 1726 Laurel Hill, Ellicott City, MD
City: Ellicott City State: MD Zip Code: 21771
Phone: 410-379-5956 Email: jcombs@nvrinc.com

ARCHITECT/ENGINEER INFORMATION INDIVIDUAL WHO SIGNED PLANS, IF APPLICABLE

Business Name: Name:
Street Address:
City: State: Zip Code:
Phone: Email:

BUILDING CHARACTERISTICS REQUIRED

Primary Structure: ☐ SF Dwelling ☐ SF Townhouse ☐ SF Duplex ☐ Mobile Home ☐ Multi-Family Dwelling (MF*) Condo: ☐ Yes ☒ No
Utilities: ☐ Electric ☐ Gas Water Supply: ☐ Public ☐ Private (Well) Sewage Disposal: ☐ Public ☒ Private (Septic)
Heating System: ☐ Electric ☐ Natural Gas ☐ Propane ☐ Other: Roadside Tree Project: ☐ No ☒ Yes: #
Sprinkler System: ☐ NFPA 13 ☐ NFPA 13R ☐ NFPA 13D ☐ None Fire Alarm System: ☐ Yes ☒ No ☐ Voice Evac

ADDITIONAL RESIDENTIAL INFORMATION (PLEASE SELECT/COMPLETE ALL THAT APPLY)

Model Name & Options: 1726 Laurel Hill, Ellicott City, MD
of Bedrooms (SF): 3 # of efficiency units (MF*): # of 1 BR (MF*): # of 2 BR (MF*): # of 3 BR (MF*):
Rooms: 7 # Full Baths: 2 # Half Baths: 1 # Fireplaces: 0
Garage/Carport Info: ☒ Attached Garage ☐ Detached Garage ☐ Integral Garage ☐ Carport ☐ None
Basement/Foundation Info: ☐ Slab on Grade ☐ Post & Pier ☐ Unfinished Basement ☐ Finished Basement: ☐ Full or ☐ Partial
1st Fl Width: 37 1st Fl Depth: 47 2nd Fl Width: 37 2nd Fl Depth: 47 Bsmt Width: 30 Bsmt Depth: 47
Energy Method: ☐ Prescriptive ☐ Performance ☐ UA Alternative ☐ ERI Gross Area: 2774 sq ft Occupiable Area: 5225 sq ft

AGREEMENT/ DISCALIMER REQUIRED

THE UNDERSIGNED HEREBY CERTIFIES AND AGREES AS FOLLOWS: (1) THAT HE/SHE IS AUTHORIZED TO MAKE THIS APPLICATION; (2) THAT THE INFORMATION IS CORRECT; (3) THAT HE/SHE WILL COMPLY WITH ALL REGULATIONS OF HOWARD COUNTY WHICH ARE APPLICABLE THERETO; (4) THAT HE/SHE WILL PERFORM NO WORK ON THE ABOVE REFERENCED PROPERTY NOT SPECIFICALLY DESCRIBED IN THIS APPLICATION; (5) THAT HE/SHE GRANTS COUNTY OFFICIALS THE RIGHT TO ENTER ONTO THIS PROPERTY FOR THE PURPOSE OF INSPECTING THE WORK PERMITTED AND POSTING NOTICES.

APPLICANT'S ORIGINAL SIGNATURE DATE SIGNED:

FOR OFFICE USE ONLY

CHECKS PAYABLE TO: DIRECTOR OF FINANCE OF HOWARD COUNTY

AGENCIES REQUIRED/APPROVALS:
☐ PR ☒ DPZ ☐ DED ☒ Health ☒ SHA
SUBMITTAL FEES: \$15.00 PAYMENT: \$70.00 ACCEPTED BY

3643 Paupers folly Lane
Lot 8

LONGWOOD

Health Dept

DIV-COMM-LOT-UNIT		
MDE-BY-0008		
COMM-LOT		
BELVEDERE ESTATES - 0008		
STREET ADDRESS		APT. NO.
3643 PAUPERS FOLLY LANE		
CITY	STATE	ZIP
WEST FRIENDSHIP	MD	21744



NVR, Inc.
5285 Westview Drive, Suite 100
Frederick, MD 21703

	FULL BASEMENT												STANDARD DETAILS
	STD. DWGS.												
SPEC SHEET	55-1												AD-1
ELEVATIONS	5												DR-1
FOUNDATIONS	14												DR-2
FOUNDATION HOLD DOWNS	14/20												DR-3
PLUMBING	21												ET-1
BASEMENT FLOOR PLAN	22												ET-1b
FIRST FLOOR PLAN	24												ET-1c
SECOND FLOOR PLAN	26												ET-1e
BUILDING SECTIONS	30/32												ET-1f
STAIR SECTIONS	34												ET-1h
KITCHEN LAYOUT	37												ET-2
LAUNDRY CABINET LAYOUT	39												ET-3
CABINET LAYOUT (OPTIONAL)	40												ET-3b
BATH ELEVATIONS	41												F-1
BASEMENT ELECTRICAL	42												F-1b
FIRST FLOOR ELECTRICAL	44												F-2
SECOND FLOOR ELECTRICAL	46												F-3
FIRST FLOOR FRAMING	50												F-3b
SECOND FLOOR FRAMING	51												FC-1
ROOF FRAMING	53												FC-2
ROOF FRAMING (OPTIONAL)	54												FC-4
TRUSS BRACING	58												FD-1
WALL BRACING LAYOUT	60												FD-2
BASEMENT HVAC LAYOUT	64/65												FD-2b
CRAWL SPACE HVAC LAYOUT	66/67												FD-3
FIRST FLOOR HVAC LAYOUT	68/69/70/71												FP-1
SECOND FLOOR HVAC LAYOUT	72/73												FP-1b
													GB-1
													IT-1
													IT-1b
													IT-1c
													IT-2
													JT-1
													JT-3
													JT-3b
													KT-1
													RF-1
													RF-1b
													RF-1c
													SEP-1
													SEP-2
													SEP-3
													SEP-4
													SP-1
													SP-2
													SP-3
													ST-1
													ST-2
													ST-3b
													WB-1
													WB-2
													WB-1
													WD-2
													WD-3
													WS-1

FIRST FLOOR SQUARE FOOTAGE	
DESCRIPTION	TOTAL SQ. FT.
1ST FLOOR (BASE SF)	1670 SF
	1670 SF
SECOND FLOOR SQUARE FOOTAGE	
DESCRIPTION	TOTAL SQ. FT.
2ND FLOOR (BASE SF)	1861 SF
	1861 SF
GARAGE SQUARE FOOTAGE	
DESCRIPTION	TOTAL SQ. FT.
GARAGE	460 SF
	460 SF
BASEMENT SQUARE FOOTAGE	
DESCRIPTION	TOTAL SQ. FT.
UNFINISHED SQUARE FOOTAGE	
DESCRIPTION	TOTAL SQ. FT.
UNFINISHED BASEMENT	1684 SF
	1684 SF
TOTAL FINISHED SQUARE FOOTAGE	
DESCRIPTION	TOTAL SQ. FT.
1ST FLOOR (BASE SF)	1670 SF
2ND FLOOR (BASE SF)	1861 SF
	3531 SF

SET - VERSION
14000 - 01

CS-1

C:\NVR\Solves\LONGWOOD_14000_01\MDE-BY-0008\1715616\Sheets\Lot_Spac\CS-1_COVERSHEET.dwg 03/06/20 - 1:23 pm

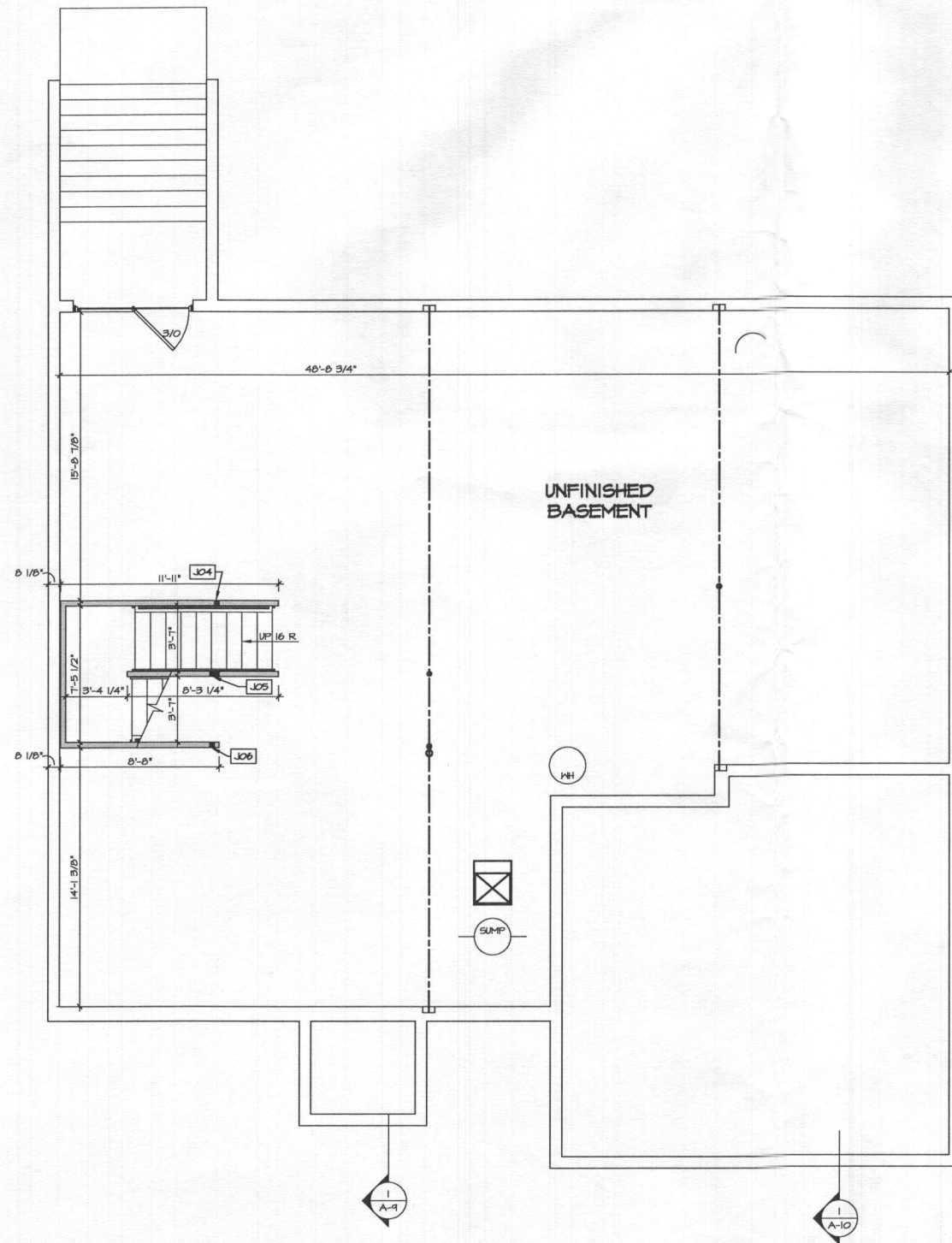

BASEMENT FLOOR PLAN
SCALE: 1/4" = 1'-0"

FLOOR PLAN NOTES

- ALL HEADERS ARE (2) 2x6 w/ 2x4 HALLS OR (3) 2x6 w/ 2x6 WALLS, UNLESS OTHERWISE NOTED.
- ALL HEADERS TO HAVE (1) 2x4 OR 2x6 JACK EACH END, UNLESS OTHERWISE NOTED.
- ALL EXTERIOR WALLS TO BE 4" AND ALL INTERIOR WALLS TO BE 3 1/2", UNLESS OTHERWISE NOTED.
- HATCHED AREAS INDICATE DROPPED CEILINGS. ALL DROPPED CEILINGS ARE 12" UNLESS OTHERWISE NOTED.
- SEE "BRACED WALL PANEL DETAIL SHEET" FOR SPECIAL WALL FRAMING LOCATIONS AND HEADER SIZES, IF APPLICABLE.
- SEE STANDARD DETAIL CATEGORY "T" SHEET(S) FOR INTERIOR TRIM DETAILS.
- SEE ARCHITECTURAL DETAIL SHEET "AD" FOR HOUSE SPECIFIC INTERIOR TRIM OPTION TABLE.
- ALL WINDOWS HAVE T-O 1/2" HEADER HEIGHT UNLESS OTHERWISE NOTED.
- ALL CASED OPENINGS AT T-11", UNLESS OTHERWISE NOTED.

GYPSUM NOTES

AT GARAGE:

5/8" DRYWALL ON COMMON WALLS, CEILING, AND BEARING WALLS AS REQUIRED.

AT STAIRS:

1/2" GYPSUM BOARD AT UNDERSIDE OF STAIRS AND WALLS IN CLOSET

WITH OPTION "SCI" - DRYWALL UNFINISHED BASEMENT CEILING AREA

NOTES:

- 1/2" GYPSUM WALL BOARD REQUIRED ON CEILING IN UNFINISHED AREAS WHEN NO SPRINKLER SYSTEM IS INSTALLED.
- A MAXIMUM AREA OF 80 SQ FT MAY BE OMITTED AS NEEDED FOR INSTALLATION OF PLUMBING, ELECTRICAL, AND/OR HVAC (TYPICALLY AN 8'-0"x8'-0" CEILING SPACE ABOVE MECHANICAL AREA).
- PROVIDE FIRE BLOCKING AS REQUIRED AT PERIMETER OF ANY AREAS WHERE DRYWALL HAS BEEN OMITTED.

LEGEND

- BEARING WALL
 - NON BEARING WALL
 - INDICATES BEARING FROM POINT-LOAD ABOVE
 - JACKS
 - BEAM/HEADER
 - PAD FOOTING
 - STEEL COLUMN
 - PORTAL FRAME
 - JOIST/TRUSS
 - LVL
 - ENGINEERING PAGE NUMBER
- SEE FG DETAILS FOR FRAMING CONNECTORS

BASEMENT JACK SCHEDULE

IDENTIFIER	DESCRIPTION	OPTIONS	ENG. N.M.	REMARKS
JO4	JACK - (2) 2X4 SFF STUD GRADE	MEC	BO020	
JO5	JACK - (4) 2X4 SFF STUD GRADE	MEC	BO016, BO018	
JO6	JACK - (2) 2X4 SFF STUD GRADE	MEC	BO016	

NVR, Inc. The owner, expressly reserves the right to make changes to these plans, drawings, or specifications without notice, and without liability to NVR, Inc. for any such changes. NVR, Inc. is not responsible for any errors or omissions in these plans, drawings, or specifications.

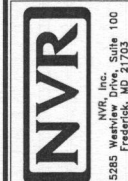

MODEL LONGWOOD	SET NO. 14000
DRAWING TITLE BASEMENT FLOOR PLAN	VERSION 01
OPTION DESCRIPTION	DRAWN BY: NSB
	DATE:
	OPTION

A-6

22

DIV-COMM-LOT-UNIT
MDE-BV-0008

COMM-LOT
BELVEDERE ESTATES - 0008

STREET ADDRESS
3648 PAPERS FOLLY LANE

CITY
MEST FRIENDSHIP

STATE
MD

ZIP
21754

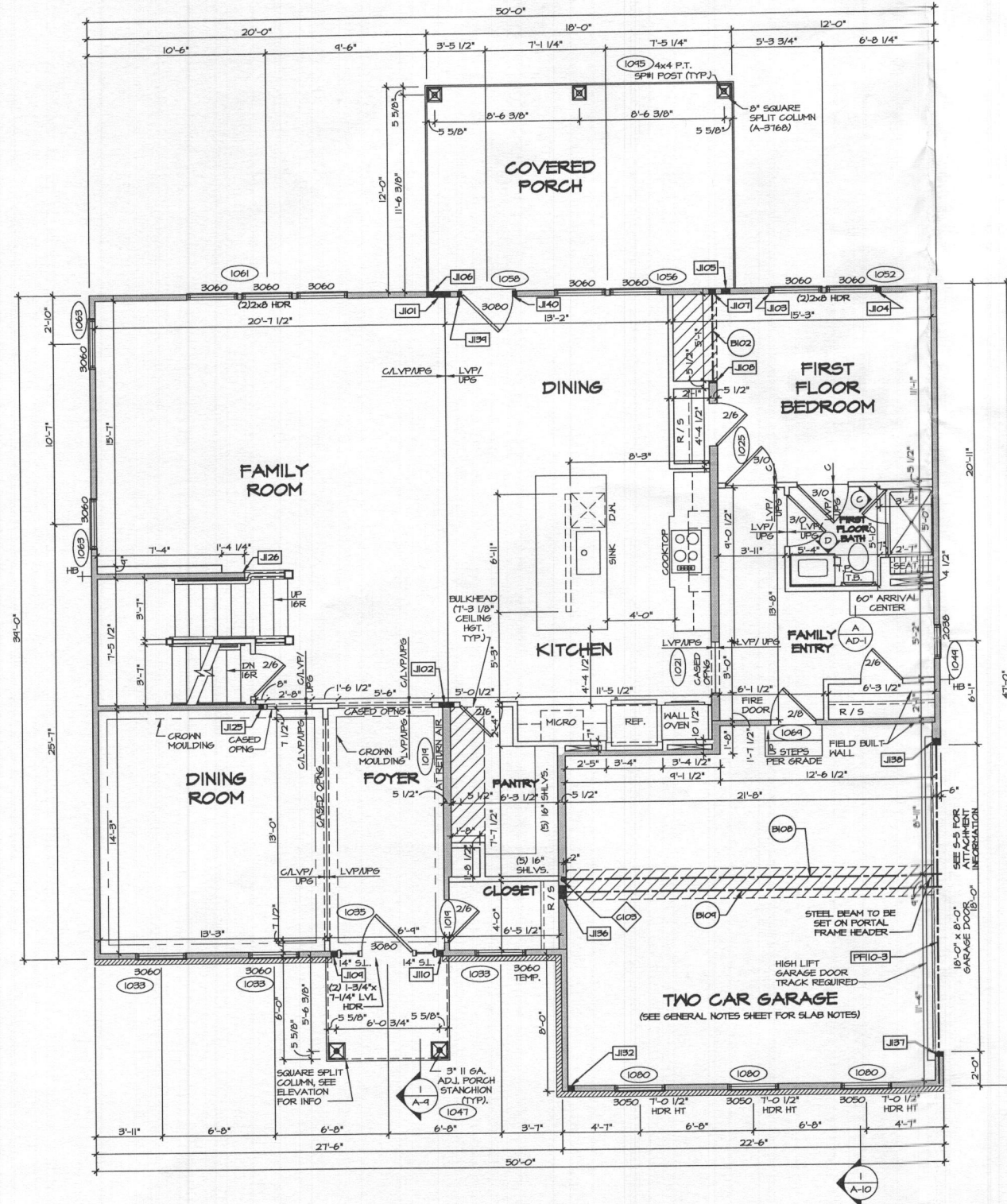

1 FIRST FLOOR PLAN
SCALE: 1/4" = 1'-0"

ALL WINDOWS HAVE
8'-0 1/2" HEADER HEIGHT
UNLESS OTHERWISE NOTED.

FLOOR PLAN NOTES

- ALL HEADERS ARE (2) 2x6 W/ 2x4 WALLS OR (3) 2x6 W/ 2x6 WALLS, UNLESS OTHERWISE NOTED.
- ALL HEADERS TO HAVE (1) 2x4 OR 2x6 JACK EACH END, UNLESS OTHERWISE NOTED.
- ALL EXTERIOR WALLS TO BE 4" AND ALL INTERIOR WALLS TO BE 3 1/2", UNLESS OTHERWISE NOTED.
- HATCHED AREAS INDICATE DROPPED CEILINGS. ALL DROPPED CEILINGS ARE 12" UNLESS OTHERWISE NOTED.
- SEE "BRACED WALL PANEL DETAIL SHEET" FOR SPECIAL WALL FRAMING LOCATIONS AND HEADER SIZES, IF APPLICABLE.
- SEE STANDARD DETAIL CATEGORY "IT" SHEET(S) FOR INTERIOR TRIM DETAILS.
- SEE ARCHITECTURAL DETAIL SHEET "AD" FOR HOUSE SPECIFIC INTERIOR TRIM OPTION TABLE.
- ALL WINDOWS HAVE 1'-0 1/2" HEADER HEIGHT UNLESS OTHERWISE NOTED.
- ALL CASED OPENINGS AT T-11, UNLESS OTHERWISE NOTED.

GYPSUM NOTES

- AT GARAGE:
5/8" DRYWALL ON COMMON WALLS, CEILING, AND BEARING WALLS AS REQUIRED.
- AT STAIRS:
1/2" GYPSUM BOARD AT UNDERSIDE OF STAIRS AND WALLS IN CLOSET
- WITH OPTION "SC1" - DRYWALL UNFINISHED BASEMENT CEILING AREA

NOTES:

- 1/2" GYPSUM WALL BOARD REQUIRED ON CEILING IN UNFINISHED AREAS WHEN NO SPRINKLER SYSTEM IS INSTALLED.
- A MAXIMUM AREA OF 80 SQ. FT. MAY BE OMITTED AS NEEDED FOR INSTALLATION OF PLUMBING, ELECTRICAL, AND/OR HVAC (TYPICALLY AN 8'-0"x8'-0" CEILING SPACE ABOVE MECHANICAL AREA).
- PROVIDE FIRE BLOCKING AS REQUIRED AT PERIMETER OF ANY AREAS WHERE DRYWALL HAS BEEN OMITTED.

LVL FLY TO FLY FASTENING SCHEDULE: (WHERE APPLICABLE BASED ON LVL USAGE)

- 1A - (2) FLY UP TO AND INCLUDING 11 7/8" TALL: FASTEN FLIES W/ (2) ROWS 16D NAILS AT 12" O.C.
- 2A - (2) FLY 14" TO AND INCLUDING 18" TALL: FASTEN FLIES W/ (3) ROWS 16D NAILS AT 12" O.C.
- 3A - (2) FLY 20" TALL AND OVER: FASTEN FLIES W/ (4) ROWS 16D NAILS AT 12" O.C.
- 4A - (3) FLY UP TO AND INCLUDING 11 7/8" TALL: FASTEN FLIES W/ (2) ROWS 16D NAILS AT 12" O.C. FROM EACH SIDE
- 5A - (3) FLY 14" TO AND INCLUDING 18" TALL: FASTEN FLIES W/ (3) ROWS 16D NAILS AT 12" O.C. FROM EACH SIDE
- 6A - (3) FLY 20" TALL AND OVER: FASTEN FLIES W/ (4) ROWS 16D NAILS AT 12" O.C. FROM EACH SIDE

FIRST FLOOR BEAM/HEADER SCHEDULE

IDENTIFIER	DESCRIPTION	LENGTH	OPTIONS	ENG. NUM.	REMARKS
B102	INT. HEADER - 2X6 - 3 FLY	5'-6"	BAR	1021	
B108	BEAM STEEL - W10X44	22'-5"	GCC	1071, 1075, 1078	
B104	BEAM STEEL - W10X39	22'-7"	GCC/ELA/NEVA	1079	
PF10-3	LVL - 22	20'-2 1/2"	GCC/ZDK	1081, 1084, 1091	PORTAL FRAME - 6A

STEEL COLUMN SCHEDULE

IDENTIFIER	STYLE	HEIGHT	OPTIONS	ENG. NUM.	REMARKS
C103	STANCHION - 3 IN SCHED 40	8'-1 5/8"	GCC	1071, 1075, 1078	

FIRST FLOOR JACK SCHEDULE

IDENTIFIER	DESCRIPTION	OPTIONS	ENG. NUM.	REMARKS
J101	JACK - (1) 2X4 SPM		1024	
J102	JACK - (1) 2X4 SFF STUD GRADE		1024	
J103	JACK - 2X4 SFF STUD GRADE		1052	
J104	JACK - (2) 2X4 SFF STUD GRADE		1052	
J105	JACK - (4) 2X4 SFF STUD GRADE	EPE	1045	
J106	JACK - (4) 2X4 SPM	EPE	1045	
J107	JACK - (3) 2X4 SFF STUD GRADE	BAR	1027	
J108	JACK - 2X6 SFF STUD GRADE	BAR	1027	
J104	JACK - (3) 2X4 SFF STUD GRADE	ELA	1035, 1047	
J110	JACK - (3) 2X4 SFF STUD GRADE	ELA	1035, 1047	
J125	JACK - (2) 2X4 SFF STUD GRADE		1011	
J126	JACK - (2) 2X4 SFF STUD GRADE		1015	
J132	JACK - (3) 2X4 SFF STUD GRADE	GCC/ELA/NEVA	1072	
J136	JACK - (6) 2X6 SFF STUD GRADE	GCC/ELA/NEVA	1075	
J137	JACK - (2) 2X6 SFF STUD GRADE	GCC	1081, 1084, 1091	
J138	JACK - (3) 2X6 SFF STUD GRADE	GCC	1081, 1084, 1091	
J134	JACK - (2) 2X4 SFF STUD GRADE		1058	
J140	JACK - (2) 2X4 SFF STUD GRADE		1058	

LEGEND

- BEARING WALL
- NON BEARING WALL
- INDICATES BEARING FROM POINT-LOAD ABOVE
- JACKS
- BEAM/HEADER
- PAD FOOTING
- STEEL COLUMN
- PORTAL FRAME
- JOIST/TRUSS
- LVL
- ENGINEERING PAGE NUMBER
- SEE FG DETAILS FOR FRAMING CONNECTORS

MDE-BV-0008

DIV-COMM-LOT-UNIT

COM-LT

BEVEDERE ESTATES - 0008

ART. NO.

STREET ADDRESS

9649 PAUPERS FOLLY LANE

CITY

STATE

MD

ZIP

21744

WEST FRIENDSHIP

MD

21744

MD

21744

MD

21744

MD

21744

MD

21744

MD

21744

MD

21744

MD

21744

MD

21744

MD

21744

MD

21744

MD

21744

MD

21744

MD

21744

MD

21744

MD

21744

MD

21744

MD

21744

MD

21744

MD

21744

MD

21744

MD

21744

MD

21744

MD

21744

MD

21744

MD

21744

