

**Bureau of Environmental Health**  
8930 Stanford Boulevard, Columbia, MD 21045  
Main: 410-313-2640 | Fax: 410-313-2648  
TDD 410-313-2323 | Toll Free 1-866-313-6300  
[www.hchealth.org](http://www.hchealth.org)  
Facebook: [www.facebook.com/hocohealth](http://www.facebook.com/hocohealth)

Maura

J. Rossman, M.D., Health Officer

RECEIPT DATE: 10/17/20

**ONSITE SEWAGE DISPOSAL SYSTEM**

P 572817

INSTALLATION

APPROVAL DATE: 11/04/2020 

**PERMIT**

**MINOR REPAIR**

A \_\_\_\_\_

PROPERTY ADDRESS: 5000 WILD OLIVE COURT, ELLICOTT CITY, MD 21042

SUBDIVISION: \_\_\_\_\_

LOT: \_\_\_\_\_

TAX ID: 05-360668

CONTRACTOR: FOGLE'S SEPTIC CLEAN. INC

EMAIL: john@foglesinc.com

CONTRACTOR ADDRESS: 5680 OBRECHT ROAD, SYKESVILLE, MD 21784

PHONE: (410)795-5670

PROPERTY OWNER: NARINDER P CHADA

EMAIL: Narinder.singh@ourbus.com

OWNER ADDRESS: 5000 WILD OLIVE COURT, ELLICOTT CITY, MD 21042

PHONE: \_\_\_\_\_

NUMBER OF BEDROOMS: 5 SEPTIC TANK SIZE: 1500 DRAINFIELD SIZE/TYPE: 165 lf x 2-ft wide/gravity

|           |  |
|-----------|--|
| LOCATION: | RECONNECT SHC TO SEPTIC TANK INLET.  |
| NOTES:    | <p>CALL FOR INSPECTION WHEN REPAIR IS ANTICIPATED. INSPECTION MUST OCCUR PRIOR TO COVERING WORK. CLEANOUTS MUST OCCUR IN SHC AT SPACING OF 70 FEET OR LESS. ADD CLEANOUT(S) AS INDICATED.</p> <p>IN ADDITION TO INSPECTING THE SHC CONNECTION AT SEPTIC TANK, THE INSPECTING ENVIRONMENTAL SANITARIAN SHOULD EVALUATE THE EXISTING SHC FOR COMPLIANCE WITH CURRENT CODE REQUIREMENTS AND REQUIRE REPLACEMENT OF MATERIALS NOT IN COMPLIANCE.</p> |

ISSUED BY: R BRICKER

ISSUE DATE: 10/17/2020

EXPIRATION DATE: 10/17/2021

NOTE: CONTRACTOR MUST SCHEDULE AN INSPECTION AND GAIN APPROVAL OF ALL COMPONENTS PRIOR TO COVERING

NOTE: AN ELECTRICAL PERMIT IS REQUIRED FOR INSTALLATION OF ANY ELECTRICAL COMPONENTS OF THE SYSTEM

NOTE: MDE RECOMMENDS SEPTIC TANKS, BAT, AND OTHER PRETREATMENT UNITS BE PUMPED AT A FREQUENCY ADEQUATE TO ENSURE THAT SOLIDS ARE NOT DISCHARGED TO THE DISPOSAL AREA

**NEITHER THE HOWARD COUNTY COUNCIL NOR THE HEALTH DEPARTMENT IS RESPONSIBLE  
FOR THE SUCCESSFUL OPERATION OF ANY SYSTEM.  
PERMITTEE RESPONSIBLE FOR OBTAINING FINAL APPROVAL ON THIS PERMIT.  
CALL 410-313-1771 FOR INSPECTION OF SEPTIC SYSTEM.**

NOT TO SCALE

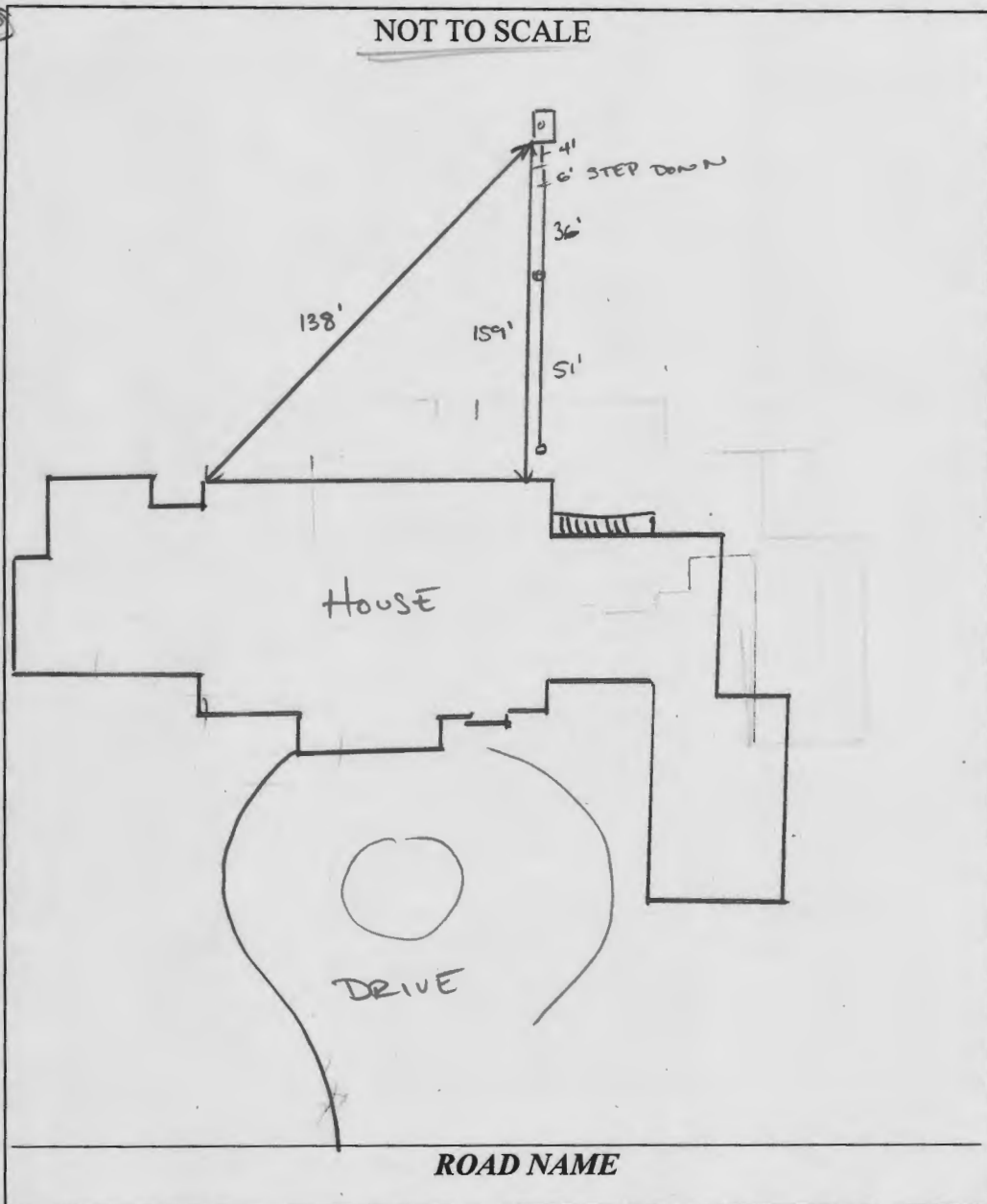

**TRENCH/DRAINFIELD DATA**

WIDTH INLET BOTTOM

NUMBER OF TRENCHES \_\_\_\_\_  
 TOTAL LENGTH \_\_\_\_\_  
 ABSORPTION AREA \_\_\_\_\_  
 DISTRIBUTION BOX LEVEL \_\_\_\_\_  
 DISTRIBUTION BOX BAFFLE \_\_\_\_\_  
 DISTRIBUTION BOX PORT \_\_\_\_\_

**SEPTIC TANK DATA**

SEPTIC TANK 1 LEVEL \_\_\_\_\_  
 MANUFACTURER \_\_\_\_\_  
 CAPACITY \_\_\_\_\_ GAL  
 SEAM LOC \_\_\_\_\_  
 TANK LID DEPTH \_\_\_\_\_  
 BAFFLES \_\_\_\_\_  
 BAFFLE FILTER \_\_\_\_\_  
 MANHOLE LOC \_\_\_\_\_  
 6" PORT LOC \_\_\_\_\_  
 WATERTIGHT TEST \_\_\_\_\_  
 SLOTTED \_\_\_\_\_  
 DATE ON LID \_\_\_\_\_

PUMP/SEPTIC TANK LEVEL \_\_\_\_\_  
 MANUFACTURER \_\_\_\_\_  
 CAPACITY \_\_\_\_\_ GAL  
 SEAM LOC \_\_\_\_\_  
 TANK LID DEPTH \_\_\_\_\_  
 BAFFLES \_\_\_\_\_  
 BAFFLE FILTER \_\_\_\_\_  
 MANHOLE LOC \_\_\_\_\_  
 6" PORT LOC \_\_\_\_\_  
 WATERTIGHT TEST \_\_\_\_\_  
 SLOTTED \_\_\_\_\_  
 DATE ON LID \_\_\_\_\_

PRE-CONSTRUCTION:

INSTALLATION:

11/04/2020 NEW SCH 40 4" PVC SEWER LINE INSTALLED FROM EXISTING SHC TO EXISTING SEPTIC TANK.

FINAL INSPECTOR

*Joseph Cantu*

DATE OF APPROVAL

11/4/2020

