

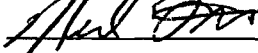

DEPARTMENT OF INSPECTIONS, LICENSES AND PERMITS 3430 COURT HOUSE DRIVE ELLCOTT CITY, MD 21043 PERMITS (410) 313-2455 INSPECTIONS (410) 313-1810 AUTOMATED INFORMATION (410) 313-3800		HOWARD COUNTY PERMIT APPLICATION		PERMIT NUMBER B09000778	
Building Address 12029 Sand Hill Manor Drive Marriottsville MD 21041			Property Owner's Name Raul & Marcel Alais		
Suite/Apt. #: _____ SDP/WP/Petition #: _____			Address 12029 Sand Hill Manor Drive		
Census Tract _____ Subdivision _____			City Marriottsville State MD Zip Code 21041		
Section _____ Area _____ Lot _____			Phone 410.696.2677 Phone 410.903.3629		
Tax Map _____ Parcel _____ Grid _____			Applicant's Name & Mailing Address, (if other than stated hereon):		
Zoning _____ Map Coordinates _____ Lot size _____			Phone _____ Fax _____		
Existing Use _____			Contractor Company Cedarbrook Deck & Patio, Inc		
Proposed Use Deck			Contact Person Neil Fortman		
Estimated Construction Cost \$ 18,000			Address 10232 Fountain School Rd		
Description of Work 424 sq ft composite Deck w/ pvc rail 29x14 w/ steps to grade			City Union Bridge State MD Zip Code 21771		
			License No. 92150		
			Phone 410.775.1444 Fax 410.775.0030		
Occupant or Tenant _____			Engineer or Architect Company _____		
Contact Name _____			Contact Person _____		
Address _____			Address _____		
City _____ State _____ Zip Code _____			City _____ State _____ Zip Code _____		
Phone _____ Fax _____			Phone _____ Fax _____		

BUILDING DESCRIPTION - COMMERCIAL		BUILDING DESCRIPTION - RESIDENTIAL	
Building Characteristics	Utilities	Building Characteristics	Utilities
Height: _____	Water Supply: _____ Public _____ Private _____	SF Dwelling <input checked="" type="checkbox"/> SF Townhouse <input type="checkbox"/> Depth _____ Width _____	Water Supply: _____ Public <input checked="" type="checkbox"/> Private _____
No. of stories: _____	Sewage Disposal: _____ Public _____ Private _____	1st floor: _____	Sewage Disposal: _____ Public _____ Private <input checked="" type="checkbox"/>
Gross area, sq. ft. per floor: _____	Electric Yes <input type="checkbox"/> No <input type="checkbox"/> Gas Yes <input type="checkbox"/> No <input type="checkbox"/>	2nd floor: _____	Electric Yes <input type="checkbox"/> No <input type="checkbox"/> Gas Yes <input type="checkbox"/> No <input type="checkbox"/>
Use group: _____	Heating System: _____ Electric <input type="checkbox"/> Oil <input type="checkbox"/> Natural Gas <input type="checkbox"/> Propane Gas <input type="checkbox"/>	Basement: _____ Finished Basement <input type="checkbox"/> Unfinished Basement <input type="checkbox"/>	Heating System: _____ Electric <input type="checkbox"/> Oil <input type="checkbox"/> Natural Gas <input type="checkbox"/> Propane Gas <input type="checkbox"/>
Construction type: _____ Reinforced Concrete _____ Structural Steel _____ Masonry _____ Wood Frame _____	Sprinkler system: N/A <input type="checkbox"/> Full _____ Partial _____ Other Suppression _____ # of Heads _____	Other Structure: _____ Dimensions: _____ Footings: _____ Roof Height: _____	Sprinkler system: N/A <input type="checkbox"/> NFPA #13D _____ NFPA #13R _____ Other: _____
State Certified Modular <input type="checkbox"/>		State Certified Modular <input type="checkbox"/> Manufactured Home <input type="checkbox"/>	

THE UNDERSIGNED HEREBY CERTIFIES AND AGREES AS FOLLOWS: (1) THAT HE/SHE IS AUTHORIZED TO MAKE THIS APPLICATION; (2) THAT THE INFORMATION IS CORRECT; (3) THAT HE/SHE WILL COMPLY WITH ALL REGULATIONS OF HOWARD COUNTY WHICH ARE APPLICABLE THERETO; (4) THAT HE/SHE WILL PERFORM NO WORK ON THE ABOVE REFERENCED PROPERTY NOT SPECIFICALLY DESCRIBED IN THIS APPLICATION; (5) THAT HE/SHE GRANTS COUNTY OFFICIALS THE RIGHT TO ENTER ONTO THIS PROPERTY FOR THE PURPOSE OF INSPECTING THE WORK PERMITTED AND POSTING NOTICES.

 Applicant's Signature President Title/Company	Neil Fortman Print Name 4/22/09 Date
---	---

Checks payable to: DIRECTOR OF FINANCE OF HOWARD COUNTY
** PLEASE WRITE NEATLY AND LEGIBLY. **

AGENCY	DATE	SIGNATURE APPROVAL	DPZ SETBACK INFORMATION	PROPERTY ID#
Land Development DPZ			Front: _____	Filing fee \$ _____
State Highways			Rear: _____	Permit fee \$ _____
Building Official			Side: _____	Excise tax \$ _____
Dev. Engineering DPZ			Side St: _____	Add'l per. fee \$ _____
Health	4/22/09		All minimum setbacks met? YES <input type="checkbox"/> NO <input type="checkbox"/>	TOTAL FEES \$ _____
Fire Protection			Is Entrance Permit required? YES <input type="checkbox"/> NO <input type="checkbox"/>	Sub-total paid \$ _____
Is Sediment Control approval required prior to issuance?			Historic District? YES <input type="checkbox"/> NO <input type="checkbox"/>	Balance due \$ _____
YES <input type="checkbox"/> NO <input type="checkbox"/>			Lot Coverage for New Town Zone _____	Check # _____
CONTINGENCY CONSTRUCTION START: <input type="checkbox"/>			SDP/Red-line approval date _____	Validation # _____
ONE STOP SHOP: <input type="checkbox"/>				
Distribution of Copies: _____	White: Building Official	Green: LDD, DPZ	Yellow: DED, DPZ	Pink: Health
T-Norms/PERMIT.FRM				Gold: SHA

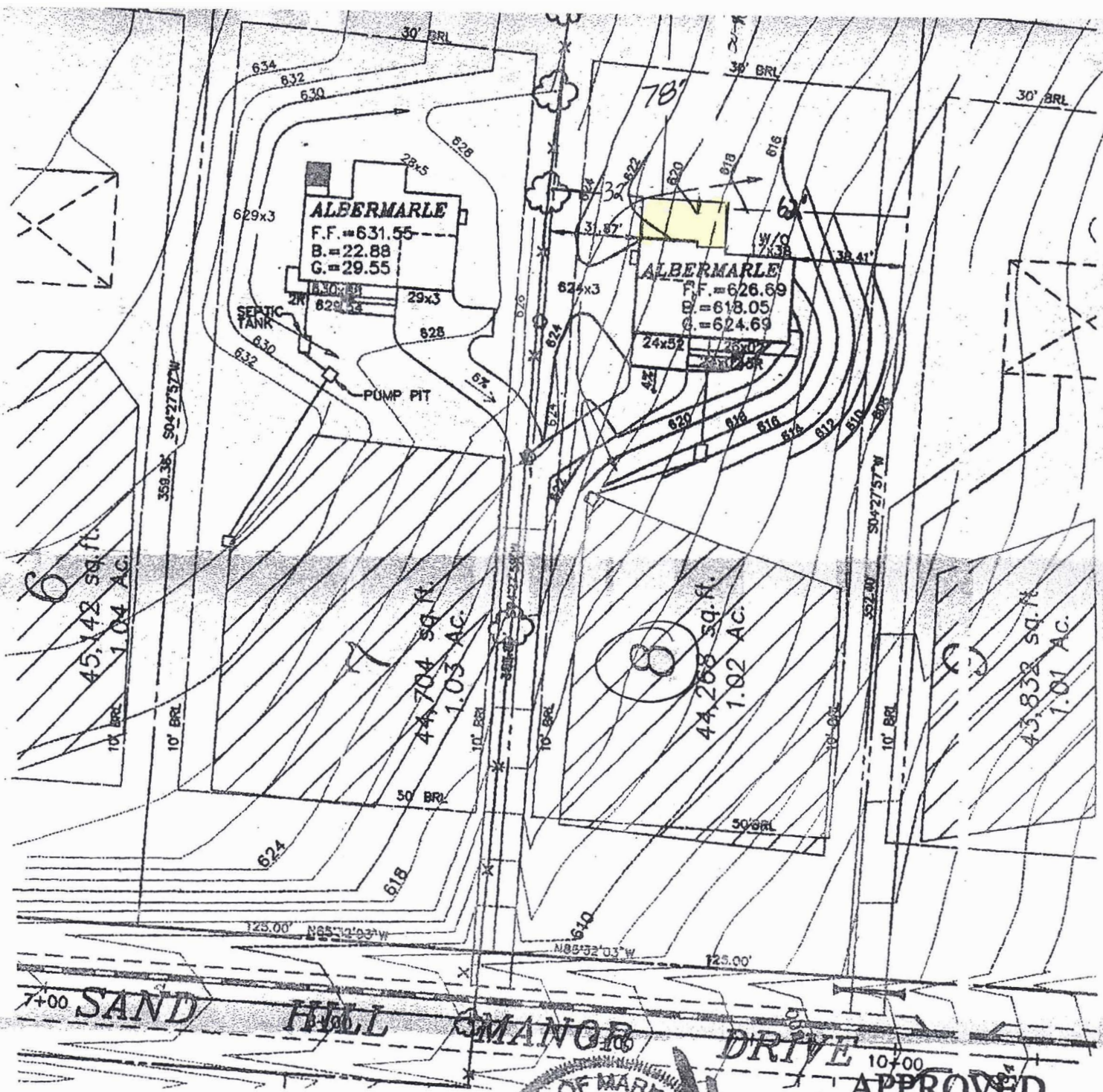

FIRST FLOOR EL. = 626.69
 INV. OUT OF HOUSE = 615.35
 INV. IN SEPTIC TANK = 614.55
 INV. OUT OF SEPTIC TANK = 614.30
 EXIST. EL. AT SEPTIC TANK = 615.00
 PROP. EL. AT SEPTIC TANK = 617.00
 EXIST. EL. AT DIST. BOX = 618.00
 INV. IN DIST. BOX = 613.50



WALK-THRU BUILDING PERMIT

BP# _____ A# P515988-A
 APP. SAN SFO DATE: 4/22/01
 DESC. OF WORK: 29' x 14'
 C.P. # 0 - 101 Deck
 PLAT # 14580-14585

THE ESTATES AT SAND HILL

PLOT PLAN LOT # 8
 12029 SAND HILL MANOR DRIVE

ELECTION DISTRICT: 3 TAX MAP: 16 HOWARD COUNTY, MARYLAND
 DRAWN BY: M.M.P. SCALE: 1"=50' DATE: JUNE 20, 2001

MILDENBERG, BOENDER & ASSOC., INC.
 Engineers Planners & Surveyors

6072 Dorsey Hall Drive, Suite 202, Ellicott City, Maryland 21042
 (410) 987-0296 Cell. (301) 821-6521 Vack. (410) 987-0296 Fax.

P515988-A