

APPLICATION

PERCOLATION TESTING

A 511435

P _____

HOWARD COUNTY HEALTH DEPARTMENT

BUREAU OF ENVIRONMENTAL HEALTH

3525-H ELLICOTT MILLS DRIVE/ELLICOTT CITY, MARYLAND 21043
TELEPHONE: 313-2640

DISTRICT _____

DATE 2/24/99

TO: THE COUNTY HEALTH OFFICER
ELLICOTT CITY, MARYLAND

I HEREBY APPLY FOR THE NECESSARY TEST PRIOR TO APPLICATION FOR PERMIT TO CONSTRUCT (OR RECONSTRUCT) A SEWAGE DISPOSAL SYSTEM.

PROPERTY OWNER R. Jeanette Miller, Trustee; Clyse Day Pendleton, Et Al

ADDRESS 14965 Frederick Road, Woodbine, MD 21797 PHONE _____

AGENT OR PROSPECTIVE BUYER Oak Hill Properties, LLC; Attn: Mr. Kevin Rogers

ADDRESS 107 Loudoun Street, SE, Leesburg, VA. 20175 PHONE 703 443 0400

PROPERTY LOCATION:

SUBDIVISION Sand Hill Property LOT NO. 1 though 78

ROAD AND DESCRIPTION East side intersection of Sand Hill Road and Mt. View Road

TAX MAP 16 PARCEL # 3

SIZE OF LOT 40,000 to 60,000 S.F. TYPE BLDG. Single Family Dwelling
(SINGLE FAMILY DWELLING OR COMMERCIAL)

THE SYSTEM INSTALLED UNDER THIS APPLICATION IS ACCEPTABLE ONLY UNTIL PUBLIC FACILITIES BECOME AVAILABLE. I FULLY UNDERSTAND THE

FEE CONNECTED WITH THE FILING OF THIS PERC TEST APPLICATION IS NON-REFUNDABLE UNDER ANY CIRCUMSTANCES. I ALSO AGREE TO

COMPLY WITH ALL M.O.S.H.A. REQUIREMENTS IN TESTING THIS LOT. Oak Hill Properties, LLC
Kevin B. Rogers
(SIGNATURE OF APPLICANT)

APPROVED BY _____ FOR _____ DATE _____

DISAPPROVED BY _____ FOR _____ DATE _____

HOLD PENDING FURTHER TESTS _____

REASONS FOR REJECTION OR HOLDING _____

PERCOLATION TEST PLAT/PRELIMINARY PLAT - TITLE OR I.D. # _____ DATE _____

SITE DEVELOPMENT PLAN/FINAL PLAT - TITLE OR I.D. # _____ DATE _____

THIS IS NOT A PERMIT

COUNTY #

SOIL PROFILE

53e

or brown
SiClm

+1.0

or brn
SiLm

+1.0

cave-in
moist
SiSaln
dull
grey

53g

orange
brown
SiClm
few
grey
mottles
in clay

+0.0

lgt tan
Saln

+1.0

53f

dark
red
brown
SiClm

+1.5

+2.0

dull
black/
grey
Saln

+11.5

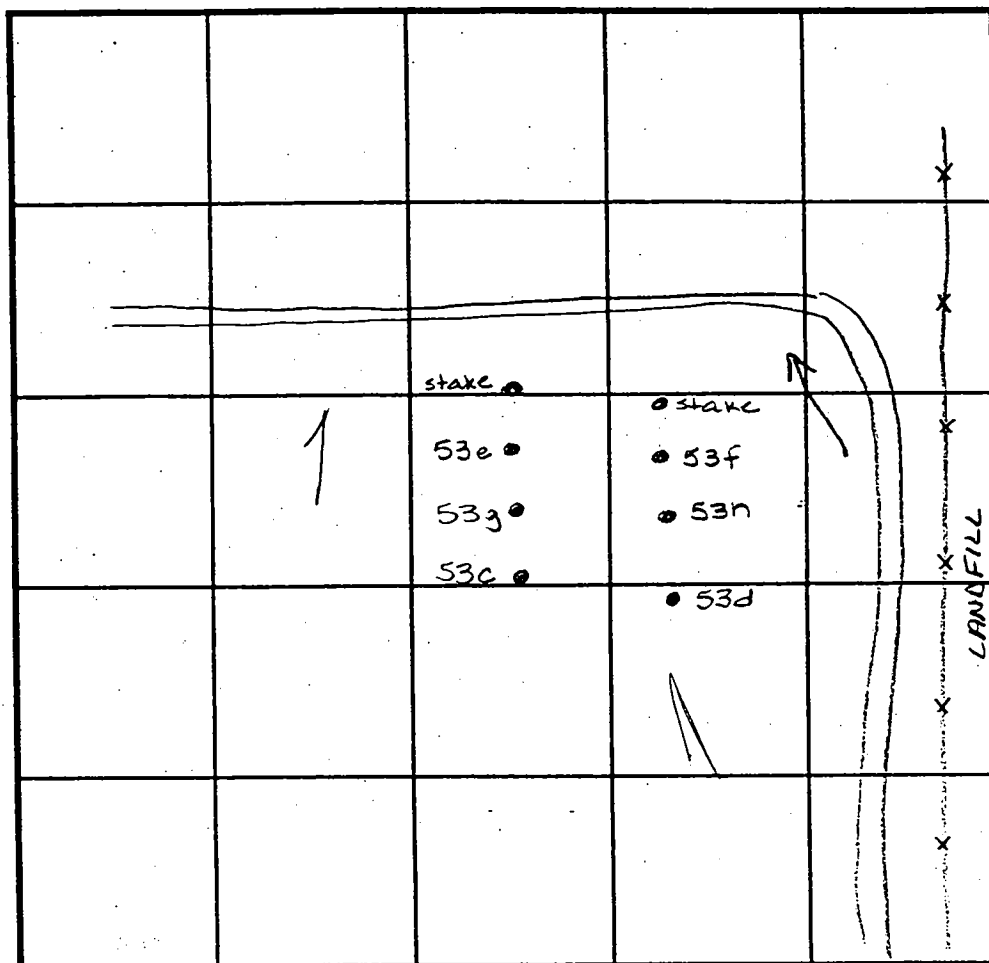

INDICATE NORTH - NAME ADJOINING ROADWAY AS BASE LINE.

SOIL PROFILE

53h 53e

bright
orange
yellow
SiClm

53d

5.0

tan
Saln
few
pockets
of grey
sand
stone
not
H₂O
related

12.0

DATE	TEST NO.	DEPTH	PRE-WET		TEST - 1" DROP		TIME
			START	STOP	START	STOP	
4-6-99	53e	Insufficient depth to potent H ₂ O	—	—	—	—	F
	53g	5.5 12	340	341	341	342	1 min
	53f	Insufficient depth to H ₂ O	—	—	—	—	F
	53c	Visual to 12.0 - see profile	—	—	—	—	OK
	53h	9.0 11.5	350	354	354	359	5 min
	53d	6.0 11.0	346	347	347	348	1 min

REMARKS

TYPE OF SOIL

TESTED BY Amy McMillen / Steve

ALSO PRESENT Olen Kethman

TRENCH DESIGN DATA: AVERAGE PERCOLATION TIME

TRENCH WIDTH

INLET DEPTH

MAXIMUM BOTTOM DEPTH

SQ. FT./BEDROOM