

APPLICATION

SEWAGE DISPOSAL TESTING

STATE OF MARYLAND - DEPARTMENT OF HEALTH AND MENTAL HYGIENE

A 350/6

P _____

HOWARD COUNTY HEALTH DEPARTMENT
ENVIRONMENTAL HEALTH SERVICES
P. O. BOX 476 ELLICOTT CITY, MARYLAND 21043
TELEPHONE: 992-2330

DISTRICT 4th
DATE 2/15/85

TO: THE COUNTY HEALTH OFFICER
ELLICOTT CITY, MARYLAND

I, HEREBY, APPLY FOR THE NECESSARY TEST IN ORDER TO CONSTRUCT (OR RECONSTRUCT) A SEWAGE DISPOSAL SYSTEM.

PROPERTY OWNER Sobrina 99, Inc.
12150 Tech Road
ADDRESS Silver Spring, MD 20904 PHONE Don Reuwer - 531-5252

PROPERTY LOCATION:

SUBDIVISION Montgomery Industrial Park LOT NO. 2
ROAD AND DESCRIPTION Route 94

SIZE OF LOT 5.3 Acres TYPE BLDG. 3 or 4 Bedrooms
(NUMBER OF BEDROOMS)

THE SYSTEM INSTALLED UNDER THIS APPLICATION IS ACCEPTABLE ONLY UNTIL PUBLIC FACILITIES BECOME AVAILABLE. I FULLY UNDERSTAND THE FEE CONNECTED WITH THE FILING OF THIS PERC TEST APPLICATION IS NON-REFUNDABLE UNDER ANY CIRCUMSTANCES. I ALSO AGREE TO COMPLY

WITH ALL M.O.S.H.A. REQUIREMENTS IN TESTING THIS LOT. /s/ Don Reuwer
(SIGNATURE OF APPLICANT)

APPROVED BY _____ FOR _____ DATE _____

REJECTED BY _____ FOR _____ DATE _____

HOLD PENDING FURTHER TESTS _____ DATE _____

REASONS FOR REJECTION OR HOLDING 3/17/85 PERC OK SECERT TRY NOTES AH

THIS IS NOT A PERMIT

GP 525240

801
6' BE L
BR CL
vgravelly
5' BE SL
multi-color
saprolite
10% flaggy
shale
8' 20% stony
12'

902
1' BE L
gravelly
ROBR
CL
gravelly
3' BE SL
20%
saprolite
~15%
crannery
shale
12.5'

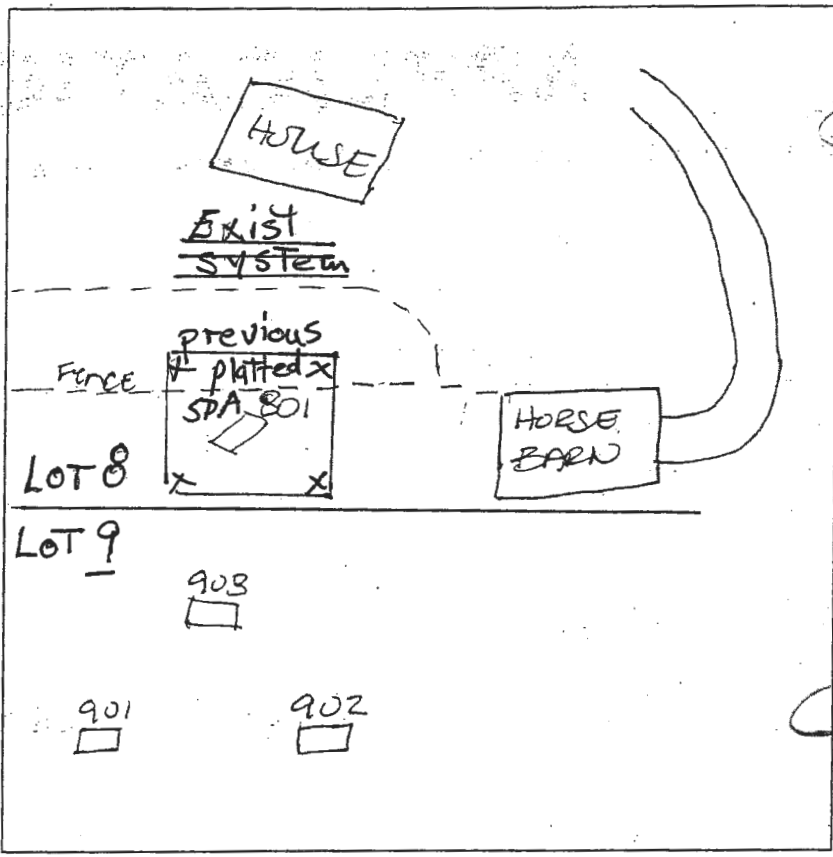

901
1' dk brn grl
2' yel-brn chl
red-brn chl
6.5' brn loam
Saprolite
strong
medium
platy
2'
903
0.5' dk brn grl
1.5' brn chl
yel-brn chl
3.5' vch loam
5.5' wk. cem.
phyllite
shale
breaks out
vchl (50% shale)
strong
medium
platy
11'

DATE	TEST #	DEPTH	START	BREAK 1" DROP	STOP 2" DROP	TIME OF 2ND INCH	P/F/H
4/3/06	801	5.5' / 12'	12:15	12:18	12:25	7	P
	902	4.5' / 12.5'	12:44	12:46	12:52	6	P
	903	6.5' / 11'	1:08	1:11	1:18	7	P
11/3/06	903	5' / 11'	0	4	10	6	P
	901	5' / 12'	0	10	22	12	P

REMARKS Sabrina Farms Lot 8+9
SANITARIAN AT/IRB BACKHOE Justin OTHERS Jack Hartner
TEST HOLES USED IN SDA 901, 902, 903 & #3-1985 * 8 SQ. FT/BR 210
TRENCH WIDTH 3 INLET DEPTH 3 MAX. BOT DEPTH 5 EFFECTIVE S/W 1.5'

* #4-1985 not used for average as it was perched in clay/soil.
→ LOT 8 perc confirms platted SDA: Trench width - 3'; Inlet - 4'; Max Depth - 6'; Sidewall 1'