WATER WELL ABANDONMENT-SEALING REPORT FORM

SUBMIT COPIES OF COMPLETED FORM TO:

- * COUNTY ENVIRONMENTAL AGENCY (contact MDE, WMA if address needed)
- * WELL OWNER
- * MDE, WATER MANAGEMENT ADMINISTRATION, WELL PROGRAM

Approved
3/16/21 (SD)

DATE WELL ABANDONED: 1-21-21 (month/day/year)

* PERMIT NUMBER OF ABANDONED WELL (if any)

H0-81-0440

* PERMIT NUMBER OF REPLACEMENT WELL:

* PERSON ABANDONING WELL: John Hess

WELL DRILLER'S LICENSE NUMBER: 553

* OWNER'S NAME: SHA

CIRCLE MWD / MSD / MGD

SITE LOCATION MAP

* WELL LOCATION:

COUNTY: Howard

NEAREST TOWN: West Friendship

TAX MAP 15 BLOCK

PARCEL 255

SUBDIVISION:

SECTION:

LOT: 30

STREET ADDRESS: 2615 Louanne Ct.

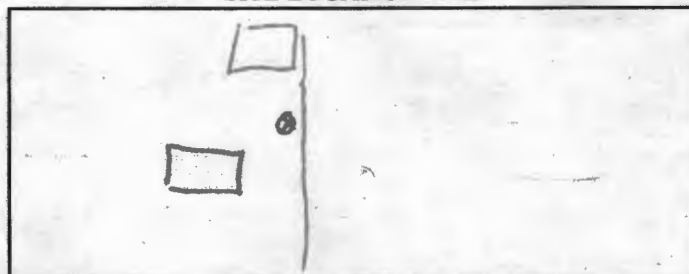

LATITUDE 39.186164

LONGITUDE 76.578134

LOG OF SEALING MATERIAL

MATERIAL	FEET	
	FROM	TO
Quick Grout	260	20
Hblc Plus	20	0

* TYPE OF WELL BEING ABANDONED:

- ☒ DRILLED ☐ JETTED
- ☐ BORED ☐ HAND DUG
- ☐ OTHER (specify) _____

* USE CODE:

- ☒ DOMESTIC ☐ MUNICIPAL/PUBLIC
- ☐ IRRIGATION ☐ INDUSTRIAL
- ☐ TEST/OBSERVATION ☐ GEOTHERMAL

VOLUME OF MATERIAL USED

14 bags OG 8 bags HP

* TYPE OF CASING:

- ☒ STEEL ☐ PLASTIC
- ☐ CONCRETE ☐ OTHER (specify) _____

SIZE OF CASING: 6 INCHES IN DIAMETER

DEPTH OF WELL: 260 FEET DEEP

WAS ANY CASING REMOVED? YES ☒ NO

If yes, length removed, in feet: _____

WAS CASING RIPPED OR PERFORATED? YES ☐ NO

SIGNATURE-MASTER WELL DRILLER OR SUPERVISING SANITARIAN LICENSE#

553 MWD / MSD / MGS
CIRCLE ONE

1/21/21 DATE

COUNTY

Pursuant to § 10-624 of the State Govt. Article of the Maryland Code, personal info requested on this form is used in processing this form pursuant to COMAR 26.04.04. Failure to provide the info may result in this form not being processed. You have the right to inspect, amend, or correct this form. The Maryland Department of the Environment is subject to the Maryland Public Information Act. This form may be made available on the Internet via MDE's website and is subject to inspection or copying, in whole or in part, by the public and other governmental agencies, if not protected by federal or State Law.