

AUG 10 2020



APPLICATIONS & PERMITS
DIVISION

www.howardcountymd.gov

T:\Operations\UpdatedFormat\ResidentialBuildingPermitApp01.28.2020

BRIDGEWATER

Health Dept

B20002726



FIRST FLOOR SQUARE FOOTAGE	
DESCRIPTION	TOTAL SQ. FT.
1ST FLOOR (BASE SF)	1525 SF
	1525 SF
SECOND FLOOR SQUARE FOOTAGE	
DESCRIPTION	TOTAL SQ. FT.
2ND FLOOR (BASE SF)	1717 SF
	1717 SF
GARAGE SQUARE FOOTAGE	
DESCRIPTION	TOTAL SQ. FT.
TWO CAR FRONT ENTRY GARAGE OR TWO CAR SIDE ENTRY GARAGE	528 SF
	528 SF
BASEMENT SQUARE FOOTAGE	
DESCRIPTION	TOTAL SQ. FT.
FINISHED BASEMENT (BASE SF)	1171 SF
	1171 SF
UNFINISHED SQUARE FOOTAGE	
DESCRIPTION	TOTAL SQ. FT.
MECHANICAL / STORAGE (BASE SF)	366 SF
	366 SF
TOTAL FINISHED SQUARE FOOTAGE	
DESCRIPTION	TOTAL SQ. FT.
1ST FLOOR (BASE SF)	1525 SF
2ND FLOOR (BASE SF)	1717 SF
FINISHED BASEMENT (BASE SF)	1171 SF
	4412 SF

SET - VERSION

3000 - 01

CS-1

SET - VERSION
|3000 - 0|

CS-1

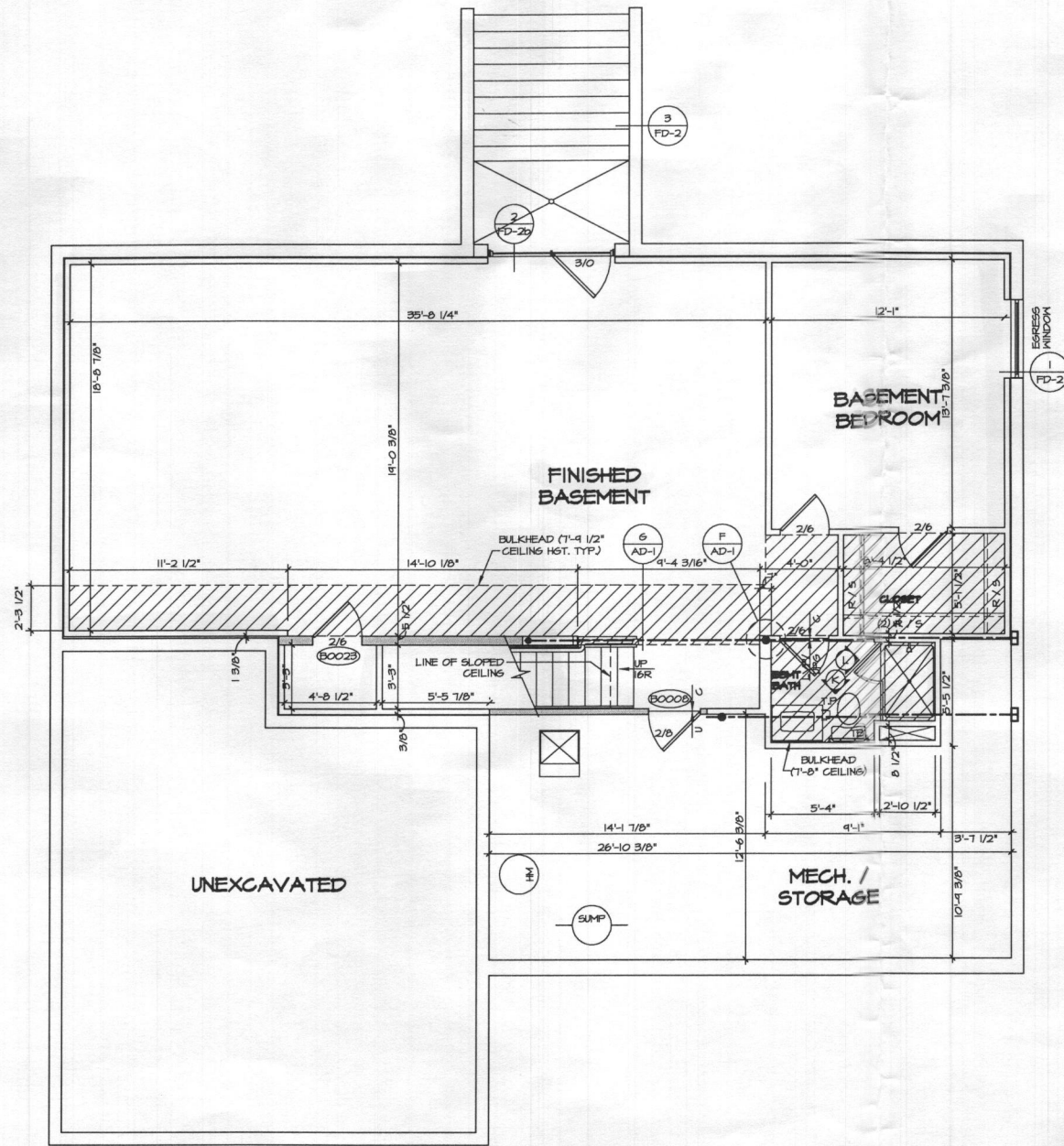

BASEMENT FLOOR PLAN
SCALE: 1/4" = 1'-0"

LEGEND	
	BEARING WALL
	NON BEARING WALL
	INDICATES BEARING FROM POINT-LOAD ABOVE
	JACKS
	BEAM/HEADER
	PAD FOOTING
	STEEL COLUMN
	PORTAL FRAME
	JOIST/TRUSS
	LVL
	ENGINEERING PAGE NUMBER
SEE FG DETAILS FOR FRAMING CONNECTORS	

FLOOR PLAN NOTES

- ALL HEADERS ARE (2) 2x6 W/ 2x4 WALLS OR (3) 2x6 W/ 2x6 WALLS, UNLESS OTHERWISE NOTED.
- ALL HEADERS TO HAVE (1) 2x4 OR 2x6 JACK EACH END, UNLESS OTHERWISE NOTED.
- ALL EXTERIOR WALLS TO BE 4" AND ALL INTERIOR WALLS TO BE 9 1/2", UNLESS OTHERWISE NOTED.
- HATCHED AREAS INDICATE DROPPED CEILINGS. ALL DROPPED CEILINGS ARE 12" UNLESS OTHERWISE NOTED.
- SEE "BRACED WALL PANEL DETAIL SHEET" FOR SPECIAL WALL FRAMING LOCATIONS AND HEADER SIZES, IF APPLICABLE.
- ALL WINDOWS HAVE 7'-0 1/2" HEADER HEIGHT UNLESS OTHERWISE NOTED.
- ALL CASED OPENINGS AT 7'-11", UNLESS OTHERWISE NOTED.

GYPSON NOTES

- AT GARAGE:
5/8" DRYWALL ON COMMON WALLS, CEILING, AND BEARING WALLS AS REQUIRED.
- AT STAIRS:
1/2" GYPSON BOARD AT UNDERSIDE OF STAIRS AND WALLS IN CLOSET

BASEMENT JACK SCHEDULE

IDENTIFIER	DESCRIPTION	OPTIONS	ENG. NUM.	REMARKS
------------	-------------	---------	-----------	---------

The owner, expressly reserves its copyright and other property rights in this drawing. No part of this drawing may be reproduced, stored in a retrieval system, or transmitted in any form or by any means, electronic, mechanical, photocopying, recording, or by any information storage and retrieval system, without the prior written consent of NVR, Inc.



SET NO. 18000	VERSION 01
DRAWN BY JAB	DATE:
OPTION FBA	DATE:

BRIDGEWATER
DRAWING TITLE
BASEMENT FLOOR PLAN
OPTION DESCRIPTION
W/ FULL BASEMENT FOUNDATION

A-6
SHEET NO.
21

DIV.-COMM-LT-UNIT
MDE-W-0016

COMM-LT	APR. NO.
WALKER MEADOWS - 0016	208
STREET ADDRESS	STATE
1082 STEPPING PLACE	MD
CITY	ZIP
SYKEVILLE	21784

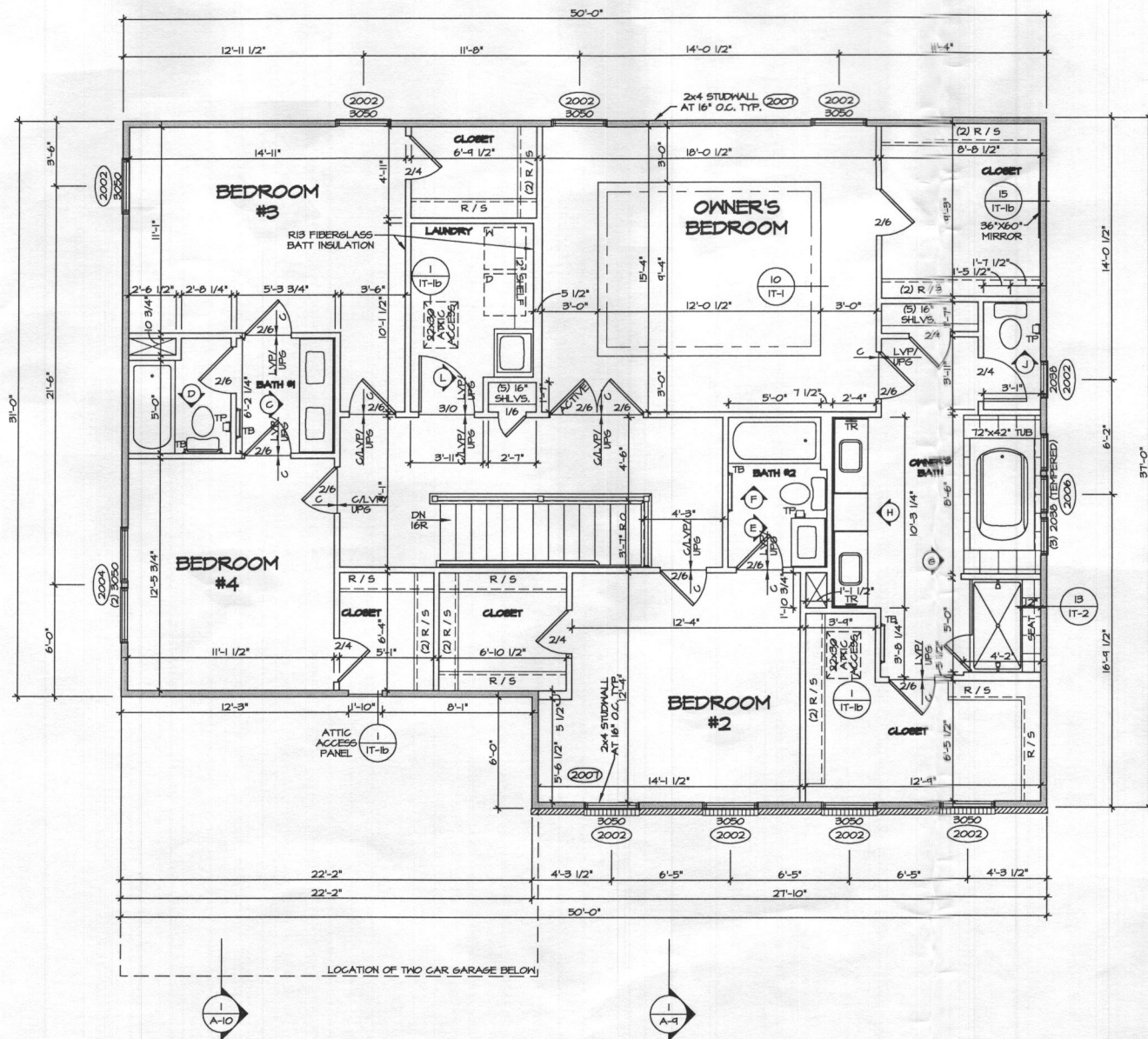

1
A-8
SECOND FLOOR PLAN
SCALE: 1/4" = 1'-0"

FIELD INSTALLED SECOND FLOOR BEAM/HEADER SCHEDULE					
IDENTIFIER	DESCRIPTION	LENGTH	OPTIONS	ENG. NUM.	REMARKS

SECOND FLOOR JACK SCHEDULE				
IDENTIFIER	DESCRIPTION	OPTIONS	ENG. NUM.	REMARKS

LEGEND	
	BEARING WALL
	NON BEARING WALL
	INDICATES BEARING FROM POINT-LOAD ABOVE
	JACKS
	BEAM/HEADER
	PAD FOOTING
	STEEL COLUMN
	PORTAL FRAME
	JOIST/TRUSS
	LVL
	ENGINEERING PAGE NUMBER

- FLOOR PLAN NOTES**
- ALL HEADERS ARE (2) 2x6 w/ 2x4 WALLS OR (3) 2x6 w/ 2x6 WALLS, UNLESS OTHERWISE NOTED.
 - ALL HEADERS TO HAVE (1) 2x4 OR 2x6 JACK EACH END, UNLESS OTHERWISE NOTED.
 - ALL EXTERIOR WALLS TO BE 4" AND ALL INTERIOR WALLS TO BE 3 1/2", UNLESS OTHERWISE NOTED.
 - HATCHED AREAS INDICATE DROPPED CEILINGS. ALL DROPPED CEILINGS ARE 12" UNLESS OTHERWISE NOTED.
 - SEE "BRACED WALL PANEL DETAIL SHEET" FOR SPECIAL WALL FRAMING LOCATIONS AND HEADER SIZES, IF APPLICABLE.
 - ALL WINDOWS HAVE 1'-0 1/2" HEADER HEIGHT UNLESS OTHERWISE NOTED.
 - ALL CASED OPENINGS AT 1'-11", UNLESS OTHERWISE NOTED.

DIV-COMM-LOT-UNIT
MDE-IW-0016

COMM-LOT
MALKER MEADOWS - 0016
STREET ADDRESS
1052 STEPPING PLACE
CITY
SPYKESVILLE
STATE
MD
ZIP
21784

The owner, expressly reserves its right to make any changes to the plans, specifications, or contract documents, without the consent of NVR, Inc.

NVR
NVR, Inc.
5285 Washington Blvd., Suite 100
Frederick, MD 21703

SET NO. 15000
VERSION 01

DRAWN BY JAB

MODEL
BRIDGEWATER
DRAWING TITLE
SECOND FLOOR PLAN

OPTION DESCRIPTION

A-8

25

CA NVR Solves BRIDGEWATER 13000_01 MDE-IW-0016 2032051 Sheets Lot Specific 25 A-8 PLAN LSW 07/28/20 - 2:57 PM