



# HOWARD COUNTY HEALTH DEPARTMENT

8527312

8 / 21 / 07

Received From Q M Contracting LLC PHONE # 443-277-7526

309 Backlick Tr. Mt Airy 21771

☐ CASH  
☒ CHECK

NO.

3417

For Kippan's Permit - remove tank replacement only  
13920 Rowan Mill Rd

One hundred thirty four and 00/100 Dollars

\$

165.00

Received By Mary Lou Burger

**SEPTIC SYSTEM REPAIR / UPGRADE / EVALUATION REQUEST**

**Please fill out this form completely and check off the reason for the request:**

Date requested: 8/22/07

**Reason for Request**

Failing System (includes surface discharge or inadequate treatment zone) \_\_\_\_\_

**Has the contractor verified through excavation/pumping evaluation, that there are no pipe blockages?**

In support of a building permit. Type of building addition: \_\_\_\_\_

\*System relocation for proposed addition for setback compliance ☒

\*Verification of adequate system capacity per COMAR 26.04.02.02D (4) \_\_\_\_\_

To replace collapsed septic tank or upgrade tank capacity 2,000 GAL. ☒

To replace collapsed drywell \_\_\_\_\_

\*\*\*\*\*

Septic Contractor: J.M. Contracting LLC

Contractor's Address: 425 O Brecht Rd

Sykesville MO - 21784

Contractor's Phone #: 443-277-7526

Property Address: 13920 River Mill Rd.

Property (Subdivision) & Lot # West Friendship Md 21794

Owner's Name: Anton Drorak

Is public sewer available/nearby: NO

Names of Any Previous Owners: Don't Know

Year House Built: \_\_\_\_\_

# of Existing Bedrooms: \_\_\_\_\_

# of Bedrooms after completion of addition: \_\_\_\_\_

Has this request been discussed previously with a Sanitarian, who? \_\_\_\_\_

***If public sewer is close, further research will be performed to verify availability and possible hook up to public sewer.***

A Sanitarian will be in contact within three business days depending upon the urgency of the situation to coordinate the scheduling of the repair /upgrade/evaluation. No inspection will be performed without fee collection at the office.

Environmental Sanitarian tentatively assigned \_\_\_\_\_

**FAX TO 410-313-2648**

PUB. SEWER STATUS VERIFIED BY

ISSUE DATE: 08/21/07

P 527312

APPROVAL DATE: 8/22/07

A REPAIR

**PERMIT**

Tax ID # 03-312070

**ON-SITE SEWAGE DISPOSAL SYSTEM  
HOWARD COUNTY HEALTH DEPARTMENT  
BUREAU OF ENVIRONMENTAL HEALTH**

J M Contracting LLC

IS PERMITTED TO INSTALL ☐ ALTER ☒

ADDRESS: 425 Obrecht Road, Sykesville

PHONE NUMBER: 443-277-7526

SUBDIVISION: Rover Meadows

LOT NUMBER: 6

ADDRESS: 13920 Rover Mill Road

PROPERTY OWNER: Anton Dvorak

SEPTIC TANK CAPACITY (GALLONS): 2000

PUMP CHAMBER CAPACITY (GALLONS):

NUMBER OF BEDROOMS:

SQUARE FEET PER BEDROOM:

LINEAR FEET OF TRENCH REQUIRED:

TRENCHES:	Trench to be      feet wide. Inlet      feet below original grade. Bottom maximum depth      feet below original grade. Effective area begins at      feet below original grade.      feet of stone below distribution pipe.
LOCATION:	
PURPOSE:	In support of BP, existing septic tank is to be replaced with 2000 gallon tank. Call for inspection when ground is opened so sanitarian can recommend repair.

PLANS APPROVED:

DATE:

NOTE: PERMIT VOID AFTER 2 YEARS

NOTE: CONTRACTOR RESPONSIBLE FOR SCHEDULING A PRE-CONSTRUCTION INSPECTION FOR ALL INSTALLATIONS

NOTE: WATERTIGHT SEPTIC TANKS REQUIRED

NOTE: ALL PARTS OF SEPTIC SYSTEM SHALL BE 100 FEET FROM ANY WATER WELL

NOTE: MANHOLE RISERS REQUIRED ON ALL SEPTIC TANKS AND PUMP CHAMBERS

**NEITHER THE HOWARD COUNTY COUNCIL OR THE HEALTH DEPARTMENT IS  
RESPONSIBLE FOR THE SUCCESSFUL OPERATION OF ANY SYSTEM  
PERMITTEE RESPONSIBLE FOR OBTAINING FINAL APPROVAL ON THIS PERMIT  
CALL 410-313-2640 FOR INSPECTION OF SEPTIC SYSTEM**

**BUILDING PERMIT SIGNED  
AND RETURNED**

B07003814- 9/12/07 - 2 story addition

# Rover Mill Rd

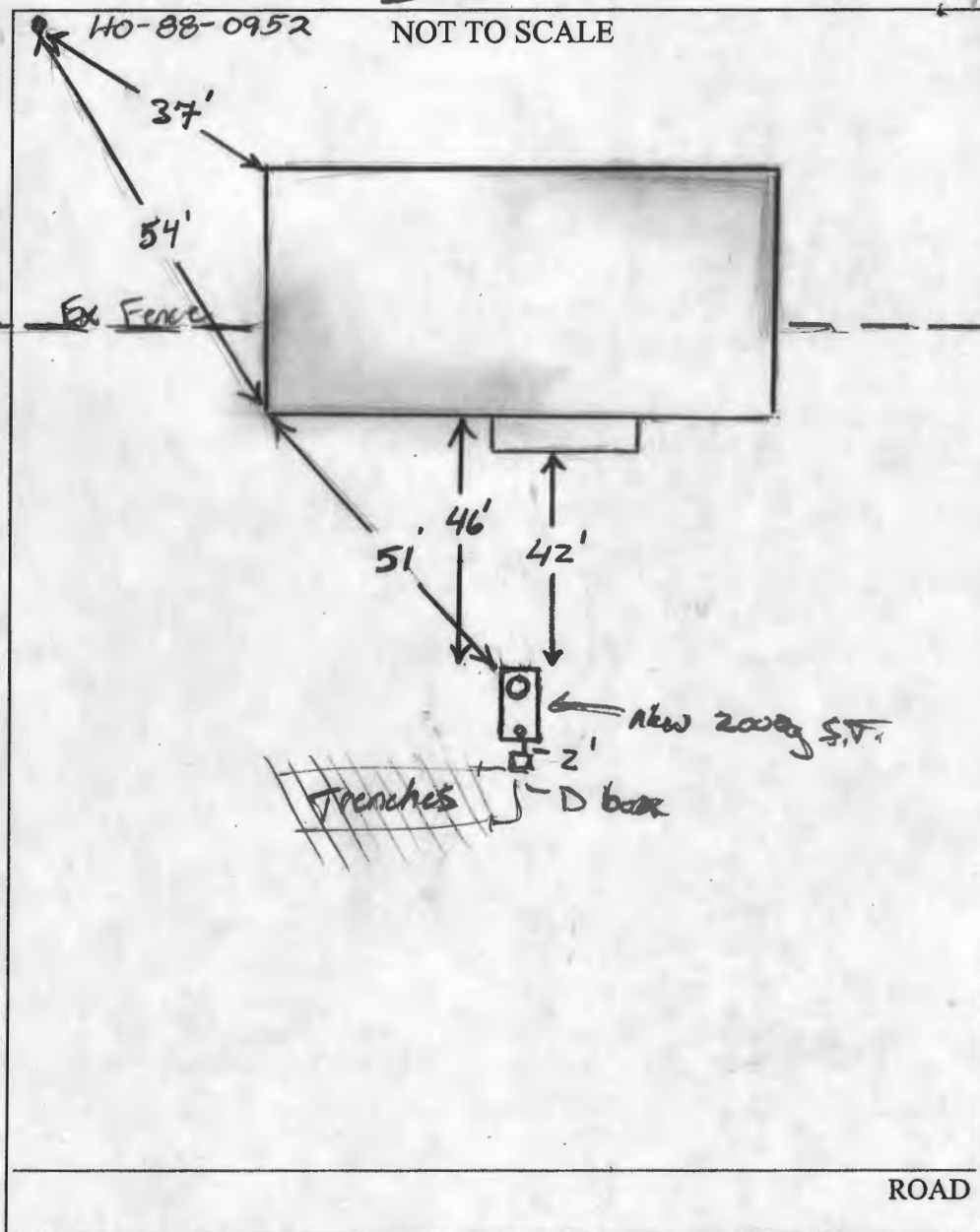

TRENCH/DRAINFIELD DATA		
WIDTH	INLET	BOTTOM
NUMBER OF TRENCHES		
TOTAL LENGTH		
ABSORPTION AREA		
DISTRIBUTION BOX LEVEL		
DISTRIBUTION BOX BAFFLE		
DISTRIBUTION BOX PORT		

SEPTIC TANK DATA	
SEPTIC TANK 1 LEVEL	Yes
CAPACITY	2000 GAL
SEAM LOC	Top
TANK LID DEPTH	2-3'
BAFFLES	Yes
BAFFLE FILTER	—
MANHOLE LOC	Front
6" PORT LOC	Rear
WATERTIGHT TEST	—
SEPTIC TANK 2 LEVEL	
CAPACITY	GAL
SEAM LOC	
TANK LID DEPTH	
BAFFLES	
BAFFLE FILTER	
MANHOLE LOC	
6" PORT LOC	
WATERTIGHT TEST	

PRE-CONSTRUCTION 8/22/07 Tank installed same place ex tank was. Old tank pumped, collapsed. Verified w/ homeowner.

INSTALLATION that addition to be extended off of ex house (not bump-out) 25'. Tank should be approx 21' off of new structure. OK to backfill (BW)

FINAL INSPECTOR

*[Signature]*

DATE OF APPROVAL

8/22/07