

LAYOUT 9/11/08 INSP 4 _____
INSP 2 9/16/08 INSP 5 _____
INSP 3 _____ INSP 6 _____

ISSUE DATE: 9/11/08

APPROVAL DATE: 11/17/08

PERMIT

Pat Trac

TAX ID # 05447879

P 529564

A 518599

**ON-SITE SEWAGE DISPOSAL SYSTEM
HOWARD COUNTY HEALTH DEPARTMENT
BUREAU OF ENVIRONMENTAL HEALTH**

Hatfields Equipment IS PERMITTED TO INSTALL ☒ ALTER ☐

ADDRESS: P0 Box 519, Annapolis Junction PHONE NUMBER: 301-854-6172

SUBDIVISION: Sheppard Manor LOT NUMBER: 9

ADDRESS: 4635 Sheppard Manor Drive PROPERTY OWNER: Williamsburg Group LLC

SEPTIC TANK CAPACITY (GALLONS): 2000 OUTLET BAFFLE FILTER REQUIRED ☐

PUMP CHAMBER CAPACITY (GALLONS): 1500 COMPARTMENTED TANK REQUIRED ☒

NUMBER OF BEDROOMS: 4

SQUARE FEET PER BEDROOM: _____

LINEAR FEET OF TRENCH REQUIRED: ~~103~~ 110

$$(1500)4 = \frac{500}{2} = 250 (.44) = 110LF$$

TRENCHES:	Trench to be 30 ²⁰ feet wide. Inlet 4.0 feet below original grade. Bottom maximum depth 8.0 feet below original grade. Effective area begins at 5.0 feet below original grade. 3.0 feet of stone below distribution pipe.
LOCATION:	Set distribution box at top center of easement 50' from NE boundary. Run 1x50' and 1x55' line on contour.
NOTES:	Layout inspection required prior to installation. Install system as noted unless otherwise directed by HCHD.

PLANS APPROVED: Heidi Scott DATE: 10/15/07

NOTE: PERMIT VOID AFTER 2 YEARS

NOTE: CONTRACTOR RESPONSIBLE FOR SCHEDULING A PRE-CONSTRUCTION INSPECTION FOR ALL INSTALLATIONS

NOTE: WATERTIGHT SEPTIC TANKS REQUIRED

NOTE: ALL PARTS OF SEPTIC SYSTEM SHALL BE 100 FEET FROM ANY WATER WELL

NOTE: MANHOLE RISERS REQUIRED ON ALL SEPTIC TANKS AND PUMP CHAMBERS UNLESS SPECIFICALLY AUTHORIZED

**NEITHER THE HOWARD COUNTY COUNCIL NOR THE HEALTH DEPARTMENT IS
RESPONSIBLE FOR THE SUCCESSFUL OPERATION OF ANY SYSTEM
PERMITTEE RESPONSIBLE FOR OBTAINING FINAL APPROVAL ON THIS PERMIT
CALL 410-313-1771 FOR INSPECTION OF SEPTIC SYSTEM**

NOT TO SCALE

* See Separate
Sheet for
As-Built

TRENCH/DRAINFIELD DATA

WIDTH	INLET	BOTTOM
2'	4'	8'
NUMBER OF TRENCHES		2
TOTAL LENGTH		118'
ABSORPTION AREA		354
DISTRIBUTION BOX LEVEL		Yes
DISTRIBUTION BOX BAFFLE		Yes
DISTRIBUTION BOX PORT		Yes

SEPTIC TANK DATA

SEPTIC TANK 1 LEVEL	
MANUFACTURER	Babylon
CAPACITY	2000 GAL
SEAM LOC	Top
TANK LID DEPTH	3.5'
BAFFLES	Yes
BAFFLE FILTER	No
MANHOLE LOC	Front
6" PORT LOC	Rear
WATERTIGHT TEST	No
SLOTTED	Yes
PUMP/SEPTIC TANK LEVEL	
Yes	
MANUFACTURER	Babylon
CAPACITY	1500 GAL
SEAM LOC	Top
TANK LID DEPTH	3.5'
BAFFLES	Front
BAFFLE FILTER	No
MANHOLE LOC	Rear
6" PORT LOC	None
WATERTIGHT TEST	No
SLOTTED	no

PRE-CONSTRUCTION

9/11/08 System as V
require a 1500 pump tank.
Set D box @ higher middle
part of SDA run
2 x 55' trenches

back towards the house. Trenches changed to 2' wide, Inlet
4' bottom 8'. Call for msp. (KW)

INSTALLATION: 9/15/08 Both tanks set. Plumbing from house to
D box (including 2" P.V.C.) installed per layout. Top 55' trench
being installed. (KW) 9/16/08 Trenches done. Need pump and
alarm test (BB) 11/17/08 Pump and alarm working. (BB)

FINAL INSPECTOR

B. Baker

DATE OF APPROVAL

11/17/08

NOT TO SCALE

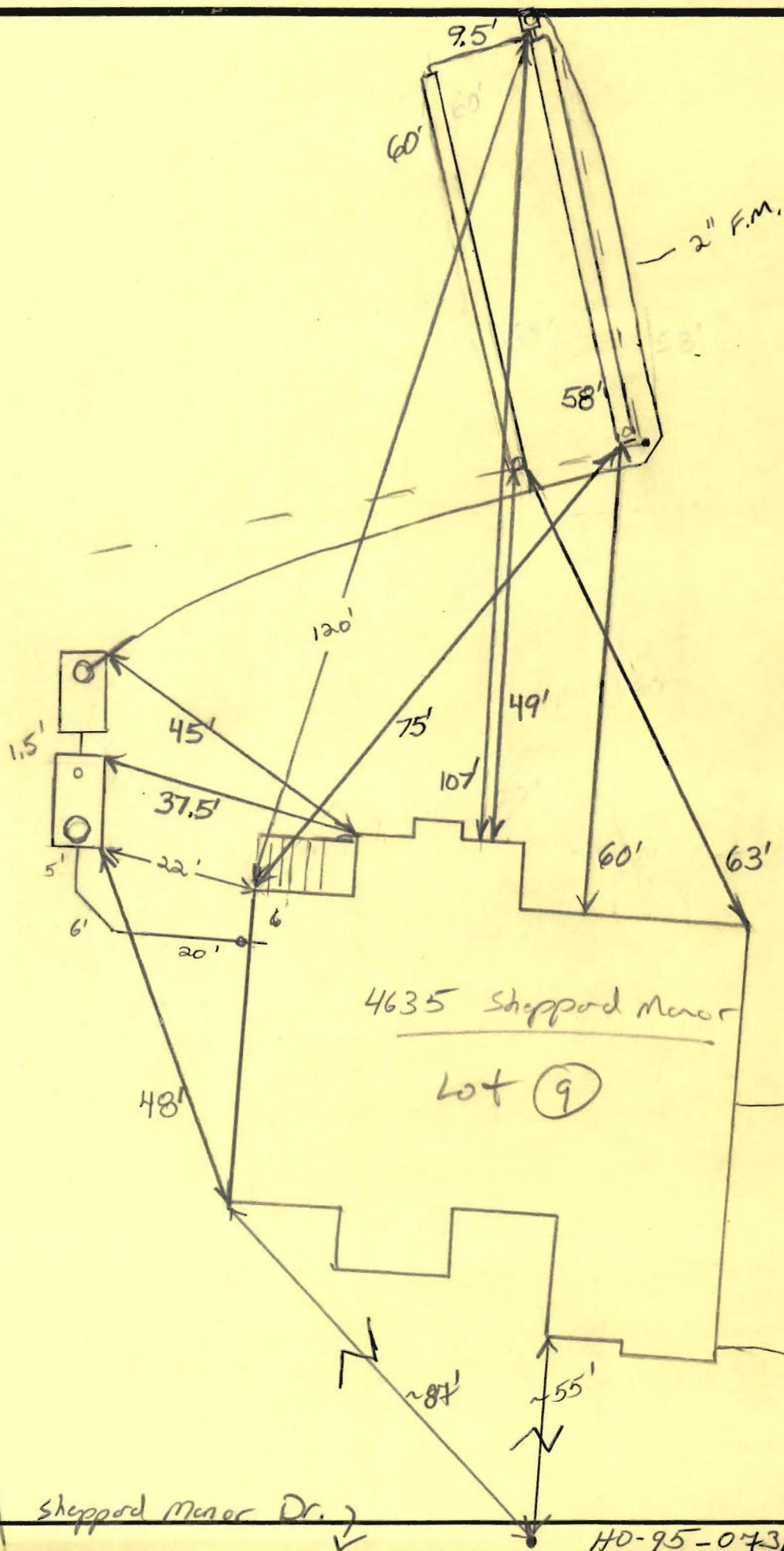



HOWARD COUNTY HEALTH DEPARTMENT

29564

DATE 9/11/08

Received From

Hatfield's Equipment

PHONE #

301.854.6012

☐ CASH

☒ CHECK

NO.

26023

For

Septic Permit - Sheppard Manor Lot 9

4635 Sheppard Manor Drive.

Five hundred ninety six dollars

\$

396.00

Received By

LLB [Signature]

Dollars

Septic Permit Fee
Paid to
Pot Trac Inc