



HOWARD COUNTY HEALTH DEPARTMENT

5 33219

DATE
4 / 28 / 10

Received
From

Angela Sophia Clean Inc.

PHONE #

☐ CASH

☒ CHECK

NO.

31997

For

Repair

14601 Roxbury Rd

Three hundred forty and 00/100

Dollars

\$

330 00

Received By

Mary & Gugg's

PUB. SEWER STATUS VERIFIED BY _____

ISSUE DATE: 4/28/10

APPROVAL DATE: 6/18/2010

PERMIT

P 533219

A REPAIR

~~Minor~~ Septic Repair

ON-SITE SEWAGE DISPOSAL SYSTEM HOWARD COUNTY HEALTH DEPARTMENT BUREAU OF ENVIRONMENTAL HEALTH

Fogles Septic Clean Inc. IS PERMITTED TO INSTALL ☐ ALTER ☒

ADDRESS: 580 Obrecht Road Sykesville, MD 21784 PHONE NUMBER: 410-795-5670

SUBDIVISION: _____ LOT NUMBER: _____

ADDRESS: 14601 Roxbury Road PROPERTY OWNER: Laura Wohlberg

SEPTIC TANK CAPACITY (GALLONS): N/A 2' Wide

PUMP CHAMBER CAPACITY (GALLONS): _____ Inlet 4'

NUMBER OF BEDROOMS: _____ Bottom 8'

SQUARE FEET OF HOUSE: _____

LINEAR FEET OF TRENCH REQUIRED: 96' 2-48' Trenches

TRENCHES:	
LOCATION:	
PURPOSE:	Replace pump in pump chamber and add an alarm to the system. Line between the septic tank and pump chamber needs to be repaired.

PLANS APPROVED: _____ DATE: _____

NOTE: PERMIT VOID AFTER 2 YEARS

NOTE: CONTRACTOR RESPONSIBLE FOR SCHEDULING A PRE-CONSTRUCTION INSPECTION FOR ALL INSTALLATIONS

NOTE: WATERTIGHT SEPTIC TANKS REQUIRED

NOTE: ALL PARTS OF SEPTIC SYSTEM SHALL BE 100 FEET FROM ANY WATER WELL

NOTE: MANHOLE RISERS REQUIRED ON ALL SEPTIC TANKS AND PUMP CHAMBERS

**NEITHER THE HOWARD COUNTY COUNCIL OR THE HEALTH DEPARTMENT IS
RESPONSIBLE FOR THE SUCCESSFUL OPERATION OF ANY SYSTEM
PERMITTEE RESPONSIBLE FOR OBTAINING FINAL APPROVAL ON THIS PERMIT
CALL 410-313-1771 FOR INSPECTION OF SEPTIC SYSTEM**

NOT TO SCALE

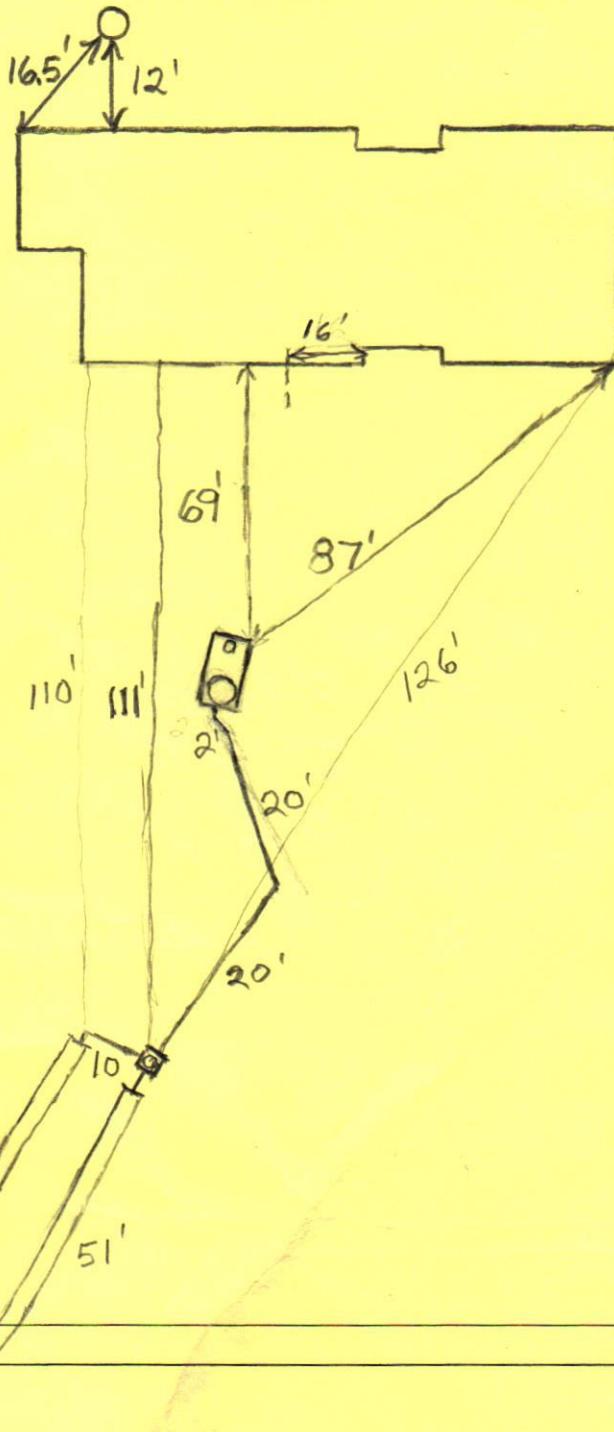

TRENCH/DRAINFIELD DATA

WIDTH	INLET	BOTTOM
2	2.5-4'	8'
NUMBER OF TRENCHES 2		
TOTAL LENGTH		
ABSORPTION AREA		
DISTRIBUTION BOX LEVEL Yes		
DISTRIBUTION BOX BAFFLE Yes		
DISTRIBUTION BOX PORT Yes		

SEPTIC TANK DATA

SEPTIC TANK 1 LEVEL

MANUFACTURER
CAPACITY GAL
SEAM LOC Midseam
TANK LID DEPTH 1.5'
BAFFLES Rear
BAFFLE FILTER No
MANHOLE LOC Rear
6" PORT LOC Front
WATERTIGHT TEST No
SLOTTED No

PUMP/SEPTIC TANK LEVEL N/A

MANUFACTURER
CAPACITY GAL
SEAM LOC
TANK LID DEPTH
BAFFLES
BAFFLE FILTER
MANHOLE LOC
6" PORT LOC
WATERTIGHT TEST
SLOTTED

PRE-CONSTRUCTION

INSTALLATION:

6/18/2010

FINAL INSPECTOR

B. Baker

DATE OF APPROVAL

6/18/2010