



**Howard County  
Health Department**

Maura J. Rossman, M.D., Health Officer

**Bureau of Environmental Health**

8930 Stanford Boulevard, Columbia, MD 21045

Main: 410-313-2640 | Fax: 410-313-2648

TDD 410-313-2323 | Toll Free 1-866-313-6300

[www.hchealth.org](http://www.hchealth.org)

Facebook: [www.facebook.com/hocohealth](https://www.facebook.com/hocohealth)

RECEIPT DATE: 8/7/20

**ONSITE SEWAGE DISPOSAL SYSTEM**

P 567932

**TANK**

**REPLACEMENT**

APPROVAL DATE: 08/27/2020 **PERMIT:**

A

PROPERTY ADDRESS: 4505 Ten Oaks Road

SUBDIVISION: \_\_\_\_\_

LOT: \_\_\_\_\_

TAX ID: 05-371554

CONTRACTOR: Billings Outback Septic

EMAIL: \_\_\_\_\_

CONTRACTOR ADDRESS: 180 Obrecht Road, Millersville, MD 21108

PHONE: 4103533880

PROPERTY OWNER: Jim Leveque

EMAIL: \_\_\_\_\_

OWNER ADDRESS: 4505 Ten Oaks Road, Dayton, MD 21036

PHONE: \_\_\_\_\_

SEPTIC TANK SIZE (GALLONS): 1500

PUMP CHAMBER CAPACITY (GALLONS): \_\_\_\_\_

PUMP SIZE: \_\_\_\_\_

NUMBER OF BEDROOMS: 4

HOUSE SQ. FT. 3,638

APPLICATION RATE: \_\_\_\_\_

DISTRIBUTION SYSTEM: GRAVITY FED ☒

LOW PRESSURE DOSED ☐

TRENCHES:	LINEAR FEET REQUIRED: _____	INLET DEPTH: _____
	TRENCH WIDTH: _____	MAXIMUM BOTTOM DEPTH: _____
	MINIMUM SPACE BETWEEN TRENCHES: _____	EFFECTIVE AREA BEGINNING DEPTH: _____
LOCATION:	TO BE STAKED BY SANITARIAN DURING PRE-CONSTRUCTION INSPECTION.	
NOTES:	Tank replacement. Current tank in poor shape.	

ISSUED BY: Susan Thomas

ISSUE DATE: 8/18/2020

EXPIRATION DATE: 8/18/2021

**NOTE: CONTRACTOR MUST SCHEDULE A PRE-CONSTRUCTION INSPECTION PRIOR TO BEGINNING ANY INSTALLATION**

**NOTE: CONTRACTOR MUST SCHEDULE AN INSPECTION AND GAIN APPROVAL OF ALL COMPONENTS PRIOR TO COVERING**

**NOTE: STONE MUST BE APPROVED BY HEALTH DEPARTMENT AND GRAVEL TICKET MUST BE AVAILABLE FOR REVIEW.**

**NOTE: WATERTIGHT SEPTIC TANKS REQUIRED**

**NOTE: ALL PARTS OF SEPTIC SYSTEM SHALL BE AT LEAST 100 FEET DOWNGRADIENT FROM ANY WATER WELL**

**NOTE: MANHOLE RISERS REQUIRED ON ALL SEPTIC TANKS AND PUMP CHAMBERS**

**NOTE: AN ELECTRICAL PERMIT IS REQUIRED FOR INSTALLATION OF ANY ELECTRICAL COMPONENTS OF THE SYSTEM**

☐ ELECTRICAL PERMIT ISSUED

E \_\_\_\_\_

**NOTE: THE HCHD DOES NOT WARRANTY ANY SYSTEM AND CANNOT GUARANTEE THE PERFORMANCE OF THIS SYSTEM AS DESIGNED. BY ACCEPTING THIS PERMIT, THE OWNER AND/OR APPLICANT ACKNOWLEDGE THAT THE SPECIFICATIONS DETAILED IN THIS DESIGN ARE ONE POSSIBLE OPTION AND THAT THE HCHD WILL REVIEW OTHER PROPOSALS. YOU HAVE THE OPTION TO SEEK THE ADVICE OF A QUALIFIED DESIGN CONSULTANT OR PROFESSIONAL ENGINEER FOR FURTHER GUIDANCE.**

**NOTE: MDE RECOMMENDS SEPTIC TANKS, BAT, AND OTHER PRETREATMENT UNITS BE PUMPED AT A FREQUENCY ADEQUATE TO ENSURE THAT SOLIDS ARE NOT DISCHARGED TO THE DISPOSAL AREA**

**NEITHER THE HOWARD COUNTY COUNCIL NOR THE HEALTH DEPARTMENT IS RESPONSIBLE FOR THE SUCCESSFUL OPERATION OF ANY SYSTEM.**

**PERMITTEE RESPONSIBLE FOR OBTAINING FINAL APPROVAL ON THIS PERMIT.**

**CALL 410-313-1771 TO SCHEDULE INSPECTIONS.**

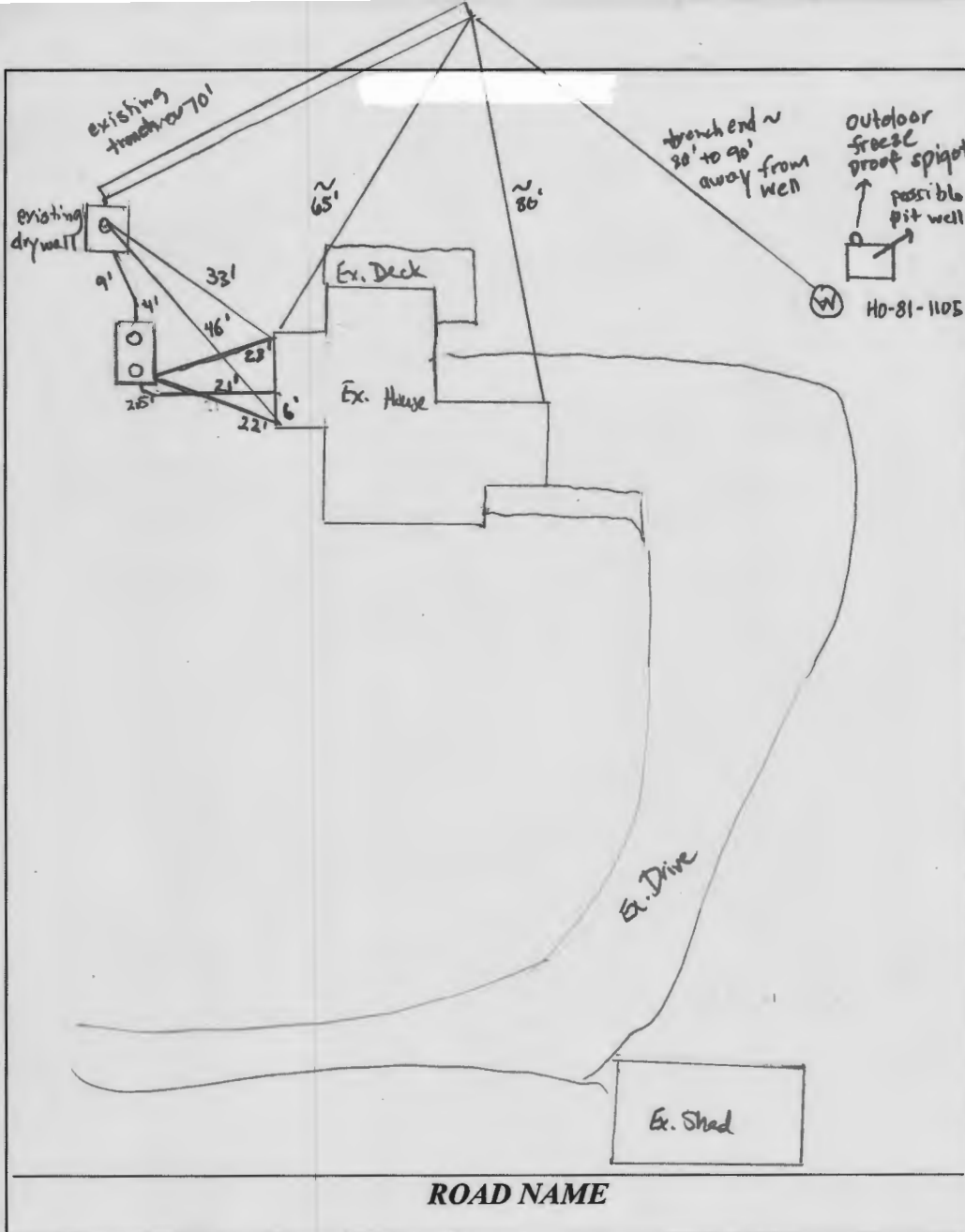

#### TRENCH/DRAINFIELD DATA

WIDTH	INLET	BOTTOM
unk	~ 3'	unk
NUMBER OF TRENCHES <u>1</u>		
TOTAL LENGTH <u>unknown</u>		
ABSORPTION AREA <u>drywell + trench</u>		
DISTRIBUTION BOX LEVEL <u>-</u>		
DISTRIBUTION BOX BAFFLE <u>-</u>		
DISTRIBUTION BOX PORT <u>-</u>		

#### SEPTIC TANK DATA

SEPTIC TANK 1 LEVEL	<u>yes</u>
MANUFACTURER	<u>Babylon</u>
CAPACITY	<u>1500</u> GAL
SEAM LOC	<u>top</u>
TANK LID DEPTH	<u>12" to 18"</u>
BAFFLES	<u>front &amp; back</u>
BAFFLE FILTER	<u>-</u>
MANHOLE LOC	<u>front &amp; back</u>
6" PORT LOC	<u>-</u>
WATERTIGHT TEST	<u>-</u>
SLOTTED	<u>yes</u>
DATE ON LID	<u>no date</u>

#### PUMP/SEPTIC TANK LEVEL

MANUFACTURER	_____
CAPACITY	_____ GAL
SEAM LOC	_____
TANK LID DEPTH	_____
BAFFLES	_____
BAFFLE FILTER	_____
MANHOLE LOC	_____
6" PORT LOC	_____
WATERTIGHT TEST	_____
SLOTTED	_____
DATE ON LID	_____

#### PRE-CONSTRUCTION:

8/18/2020 New tank will be set next to old tank, at least 10' from the house. Property line must be staked to ensure set back is met. Contractor will uncover both ends of trenches. If another trench is discovered, contractor will locate d-box and add ab. port. (ST)

#### INSTALLATION:

8/27/20 - new tank in place w/ solids line and SHC complete, old tank pumped out crushed & filled in w/ clean fill, 6" baffle on front of tank 14" baffle on back end, drywell located connected to new tank (retained) and c/p added to drywell, contractor located one existing trench coming off the drywell, approx 70' in length w/ 3' of cover #2 stone observed (the area where the trench was located had large ruts from equipment running back and forth over it), approx end of trench about 80'-90' away from existing well, possible pit well next to drilled well serving an outdoor spigot, drilled well (HO-81-1105) one piece cap which was loose and q/s'd while onsite. OK to backfill all work. (ST)

FINAL INSPECTOR

R. Rappaport

DATE OF APPROVAL

8/27/20

**Maura J. Rossman, M.D., Health Officer**

**INFORMATION FORM - SEPTIC SYSTEM REPAIR/UPGRADE**

**Reason for Request:**

- ☐ Failing System
- ☐ System relocation for proposed addition
- ☐ System upgrade for proposed addition
- ☐ Inadequate treatment zone
- ☒ Collapsed septic tank
- ☐ Collapsed drywell

**Has the septic tank been pumped within the last month?**

☐ Yes  
☒ No Date pumped: \_\_\_\_\_

**Was a visual inspection of the septic tank and/or drain fields conducted?**

☒ Yes Explain observation: CRACKED LID ON SINKER BLOCK  
TANK. POOR CONDITION.  
FIELD WAS PROBED & DRY TO 5'  
☐ No

**Existing system design**

- ☐ Drywell
- ☒ Trench
- ☐ Mound
- ☐ Unknown
- ☐ Other: \_\_\_\_\_

**Was a visual inspection of the sewage line conducted?**

☒ Yes NEW PVC PLUMBING OUT TO TANK  
☐ No

**Blockage Leading to the field**

☐ Yes Explain \_\_\_\_\_  
☒ No

**Is discharge surfacing on the ground?**

☐ Yes  
☒ No

**Additional Comments:**

TANK IN POOR SHAPE. LID CRACKED & PATCH BEFORE.  
NEWER 4" PVC HOUSE SEWER. NO Baffle. Blew out the  
SIDE OF THE TANK TO BRING NEW SEWER IN. NOT PATCHED

\*For REPAIRS, are the owners proposing, or do they plan to add in the future any additions or modifications to the property, i.e. pools, living space additions, garages, etc? This information must be disclosed at the time of this application. The Health Department will not be able to accommodate requests in the field for property modifications unrelated to the repair request. Such requests may require an additional fee, testing, and submittal of a Percolation Certification Plan, if the property does not meet current Code and Regulations.

Septic Contractor: Billing's OUTBACK SEPTIC Contractor's Phone: 410 353-3880  
Contractor's Address: 180 OBrecht Rd Millersville 21108  
Property Address: 4505 TEN OAKS RD County File: \_\_\_\_\_  
Subdivision: MITCHELL PROPERTY Lot: 1 Year Built: 1969  
Owner's Name: Jim Leveque Existing bedrooms: 4  
Name of previous owners: William Mitchell Existing bedrooms: \_\_\_\_\_  
Proposed bedrooms: \_\_\_\_\_

\*A Sanitarian will be in contact within three business days, depending upon the urgency of the situation, to coordinate the scheduling/review of the repair or upgrade.

\*Prior to scheduling inspections, scaled plans should be submitted to clarify the nature of the addition.\*

Print out a copy of Real Property Data via Dept. of Taxation website \_\_\_\_\_ Indexed file found \_\_\_\_\_

If soil/site conditions are limited and sewer and/or Metro District status is not conducive to connection, the Sanitarian may recommend pursuit of Emergency Sewer Extension or Emergency Metro District Inclusion. The Owner should contact the Bureau of Utilities for details.

No permit is to be issued nor inspection to be scheduled without prior fee collection at the office unless an emergency exists.

The contractor is to notify the office of the emergency as soon as possible.

2/2020

# Billing's Outback Septic

## Septic Certification

4505 Ten Oaks Rd  
Dayton Md

8/03/20

We have inspected the septic system. There is a cinderblock tank and drainfield. The rear baffle is in place. The front baffle is not present. The cinder block tank is in poor shape. The lid has been cracked and broken and patched with another piece of concrete. The new piping coming from the house has been stuffed into the tank and not sealed properly. This tank needs to be replaced with a new watertight concrete tank. Approximately 4500.00 for a new tank with permits.

A surge test was performed with no backup.

We probed the drainfield and it was not saturated.

Septic tank	Acceptable <input type="checkbox"/>	Unacceptable <input checked="" type="checkbox"/>
Absorption system	Acceptable <input checked="" type="checkbox"/>	Unacceptable <input type="checkbox"/>

*Gregory Billing*

Greg Billing  
AA-00157

Yes No

8/3/20

- |                                     |                                     |  |
|-------------------------------------|-------------------------------------|--|
| <input checked="" type="checkbox"/> | <input type="checkbox"/>            | Does the tank have a riser to grade  |
| <input type="checkbox"/>            | <input checked="" type="checkbox"/> | Front baffle present   |
| <input checked="" type="checkbox"/> | <input type="checkbox"/>            | Rear Baffle Present  |
| <input type="checkbox"/>            | <input checked="" type="checkbox"/> | Visible signs of previous backup.  |
| <input checked="" type="checkbox"/> | <input type="checkbox"/>            | All sewage from the home enter the septic tank<br>Including washing machine. |
| <input type="checkbox"/>            | <input checked="" type="checkbox"/> | Did sewage backup while doing the surge test.                                |
| <input type="checkbox"/>            | <input checked="" type="checkbox"/> | Was the tank pumped at the time of inspection.                               |
| <input type="checkbox"/>            | <input checked="" type="checkbox"/> | Any seepage or lush vegetation around disposal area.                         |
| <input type="checkbox"/>            | <input checked="" type="checkbox"/> | Is there an Effluent filter present that would need<br>Regular maintenance.  |

Size of septic tank 1000 gallons

Was tank pumped at time of inspection no



# HOWARD COUNTY HEALTH DEPARTMENT

67932

PS

DATE 8/17/20

Received From

Billing & Outback  
Septic Services

PHONE #

410 923-2500

For

-tank replacement -  
4505 Ten Oaks

☐ CASH

☒ CHECK

NO.

1354

One hundred sixty five <sup>RD.</sup> Dollars

\$

165.00

Received By

(Kemp)