



Howard County
Health Department

Maura J. Rossman, M.D., Health Officer

Bureau of Environmental Health

8930 Stanford Boulevard, Columbia, MD 21045

Main: 410-313-2640 | Fax: 410-313-2648

TDD 410-313-2323 | Toll Free 1-866-313-6300

www.hchealth.org

Facebook: www.facebook.com/hocohealth

RECEIPT DATE: 2/24/21

ONSITE SEWAGE DISPOSAL SYSTEM

P 568766

APPROVAL DATE: _____

PERMIT:

REPAIR

A _____

Tank Replacement

PROPERTY ADDRESS: 11633 Quarterfield Drive

SUBDIVISION: _____

LOT: _____

TAX ID: _____

CONTRACTOR: Fogles Septic Clean Inc

EMAIL: kim@foglesinc.com

CONTRACTOR ADDRESS: 580 Obrecht Road, Sykesville, MD 21784

PHONE: 410-795-5670

PROPERTY OWNER: Alex Carr

EMAIL: _____

OWNER ADDRESS: 11633 Quarterfield Drive, Ellicott City, MD 21042

PHONE: 303-710-5151

SEPTIC TANK SIZE (GALLONS): 1500g

PUMP CHAMBER CAPACITY (GALLONS): _____

PUMP SIZE: _____

NUMBER OF BEDROOMS: _____

HOUSE SQ. FT. _____

APPLICATION RATE: _____

DISTRIBUTION SYSTEM: GRAVITY FED ☐

LOW PRESSURE DOSED ☐

TRENCHES:	LINEAR FEET REQUIRED: <u>N/A</u>	INLET DEPTH: _____
	TRENCH WIDTH: _____	MAXIMUM BOTTOM DEPTH: _____
	MINIMUM SPACE BETWEEN TRENCHES: _____	EFFECTIVE AREA BEGINNING DEPTH: _____
LOCATION:	TO BE STAKED BY SANITARIAN DURING PRE-CONSTRUCTION INSPECTION.	
NOTES:	<u>Install 1500g. septic per layout.</u>	

ISSUED BY: _____ ISSUE DATE: _____ EXPIRATION DATE: _____

NOTE: CONTRACTOR MUST SCHEDULE A PRE-CONSTRUCTION INSPECTION PRIOR TO BEGINNING ANY INSTALLATION

NOTE: CONTRACTOR MUST SCHEDULE AN INSPECTION AND GAIN APPROVAL OF ALL COMPONENTS PRIOR TO COVERING

NOTE: STONE MUST BE APPROVED BY HEALTH DEPARTMENT AND GRAVEL TICKET MUST BE AVAILABLE FOR REVIEW.

NOTE: WATERTIGHT SEPTIC TANKS REQUIRED

NOTE: ALL PARTS OF SEPTIC SYSTEM SHALL BE AT LEAST 100 FEET DOWNGRADIENT FROM ANY WATER WELL

NOTE: MANHOLE RISERS REQUIRED ON ALL SEPTIC TANKS AND PUMP CHAMBERS

NOTE: AN ELECTRICAL PERMIT IS REQUIRED FOR INSTALLATION OF ANY ELECTRICAL COMPONENTS OF THE SYSTEM

☐ ELECTRICAL PERMIT ISSUED E _____

NOTE: THE HCHD DOES NOT WARRANTY ANY SYSTEM AND CANNOT GUARANTEE THE PERFORMANCE OF THIS SYSTEM AS DESIGNED. BY ACCEPTING THIS PERMIT, THE OWNER AND/OR APPLICANT ACKNOWLEDGE THAT THE SPECIFICATIONS DETAILED IN THIS DESIGN ARE ONE POSSIBLE OPTION AND THAT THE HCHD WILL REVIEW OTHER PROPOSALS. YOU HAVE THE OPTION TO SEEK THE ADVICE OF A QUALIFIED DESIGN CONSULTANT OR PROFESSIONAL ENGINEER FOR FURTHER GUIDANCE.

NOTE: MDE RECOMMENDS SEPTIC TANKS, BAT, AND OTHER PRETREATMENT UNITS BE PUMPED AT A FREQUENCY ADEQUATE TO ENSURE THAT SOLIDS ARE NOT DISCHARGED TO THE DISPOSAL AREA

NEITHER THE HOWARD COUNTY COUNCIL NOR THE HEALTH DEPARTMENT IS RESPONSIBLE FOR THE SUCCESSFUL OPERATION OF ANY SYSTEM.

PERMITTEE RESPONSIBLE FOR OBTAINING FINAL APPROVAL ON THIS PERMIT.

CALL 410-313-1771 TO SCHEDULE INSPECTIONS.

11633 Quarterfield Dr

NOT TO SCALE

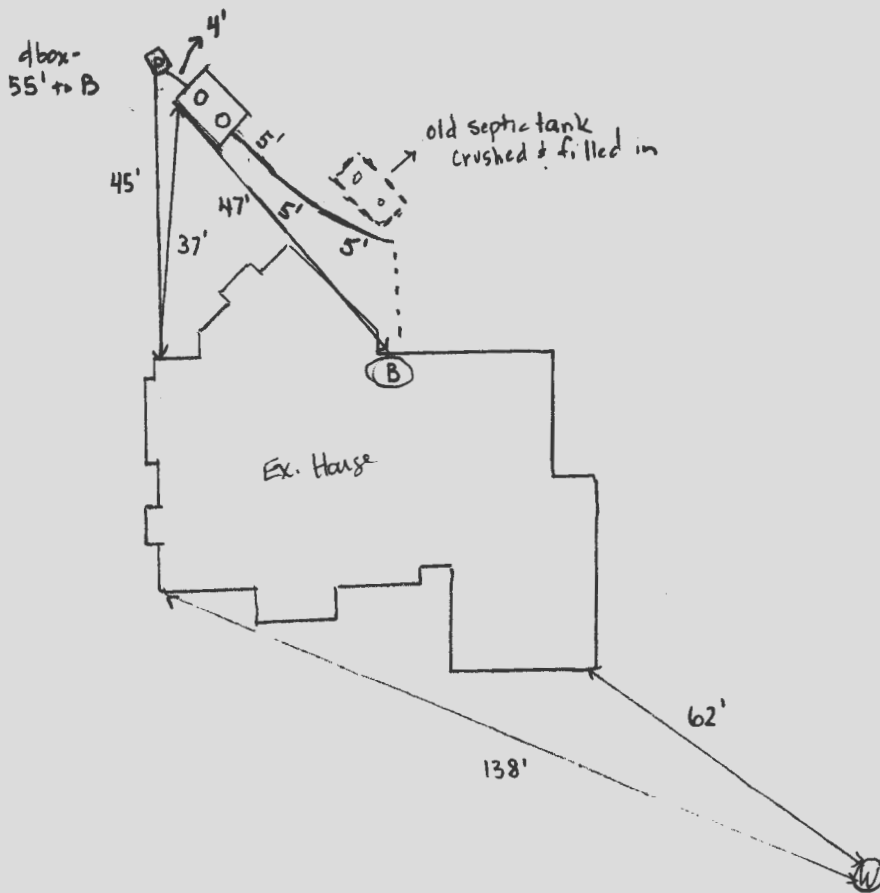

ROAD NAME

Quarterfield

TRENCH/DRAINFIELD DATA

WIDTH INLET BOTTOM

NUMBER OF TRENCHES _____
 TOTAL LENGTH _____
 ABSORPTION AREA _____
 DISTRIBUTION BOX LEVEL _____
 DISTRIBUTION BOX BAFFLE _____
 DISTRIBUTION BOX PORT _____

SEPTIC TANK DATA

SEPTIC TANK 1 LEVEL yes
 MANUFACTURER Baby-lon
 CAPACITY 1500 GAL
 SEAM LOC top
 TANK LID DEPTH 18"
 BAFFLES front 6" / back 4"
 BAFFLE FILTER -
 MANHOLE LOC front / back
 6" PORT LOC -
 WATERTIGHT TEST -
 SLOTTED yes
 DATE ON LID 12/15/20

PUMP/SEPTIC TANK LEVEL

MANUFACTURER _____
 CAPACITY _____ GAL
 SEAM LOC _____
 TANK LID DEPTH _____
 BAFFLES _____
 BAFFLE FILTER _____
 MANHOLE LOC _____
 6" PORT LOC _____
 WATERTIGHT TEST _____
 SLOTTED _____
 DATE ON LID _____

PRE-CONSTRUCTION:

3/10/21 Laid out 1500g tank location 21' from house foundation. Old tank location will be collapsed + filled and pipe will be rerouted over virgin ground. (S)

INSTALLATION: 3/11/21 Site insp. contractor on site finishing up the job, new sewer line tied into existing sewer line which runs to the side of the old septic tank, leads to the new 1500 gal tank, the existing dbox was much lower in the ground, a c/p was added to dbox and the septic outlet line was stepped down and connected to dbox, the final thing to be completed is collapsing the old tank and filling it in, contractor stated that it'd be done before he left the site (Jamie), ok to continue; backfill (S)

FINAL INSPECTOR R. Rappeport DATE OF APPROVAL 3/11/21

Howard County Health Department

Bureau of Environmental Health, Columbia, MD 21045 - 410-313-1771

SEWAGE DISPOSAL PERMIT NO. A-_____ P- 568766

RESIDENTIAL PERMIT ☐
(NUMBER OF BEDROOMS: _____)

COMMERCIAL PERMIT ☐
(DESIGN FLOW: _____ GPD)

PERMITEE:

Fogles Septic Clean Inc.

LOCATION:

11633 Quarterfield Road

****POST THIS CARD WHERE IT CAN BE SEEN FROM ROAD****

☐

STOP ALL CONSTRUCTION ON SEWAGE
DISPOSAL SYSTEM AND CONTACT HEALTH
DEPARTMENT BEFORE CONTINUING

Inspector _____

Date _____

☐

WORK IS SATISFACTORY, OK TO
CONTINUE

Inspector _____

Date _____

COMMENTS:

☐

FINAL INSPECTION MADE, OK TO
COVER ALL WORK

Inspector _____

Date _____

3/11/97
p.m. c.o.

PERMIT

SEWAGE DISPOSAL SYSTEM

DEPARTMENT OF HEALTH AND MENTAL HYGIENE

INDEXED

HOWARD COUNTY HEALTH DEPARTMENT

BUREAU OF ENVIRONMENTAL HEALTH

~~XXXXXXXX~~

313-2640

P 58016A

A 48839

DISTRICT 3rd

DATE 5/11/97

DATE SYSTEM APPROVED 3-18-97

INSPECTOR KM

Fogle's Septic Clean, Inc.

IS PERMITTED TO INSTALL X ALTER

ADDRESS 558 Obrecht Road, Sykesville, Maryland 21784 PHONE 795-5674

SUBDIVISION Quarterfield LOT 23 ROAD 11635 Quarterfield Drive

PROPERTY OWNER Dr. Diane Feng

ADDRESS

SEPTIC TANK CAPACITY 1000 GALLONS

NUMBER OF BEDROOMS 3

180 SQUARE FEET PER BEDROOM

LINEAR FEET OF TRENCH REQUIRED 135

TRENCHES - Trench to be 2 feet wide. Inlet 4 feet below original grade. Bottom maximum depth 8 feet below original grade. Effective area begins at 4 feet below original grade. 4 feet of stone below distribution pipe.

LOCATION - Begin trenches 175.00 feet up the left lot line and 75 feet off that same lot line as seen when facing the lot from Quarterfield Road. Run trenches on contour in both directions.

NOTES - No trench to exceed 100 feet in length. Provide 6" - 8" diameter cleanout and cap to grade or above on septic tank. OK/ML

PLANS APPROVED BY Amy McMillen

DATE 09/30/96

COVER NO WORK UNTIL INSPECTED AND APPROVED

NEITHER THE HOWARD COUNTY COUNCIL NOR THE HEALTH DEPARTMENT IS RESPONSIBLE FOR THE SUCCESSFUL OPERATION OF ANY SYSTEM

NOTE: CLEANOUT REQUIRED EVERY 70 FEET OF SEWER LINE AND/OR AT 90° SWEEPS IN LINES FROM HOUSE TO DRAIN FIELDS, 90° ELBOWS NOT ACCEPTABLE.

NOTE: ALL PARTS OF SEPTIC SYSTEMS (I.E. TANK, DISTRIBUTION BOX TRENCHES) TO BE 100 FEET FROM WELL (UNLESS OTHERWISE SPECIFICALLY AUTHORIZED)

NOTE: IF DEEP TRENCH(ES) ARE USED CALL FOR INSPECTION BEFORE AND AFTER PLACING GRAVEL IN TRENCH(ES)

NOTE: NO DRY WELL SHALL EXCEED 15 FOOT IN DIAMETER NO ABSORPTION TRENCH TO EXCEED 100 FEET IN LENGTH

NOTE: ALL PIPE FROM HOUSE TO SEPTIC TANK MUST BE CAST IRON OR SCHEDULE 35/40 PVC OR ABS

PERMIT VOID AFTER TWO YEARS

NOTE: INSTALL STAND PIPE ON SEPTIC TANK AND DRY WELL STAND PIPES MUST BE 6 INCHES IN DIAMETER CAST IRON, CONCRETE OR TERRA COTTA OR PVA OR ABS ACCEPTED. IF TOP OF SEPTIC TANK IS DEEPER THAN 3 FEET, MANHOLE TO GRADE REQUIRED. check

NOTE: DISTRIBUTION BOXES MUST HAVE BAFFLES

***INSTALLER IS RESPONSIBLE FOR OBTAINING FINAL APPROVAL ON THIS PERMIT**

***CALL 461-9933 FOR INSPECTION OF SEPTIC SYSTEM.**

HD-260(6-90)

OLD PERMIT SIGNED

AND RETURNED 7-9-98

Sealed # BWH 12883

A 48839

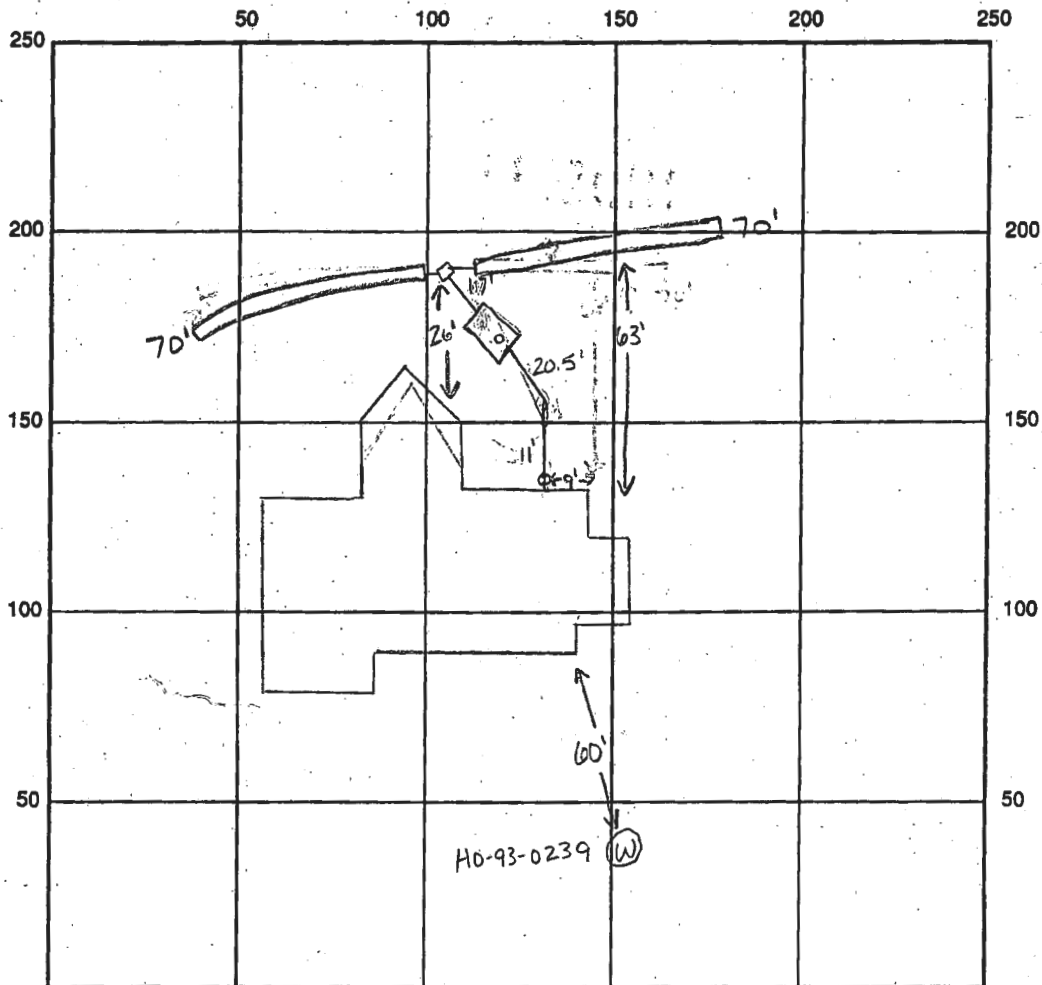

INDICATE NORTH - NAME ADJOINING ROADWAY AS BASE LINE Quarterfield Drive

SEPTIC TANK LEVEL OK, 1000 gallons CLEANOUTS 1 on tank, 1 at house

DISTRIBUTION BOX LEVEL OK

DRAIN FIELD/TITLE DEPTH 8 FT. TRENCH WIDTH 2 FT. INLET DEPTH 4 FT.

EFFECTIVE GRAVEL DEPTH 4 FT. TOTAL LENGTH 70x2 FT. → 140

NUMBER OF TRENCHES 2 ONE SIDEWALL/BOTTOM AREA 560 SQ. FT.

DRYWALL INSIDE DIAMETER — FT. EFFECTIVE DEPTH BELOW INLET — FT.

ABSORBENT AREA — SQ. FT.

REMARKS: 3-17-97 house conn. made, OK to continue leaving ends open on trenches,

OK to cover up to distribution box KM

3-18-97 WPT OK to cover well line, P.A. 4' below grade, casing 1.5' above grade,

2 piece watertight cap

OK to cover all work KM

DATE SYSTEM APPROVED 3-18-97

INSPECTOR Kimberley Maisto

FOGLE'S SEPTIC CLEAN, INC.
 580 Obrecht Road • Sykesville • Maryland 21784
 (410) 795-5670

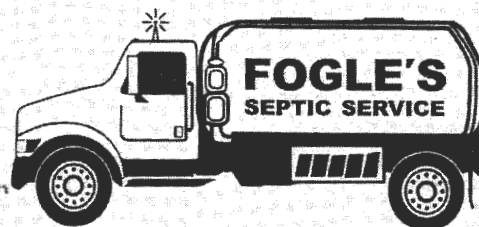

SEPTIC EVALUATION

acarr 4379@comcast.net 303-710-5151 4/20/21 4:30pm

<input checked="" type="checkbox"/> Buyer / <input type="checkbox"/> Seller	Date: 4/20/21	Time: 11:00am	Occupied? <input type="checkbox"/> Yes / <input checked="" type="checkbox"/> No
Client: <u>Alex Carr</u>	Ordered By: <u>Michael Ball</u>	If vacant, how long? <u>~ a few wks</u>	
Property Address:	Phone: <u>410-707-7787</u>	Last pumped: ? <u>2019-Fogles</u>	
<u>11633 Quarterfield DR.</u>	email: <u>Michael@michaelmball.com</u>	Property age: <u>1997</u>	# Bedrooms: <u>5</u>
<u>Ellicott City, MD 21042</u>	Weather:	County Records: <input checked="" type="checkbox"/> Requested <input type="checkbox"/> Not Received	
	Ground Conditions:	Confirmed: <input checked="" type="checkbox"/> Yes <input type="checkbox"/> Left Message	

Liquid level: <input type="checkbox"/> Above Normal / <input checked="" type="checkbox"/> Normal / <input type="checkbox"/> Below normal	Depth of tank: <u>1'</u>
Maintenance Appears: <input type="checkbox"/> Good / <input type="checkbox"/> Fair / <input checked="" type="checkbox"/> Poor	Access to tank: <u>6" x 10</u>
Effluent Filter present? <input type="checkbox"/> Yes / <input checked="" type="checkbox"/> No	Pump system: <input type="checkbox"/> Yes / <input checked="" type="checkbox"/> No

Type of Tank	Tank Composition & Size	Type of Absorption System
<input checked="" type="checkbox"/> Septic Tank (1 tank)	<input type="checkbox"/> Metal <input checked="" type="checkbox"/> Concrete <input type="checkbox"/> Unknown	<input checked="" type="checkbox"/> Drainfield <u>2</u>
<input type="checkbox"/> Cesspool	Tank Size: <u>1000g</u>	<input type="checkbox"/> Drywell
<input type="checkbox"/> Aeration System	Baffles intact? <input checked="" type="checkbox"/> Yes / <input type="checkbox"/> No <u>Conc.</u>	<input type="checkbox"/> Sandmound
<input type="checkbox"/> Other:		<input type="checkbox"/> Other:

Inspected System Appears:	Inspector's Comments	Sketch of System
<input type="checkbox"/> Functional <input type="checkbox"/> Marginal <input checked="" type="checkbox"/> Unsatisfactory	Septic tank needs to be etc and cleaned due to the tremendous amt. of solids present. Approx cost \$400 Drainfields have dry clean stone. This is a 31m septic system. There is limited area to increase the septic area on this lot. We recommend contacting HCHD or an engineer to recommend a course of action.	
Inspector:		
Signature: <u>K. Russell</u>		
Inspection Fee: <u>275</u>		
Locate/Hand Digging Fee:		
Water Test: <input type="checkbox"/> U&O <input type="checkbox"/> Lead <input type="checkbox"/> Nitrite		
Water Test Other:		
Amount Due:		
Check # <u>CC info on file</u>		

1 hr well yield ~~22~~ ~~23~~ ~~24~~ \$260
 IMPORTANT: 2/1/21 8a-9a

- This is a subjective and visual inspection only, based upon many unknown and unseen factors.
- The condition of the Sewage Disposal system is reported as of the above date.
- This report does not WARRANT nor GUARANTEE continued functional Sewage Disposal System operations.
- If house has been unoccupied, this report may not be accurate. Little or no use of the septic system could have allowed the problems to temporarily clear themselves.
- If a larger family is moving in than is presently occupying the house, the septic system may be subject to failure.
- If the general ground condition is wet, this report may not be accurate, as ground moisture may cover or hide actual septic effluent on the surface.
- In the above cases, it is strongly suggested that the septic system be re-certified in 3 to 6 months.
- If the system is rated below as marginal or unsatisfactory, it is suggested that the local health department be contacted to inspect and confirm the findings.

Payment for this inspection signifies understanding and acceptance of above clauses.