

MARYLAND DEPARTMENT OF THE ENVIRONMENT, WATER MANAGEMENT ADMINISTRATION  
1800 Washington Blvd., Baltimore, Maryland 21230 (410) 537-3784

WATER WELL ABANDONMENT-SEALING REPORT FORM

SUBMIT COPIES OF COMPLETED FORM TO:

- \* COUNTY ENVIRONMENTAL AGENCY (contact MDE, WMA if address needed)
- \* WELL OWNER
- \* MDE, WATER MANAGEMENT ADMINISTRATION, WELL PROGRAM

DATE WELL ABANDONED: September 3, 2021 (month/day/year)

\* PERMIT NUMBER OF ABANDONED WELL (if any)

\* PERMIT NUMBER OF REPLACEMENT WELL:

\* PERSON ABANDONING WELL: FRANK SINGLETON

WELL DRILLER'S LICENSE NUMBER: WRD 046

\* OWNER'S NAME: Ted Evans

CIRCLE: MWD / MSD / MGD

\* WELL LOCATION:

COUNTY: Howard

NEAREST TOWN: HIGHLAND

TAX MAP BLOCK PARCEL

SUBDIVISION:

SECTION: LOT:

STREET ADDRESS: 13043 ST. PATRICKS CT

LATITUDE 39.184233

LONGITUDE 76.967728

\* TYPE OF WELL BEING ABANDONED:

- ☒ DRILLED ☐ JETTED
- ☐ BORED ☐ HAND DUG
- ☐ OTHER (specify)

\* USE CODE:

- ☒ DOMESTIC ☐ MUNICIPAL/PUBLIC
- ☐ IRRIGATION ☐ INDUSTRIAL
- ☐ TEST/OBSERVATION ☐ GEOTHERMAL

\* TYPE OF CASING:

- ☒ STEEL ☐ PLASTIC
- ☐ CONCRETE ☐ OTHER (specify)

SIZE OF CASING: 6 INCHES IN DIAMETER

DEPTH OF WELL: 300 FEET DEEP

WAS ANY CASING REMOVED? ☒ YES ☐ NO

If yes, length removed, in feet: 3

WAS CASING RIPPED OR PERFORATED? ☐ YES ☒ NO

SIGNATURE-MASTER WELL DRILLER OR SUPERVISING SANITARIAN Beany F. Eastman LICENSE# 040

COUNTY

Reason:

Approved 10/26/2021 Panag

HO - 73 - 1380

HO - 94 - 3105

SITE LOCATION MAP

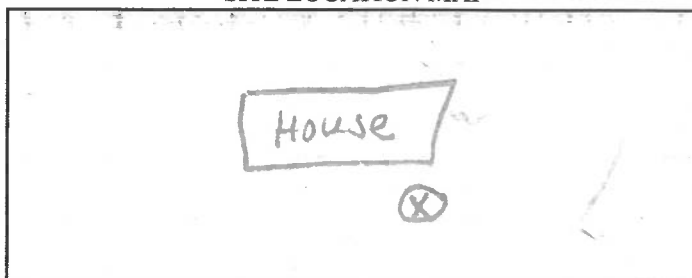

LOG OF SEALING MATERIAL

MATERIAL	FEET	
	FROM	TO
Bentonite	300	2
TOP SOIL	2	0
VOLUME OF MATERIAL USED		
900 # Bentonite mixed w/ slurry		

Pursuant to § 10-624 of the State Govt. Article of the Maryland Code, personal info requested on this form is used in processing this form pursuant to COMAR 26.04.04. Failure to provide the info may result in this form not being processed. You have the right to inspect, amend, or correct this form. The Maryland Department of the Environment is subject to the Maryland Public Information Act. This form may be made available on the Internet via MDE's website and is subject to inspection or copying, in whole or in part, by the public and other governmental agencies, if not protected by federal or State Law.

MWD / MSD / MGS

CIRCLE ONE

DATE



## Search Result for HOWARD COUNTY

1. This screen allows you to search the Real Property database and display property records.
2. Click **here** for a glossary of terms.
3. Deleted accounts can only be selected by Property Account Identifier.