

PERMIT NUMBER: B 23000072

DATE ACCEPTED:

DILP 2023 JAN 10 10:10:10

RESIDENTIAL BUILDING PERMIT APPLICATION					
HOWARD COUNTY DEPARTMENT OF INSPECTIONS, LICENSES, AND PERMITS 3430 COURT HOUSE DRIVE, ELLICOTT CITY, MD 21043 - PHONE: (410) 313-2455 OPTION #4 www.howardcountymd.gov					
BUILDING SITE ADDRESS REQUIRED					
Street Address: 10525 Pudding Lane					Unit:
City: Ellicott City			State: MD		Zip Code: 21042
Subdivision/Village/Complex Name: Kingsley Woods				SDP/WP/BA #:	
Lot: 30	Tax Map: 0023	Parcel: 0148	Grading Permit #:		
DESCRIPTION OF WORK REQUIRED					
Existing Use: SFD		Proposed Use: stairs		Estimated Cost: \$4,000.00	
Trade Work to Be Completed (Separate Permits Required): <input type="checkbox"/> Mechanical (HVACR) <input type="checkbox"/> Electrical <input type="checkbox"/> Plumbing <input checked="" type="checkbox"/> None					
Adding Stairs and landing to an existing deck/porch					
PROPERTY OWNER INFORMATION REQUIRED					
Owner(s) Name(s) (As it appears on tax records): Robert k Buck - Holly A Buck					Primary Residence: <input checked="" type="checkbox"/> Yes <input type="checkbox"/> No
Owner's Street Address: 10525 Pudding Lane					
City: Ellicott City			State: MD		Zip Code: 21042
Phone: (410) 977-1254			Email: ken.buck@national-delivery.com		
APPLICANT NAME REQUIRED - INDIVIDUAL WHO SIGNS THIS APPLICATION					
Business Name: same as property owner			Contact Name:		
Street Address:					
City:			State:		Zip Code:
Phone:			Email:		
CONTRACTOR INFORMATION REQUIRED					
Business Name: owner to construct					
Licensee's Name:			License #:		
Street Address:					
City:			State:		Zip Code:
Phone:			Email:		
ARCHITECT/ENGINEER INFORMATION INDIVIDUAL WHO SIGNED PLANS, IF APPLICABLE					
Business Name:			Name:		
Street Address:					
City:			State:		Zip Code:
Phone:			Email:		
BUILDING CHARACTERISTICS REQUIRED					
Primary Structure: <input checked="" type="checkbox"/> SF Dwelling <input type="checkbox"/> SF Townhouse <input type="checkbox"/> SF Duplex <input type="checkbox"/> Mobile Home <input type="checkbox"/> Multi-Family Dwelling (MF*)					Condo: <input type="checkbox"/> Yes <input checked="" type="checkbox"/> No
Utilities: <input checked="" type="checkbox"/> Electric <input checked="" type="checkbox"/> Gas		Water Supply: <input type="checkbox"/> Public <input checked="" type="checkbox"/> Private (Well)		Sewage Disposal: <input type="checkbox"/> Public <input checked="" type="checkbox"/> Private (Septic)	
Heating System: <input checked="" type="checkbox"/> Electric <input checked="" type="checkbox"/> Natural Gas <input type="checkbox"/> Propane <input type="checkbox"/> Other:			Roadside Tree Project: <input checked="" type="checkbox"/> No <input type="checkbox"/> Yes: #		
Sprinkler System: <input type="checkbox"/> NFPA 13 <input checked="" type="checkbox"/> NFPA 13R <input type="checkbox"/> NFPA 13D <input type="checkbox"/> None			Fire Alarm System: <input type="checkbox"/> Yes <input checked="" type="checkbox"/> No <input type="checkbox"/> Voice Evac		
ADDITIONAL RESIDENTIAL INFORMATION (PLEASE SELECT/COMPLETE ALL THAT APPLY)					
Model Name & Options: Parkhurst					
# of Bedrooms (SF): 5	# of efficiency units (MF*):	# of 1 BR (MF*):	# of 2 BR (MF*):	# of 3 BR (MF*):	
# Rooms:	# Full Baths: 5	# Half Baths: 2	# Fireplaces:		
Garage/Carport Info: <input checked="" type="checkbox"/> Attached Garage <input type="checkbox"/> Detached Garage <input type="checkbox"/> Integral Garage <input type="checkbox"/> Carport <input type="checkbox"/> None					
Basement/Foundation Info: <input type="checkbox"/> Slab on Grade <input type="checkbox"/> Post & Pier <input type="checkbox"/> Unfinished Basement <input checked="" type="checkbox"/> Finished Basement: <input type="checkbox"/> Full or <input checked="" type="checkbox"/> Partial					
1 st Fl Width:	1 st Fl Depth:	2 nd Fl Width:	2 nd Fl Depth:	Bsmt Width:	Bsmt Depth:
Energy Method: <input type="checkbox"/> Prescriptive <input type="checkbox"/> Performance <input type="checkbox"/> UA Alternative <input type="checkbox"/> ERI		Gross Area:		sq ft	Occupiable Area: sq ft
AGREEMENT/ DISCALIMER REQUIRED					
THE UNDERSIGNED HEREBY CERTIFIES AND AGREES AS FOLLOWS: (1) THAT HE/SHE IS AUTHORIZED TO MAKE THIS APPLICATION; (2) THAT THE INFORMATION IS CORRECT; (3) THAT HE/SHE WILL COMPLY WITH ALL REGULATIONS OF HOWARD COUNTY WHICH ARE APPLICABLE THERETO; (4) THAT HE/SHE WILL PERFORM NO WORK ON THE ABOVE REFERENCED PROPERTY NOT SPECIFICALLY DESCRIBED IN THIS APPLICATION; (5) THAT HE/SHE GRANTS COUNTY OFFICIALS THE RIGHT TO ENTER ONTO THIS PROPERTY FOR THE PURPOSE OF INSPECTING THE WORK PERMITTED AND POSTING NOTICES.					
APPLICANT'S ORIGINAL SIGNATURE			DATE SIGNED: 1-10-23		
FOR OFFICE USE ONLY					
CHECKS PAYABLE TO: DIRECTOR OF FINANCE OF HOWARD COUNTY					
AGENCIES REQUIRED/APPROVALS:					
<input type="checkbox"/> PR	<input type="checkbox"/> DPZ	<input type="checkbox"/> DED	<input checked="" type="checkbox"/> Health	<input type="checkbox"/> SHA	<input type="checkbox"/> CID
SUBMITTAL FEES: \$55.00		PAYMENT:		ACCEPTED BY: OK	

PROFESSIONAL CERTIFICATION: I HEREBY CERTIFY THAT THESE DOCUMENTS WERE PREPARED BY ME OR UNDER MY RESPONSIBLE CHARGE, AND THAT I AM A DULY LICENSED PROFESSIONAL LAND SURVEYOR UNDER THE LAWS OF THE STATE OF MARYLAND, LICENSE NO. 21328, EXPIRATION DATE 1/8/23.

LEGEND:

- BRL BUILDING RESTRICTION LINE
- WELL LOCATION
- T.W. TOP OF WALL
- C.F. CARAGE FLOOR
- B.F. BASEMENT FLOOR
- PERC PASSED PERC LOCATION
- SCF FAILED PERC LOCATION
- SEWAGE DISPOSAL AREA
- WELL BOX AREA
- SILT FENCE
- SUPER SILT FENCE
- LIMITS OF DISTURBANCE
- PROPOSED TREE
- PROPOSED TREE
- STONE CONSTRUCTION ENTRANCE

NOTE:
TOTAL LIMITS OF DISTURBANCE (LOD) = 40,658 SQ. FT.

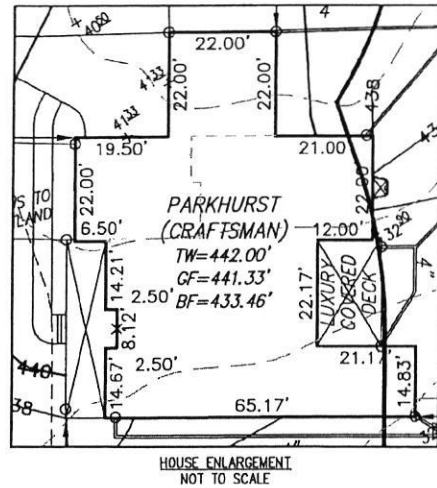

BUILDING SETBACKS (B.R.L.'s) SHOWN HEREON PER SITE DEVELOPMENT PLAN
SETBACK DISTANCES SHOWN HEREON AS "±" HAVE AN ACCURACY OF ±0.1' FOOT.

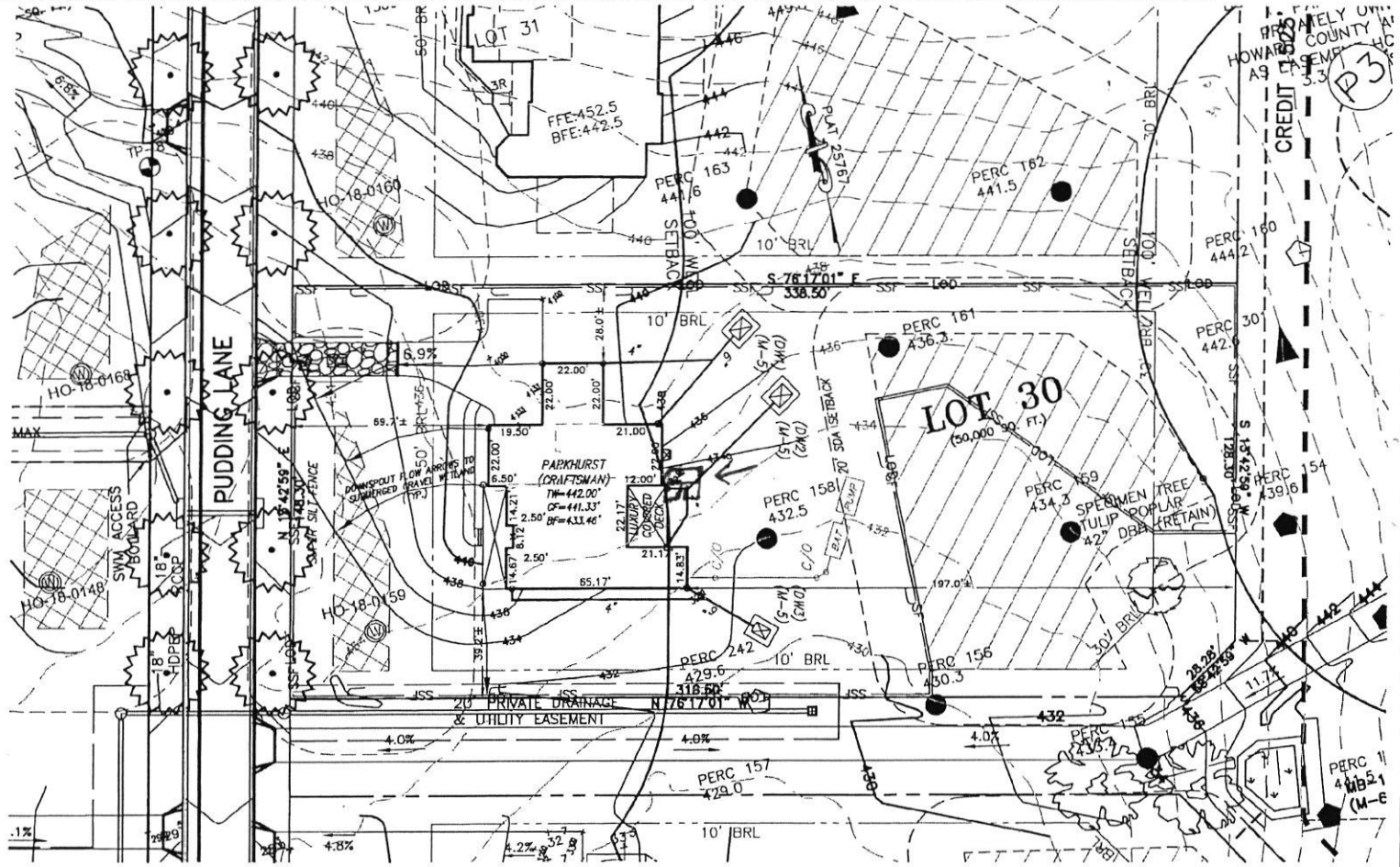

HOUSE TYPE: PARKHURST (CRAFTSMAN)

INTERIOR WET BAR
TWO CAR SIDE ENTRY GARAGE
FINISHED LOWER LEVEL
WALK-OUT BASEMENT
ADDITIONAL TWO CAR FRONT ENTRY GARAGE
POWDER ROOM - FINISHED BASEMENT
MULTI-GENERATIONAL SUITE ADDITION
WALK-OUT COVER DECK
WET BAR - FINISHED BASEMENT
MEDIA ROOM - FINISHED BASEMENT
DOUBLE WIDE DRIVEWAY TAIL
DAYLIGHT WINDOW/WELL IN BASEMENT

OPTION No. 003
OPTION No. 012
OPTION No. 013
OPTION No. 017
OPTION No. 263019
OPTION No. 263036
OPTION No. 263073
OPTION No. 263169
OPTION No. 561
OPTION No. 562
OPTION No. 851
OPTION No. 543

WELL NUMBER: HO-18-0159

ADDRESS: 10525 PUDDING LANE
ELLICOTT CITY, MD 21042

PLOT PLAN
LOT 30
KINGS FOREST
LIBER 11372, FOLIO 431
PLAT NO. 25767
2nd ELECTION DISTRICT
HOWARD COUNTY, MARYLAND

ESE CONSULTANTS

ENGINEERING • PLANNING • SURVEYING • ENVIRONMENTAL

ESE Consultants, Inc.
6731 Columbia Gateway Drive • Suite 120 • Columbia, MD 21046
T: 410-872-9105

DATE: 02/05/2022
CHK'D: M.J.B.

SCALE: 1"= 40'
JOB NO: 3502

FILE: PP LOT 30 Parkhurst Craftsman
DRAWN: V.X.P.

DRAWING FOR STAIR AND LANDING ADDITION

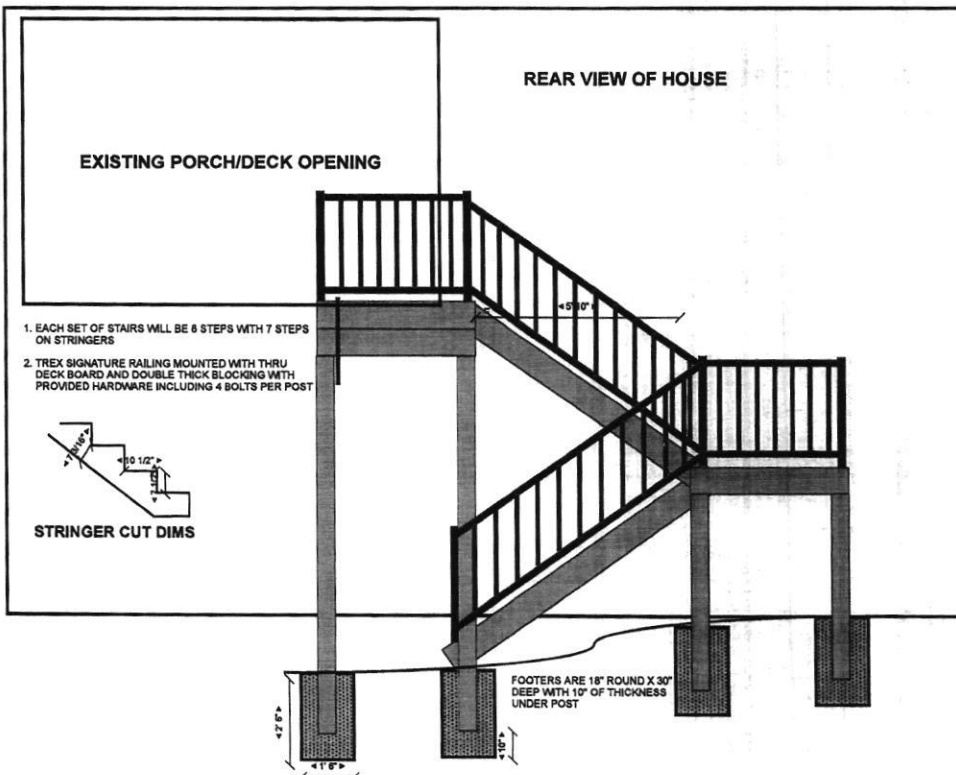
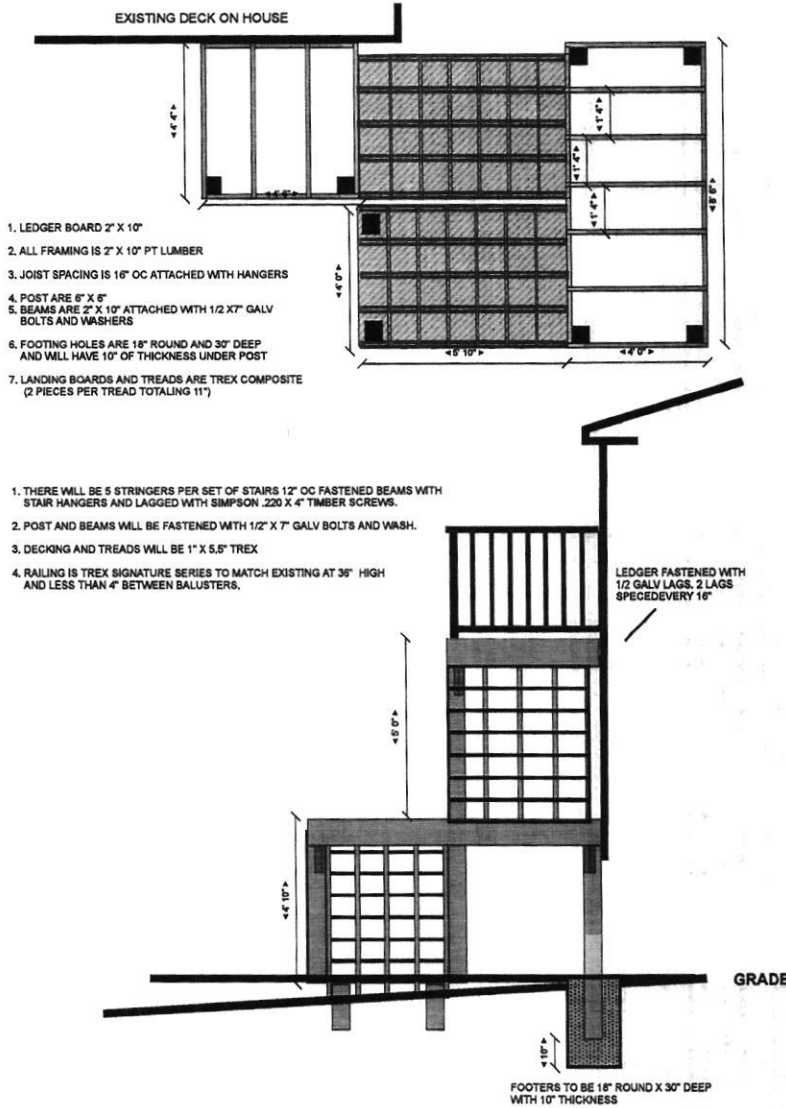

Product Options

LOOK A

Continue with Step 1+2 to pick your aluminum posts.

LOOK B

Jump to Steps 1, 2a and 2b on page 22 to pick your composite posts.

STEP 1+2: PICK AN ALUMINUM POST STYLE

1+2 ALUMINUM POST

Use for a traditional aluminum post look.



Heights

37", 43"
53"

Applications

Horizontal
Stair



1+2 ALUMINUM CROSSOVER POST

Use for a continuously graspable top rail.



Heights

36", 42"

Applications

Horizontal, Stair*



*Stair crossover applications can only be achieved with the use of a swivel crossover bracket. See page 53 (Item# XX25RCSW5CBKTAL).

1+2 ALUMINUM JOIST MOUNT POST

Use with steel deck framing or wood framing.

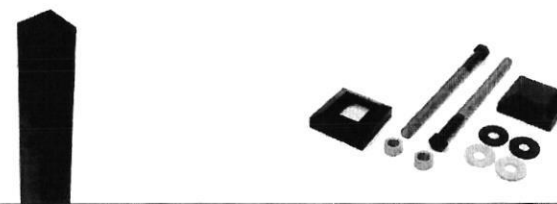

Heights

63"

Applications

Horizontal



1+2 ALUMINUM POST WITH PREMOUNTED BRACKETS

Use for simple and quick post applications.



Heights

37", 43"

Applications

Horizontal

Brackets

Line, End, Corner



Simplify Step 3 by choosing Assembled Square Baluster Panels, shown on page 23.

STEPS 1, 2A, 2B: PICK A COMPOSITE POST STYLE**1****POST SLEEVE**

Each 4" x 4" and 6" x 6" post sleeve fits over a 4" x 4" pressure treated post or equivalent post mount. 6" x 6" width only available in Classic White.



Heights
39", 108"

Widths
4" x 4", 6" x 6"

**2a****POST SLEEVE CAP**

6" x 6" width only available in Classic White.



Widths
4" x 4", 6" x 6"



*Opt for a post cap light variation.
Details on page 60.*

2b**POST SLEEVE SKIRT**

6" x 6" width only available in Classic White.

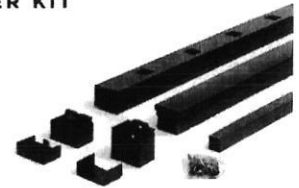

Widths
4" x 4", 6" x 6"

**STEP 3: GO WITH A RAIL KIT****3****ALUMINUM RAIL & SQUARE BALUSTER KIT**

Heights
36", 42"

Lengths
6', 8'

Applications
Horizontal, Stair

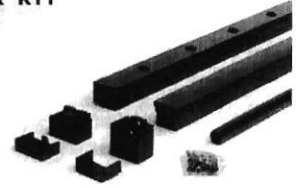
**3****ALUMINUM RAIL & ROUND BALUSTER KIT**

Heights
36", 42"

Lengths
6', 8'

Applications
Horizontal, Stair

**3****ASSEMBLED SQUARE BALUSTER PANEL**

Use for simple and quick rail applications. Brackets sold separately.

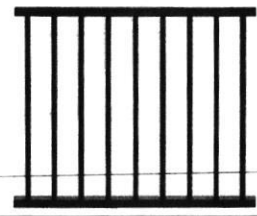

Heights
36", 42"

Lengths
4', 6', 8'

Applications
Horizontal



Look A: Aluminum Posts

Keep it consistent with aluminum posts and rails, available in three powder-coated colors.

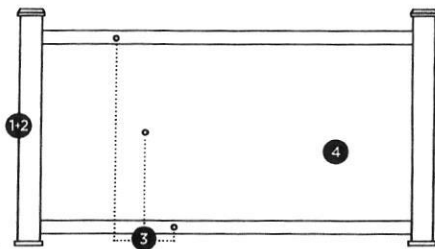

- 1-2 ALUMINUM POST + CAP & SKIRT**
- 3 RAIL KIT: TOP RAIL, BOTTOM RAIL, INFILL**
- 4 MESH OR GLASS INFILL PANEL**

ALUMINUM RAILING

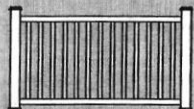

COLORS:



1-2 3

ROD RAIL

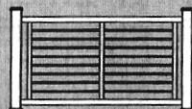

COLOR COMBINATIONS:



First color denotes rails; second color denotes infill.

1-2 3

MESH RAILING

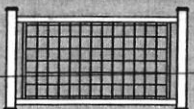

COLORS:



Mesh is 316 mill-finish stainless steel.

SS

1-2 3 4

GLASS RAILING

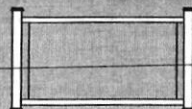

COLORS:



1-2 3 4

Look B: Composite Posts

Create a mixed materials look with Trex Post Components and aluminum rails. The addition of composite allows for even more color combinations.

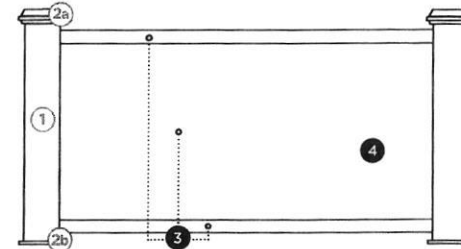
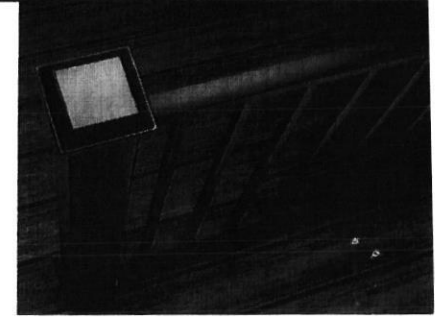

- 1 POST SLEEVE**
- 2a POST SLEEVE CAP**
- 2b POST SLEEVE SKIRT**
- 3 RAIL KIT: TOP RAIL, BOTTOM RAIL, INFILL**
- 4 MESH OR GLASS INFILL PANEL**

ALUMINUM RAILING

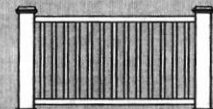

COLORS:



1 2a 2b 3

ROD RAIL

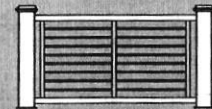

COLOR COMBINATIONS:



First color denotes rails; second color denotes infill.

1 2a 2b 3

MESH RAILING

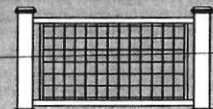

COLORS:



Mesh is 316 mill-finish stainless steel.

SS

1 2a 2b 3 4

GLASS RAILING

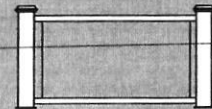

COLORS:



1 2a 2b 3 4

Rendering of Final Design

