



<b>B 1</b>	<b>68347</b>	SEQUENCE NO. (MDE USE ONLY)	<b>STATE OF MARYLAND</b> <b>APPLICATION FOR PERMIT TO DRILL WELL</b> please type <b>567925</b>	STATE PERMIT NUMBER <b>HO -20 -0042</b> <small>fill in this form completely</small>
Date Received (APA) <b>08/12/20</b>		<b>OWNER INFORMATION</b>		
8 MM DD YY 13 <b>SEN John</b> 15 Last Name Owner First Name 34 <b>109 HUNTS BLUFF RD</b> 36 Street or RFD 55 <b>SPARKS MD 21152</b> 57 Town 70 State 72 Zip 76		<b>LOCATION OF WELL</b>		
		B 3 8 COUNTY <b>Howard</b> 21 <b>Brighton Farms Estates</b> 23 SUBDIVISION 42 SECTION <b>44</b> 46 LOT <b>11</b> 48 50 <b>CLARKSVILLE</b> 52 NEAREST TOWN 71		
<b>DRILLER INFORMATION</b>		<b>SOURCES OF DRILLING WATER</b>		
Driller's Name <b>Michael Barlow</b> M W D <b>355</b> 76 License No. 81 Firm Name <b>Barlow Well Drilling</b> Address <b>522 UNDERWOOD LANE 21014</b> Signature <b>[Signature]</b> Date <b>7/29/2020</b>		B 4 1. <b>Well</b> 2. <b>10/2/2020</b> 3. <b>10/2/2020</b> Cement - bent pipe 28 bags 37' to main pipe		
<b>WELL INFORMATION</b>		<b>ON WHICH SIDE OF ROAD (CIRCLE APPROPRIATE BOX)</b>		
B 2 1 APPROX. PUMPING RATE (GAL. PER MIN.) 8 12 <b>5</b> AVERAGE DAILY QUANTITY NEEDED (GAL. PER DAY) 14 20 <b>750</b>		11 STREET ADDRESS 30 <b>13575 NICHOLS DRIVE</b> ON WHICH SIDE OF ROAD (CIRCLE APPROPRIATE BOX) NORTH WEST EAST SOUTH 34 200 37 DISTANCE FROM ROAD ENTER FT OR MI 38 39 TAX MAP: <b>34</b> BLK: <b>8</b> PARCEL <b>104</b>		
<b>USE FOR WATER (CIRCLE APPROPRIATE BOX)</b>		<b>NOT TO BE FILLED IN BY DRILLER HEALTH DEPARTMENT APPROVAL</b>		
D DOMESTIC POTABLE SUPPLY & RESIDENTIAL IRRIGATION F FARMING (LIVESTOCK WATERING & AGRICULTURAL IRRIGATION) I INDUSTRIAL, COMMERCIAL, DEWATERING P PUBLIC WATER SUPPLY WELL T TEST, OBSERVATION, MONITORING O OPEN LOOP GEOTHERMAL C CLOSED LOOP GEOTHERMAL		COUNTY NAME <b>Howard</b> COUNTY NO. <b>13</b> STATE SIGNATURE _____ INSERT S → 41 DATE ISSUED <b>09/15/20</b> CO SIGNATURE <b>[Signature]</b> EXP. DATE <b>09/15/20</b> 43 MM DD YY 48		
APPROXIMATE DEPTH OF WELL <b>300</b> FEET 24 28 APPROXIMATE DIAMETER OF WELL <b>6</b> INCH NEAREST INCH		<b>PROPOSED LOCATION OF WELL ON LOT</b> SHOW PERMANENT STRUCTURES SUCH AS BUILDINGS, SEPTIC SYSTEM, ROADS AND/OR LANDMARKS AND INDICATE NOT LESS THAN TWO DISTANCE MEASUREMENTS TO WELL		
<b>METHOD OF DRILLING (circle one)</b>		80' casing 30' Lines 180'		
BORED (or Augered) JETTED Jetted & DRIVEN 30 AIR-ROTARY AIR-PERCussion ROTARY (Hydraulic Rotary) 37 CABLE REVERSE-ROTARY DRIVE-POINT other _____				
<b>REPLACEMENT OR DEEPEINED WELLS (CIRCLE APPROPRIATE BOX)</b>		Pursuant to § 10-624 of the State Govt. Article of the Maryland Code, personal info requested on this form is used in processing this form pursuant to COMAR 26.04.04. Failure to provide the info may result in this form not being processed. You have the right to inspect, amend, or correct this form. The Maryland Department of the Environment is subject to the Maryland Public Information Act. This form may be made available on the Internet via MDE's website and is subject to inspection or copying, in whole or in part, by the public and other governmental agencies, if not protected by federal or State Law.		
N THIS WELL WILL NOT REPLACE AN EXISTING WELL Y THIS WELL WILL REPLACE A WELL THAT WILL BE ABANDONED AND SEALED <b>Has been 2/19/2020</b> 39 S THIS WELL WILL REPLACE A WELL THAT WILL BE USED AS A STANDBY-CONTACT LOCAL APPROVING AUTHORITY FOR POLICY ON STANDBY WELLS D THIS WELL WILL DEEPEIN AN EXISTING WELL				
PERMIT NUMBER OF WELL TO BE REPLACED OR DEEPEINED (IF AVAILABLE) 41 _____ 52				
<b>Not to be filled in by driller (MDE OR COUNTY USE ONLY)</b>				
APPROP. PERMIT NUMBER _____ <b>G</b> _____ PERMIT No. <b>HO -20 -0042</b> 70 71 72 73 74 75 76 77 78 79				
SPECIAL CONDITIONS <b>MUST BE TESTED FOR RADIUM AT YIELD</b> <small>NOTE: APPROVING AUTHORITIES SHOULD USE SEPARATE SHEET IF NEEDED</small>				



# MICHAEL BARLOW WELL DRILLING & SERVICE, INC.

522 Underwood Lane  
(410) 838-6910

Bel Air, Maryland 21014  
Fax (410) 838-3582

## WELL YIELD REPORT

Date Test Completed:

October 8, 2020

Well Depth: 225 feet

Customer John Sen  
Road 13575 Nicholas Drive  
City Clarksville  
State Maryland

Permit # HO-20-0042  
Subdivision Brighton Farms Estates  
Section  
Lot # 11

Time	Water Level feet	Time to Fill 1-gallon bucket seconds	G.P.M.
10:30 AM	37	5	12.00
10:45 AM	38	5	12.00
11:00 AM	38	5	12.00
11:15 AM	38	5	12.00
11:30 AM	38	5	12.00
11:45 AM	38	5	12.00
12:00 PM	38	5	12.00
12:15 PM	38	5	12.00
12:30 PM	38	5	12.00
12:45 PM	38	5	12.00
1:00 PM	38	5	12.00
1:15 PM	38	5	12.00
1:30 PM	38	5	12.00

This yield test report is for informational purposes only. Please note the yield may increase or decrease over time and the GPM indicated above is not a guarantee.



**HOWARD COUNTY HEALTH DEPARTMENT**  
**BUREAU OF ENVIRONMENTAL HEALTH**  
**WELL & SEPTIC PROGRAM**  
**TEL: (410)313-1771 FAX: (410)313-2648**

**Information Form for the Installation of the Well Pump, Pitless Adapter, and Supply Piping**

**NOTE:** The installer is responsible for requesting an inspection prior to 9 am on the day of the desired inspection. No work is to be covered until approved by the Health Department. All installations must comply with the National Standard Plumbing Code (NSPC, as amended locally) and COMAR 26.04.04 (MD Well Construction Regulations). Submission of a complete form is required prior to Use and Occupancy approval.

Company Name: Barlow Well Drilling Telephone #: 410-838-6910  
Address: 522 UNDERWOOD LANE  
BEL AIR, MD 21014

(Must circle one) Licensed Plumber Licensed Well Driller Licensed Well Pump Installer  
License # and name of individual responsible for the field installation:  
Name (Print): Michael Isom License# MSD162

**\*A licensed individual must perform the actual installation. Apprentices must be under the supervision of a licensed journeyman or master plumber, pump installer or well driller. Licenses may be subjected to field verification. Unlicensed individuals may be reported to the appropriate licensing agency.**

Name of Property Owner: John Sen Telephone #: \_\_\_\_\_  
Subdivision: Brighton Farms Est Lot #: 11 Well Tag #: HO-20-0042 (S)  
Site Address: 13575 Nichols Drive  
Chesapeake MD 21029

<u>Submersible Pump Data</u>	<u>Pitless Adapter</u>	<u>Well Cap and Electric Conduit</u>
Make: <u>Goulds</u>	Make: <u>BIS</u>	Two piece watertight cap: _____
Model #: <u>10CS07422</u>	Model#: <u>P100</u>	Screened, vented well cap: _____
Pump Capacity <u>10</u> GPM	Depth: <u>36</u> (36" min)	Cap secured to casing: _____
Well Yield: <u>12</u> GPM	NSF/WSC approved: <u>YES</u>	Conduit min 18" B.G.: _____
Depth of well encountered at time of pump installation: <u>225</u> (feet)		Conduit secured to well cap: _____
If pump capacity exceeds well yield, a low water cut off switch is required by NSPC 1990 Section 17.8.4		
Torque arrestors, Cable guards, or other acceptable method used- Must circle one		
Safety rope, if used, attached to brass rope adapter or other acceptable method <u>inside of well casing</u>		

<u>Piping to house</u>	<u>House Connection</u>
Type: <u>1" PDL</u>	PVC sleeve to undisturbed soil at wall penetration: _____
PSI: <u>200</u> (160 psi min)	Length of sleeve (5' minimum from foundation): <u>6'</u>
Depth of supply line: <u>36</u> (36" min)	Sleeve sealed properly: <u>YES</u>

The water supply line is required to be at least ten feet from the septic tank, pump chamber, sewage piping, distribution box, drainfields, and sewage reserve area. If this cannot be accomplished, contact this office for approval prior to installation.

Signature of company representative responsible for installation \_\_\_\_\_

date 4/29/2022

**For Health Department Use Only - Not to be completed by Installer**

Date Insp. Requested: 5/5/22 Date Insp. Approved: 5/18/22 Inspector: (S)  
Inspection Data: Pitless adapter watertight & water supply line at least 36" below grade ✓ 36"  
Two piece cap installed and attached to casing securely ✓  
Elec. conduit extends at least 18" below grade/attached to cap properly ✓ 29"  
Safety rope not outside of well cap/casing ✓ 10"  
Correct well tag attached properly and casing 8" above finished grade ✓ 10"  
Water supply line sleeved adequately at house connection ✓  
Adequate grout observed below pitless adapter ✓

10 feet from house

5/5/22 - Upon inspection contractor not very far along w/ trench - encountering a lot of hard clay and roots, they are going to stop and fill trench due to rain and try again at a later date. (P)

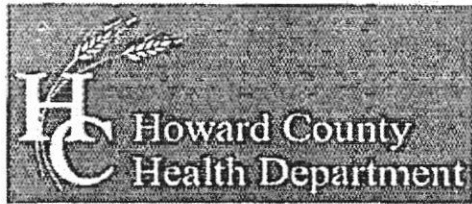

**Bureau of Environmental Health**

8930 Stanford Boulevard, Columbia, MD 21045

Main: 410-313-2640 | Fax: 410-313-2648

TDD 410-313-2323 | Toll Free 1-855-313-6300

[www.hchealth.org](http://www.hchealth.org)

Facebook: [www.facebook.com/hocohealth](https://www.facebook.com/hocohealth)

Twitter: HowardCoHealthDep

**Maura J. Rossman, M.D., Health Officer**

**TO ALL INTERESTED PARTIES**

When submitting a well permit application for a proposed well, please indicate one of the following:

Well Site Location:

BRIGHTON FARMS ESTATES

11

13575 NICHOLS DRIVE

Subdivision/Property Name

Lot #

Road Name

- ☒ The well site, as shown on the attached well site plan, has been staked by

Fisher, Collins & Carter, Inc.

(professional land surveyor or company employing professional land surveyors)

on February, 2020

(date)

- ☐ The well driller, builder or property owner will call the Health Department to schedule a time to meet in the field to verify the proposed well site location.

This sheet, along with two copies of an acceptable well site plan, must be attached to the green well permit application.



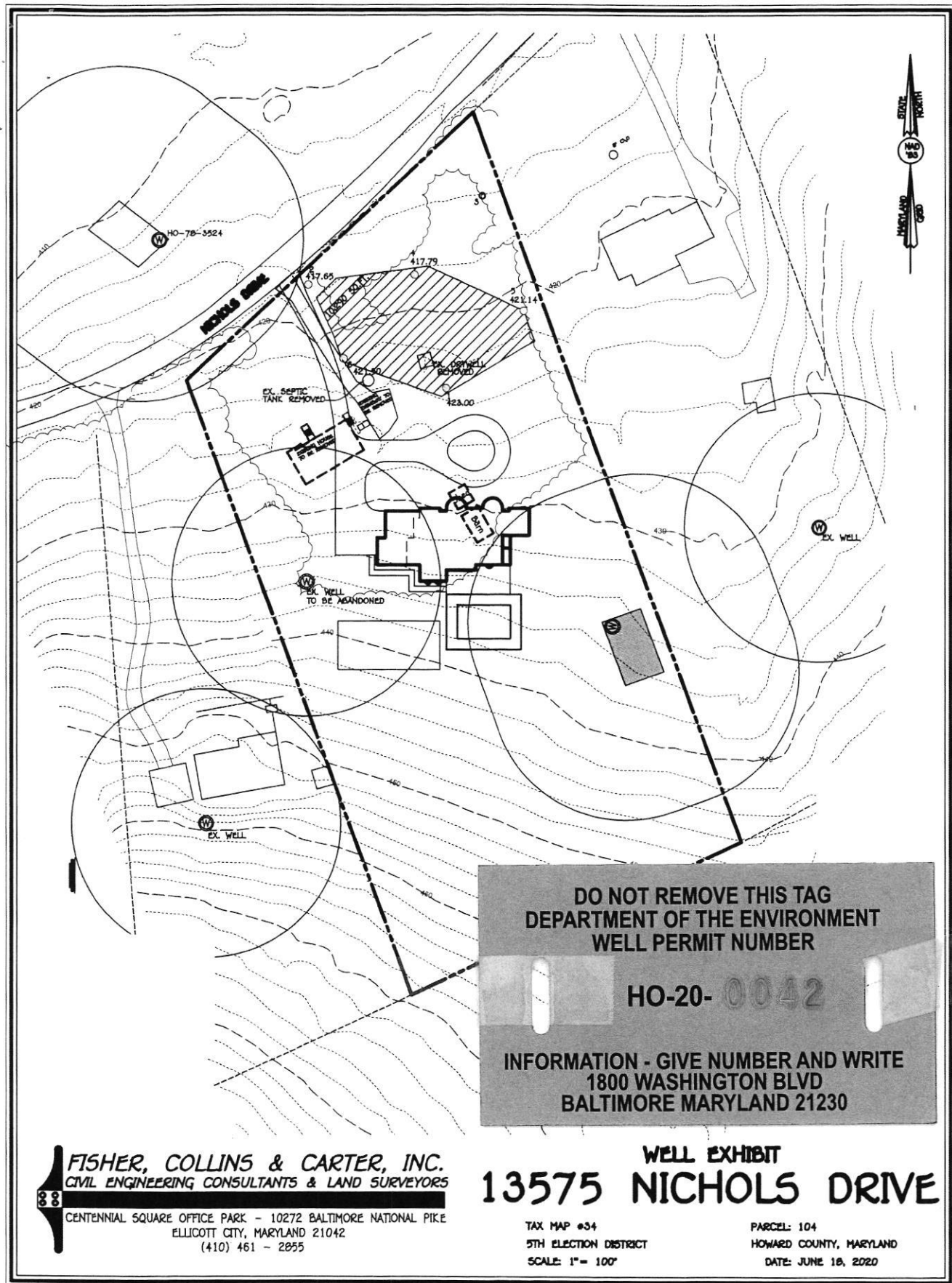

**FISHER, COLLINS & CARTER, INC.**  
CIVIL ENGINEERING CONSULTANTS & LAND SURVEYORS  
CENTENNIAL SQUARE OFFICE PARK - 10272 BALTIMORE NATIONAL PIKE  
ELICOTT CITY, MARYLAND 21042  
(410) 461 - 2855

**WELL EXHIBIT**  
**13575 NICHOLS DRIVE**

TAX MAP #34  
5TH ELECTION DISTRICT  
SCALE: 1" = 100'

PARCEL: 104  
HOWARD COUNTY, MARYLAND  
DATE: JUNE 18, 2020

9/15/2020 Approved   
Stated by Fisher, Collins, Carter

**INTERIM CERTIFICATE OF POTABILITY**

**Expiration Date – JUNE 28, 2023**

December 28, 2022

Homeowner  
13575 Nichols Drive  
Clarksville, MD 21029

**RE: Brighton Farm Est., Lot 11**  
**13575 Nichols Drive**  
**Building Permit: B20003798**  
**Well Permit: HO-20-0042**

Dear Homeowner:

This is to advise you that the septic system installation and water well construction for the above referenced property have been inspected and approved. Final approval of the septic system was granted on **8/12/2022**. Final approval of the well line connection to the dwelling was granted on **5/18/2022**. The well construction was completed on **10/8/2020**. Water samples were collected on **11/10/2022, 12/20/2022**.

The water sample results indicate that the water samples submitted for testing were free of coliform and fecal coliform bacteria at the time of sampling and are bacteriologically safe for drinking. This certifies that the initial sampling requirements of COMAR 26.04.04 "Well Regulations" have been met for the water supply system installed under well permit HO-20-0042. Although the submitted sample results are in compliance with COMAR standards, the Health Department does not guarantee water supplies.

This Interim Certificate of Potability will expire **six months** from the date of issuance. Submission of a second bacteriological test indicating the water is free of coliform and fecal coliform bacteria is required prior to the expiration date, after which time a Final Certificate of Potability will be issued. **Failure to submit an additional sample and obtain a Final Certificate of Potability will result in a Notice of Violation and is punishable as a misdemeanor under the Annotated Code of Maryland, Environment Article, 9-1311, subject to a fine of up to \$500 or imprisonment not to exceed three months.**

Please contact (410) 313-1773 to schedule a final water sample appointment or contact a Maryland certified water laboratory to schedule a water sample. A list of laboratories certified by the state of Maryland may be found at the following website:  
<http://www.mde.state.md.us/assets/document/WSP-Labs-2010apr16.pdf>



Bureau of Environmental Health  
8930 Stanford Blvd | Columbia, MD 21045  
410.313.2640 - Voice/Relay  
410.313.2648 - Fax  
1.866.313.6300 - Toll Free

---

Maura J. Rossman, M.D., Health Officer

In closing, please refer to our "Homeowner Fact Sheet" which illustrates a better understanding for your Onsite Sewage Disposal System. You will also find a link to Maryland Department of the Environments website which describes in further detail operation and maintenance of your septic system.

Approving Authority,

Kevin M. Wolf, LEHS, R.S./REHS, Supervisor  
Groundwater Management Section  
Well & Septic Program

cc: Howard County Dept. of Inspections, Licenses, and Permits  
Community Hygiene Program  
File



3020 VENTRIE COURT  
MYERSVILLE, MD 21773



(301) 293-3340  
INFO@FTLAB.COM

## Certificate of Analysis

Work order: **FWL0469**

**Client:**  
Classic Homes of Maryland  
6116 Executive Blvd Suite 750  
North Bethesda, MD 20852

**Project:** 13575 Nichols Drive  
HCHD U&O

**Received at lab:** 12/20/22 13:20

**Reported:** 12/23/22 10:12

**Sample Site:** Classic Homes  
**Sample Address:** 13575 Nichols Drive  
Clarksville, MD 21029

PWSID:  
Treatment: Sediment Filter on Bypass  
Collected by: David Hiller, ID: 2176DH  
Well Tag: HO-20-0042

### Powder Room Sink FWL0469-01 (Drinking Water)(Grab)

Date Collected: 12/20/22 10:38

#### Field Results

Result	Units
N/A	deg. C
7.0	
N/A	mg/L
N/A	mg/L

Temperature
pH
Res. Chlorine
Chlorine, Total

#### Inorganic

Result	Units	MRL	MCL	Date Analyzed	Analyst	Qual	Method
<2.00	mg/L	2.00		12/23/22 9:25	JD		0.065mmFilter
0.34	NTUs	0.10	9.99	12/20/22 16:18	MW		180.1

Sand
Turbidity

## Notes and Definitions

#### Item Definition

ND Analyte NOT DETECTED at or above the reporting limit.

*Sara E. Randall*  
Sara E. Randall, President

Fredericktowne Labs, Inc. is a State Certified Water Quality Laboratory  
Maryland Cert. No. 116 Virginia Cert. No. 00444  
MDOT WBE Cert. No.: 91-158

## Certificate of Analysis

Work order: **FWK0317**

**Client:**

Classic Homes of Maryland  
50 West Edmonston Drive, Suite 405  
Rockville, MD 20852

**Project:** 13575 Nichols Drive

**Sample Site**

**Sample Address:**

Classic Homes  
13575 Nichols Drive  
Clarksville, MD 21029

**Received at lab:** 11/10/22 11:47

**Reported:** 11/15/22 9:29

PWSID:

Treatment:

Collected by:

Well Tag:

Filter

Evan Evans, ID: 2349EE

HO-20-0042

*Need pre-treatment for sand & turbidity. Builder noted 11/15/22*

**Basement Wash Sink**

FWK0317-01 (Drinking Water)(Grab)

Date Collected: 11/10/22 10:39

**Field Results**

	Result	Units
Temperature	22.1	deg. C
pH	6.8	
Res. Chlorine	<0.1	mg/L
Chlorine, Total	N/A	mg/L

**Microbiology**

	Result	Units	MRL	MCL	Date Prepared	Date Analyzed	Analyst	Qual	Method
Bacteria - Total Coliform	<1	cfu/100ml	1	1	11/10/22 14:30	11/11/22 8:45	JD		9223B
Bacteria - E coli	<1	cfu/100ml	1	1	11/10/22 14:30	11/11/22 8:45	JD		9223B

Bacteriological analysis of this sample indicates the water is safe for human consumption and meets federal, state and local requirements. Analysis was performed according to the 20th edition of Standard Methods

**Inorganic**

	Result	Units	MRL	MCL	Date Analyzed	Analyst	Qual	Method
Nitrate	1.94	mg/L	0.20	10	11/11/22 15:59	SH		300.0
Sand	<2.00	mg/L	2.00		11/11/22 15:10	JD		0.065mmFilter
Turbidity	0.72	NTUs	0.10	9.99	11/10/22 16:20	KMW		180.1

## Notes and Definitions

**Item Definition**

ND Analyte NOT DETECTED at or above the reporting limit.

*Sara E. Randall*  
Sara E. Randall, President

Fredericktowne Labs, Inc. is a State Certified Water Quality Laboratory  
Maryland Cert. No. 116 Virginia Cert. No. 00444  
MDOT WBE Cert. No.: 91-158

# Chain of Custody

Fredericktowne Labs, Inc  
3020 Ventrie Court  
Myersville, MD 21773  
(301) 293-3340

**FWK0317**

Client: Classic Homes of Maryland  
Project: 13575 Nichols Drive  
Project Manager: Brad Paradise

Sampling Site: Classic Homes  
13575 Nichols Drive  
Clarksville, MD 21029

Sampling Date:

Collected by:

Evan Evans

Treatment:

FWK0317-01

Source: Describe	Date	Time	Ph	Cl	Temp
Basement Wash Sink	11-10-22	10:39	6.8	<0.1	22.1
Matrix: Drinking Water	Sampled:				
Type: Grab	Composite Begin:				
A Plastic - 100ml Sterile Bacteria - C 200 (18 hr)					
B Plastic - 250ml unp IC_Nitrate (NO3)					
Turb					
C Plastic - 1000ml unp					
Sand					
Filter					

## Project Memo:

HCHD U & O Must check verify systems / verify well tag HO-20-0042

Entry - combo on garage 1 2 3 4

Any problems call Phillp

Permit B20003798

Iced: ☐ Yes ☐ No

Temp:

1.5

Relinquished By

Evan Evans

Date/Time

11-10-22 11:47

Received By

Nicole Daily

Date

11/10/22 1147

Relinquished By

Date/Time

Received By

Date

Page 1 of 1

Page 2 of 2

# Chain of Custody

Fredericktowne Labs, Inc  
3020 Ventrie Court  
Myersville, MD 21773  
(301) 293-3340

**FWL0469**

Client: Classic Homes of Maryland  
Project: 13575 Nichols Drive  
Project Manager: Brad Paradise  
Sampling Date: 12/20/2022  
Collected by: D Miller

Sampling Site: Classic Homes  
13575 Nichols Drive  
Clarksville, MD 21029

Source: <u>Pressure Tank</u> <u>SINK</u>		Date	Time	Ph	Cl	Temp
Matrix: Drinking Water	Sampled:	<u>12/20/22</u>	<u>1038</u>	<u>7.0</u>		
Type: Grab	Composite Begin:					
<b>Containers:</b> <b>FWL0469-01-A</b> Plastic - 1000ml unp Sand <b>FWL0469-01-B</b> Plastic - 250ml unp Turbidity						
Field Observations: <u>SEDIMENT FILTER IS BYPASSED</u>		Treatment: Sediment Filter				

## Work Comments:

HCHD U&O

Entry via combo on garage 1 2 3 4

Take Raw Samples MUST be from PT

Call Phillip if there are any issues 410-868-4301

Iced:

☒ Yes ☐ No

Temp:

2.6

Relinquished By

Date/Time

Relinquished By

Date/Time

Relinquished By

Date/Time

Received By

Date

Received By

Date

Received By

Date