



Howard County  
Health Department

**Bureau of Environmental Health**

8930 Stanford Boulevard, Columbia, MD 21045

Main: 410-313-2640 | Fax: 410-313-2648

TDD 410-313-2323 | Toll Free 1-866-313-6300

[www.hchealth.org](http://www.hchealth.org)

Facebook: [www.facebook.com/hocohealth](https://www.facebook.com/hocohealth)

Maura J. Rossman, M.D., Health Officer

RECEIPT DATE: 4/4/23

**ONSITE SEWAGE DISPOSAL SYSTEM**

P 574075

INSTALLATION

APPROVAL DATE: 4/13/2023 *SP*

**PERMIT**

A \_\_\_\_\_

**SEWER HOUSE CONNECTION**

*— Upgrade*

PROPERTY ADDRESS: 2904 Summer Hill Drive

SUBDIVISION: Sobus Farms

LOT: 16 TAX ID: \_\_\_\_\_

CONTRACTOR: Mahon Plumbing Inc.

EMAIL: \_\_\_\_\_

CONTRACTOR ADDRESS: 6824 Fort Smallwood Road, Baltimore, MD 21226

PHONE: 410-636-7944

PROPERTY OWNER: Steven and Jessica Clark

EMAIL: \_\_\_\_\_

OWNER ADDRESS: 2904 Summer Hill Drive, West Friendship, MD 21794

PHONE: \_\_\_\_\_

NUMBER OF BEDROOMS: \_\_\_\_\_ CONNECTED TO PUBLIC WATER: ☐ YES ☒ NO

LOCATION:	INSTALL 4" SEWER LINE PER APPROVED SITE PLAN.
NOTES:	

ISSUED BY: Dana B. ISSUE DATE: 4/4/2023 EXPIRATION DATE: 4/4/2024

**NOTE: HOWARD COUNTY BUREAU OF UTILITIES APPROVAL OF GRINDER PUMP INSTALLATION IS REQUIRED PRIOR TO SEPTIC PERMIT APPROVAL**

**NOTE: CONTRACTOR MUST SCHEDULE AN INSPECTION AND GAIN APPROVAL OF ALL COMPONENTS PRIOR TO COVERING**

**NOTE: AN ELECTRICAL PERMIT IS REQUIRED FOR INSTALLATION OF ANY ELECTRICAL COMPONENTS OF THE SYSTEM**

**NEITHER THE HOWARD COUNTY COUNCIL NOR THE HEALTH DEPARTMENT IS RESPONSIBLE FOR THE SUCCESSFUL OPERATION OF ANY SYSTEM.**

**PERMITTEE RESPONSIBLE FOR OBTAINING FINAL APPROVAL ON THIS PERMIT.**

**CALL 410-313-1771 FOR INSPECTION OF SEPTIC SYSTEM.**

NOT TO SCALE

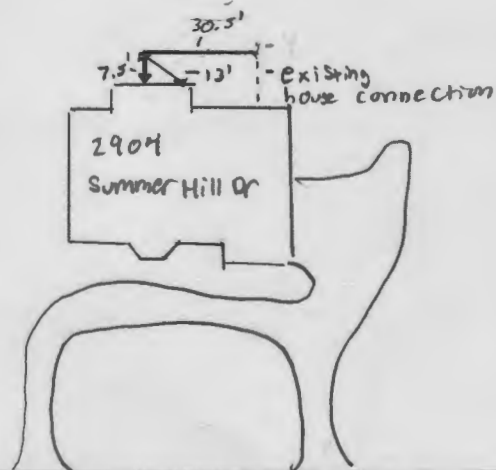

ROAD NAME

Summer Hill Dr.

PRE-CONSTRUCTION:

INSTALLATION: 4/5/2023 - Contractor had dug sewer line from outdoor sink but no pipe was installed. 1". Fall would be achieved. Installing pipe week of 4/10. (SP)  
4/12/2023 - Could not see what type of pipe used to make connection from outside sink to septic. pipe is 4". Phone call w/ Plumber told not to backfill until confirm SCHD 40 or SDR 35 pipe (SP)  
4/13/2023 - Plumber sent pic of SCHD 40 pipe used, see attached pics, gave OK to backfill (SP)

FINAL INSPECTOR Shepsura Rose

DATE OF APPROVAL 4/13/2023

**TRENCH/DRAINFIELD DATA**

WIDTH INLET BOTTOM

N/A

NUMBER OF TRENCHES

TOTAL LENGTH

ABSORPTION AREA

DISTRIBUTION BOX LEVEL

DISTRIBUTION BOX BAFFLE

DISTRIBUTION BOX PORT

**SEPTIC TANK DATA**

SEPTIC TANK 1 LEVEL N/A

MANUFACTURER

CAPACITY GAL

SEAM LOC

TANK LID DEPTH

BAFFLES

BAFFLE FILTER

MANHOLE LOC

6" PORT LOC

WATERTIGHT TEST

SLOTTED

DATE ON LID

PUMP/SEPTIC TANK LEVEL N/A

MANUFACTURER

CAPACITY GAL

SEAM LOC

TANK LID DEPTH

BAFFLES

BAFFLE FILTER

MANHOLE LOC

6" PORT LOC

WATERTIGHT TEST

SLOTTED

DATE ON LID



SCH 40 NSF<sup>®</sup> dwv ASTM D 2665 .  PVC 112

# PERMIT

## SEWAGE DISPOSAL SYSTEM

DEPARTMENT OF HEALTH AND MENTAL HYGIENE

HOWARD COUNTY HEALTH DEPARTMENT

BUREAU OF ENVIRONMENTAL HEALTH

XXX-XXXX-XXXX 313-2640

INDEXED

03-319830

P 58453-B

A 49914W

DISTRICT 3rd

DATE 5/14/97

DATE SYSTEM APPROVED 7-14-97

INSPECTOR KM

South Carroll Backhoe, Inc.

IS PERMITTED TO INSTALL ☒ ALTER

ADDRESS 4410 Salem Bottom Road, Westminster, Maryland 21157 PHONE 875-4197

SUBDIVISION Sobus Farms LOT 16 ROAD 2904 Summer Hill Drive

PROPERTY OWNER Frank Altieri

ADDRESS

SEPTIC TANK CAPACITY 1250 GALLONS

NUMBER OF BEDROOMS 4

180 SQUARE FEET PER BEDROOM

LINEAR FEET OF TRENCH REQUIRED 240

TRENCHES - Trench to be 3 feet wide. Inlet 3 feet below original grade. Bottom maximum depth 5 feet below original grade. Effective area begins at 3 feet below original grade. 2 feet of stone below distribution pipe.

LOCATION - Place distribution box 140 feet up the left (240.58') lot line and 100 feet off that same lot line. Run trenches on contour towards the right lot line as seen when facing the lot from Summer Hill Drive.

NOTES - No trench to exceed 100 feet in length. Provide 6" - 8" diameter cleanout and cap to grade or above on septic tank.

OK 3/28/97

PLANS APPROVED BY Amy McMillen/Donna K. Soe

REVISED DATE 032797

COVER NO WORK UNTIL INSPECTED AND APPROVED

NEITHER THE HOWARD COUNTY COUNCIL NOR THE HEALTH DEPARTMENT IS RESPONSIBLE FOR THE SUCCESSFUL OPERATION OF ANY SYSTEM

NOTE: CLEANOUT REQUIRED EVERY 70 FEET OF SEWER LINE AND/OR AT 90° SWEEPS IN LINES FROM HOUSE TO DRAIN FIELDS, 90° ELBOWS NOT ACCEPTABLE.

NOTE: ALL PARTS OF SEPTIC SYSTEMS (I.E. TANK, DISTRIBUTION BOX TRENCHES) TO BE 100 FEET FROM WELL (UNLESS OTHERWISE SPECIFICALLY AUTHORIZED)

NOTE: IF DEEP TRENCH(ES) ARE USED CALL FOR INSPECTION BEFORE AND AFTER PLACING GRAVEL IN TRENCH(ES)

NOTE: NO DRY WELL SHALL EXCEED 15 FOOT IN DIAMETER NO ABSORPTION TRENCH TO EXCEED 100 FEET IN LENGTH

NOTE: ALL PIPE FROM HOUSE TO SEPTIC TANK MUST BE CAST IRON OR SCHEDULE 35/40 PVC OR ABS

PERMIT VOID AFTER TWO YEARS

NOTE: INSTALL STAND PIPE ON SEPTIC TANK AND DRY WELL STAND PIPES MUST BE 8 INCHES IN DIAMETER CAST IRON. CONCRETE OR TERRA COTTA OR PVA OR ABS ACCEPTED. IF TOP OF SEPTIC TANK IS DEEPER THAN 3 FEET. MANHOLE TO GRADE REQUIRED.

NOTE: DISTRIBUTION BOXES MUST HAVE BAFFLES

\*INSTALLER IS RESPONSIBLE FOR OBTAINING FINAL APPROVAL ON THIS PERMIT

HD-260(8-90)

\*CALL 461-9933 FOR INSPECTION OF SEPTIC SYSTEM.

OLD PERMIT 6/1/01  
300130582 - deck

A 49914W

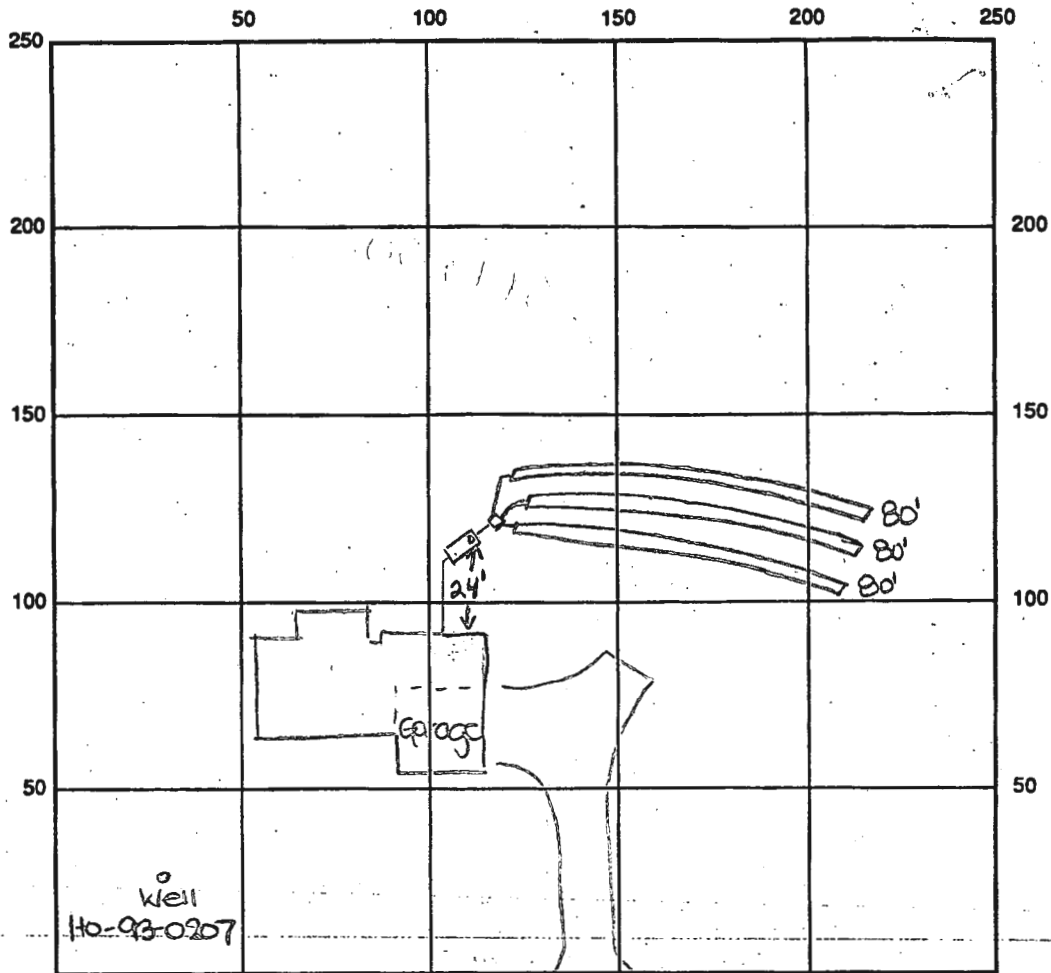

INDICATE NORTH - NAME ADJOINING ROADWAY AS BASE LINE

SEPTIC TANK LEVEL OK -1250 gal CLEANOUTS OK

DISTRIBUTION BOX LEVEL OK baffles is in

DRAIN FIELD/TITLE DEPTH 5.0 FT. TRENCH WIDTH 3.0 FT. INLET DEPTH 3.0 FT.

EFFECTIVE GRAVEL DEPTH 2.0 FT. TOTAL LENGTH 3 x 80 FT. → 240

NUMBER OF TRENCHES 3 ONE SIDEWALL/BOTTOM AREA 720 SQ. FT.

DRYWALL INSIDE DIAMETER — FT. EFFECTIVE DEPTH BELOW INLET — FT.

ABSORBENT AREA — SQ. FT.

REMARKS: 7/11/97 OK to install trenches-leave ends open only due to safety issues  
of leaving trenches open all weekend-fill in around septic tank also ALM  
7-14-97 everything covered except for ends of trenches, could not take  
any measurements KM

6/30/97 WPI - well line already covered - nothing to inspect. DKS

DATE SYSTEM APPROVED 7-14-97 INSPECTOR Kimberly Maisto