

12/30/98

PERMIT

SEWAGE DISPOSAL SYSTEM

DEPARTMENT OF HEALTH AND MENTAL HYGIENE

P 511327

AREA 50388-S

DISTRICT 4th

DATE 12/30/98

DATE SYSTEM APPROVED 12/30/98

INSPECTOR AI

HOWARD COUNTY HEALTH DEPARTMENT

BUREAU OF ENVIRONMENTAL HEALTH

~~XXXXXX~~ 410-313-2640

#360710
INDEXED

K & K Excavating

IS PERMITTED TO INSTALL X ALTER

ADDRESS 14960 Route 144, Woodbine, MD 21797

PHONE 410-442-1336

SUBDIVISION Ridge View Hunt

LOT 3

ROAD 15263 Ridge Hunt Drive

PROPERTY OWNER Selfridge Builders

ADDRESS

SEPTIC TANK CAPACITY 1250 GALLONS

NUMBER OF BEDROOMS 4

180 SQUARE FEET PER BEDROOM

LINEAR FEET OF TRENCH REQUIRED 240

TRENCHES - Trench to be 3 feet wide. Inlet 3 feet below original grade. Bottom maximum depth 5 feet below original grade. Effective area begins at 3 feet below original grade. 2 feet of stone below distribution pipe.

LOCATION - Begin trenches 215 feet up the left (308.70') lot line and 50 feet off that same lot line as seen from Ridge Hunt Drive. Run trenches on contour toward the left lot line.

NOTES - No trench to exceed 100 feet in length. Provide 6" - 8" diameter cleanout and cap to grade or above on septic tank.

12/29/98 MAINTAIN 20' TO HOUSE (MR)

PLANS APPROVED BY Amy McMillen/Donna K. Soe

ok by 10:1-95

DATE 9-21-98

COVER NO WORK UNTIL INSPECTED AND APPROVED

NEITHER THE HOWARD COUNTY COUNCIL NOR THE HEALTH DEPARTMENT IS RESPONSIBLE FOR THE SUCCESSFUL OPERATION OF ANY SYSTEM

NOTE: CLEANOUT REQUIRED EVERY 70 FEET OF SEWER LINE AND/OR AT 90° SWEEPS IN LINES FROM HOUSE TO DRAIN FIELDS, 90° ELBOWS NOT ACCEPTABLE.

NOTE: ALL PARTS OF SEPTIC SYSTEMS (I.E. TANK, DISTRIBUTION BOX TRENCHES) TO BE 100 FEET FROM WELL (UNLESS OTHERWISE SPECIFICALLY AUTHORIZED)

NOTE: IF DEEP TRENCH(ES) ARE USED CALL FOR INSPECTION BEFORE AND AFTER PLACING GRAVEL IN TRENCH(ES)

NOTE: NO DRY WELL SHALL EXCEED 15 FOOT IN DIAMETER NO ABSORPTION TRENCH TO EXCEED 100 FEET IN LENGTH

NOTE: ALL PIPE FROM HOUSE TO SEPTIC TANK MUST BE CAST IRON OR SCHEDULE 35/40 PVC OR ABS

PERMIT VOID AFTER TWO YEARS

NOTE: INSTALL STAND PIPE ON SEPTIC TANK AND DRY WELL STAND PIPES MUST BE 6 INCHES IN DIAMETER CAST IRON, CONCRETE OR TERRA COTTA OR PVA OR ABS ACCEPTED. IF TOP OF SEPTIC TANK IS DEEPER THAN 3 FEET, MANHOLE TO GRADE REQUIRED.

NOTE: DISTRIBUTION BOXES MUST HAVE BAFFLES

*INSTALLER IS RESPONSIBLE FOR OBTAINING FINAL APPROVAL ON THIS PERMIT

*CALL 481-9933 FOR INSPECTION OF SEPTIC SYSTEM.

50388-S

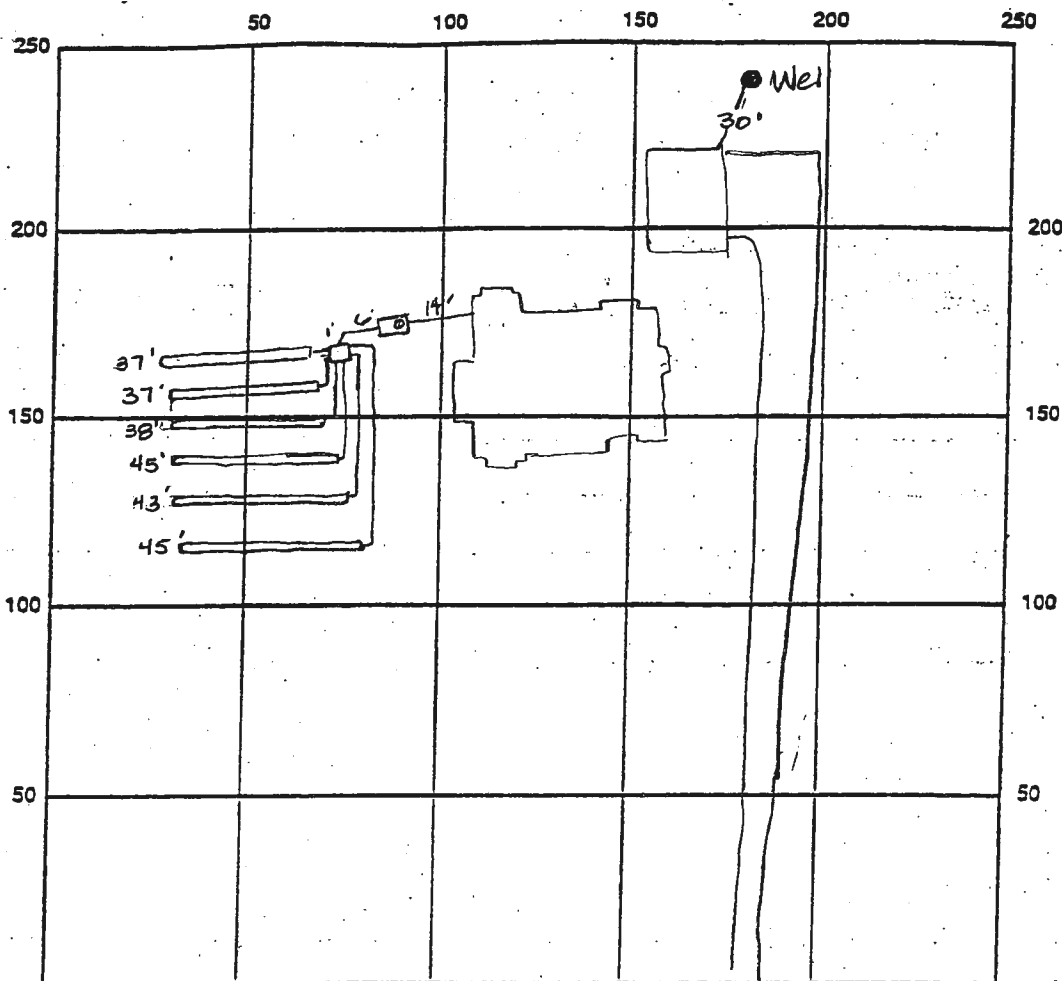

INDICATE NORTH - NAME ADJOINING ROADWAY AS BASE LINE Ridge Hunt Dr

SEPTIC TANK LEVEL OK 1500 gal CLEANOUTS OK

DISTRIBUTION BOX LEVEL OK

DRAIN FIELD/TITLE DEPTH 5.0 FT. TRENCH WIDTH 3.0 FT. INLET DEPTH 3.0 FT.

EFFECTIVE GRAVEL DEPTH 2.0 FT. TOTAL LENGTH 245 FT.

NUMBER OF TRENCHES 6 ONE SIDEWALL/BOTTOM AREA 735 SQ. FT.

DRYWALL INSIDE DIAMETER — FT. EFFECTIVE DEPTH BELOW INLET 2.0 FT.

ABSORBENT AREA — SQ. FT.

REMARKS: 12/30/98 OK to cover all work final

DATE SYSTEM APPROVED 12/30/98 INSPECTOR A. McMillan