



Howard County
Health Department

Maura J. Rossman, M.D., Health Officer

Bureau of Environmental Health

8930 Stanford Boulevard, Columbia, MD 21045

Main: 410-313-2640 | Fax: 410-313-2648

TDD 410-313-2323 | Toll Free 1-866-313-6300

www.hchealth.org

Facebook: www.facebook.com/hocohealth

RECEIPT DATE: 12/18/2023

ONSITE SEWAGE DISPOSAL SYSTEM

P 575702

APPROVAL DATE: 1/11/2024 SP

PERMIT: REPAIR

A _____

PROPERTY ADDRESS: 12019 Broad Meadow Lane

SUBDIVISION: Clearview Est. Sec II

LOT: 47

TAX ID: 05-414156

CONTRACTOR: Fogle's

EMAIL: Jeff@foglesinc.com

CONTRACTOR ADDRESS: 580 Obrecht Road, Sykesville 21784

PHONE: 410-795-5670

PROPERTY OWNER: Ye Li Rong

EMAIL: n/a

OWNER ADDRESS: Same as above

PHONE: _____

SEPTIC TANK SIZE: Existing (2000g)

PUMP SIZE: n/a

PUMP TANK CAPACITY: n/a

DISTRIBUTION SYSTEM: ☒ GRAVITY ☐ LPD

BEDROOMS: 4 ex APPLICATION RATE: 1.2

TRENCHES:	LINEAR FEET REQUIRED: <u>165</u>	INLET DEPTH: <u>3</u>
	TRENCH WIDTH: <u>2</u>	MAXIMUM BOTTOM DEPTH: <u>7.5</u>
	MINIMUM SPACE BETWEEN TRENCHES: <u>9</u>	EFFECTIVE AREA BEGINNING DEPTH: <u>4.5</u>
LOCATION:	SYSTEM STAKED BY INSTALLER AND VERIFIED BY APPROVING AUTHORITY DURING PRE-CONSTRUCTION INSPECTION.	
NOTES:	Install system per approved design plans. System sized for 6 bedrooms per homeowner request. Plenty of repair area to support 6 bedroom design.	

ISSUED BY: Kevin M. Wolf, L.E.H.S.

ISSUE DATE: 12/18/2023

EXPIRATION DATE: 12/18/2024

NOTE: CONTRACTOR MUST SCHEDULE A PRE-CONSTRUCTION INSPECTION PRIOR TO BEGINNING ANY INSTALLATION

NOTE: CONTRACTOR REGISTERED WITH THE STATE OF MD ON-SITE WASTEWATER PROFESSIONALS BOARD: CONFIRMED ☒

NOTE: CONTRACTOR MUST SCHEDULE AN INSPECTION AND GAIN APPROVAL OF ALL COMPONENTS PRIOR TO COVERING

NOTE: STONE MUST BE APPROVED BY HEALTH DEPARTMENT AND GRAVEL TICKET MUST BE AVAILABLE FOR REVIEW.

NOTE: WATERTIGHT SEPTIC TANKS REQUIRED

NOTE: ALL PARTS OF SEPTIC SYSTEM SHALL BE AT LEAST 100 FEET DOWNGRADIENT FROM ANY WATER WELL

NOTE: MANHOLE RISERS REQUIRED ON ALL SEPTIC TANKS AND PUMP CHAMBERS

NOTE: AN ELECTRICAL PERMIT IS REQUIRED FOR INSTALLATION OF ANY ELECTRICAL COMPONENTS OF THE SYSTEM

☒ ELECTRICAL PERMIT ISSUED E n/a

NOTE: THE HCHD DOES NOT WARRANTY ANY SYSTEM AND CANNOT GUARANTEE THE PERFORMANCE OF THIS SYSTEM AS DESIGNED. BY ACCEPTING THIS PERMIT, THE OWNER AND/OR APPLICANT ACKNOWLEDGE THAT THE SPECIFICATIONS DETAILED IN THIS DESIGN ARE ONE POSSIBLE OPTION AND THAT THE HCHD WILL REVIEW OTHER PROPOSALS. YOU HAVE THE OPTION TO SEEK THE ADVICE OF A QUALIFIED DESIGN CONSULTANT OR PROFESSIONAL ENGINEER FOR FURTHER GUIDANCE.

NOTE: AN INDIVIDUAL CERTIFIED BY MDE AND THE MANUFACTURER FOR BAT INSTALLATION MUST BE PRESENT AT ALL TIMES DURING BAT INSTALLATION.

NOTE: MDE RECOMMENDS SEPTIC TANKS, BAT, AND OTHER PRETREATMENT UNITS BE PUMPED AT A FREQUENCY ADEQUATE TO ENSURE THAT SOLIDS ARE NOT DISCHARGED TO THE DISPOSAL AREA

NEITHER THE HOWARD COUNTY COUNCIL NOR THE HEALTH DEPARTMENT IS RESPONSIBLE FOR THE
SUCCESSFUL OPERATION OF ANY SYSTEM.

PERMITTEE RESPONSIBLE FOR OBTAINING FINAL APPROVAL ON THIS PERMIT.

CALL 410-313-1771 TO SCHEDULE INSPECTIONS.

NOT TO SCALE

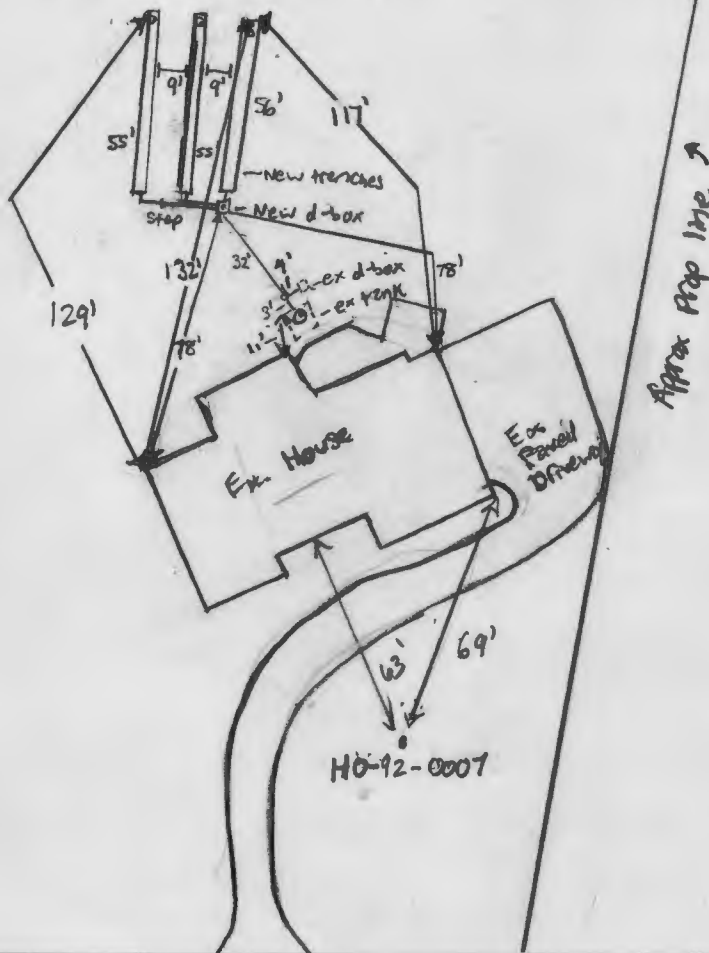

TRENCH/DRAINFIELD DATA

WIDTH	INLET	BOTTOM
2'	2.5'-3'	7.5'
NUMBER OF TRENCHES		3
TOTAL LENGTH		166'
ABSORPTION AREA		332 ft ²
DISTRIBUTION BOX LEVEL		yes
DISTRIBUTION BOX BAFFLE		yes
DISTRIBUTION BOX PORT		yes

SEPTIC TANK DATA

SEPTIC TANK 1 LEVEL

MANUFACTURER unknown
 CAPACITY 2000 GAL
 SEAM LOC mid
 TANK LID DEPTH _____
 BAFFLES _____
 BAFFLE FILTER _____
 MANHOLE LOC _____
 6" PORT LOC _____
 WATERTIGHT TEST ok
 SLOTTED no
 DATE ON LID n/a

PUMP/SEPTIC TANK LEVEL

MANUFACTURER _____
 CAPACITY _____ GAL
 SEAM LOC _____
 TANK LID DEPTH _____
 BAFFLES _____
 BAFFLE FILTER _____
 MANHOLE LOC _____
 6" PORT LOC _____
 WATERTIGHT TEST _____
 SLOTTED _____
 DATE ON LID _____

PRE-CONSTRUCTION:

11/20/2023 System laid out by installer. Elevation verified. Owner wanted system sized for 6 bedrooms, OK to add another 55' run. per the plan. Call for inspection. OK

INSTALLATION: 11/3/2024 - Bill can valve installed to alternate old piping system & new replacement system.

Line from tank to d-box level, installer changing the so there's fall, reinspect to make sure there's adequate fall. D-box retested while onsite, size baffles 2 upper trenches has 2.5' inlet, lengths @ 55' & 56'. lowest trench inlet @ 3' + length @ 55'. Installer now finished stone lowest trench.

1/11/2024 - Confirmed installer finished stone for lower. Confirmed line from ex tank to d-box has adequate fall.

FINAL INSPECTOR

S. Page

DATE OF APPROVAL

1/14/2024

[illegible]

Map Labels:

- BROAD MEADOW LN
- 12019 Broad Meadow Ln
- Clarksville, MD 21029
- 12025
- 12037
- Elevation contours: 420, 430, 440, 450

Handwritten Notes:

- H/O - Jessie Ye
- 6-Bedrooms
- Dropped off to Kevin Wolfe on 12/13/23
- No Neighboring Wells within 100'
- Trench Detail
 - 6-Bedroom: 165' total length, 3- 55' each
 - 4 Bedroom: 110'- total trench length, 2- 55' each, 2'- wide, 7.5'- Deep, 5'- Stone, 2'- cover

Signature and Date:

Approved Septic System Plan
Howard County Health Department
[Signature]
Date: 12/18/2023

Permit Information:

Jessie Ye
12019 Broad Meadow Ln
Clarksville, MD 21029
301-362-1688
Peric for Repair
4 Bedroom
Permit P575702

[illegible]

100 ft

420

410

420

430

440

450

12025

12019

12037

BROAD MEADOW LN

BROAD MEADOW LN

BROAD MEADOW LN

BROAD MEADOW LN

H/O - Jessie Ye

6-Bedrooms

12019 Broad Meadow Ln

Clarksburg, MD 21029

Dropped off to Kevin Wolfe on 12/13/23

Approved Septic System Plan

Howard County Health Department

12/18/2023

Signature

Approved Repair Design for 6-Bedrooms

No Neighboring Wells within 100

Trench Detail

6-Bedroom

165' total length

3- 55' Each

Same

4 Bedroom -

110' total trench length

2- 55' each

2'- wide

7.5'- Deep

5'- Stone

2'- cover

45'

50'

115'

14' 1/4"

200'

60' 1/2"

12019

Ex Well

100 ft

420

410

420

430

440

450

12025

12019

12037

BROAD MEADOW LN

BROAD MEADOW LN

BROAD MEADOW LN

BROAD MEADOW LN

H/O - Jessie Ye

6-Bedrooms

12019 Broad Meadow Ln

Clarksburg, MD 21029

Dropped off to Kevin Wolfe on 12/13/23

Approved Septic System Plan

Howard County Health Department

12/18/2023

Signature

Approved Repair Design for 6-Bedrooms

No Neighboring Wells within 100

Trench Detail

6-Bedroom

165' total length

3- 55' Each

Same

4 Bedroom -

110' total trench length

2- 55' each

2'- wide

7.5'- Deep

5'- Stone

2'- cover

45'

50'

115'

14' 1/4"

200'

60' 1/2"

12019

Ex Well

[illegible][illegible][illegible]A topographic map of a residential area with contour lines indicating elevation. A road labeled "BROAD MEADOW LN" runs diagonally across the lower half of the map. Several properties are outlined, with addresses 12019, 12025, and 12037 visible. Handwritten notes in black ink provide details about a septic system repair project. The notes include the name "H/O - Jessie Ye", address "12019 Broad Meadow Ln", city "Clarksburg, MD 21029", and a date "12/13/23". They also mention a permit number "P575702" and describe the work as "Approved Septic System Plan" and "Repair Design". Specific measurements for trench lengths and widths are provided for both 6-bedroom and 4-bedroom systems. A note states "No Neighboring Wells within 100'". A small diagram shows a trench layout with dimensions like 45', 50', 115', and 141'. An "Ex Well" is also indicated near property 12019. A scale bar at the bottom left indicates "100 ft".

H/O - Jessie Ye
12019 Broad Meadow Ln
Clarksburg, MD 21029
Dropped off
to Kevin Wolfe
on 12/13/23

BROAD MEADOW LN

BROAD MEADOW LN

BROAD MEADOW LN

12019

12025

12037

45'

50'

115'

141'

Ex Well

No Neighboring Wells within 100'

Trench Detail

✓ 6-Bedroom
165' total length
3- 55' Each
Same →

4 Bedroom -
110' total trench length
2- 55' each
2'- wide
7.5- Deep
5'- Stone
2'- cover

Approved Septic System Plan
Repair Design
Signature _____
Date 12/13/23
Howard County Health Department

Jessie Ye
12019 Broad Meadow Ln
Clarksburg, MD 21029
301-362-1688
Permit P575702
4 Bedroom

100 ft

[illegible][illegible][illegible]