

05-368316

# PERMIT

SEWAGE DISPOSAL SYSTEM

MARYLAND STATE DEPARTMENT OF HEALTH

HOWARD COUNTY

BUREAU OF ENVIRONMENTAL HEALTH

461-9933

INDEXED

P 41693

A REPAIR

DISTRICT

DATE

DATE SYSTEM APPROVED 5-12-88

INSPECTOR S. Abel

Arnold Backhoe &amp; Septic Services, Inc.

IS PERMITTED TO INSTALL ALTER X

ADDRESS P. O. Box 15, Woodbine, Maryland 21797

PHONE 795-7873

SUBDIVISION ROAD 5178 Ten Oaks Road LOT

PROPERTY OWNER Mr. Donald Stoner

5178 Ten Oaks Road

ADDRESS

IF GARBAGE GRINDER IS USED INCREASE SEPTIC TANK CAPACITY BY 50% AND ABSORPTION AREA BY 22%.

GARBAGE GRINDER? YES NO X

SEPTIC TANK CAPACITY 1000 GALLONS NUMBER OF BEDROOMS 2

REPAIR - INSTALL 90' of trench. Inlet 4 feet below original grade. Bottom maximum depth

9 feet below original grade. 5 feet of stone below distribution pipe.

Specs BASED ON DEPTH OF EXISTING DRY &amp; INLET. SA

WATER TO 6' IN TRENCH AREA. MOVE UPHILL &amp; INSTALL 150' OF TRENCH 3' W 106.

AS SHALLOW AS POSSIBLE

OK/SA

PLANS APPROVED BY Sid Abel

DATE 3/28/88

COVER NO WORK UNTIL INSPECTED AND APPROVED.

NEITHER THE HOWARD COUNTY COUNCIL NOR THE HEALTH DEPARTMENT IS RESPONSIBLE FOR THE SUCCESSFUL OPERATION OF ANY SYSTEM.

NOTE: CLEANOUT REQUIRED EVERY 70 FEET OF SEWER LINE AND/OR AT 90° SWEEPS IN LINES FROM HOUSE TO DRAIN FIELDS.

NOTE: ALL PARTS OF SEPTIC SYSTEMS (I.E., TANK, DISTRIBUTION BOX, TRENCHES) TO BE 100 FEET FROM WELL. (UNLESS OTHERWISE SPECIFICALLY AUTHORIZED)

NOTE: IF DEEP TRENCH(ES) ARE USED CALL FOR INSPECTION BEFORE AND AFTER PLACING GRAVEL IN TRENCH(ES).

NOTE: NO DRY WELL SHALL EXCEED 15 FOOT IN DIAMETER. NO ABSORPTION TRENCH TO EXCEED 100 FEET IN LENGTH.

NOTE: ALL PIPE FROM HOUSE TO SEPTIC TANK MUST BE CAST IRON OR SCHEDULE 40 PVC OR ABS.

PERMIT VOID AFTER TWO YEARS.

NOTE: INSTALL STAND PIPE ON SEPTIC TANK AND DRY WELL. STAND PIPES MUST BE 6 INCHES IN DIAMETER. CAST IRON, CONCRETE OR TERRA COTTA OR PVC OR ABS ACCEPTED. IF TOP OF SEPTIC TANK IS DEEPER THAN 3 FEET, MANHOLE TO GRADE REQUIRED.

NOTE: DISTRIBUTION BOXES MUST HAVE BAFFLES.

\*INSTALLER IS RESPONSIBLE FOR OBTAINING FINAL APPROVAL ON THIS PERMIT

\*CALL 461-9933 FOR INSPECTION OF SEPTIC SYSTEMS.

EH - 2-1186

P 41693

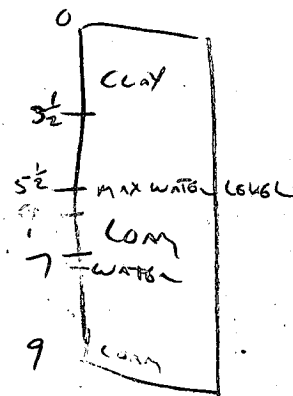
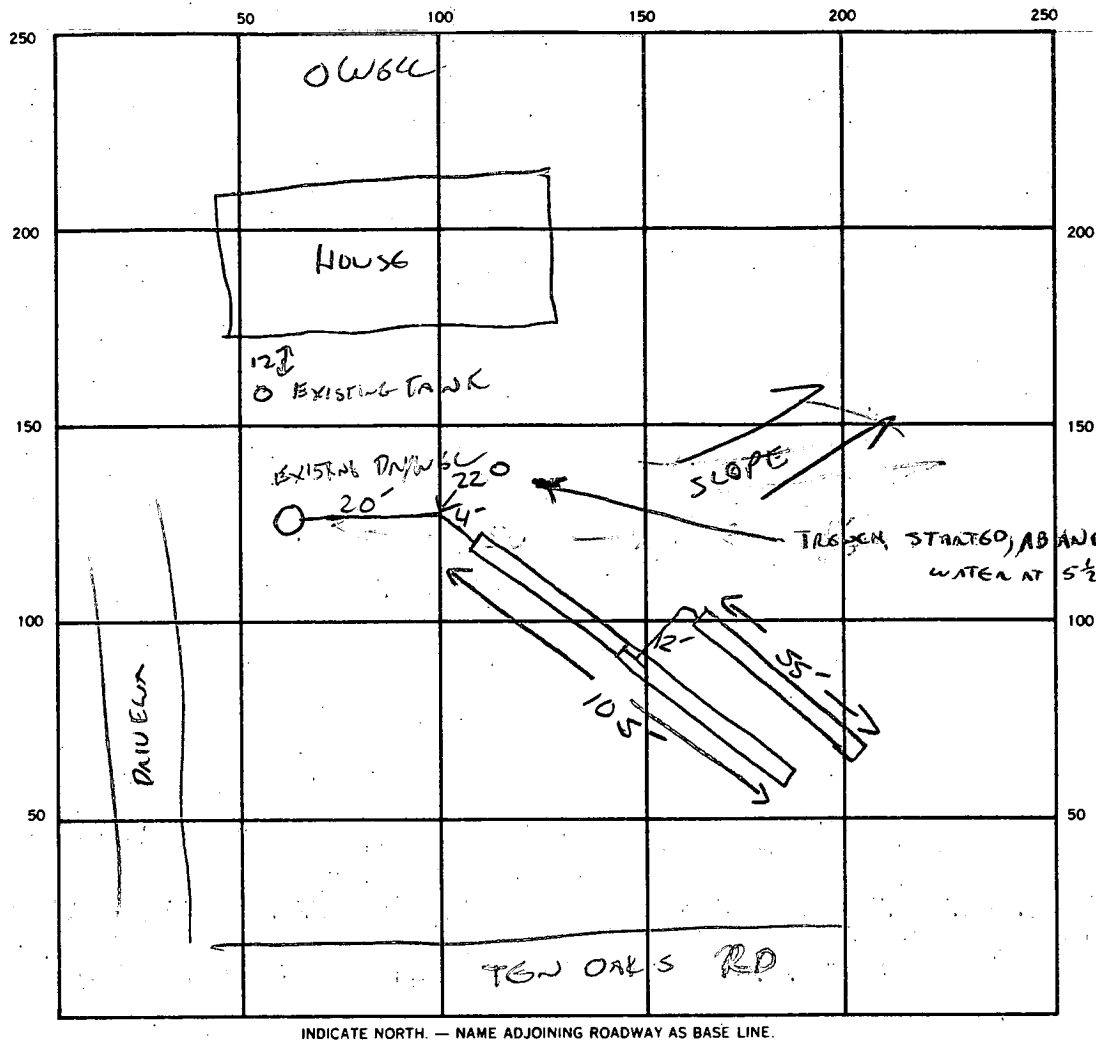

SEPTIC TANK LEVEL EXISTING CLEANOUTS ST & DW EXISTING

DISTRIBUTION BOX LEVEL T IN LINE

DRAIN FIELD/TILE FIELD DEPTH 5 FT. TRENCH WIDTH 3 FT. INLET DEPTH 4 FT.

EFFECTIVE GRAVEL DEPTH 12" TOTAL LENGTH 160 FT.

NUMBER OF TRENCHES 2 ONE SIDEWALL/BOTTOM AREA 480 SQ. FT.

DRYWELL INSIDE DIAMETER EXISTING FT. EFFECTIVE DEPTH BELOW INLET — FT.

ABSORBENT AREA 480 SQ. FT.

REMARKS 150' SHALLOW TRENCH 3' WIDEB REQ'D, 5/11/88 CW

5-12-88 OK TO COVER ALL WORK. S. Abel

DATE SYSTEM APPROVED 5-12-88 INSPECTOR S. Abel