

Tax ID-04-316339

# PERMIT

SEWAGE DISPOSAL SYSTEM

MARYLAND STATE DEPARTMENT OF HEALTH

HOWARD COUNTY

BUREAU OF ENVIRONMENTAL HEALTH

461-9933

P 42098

A REPAIR

DISTRICT \_\_\_\_\_

DATE 7/7/88

DATE SYSTEM APPROVED \_\_\_\_\_

INSPECTOR \_\_\_\_\_

Arnold Backhoe & Septic Services, Inc. IS PERMITTED TO INSTALL \_\_\_\_\_ ALTER X

ADDRESS P. O. Box 15, Woodbine, Maryland 21797 PHONE 795-7873

SUBDIVISION \_\_\_\_\_ ROAD 4152 Roxbury Mill LOT \_\_\_\_\_

PROPERTY OWNER Gregory Forst Charles Goshen PHONE # 9442 1568

ADDRESS 4152 Roxbury Mill Road

IF GARBAGE GRINDER IS USED INCREASE SEPTIC TANK CAPACITY BY 50% AND ABSORPTION AREA BY 22%.

GARBAGE GRINDER? YES \_\_\_\_\_ NO X

SEPTIC TANK CAPACITY 1000 GALLONS NUMBER OF BEDROOMS 3

REPAIR - CALL FOR INSPECTION WHEN GROUND IS OPENED UP SO SANITARIAN CAN RECOMMEND REPAIR.

orange tan silty clay soils - red rock 1' to refusal 5' +  
best soils of area: tested 1 1/2' 1052 1057 1057 1105 (8 MIN)

Leaching bed = 25 x 35' in size 1 1/2 - 2' stone, min 2'  
above rocky soils. Inlet = 1 1/2' below grade (on low side)  
slightly deeper on high. Pit to be min 75' from well

PLANS APPROVED BY C. Williams DATE 7/05/88

COVER NO WORK UNTIL INSPECTED AND APPROVED.

NEITHER THE HOWARD COUNTY COUNCIL NOR THE HEALTH DEPARTMENT IS RESPONSIBLE FOR THE SUCCESSFUL OPERATION OF ANY SYSTEM.

NOTE: CLEANOUT REQUIRED EVERY 70 FEET OF SEWER LINE AND/OR AT 90° SWEEPS IN LINES FROM HOUSE TO DRAIN FIELDS.

NOTE: ALL PARTS OF SEPTIC SYSTEMS (I.E., TANK, DISTRIBUTION BOX, TRENCHES) TO BE 100 FEET FROM WELL (UNLESS OTHERWISE SPECIFICALLY AUTHORIZED)

NOTE: IF DEEP TRENCH(ES) ARE USED CALL FOR INSPECTION BEFORE AND AFTER PLACING GRAVEL IN TRENCH(ES).

NOTE: NO DRY WELL SHALL EXCEED 15 FOOT IN DIAMETER. NO ABSORPTION TRENCH TO EXCEED 100 FEET IN LENGTH.

NOTE: ALL PIPE FROM HOUSE TO SEPTIC TANK MUST BE CAST IRON OR SCHEDULE 40 PVC OR ABS.

PERMIT VOID AFTER TWO YEARS.

NOTE: INSTALL STAND PIPE ON SEPTIC TANK AND DRY WELL. STAND PIPES MUST BE 6 INCHES IN DIAMETER. CAST IRON, CONCRETE OR TERRA COTTA OR PVC OR ABS ACCEPTED. IF TOP OF SEPTIC TANK IS DEEPER THAN 3 FEET, MANHOLE TO GRADE REQUIRED.

NOTE: DISTRIBUTION BOXES MUST HAVE BAFFLES.

**\*INSTALLER IS RESPONSIBLE FOR OBTAINING FINAL APPROVAL ON THIS PERMIT**

**\*CALL 461-9933 FOR INSPECTION OF SEPTIC SYSTEMS.**

EH - 2-1186

PR 42098

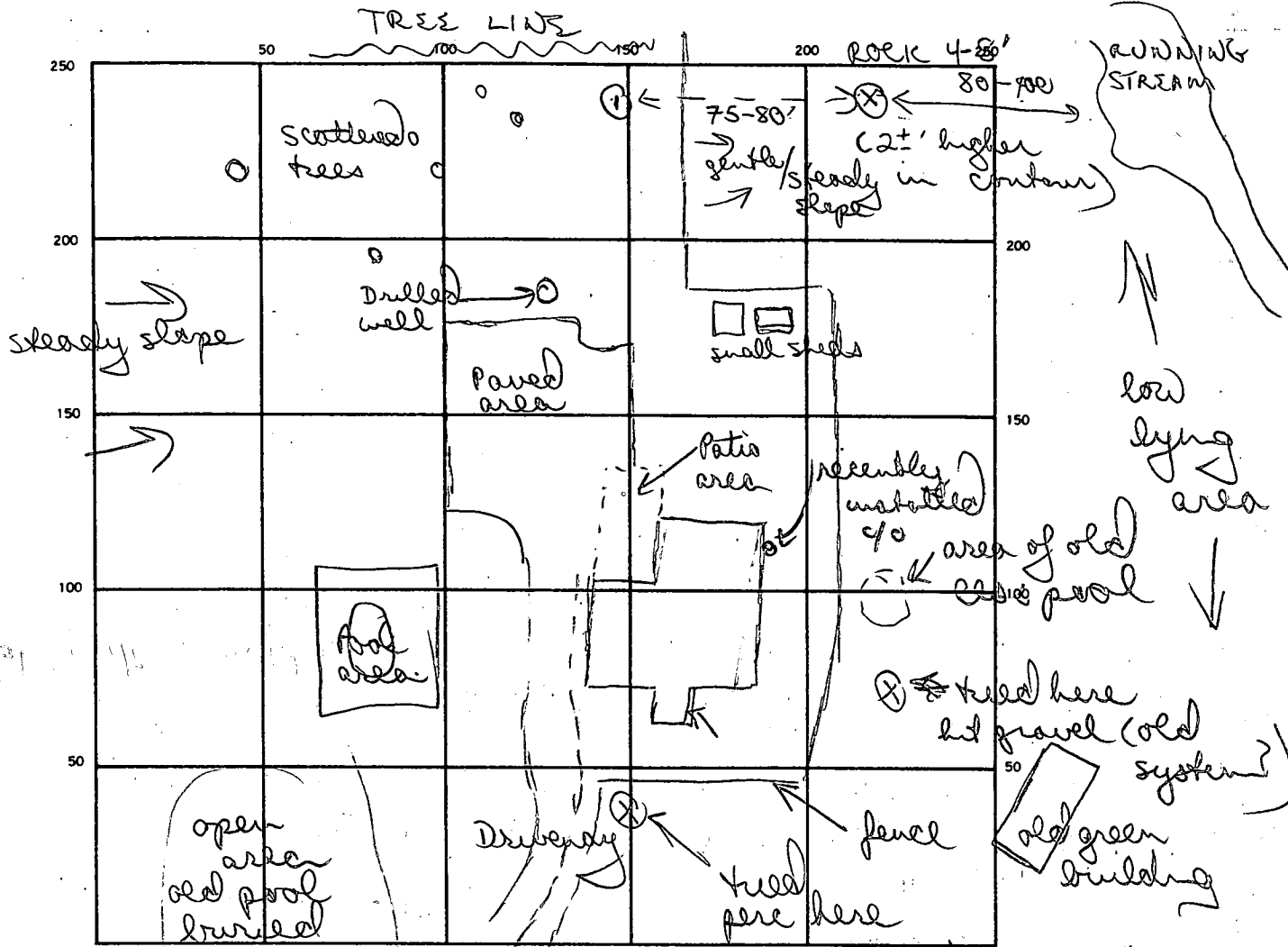

INDICATE NORTH. — NAME ADJOINING ROADWAY AS BASE LINE.

SEPTIC TANK, LEVEL \_\_\_\_\_

CLEANOUTS \_\_\_\_\_

DISTRIBUTION BOX, LEVEL \_\_\_\_\_

DRAIN FIELD/TILE FIELD, DEPTH \_\_\_\_\_ FT. TRENCH WIDTH \_\_\_\_\_ FT. INLET DEPTH \_\_\_\_\_ FT.

EFFECTIVE GRAVEL DEPTH \_\_\_\_\_ FT. TOTAL LENGTH \_\_\_\_\_ FT.

NUMBER OF TRENCHES \_\_\_\_\_ ONE SIDEWALL/BOTTOM AREA \_\_\_\_\_ SQ. FT.

DRYWELL INSIDE DIAMETER \_\_\_\_\_ FT. EFFECTIVE DEPTH BELOW INLET \_\_\_\_\_ FT.

ABSORBENT AREA \_\_\_\_\_ SQ. FT.

REMARKS \_\_\_\_\_

\_\_\_\_\_

\_\_\_\_\_

\_\_\_\_\_

\_\_\_\_\_

DATE SYSTEM APPROVED \_\_\_\_\_ INSPECTOR \_\_\_\_\_