

TAX# 03286940
PERMIT

SEWAGE DISPOSAL SYSTEM

MARYLAND STATE DEPARTMENT OF HEALTH*

HOWARD COUNTY

BUREAU OF ENVIRONMENTAL HEALTH
461-9933

P 42725

A REPAIR

DISTRICT _____

DATE 10/06/88

DATE SYSTEM APPROVED 10/31/88

INSPECTOR CW.

INDEXED

Jack Fyock

IS PERMITTED TO INSTALL _____ ALTER X

ADDRESS _____ PHONE 988-9270

SUBDIVISION _____ ROAD 11350 Route 144 LOT _____

PROPERTY OWNER Mayo Wells
11350 Route 144

ADDRESS _____

IF GARBAGE GRINDER IS USED INCREASE SEPTIC TANK CAPACITY BY 50% AND ABSORPTION AREA BY 22%.

GARBAGE GRINDER? YES _____ NO _____

SEPTIC TANK CAPACITY _____ GALLONS NUMBER OF BEDROOMS _____

DIRECTIONS - 5th house past Marriottsville Road

REPAIR - CALL FOR INSPECTION WHEN GROUND IS OPENED UP SO SANITARIAN CAN RECOMMEND REPAIR.

170 Pz

PLANS APPROVED BY C. Williams DATE 10/06/88

COVER NO WORK UNTIL INSPECTED AND APPROVED.

NEITHER THE HOWARD COUNTY COUNCIL NOR THE HEALTH DEPARTMENT IS RESPONSIBLE FOR THE SUCCESSFUL OPERATION OF ANY SYSTEM.

NOTE: CLEANOUT REQUIRED EVERY 70 FEET OF SEWER LINE AND/OR AT 90° SWEEPS IN LINES FROM HOUSE TO DRAIN FIELDS.

NOTE: ALL PARTS OF SEPTIC SYSTEMS (I.E., TANK, DISTRIBUTION BOX, TRENCHES) TO BE 100 FEET FROM WELL (UNLESS OTHERWISE SPECIFICALLY AUTHORIZED)

NOTE: IF DEEP TRENCH(ES) ARE USED CALL FOR INSPECTION BEFORE AND AFTER PLACING GRAVEL IN TRENCH(ES).

NOTE: NO DRY WELL SHALL EXCEED 15 FOOT IN DIAMETER. NO ABSORPTION TRENCH TO EXCEED 100 FEET IN LENGTH.

NOTE: ALL PIPE FROM HOUSE TO SEPTIC TANK MUST BE CAST IRON OR SCHEDULE 40 PVC OR ABS.

PERMIT VOID AFTER TWO YEARS.

NOTE: INSTALL STAND PIPE ON SEPTIC TANK AND DRY WELL. STAND PIPES MUST BE 6 INCHES IN DIAMETER. CAST IRON, CONCRETE OR TERRA COTTA OR PVC OR ABS ACCEPTED. IF TOP OF SEPTIC TANK IS DEEPER THAN 3 FEET, MANHOLE TO GRADE REQUIRED.

NOTE: DISTRIBUTION BOXES MUST HAVE BAFFLES.

***INSTALLER IS RESPONSIBLE FOR OBTAINING FINAL APROVAL ON THIS PERMIT**

*CALL 461-9933 FOR INSPECTION OF SEPTIC SYSTEMS.

EH - 2-1186

10/12/88

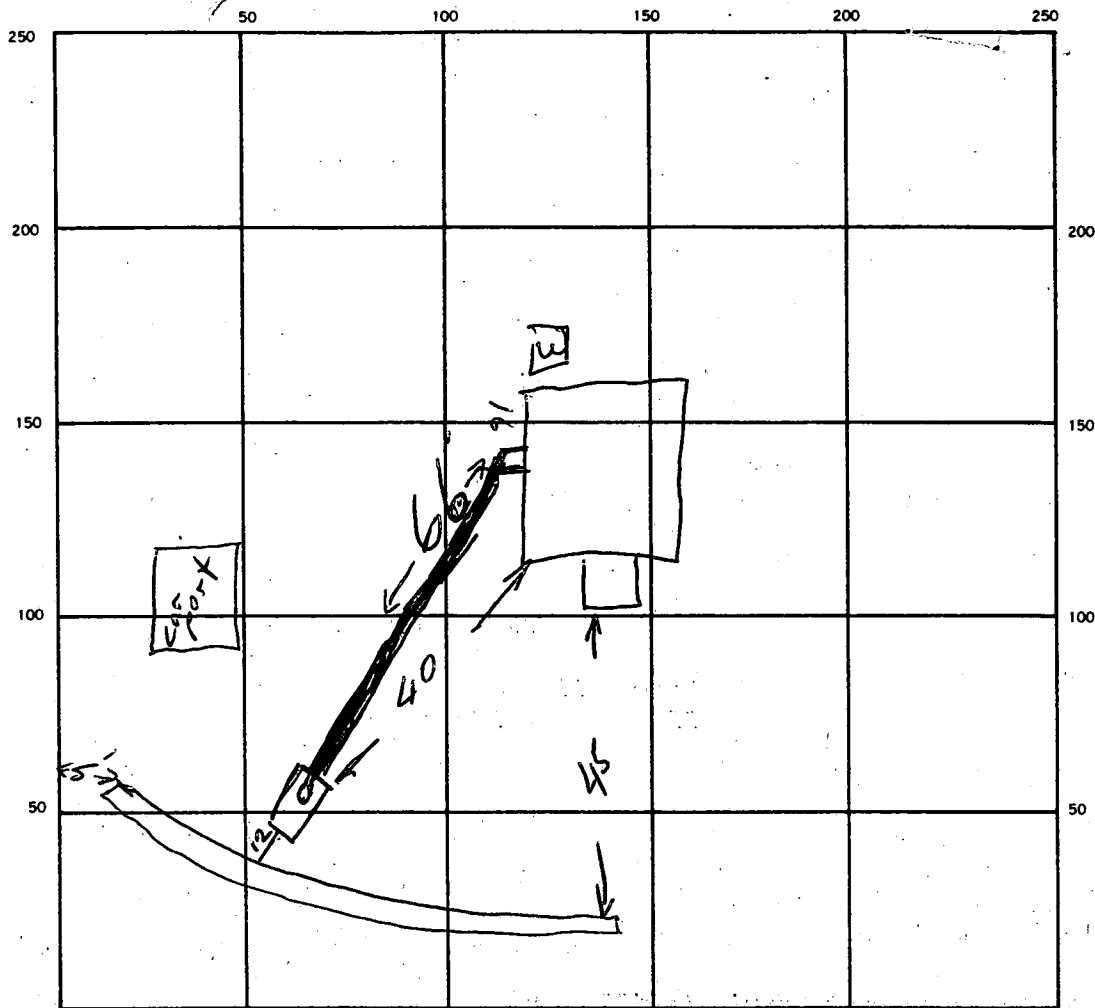

INDICATE NORTH — NAME ADJOINING ROADWAY AS BASE LINE.

Rt 144

SEPTIC TANK, LEVEL 1000 CLEANOUTS 5+

DISTRIBUTION BOX, LEVEL _____

DRAIN FIELD/TILE FIELD, DEPTH 11 FT. TRENCH WIDTH _____ FT. INLET DEPTH 3 FT.

EFFECTIVE GRAVEL DEPTH 8 FT. TOTAL LENGTH 68 FT.

NUMBER OF TRENCHES _____ ONE SIDEWALL/BOTTOM AREA _____ SQ. FT.

DRYWELL INSIDE DIAMETER _____ FT. EFFECTIVE DEPTH BELOW INLET _____ FT.

ABSORBENT AREA _____ SQ. FT.

REMARKS 10/25/88 - Skip Put the repair job in on a weekend. He had permission from Craig to cover without inspection per Skip.
B. Goodger

DATE SYSTEM APPROVED 10/31/88 INSPECTOR Craig Wilbur

10/6/88
T/C
P.M.
Before 4:50
[M 12.30]

10-7-88
AS LATE AS
POSSIBLE

T/C to Cathy
10/25 7 Fyock
A.M.
HOLD for paperwork

P.C.O. Discussed
10/6/88 only
10/7/88 P.C.O.
P 42725 C.B.D.

PERMIT

SEWAGE DISPOSAL SYSTEM

MARYLAND STATE DEPARTMENT OF HEALTH* DISTRICT _____

HOWARD COUNTY
BUREAU OF ENVIRONMENTAL HEALTH
461-9933

INDEXED

DATE 10/06/88
DATE SYSTEM APPROVED 10/10/88
INSPECTOR C.W.

Jack Fyock IS PERMITTED TO INSTALL _____ ALTER X

ADDRESS _____ PHONE 988-9270 GOING
NOTE 5th HOUSE FROM MARRIOTTSTVILLE WEST
SUBDIVISION _____ ROAD 11350 Route 144 LOT _____ RD.

PROPERTY OWNER Mauro Wells
11350 Route 144
ADDRESS _____

IF GARBAGE GRINDER IS USED INCREASE SEPTIC TANK CAPACITY BY 50% AND ABSORPTION AREA BY 22%.

GARBAGE GRINDER? YES _____ NO ✓

[SEPTIC TANK CAPACITY 1000 + NEW GALLONS] NUMBER OF BEDROOMS 3

10/6/88 Discussed
C.B.D.
KEEP SYSTEM NOTE
80' off well
160' of area/Bedroom
20'

DIRECTIONS - 5th house past Marriotttsville Road

REPAIR - CALL FOR INSPECTION WHEN GROUND IS OPENED UP SO SANITARIAN CAN RECOMMEND REPAIR.

Trench to be with 6' of stone if possible to make
480' of trench system; 80' of trench @ front of home.
C.B.D.

PLANS APPROVED BY C. Williams DATE 10/06/88

COVER NO WORK UNTIL INSPECTED AND APPROVED.

NEITHER THE HOWARD COUNTY COUNCIL NOR THE HEALTH DEPARTMENT IS RESPONSIBLE FOR THE SUCCESSFUL OPERATION OF ANY SYSTEM.

NOTE: CLEANOUT REQUIRED EVERY 70 FEET OF SEWER LINE AND/OR AT 90° SWEEPS IN LINES FROM HOUSE TO DRAIN FIELDS.

NOTE: ALL PARTS OF SEPTIC SYSTEMS (I.E., TANK, DISTRIBUTION BOX, TRENCHES) TO BE 100 FEET FROM WELL (UNLESS OTHERWISE SPECIFICALLY AUTHORIZED)

NOTE: IF DEEP TRENCH(IES) ARE USED CALL FOR INSPECTION BEFORE AND AFTER PLACING GRAVEL IN TRENCH(IES).

NOTE: NO DRY WELL SHALL EXCEED 15 FOOT IN DIAMETER. NO ABSORPTION TRENCH TO EXCEED 100 FEET IN LENGTH.

NOTE: ALL PIPE FROM HOUSE TO SEPTIC TANK MUST BE CAST IRON OR SCHEDULE 40 PVC OR ABS.

PERMIT VOID AFTER TWO YEARS.

NOTE: INSTALL STAND PIPE ON SEPTIC TANK AND DRY WELL. STAND PIPES MUST BE 6 INCHES IN DIAMETER. CAST IRON, CONCRETE OR TERRA COTTA OR PVC OR ABS ACCEPTED. IF TOP OF SEPTIC TANK IS DEEPER THAN 3 FEET, MANHOLE TO GRADE REQUIRED.

NOTE: DISTRIBUTION BOXES MUST HAVE BAFFLES.

***INSTALLER IS RESPONSIBLE FOR OBTAINING FINAL APROVAL ON THIS PERMIT**

*CALL 461-9933 FOR INSPECTION OF SEPTIC SYSTEMS.

EH - 2-1186

42725

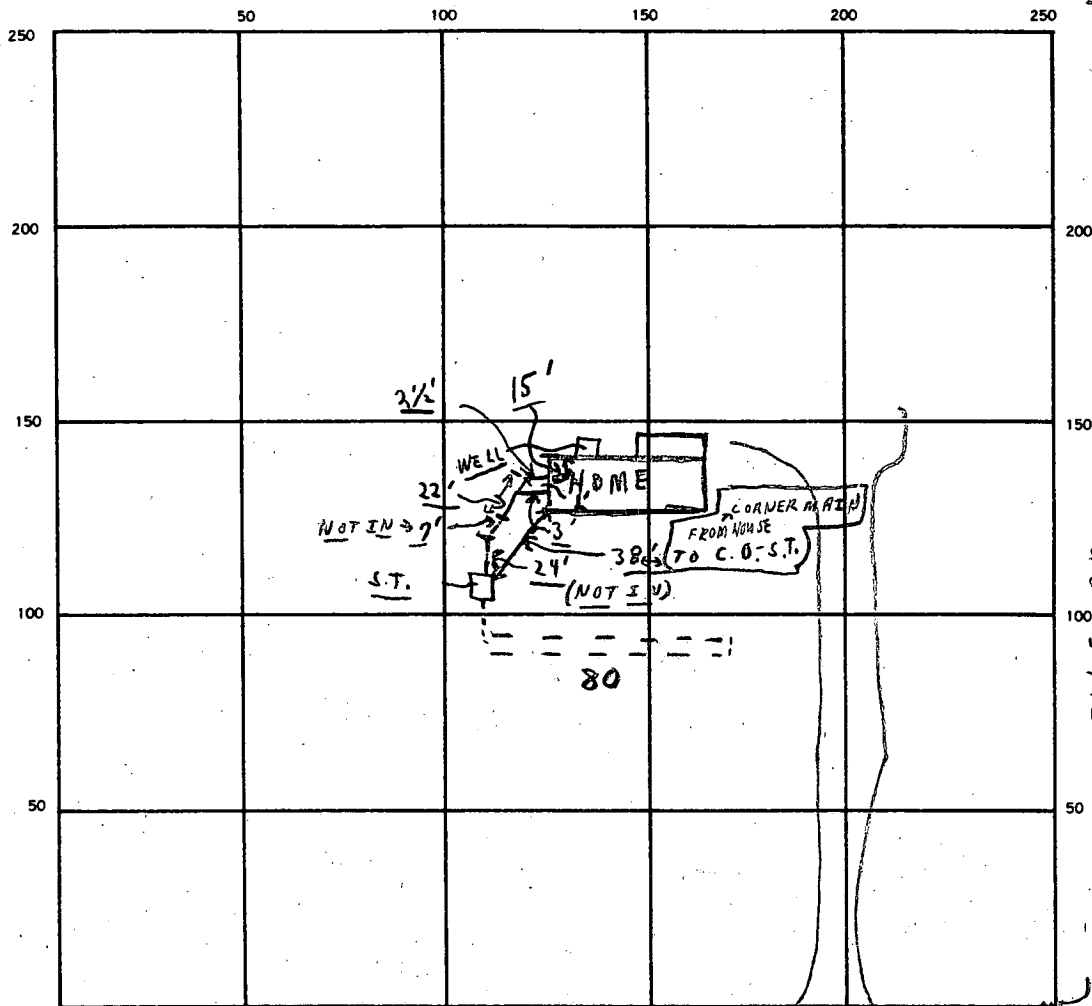

RT. 70
RD. 48

SEPTIC TANK. LEVEL OK RT. 144 CLEANOUTS (S.T. C.O. NO 10/2/88 C.B.D.) E.C.

DISTRIBUTION BOX. LEVEL N/A

DRAIN FIELD/TILE FIELD. DEPTH 2 FT. TRENCH WIDTH 24 FT. INLET DEPTH 2 FT. HOLD FOR FYOCK

EFFECTIVE GRAVEL DEPTH 2 FT. TOTAL LENGTH 2 FT. WITH FYOCK

NUMBER OF TRENCHES 1 ONE SIDEWALL/BOTTOM AREA 2 SQ. FT.

DRYWELL INSIDE DIAMETER 2 FT. EFFECTIVE DEPTH BELOW INLET 2 FT.

ABSORBENT AREA 480 SQ. FT.

REMARKS 10/6/88 discussed repair at site with J. FYOCK; 10/7/88
LATE-P.M. - PARTIAL - TANK IN; PART OF PIPE; TO BE COMPLETED - POSS-
IBLY OVER WEEK END - HOLD FOR ACALL OR DRAWING - CERTIFIED
DRAWING BY FYOCK; SEE ABOVE ALSO; LEFT CARD; OK TO CONTINUE AT BACK DOOR.
10/10/88 SYSTEM COMPLETE FOR CONSTRUCTION. C.B.D. Cullen

DATE SYSTEM APPROVED 10/10/88 INSPECTOR Cullen