

04-331656
PERMIT

SEWAGE DISPOSAL SYSTEM

MARYLAND STATE DEPARTMENT OF HEALTH

HOWARD COUNTY
BUREAU OF ENVIRONMENTAL HEALTH
461-9933

P 45702

A REPAIR

DATE 03/15/90

DATE SYSTEM APPROVED 3/15/90

INSPECTOR M. Ritkin

INDEXED

Jack Fyock

IS PERMITTED TO INSTALL ALTER X

ADDRESS 13775 Triadelphia Road, Glenelg, Maryland 21737 PHONE 988-9270

SUBDIVISION ROAD 14777 Roxbury Road LOT 1

PROPERTY OWNER Ira Zimmerman

ADDRESS 14777 Roxbury Road

ADDRESS Glenelg, Md. 21737

~~IF GARBAGE GRINDER IS USED INCREASE SEPTIC TANK CAPACITY BY 50% AND ABSORPTION AREA BY 25%~~

~~GARBAGE GRINDER~~ YES ~~XXXXXXXXXXXX~~ NO ~~XXXXXXXXXX~~

SEPTIC TANK CAPACITY GALLONS NUMBER OF BEDROOMS 3

REPAIR - CALL FOR INSPECTION WHEN GROUND IS OPENED SO SANITARIAN CAN RECOMMEND REPAIR.

125 # BR INLET 3' BOTTOM 10'

PLANS APPROVED BY Craig Williams cm DATE 03/15/90

COVER NO WORK UNTIL INSPECTED AND APPROVED

NEITHER THE HOWARD COUNTY COUNCIL NOR THE HEALTH DEPARTMENT IS RESPONSIBLE FOR THE SUCCESSFUL OPERATION OF ANY SYSTEM

NOTE: CLEANOUT REQUIRED EVERY 70 FEET OF SEWER LINE AND/OR AT 90° SWEEPS IN LINES FROM HOUSE TO DRAIN FIELDS

NOTE: ALL PARTS OF SEPTIC SYSTEMS (I.E. TANK, DISTRIBUTION BOX, TRENCHES) TO BE 100 FEET FROM WELL (UNLESS OTHERWISE SPECIFICALLY AUTHORIZED)

NOTE: IF DEEP TRENCH(ES) ARE USED CALL FOR INSPECTION BEFORE AND AFTER PLACING GRAVEL IN TRENCH(ES)

NOTE: NO DRY WELL SHALL EXCEED 15 FOOT IN DIAMETER NO ABSORPTION TRENCH TO EXCEED 100 FEET IN LENGTH.

NOTE: ALL PIPE FROM HOUSE TO SEPTIC TANK MUST BE CAST IRON OR SCHEDULE 40 PVC OR ABS

PERMIT VOID AFTER TWO YEARS

NOTE: INSTALL STAND PIPE ON SEPTIC TANK AND DRY WELL. STAND PIPES MUST BE 6 INCHES IN DIAMETER. CAST IRON, CONCRETE OR TERRA COTTA OR PVC OR ABS ACCEPTED. IF TOP OF SEPTIC TANK IS DEEPER THAN 3 FEET, MANHOLE TO GRADE REQUIRED

NOTE: DISTRIBUTION BOXES MUST HAVE BAFFLES

*INSTALLER IS RESPONSIBLE FOR OBTAINING FINAL APPROVAL ON THIS PERMIT

*CALL 461-9933 FOR INSPECTION OF SEPTIC SYSTEMS.

P 45702

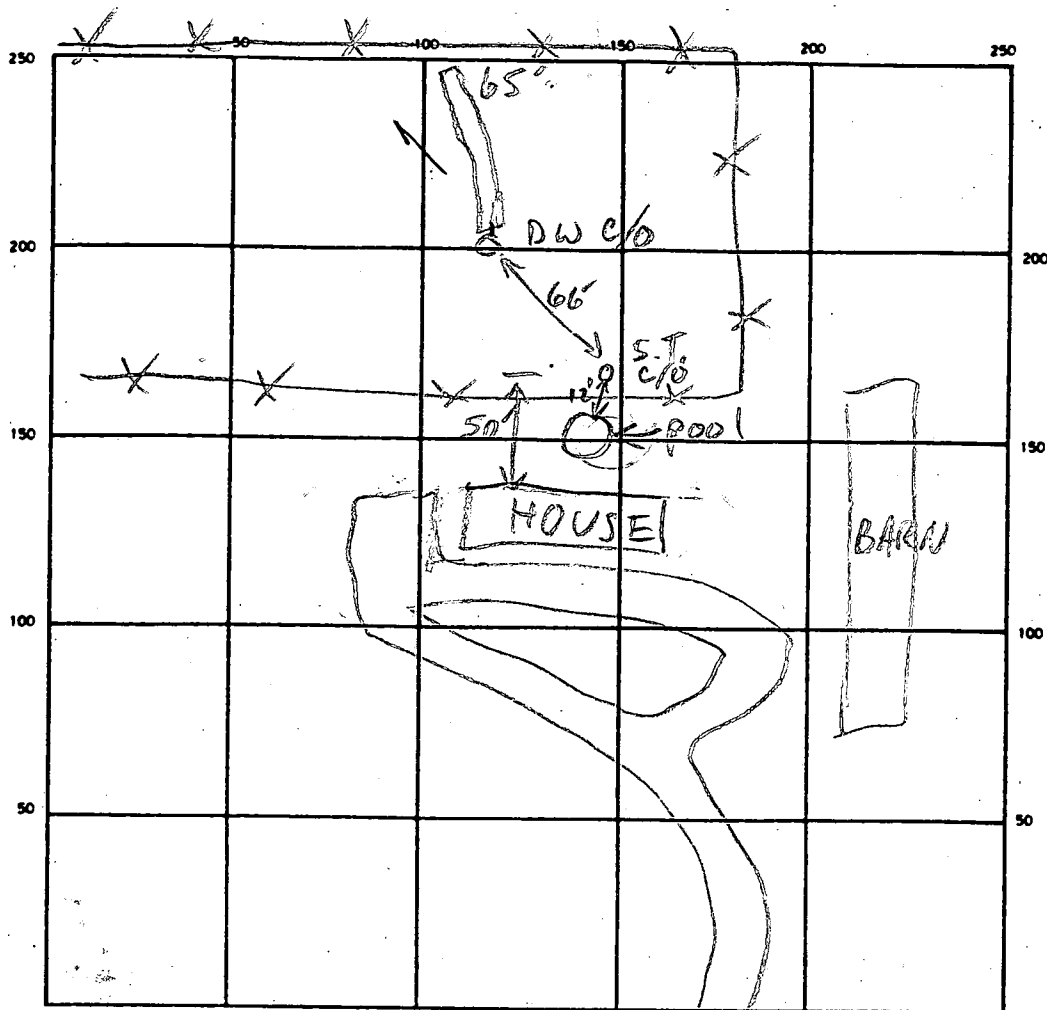

INDICATE NORTH - NAME ADJOINING ROADWAY AS BASE LINE
Roxbury Rd

SEPTIC TANK LEVEL OK CLEANOUTS S.T. OK DW OK

DISTRIBUTION BOX LEVEL —

DRAIN FIELD/TILE FIELD. DEPTH 10 FT. TRENCH WIDTH 2 FT. INLET DEPTH 3 FT.

EFFECTIVE GRAVEL DEPTH 7 FT. TOTAL LENGTH 65 FT.

NUMBER OF TRENCHES 1 ONE SIDEWALL/BOTTOM AREA 455 SQ. FT.

DRYWELL INSIDE DIAMETER — FT. EFFECTIVE DEPTH BELOW INLET — FT.

ABSORBENT AREA 455 SQ. FT.

REMARKS 3/15/90 OK TO COVER WHEN READY. TRENCH GOING SLIGHTLY DOWNHILL. CONTRACTOR INDICATES THIS DUE TO OWNER'S EXCAVATION OF A "REPAIR" TRENCH OFF D/W IN SAME LOCATION. CONTRACTOR COMPENSATED BY SLOPING PIPE 1/16" / FT. MR

DATE SYSTEM APPROVED 3/15/90 INSPECTOR M. Riffkin