

Hold For Pump Test

PERMIT

SEWAGE DISPOSAL SYSTEM

DEPARTMENT OF HEALTH AND MENTAL HYGIENE

HOWARD COUNTY HEALTH DEPARTMENT

BUREAU OF ENVIRONMENTAL HEALTH

461-9933

INDEXED

1/6/92 (2) P.C.O. C.B.

P 47631

A 46842

DISTRICT

DATE 1/6/92

DATE SYSTEM APPROVED 4/20/92

INSPECTOR C.B.

Whitworth Excavating IS PERMITTED TO INSTALL ALTER X

ADDRESS 12680 Clarksville Pike, Clarksville, Maryland 21029 PHONE 854-2513

SUBDIVISION Keith Wilson Property LOT 1 ROAD 12275 Scaggsville Road

PROPERTY OWNER Keith Wilson

ADDRESS

SEPTIC TANK CAPACITY GALLONS

NUMBER OF BEDROOMS 4 (1/6/92) 1-120' d. } PUMP SYSTEM TO BE INSTALLED

240 SQUARE FEET PER BEDROOM

LINEAR FEET OF TRENCH REQUIRED 320' +

TRENCHES - Trench to be 3 feet wide. Inlet 4 feet below original grade. Bottom maximum depth 4 feet below original grade. Effective area begins at 5 - 5 1/2 feet below original grade. 3 feet of stone below distribution pipe.

LOCATION - Trenches to start 95 feet from edge of existing Route 216 and 70 feet off right property line when facing lot from Route 216. Run trenches toward Route 216 on contour and keep trenches 15 feet off edge of Route 216. Run trenches on contour toward Route 216. Keep trenches 100 feet from water well at all times.

NOTE - No trench to exceed 100 feet in length. Provide 6" - 8" diameter cleanout and cap to grade or above on septic tank. OK 3 SEPT 91 RH

(F 320) (1) 120' d, (2) 100' + - 1/6/92 C.B.

PLANS APPROVED BY Charles Streaker cm DATE 7/25/91

COVER NO WORK UNTIL INSPECTED AND APPROVED

NEITHER THE HOWARD COUNTY COUNCIL NOR THE HEALTH DEPARTMENT IS RESPONSIBLE FOR THE SUCCESSFUL OPERATION OF ANY SYSTEM

NOTE: CLEANOUT REQUIRED EVERY 70 FEET OF SEWER LINE AND/OR AT 90° SWEEPS IN LINES FROM HOUSE TO DRAIN FIELDS, 90° ELBOWS NOT ACCEPTABLE.

NOTE: ALL PARTS OF SEPTIC SYSTEMS (I.E. TANK, DISTRIBUTION BOX TRENCHES) TO BE 100 FEET FROM WELL (UNLESS OTHERWISE SPECIFICALLY AUTHORIZED)

NOTE: IF DEEP TRENCH(ES) ARE USED CALL FOR INSPECTION BEFORE AND AFTER PLACING GRAVEL IN TRENCH(ES)

NOTE: NO DRY WELL SHALL EXCEED 15 FOOT IN DIAMETER NO ABSORPTION TRENCH TO EXCEED 100 FEET IN LENGTH

NOTE: ALL PIPE FROM HOUSE TO SEPTIC TANK MUST BE CAST IRON OR SCHEDULE 35/40 PVC OR ABS

PERMIT VOID AFTER TWO YEARS

NOTE: INSTALL STAND PIPE ON SEPTIC TANK AND DRY WELL STAND PIPES MUST BE 6 INCHES IN DIAMETER CAST IRON, CONCRETE OR TERRA COTTA OR PVA OR ABS ACCEPTED. IF TOP OF SEPTIC TANK IS DEEPER THAN 3 FEET, MANHOLE TO GRADE REQUIRED.

NOTE: DISTRIBUTION BOXES MUST HAVE BAFFLES

*INSTALLER IS RESPONSIBLE FOR OBTAINING FINAL APPROVAL ON THIS PERMIT

*CALL 461-9933 FOR INSPECTION OF SEPTIC SYSTEM.

46842

250 50 100 150 200 250

(A)
11-27-91
5 Red-brown
silt
0 Red-yellow
micaceous,
lenses
of Feldspar
w/ traces
of mottles
at 6.0 ft. 9.0 ft.
Bottom

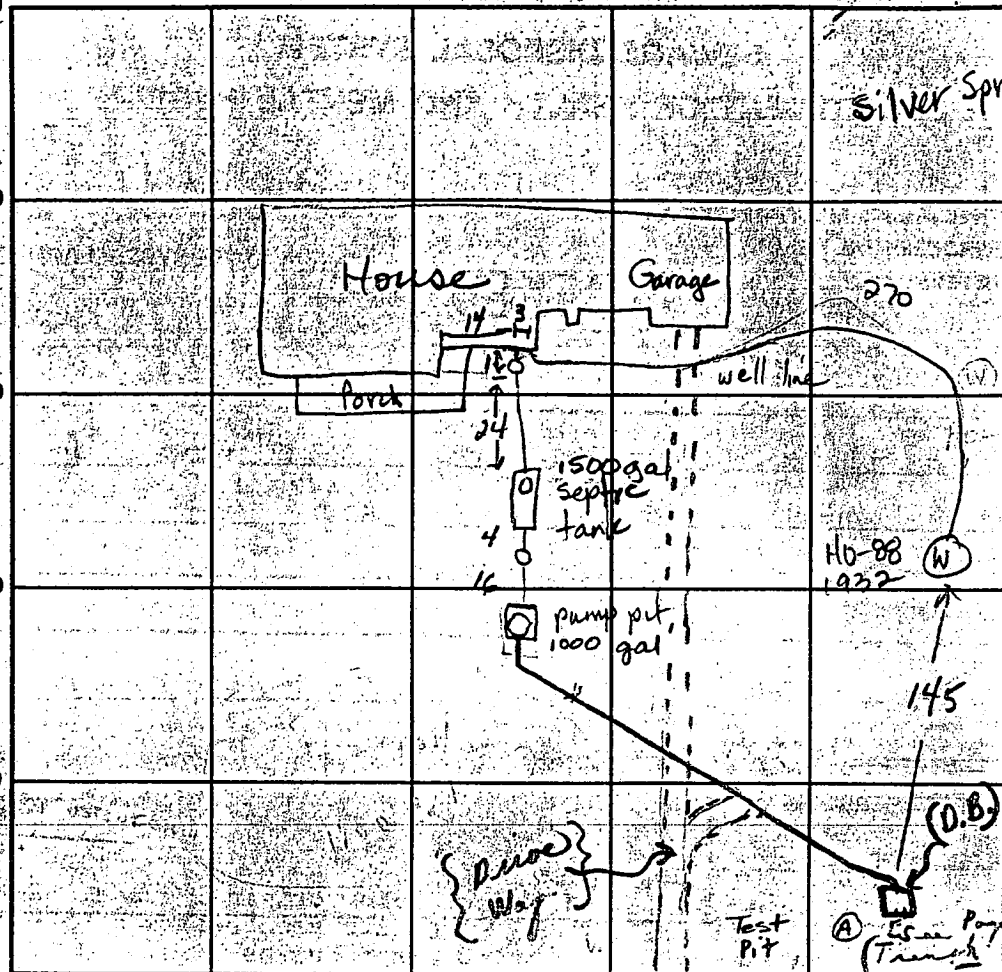

384-
Plans
Donald
Dermitt
RCM
WPI 60 in to
P.A. No ground
line. Well line
at 60 in
would need
20 ft of
sleeve
at house,
well line
24 in below
traffic line,
No pump
tank yet.
JEN
1/6/92 MUD + 10R
WATER
COVERED
C.B.

INDICATE NORTH - NAME ADJOINING ROADWAY AS BASE LINE
SEPTIC TANK LEVEL 1500 gal top seam, 1000 gal bottom seam
CLEANOUTS 1 at house, 1 on ST, 1 in line
DISTRIBUTION BOX LEVEL OK (Top seam)
HIGHLAND

RAIN FIELD/TITLE DEPTH 7 per cent FT. TRENCH WIDTH 3 FT. INLET DEPTH 4 FT.
EFFECTIVE GRAVEL DEPTH 4 average FT. TOTAL LENGTH 10.1 FT. } 32
NUMBER OF TRENCHES 3 ONE 32 / BOTTOM AREA 960 SQ. FT.
DRYWALL INSIDE DIAMETER FT. EFFECTIVE DEPTH BELOW INLET FT.
ABSORBENT AREA 960+ SQ. FT.

REMARKS: 11-27-91 Top seam septic tank and pump pit in place. Add baffle
to front of pump pit. Observed soils at dist. box. Some mottles at 6.0-7.0 ft.
to backfill around tanks. STOP WORK ORDER ISSUED. JEN 12/10/91
1/6/92 A.M. - Working on pump lines + baffles @ front of pump pit. A.M. - Partial
1/6/92 OK TO COVER ALL WORK - 20' from house to dist box - P.M. - Partial
NO TRENCHES - STARTED YET - HOLD FOR A CALL -> See page 2
DATE SYSTEM APPROVED 4/20/92 INSPECTOR Charles Bryan