

10/18/90 noon

Tax ID 03-300374

# PERMIT

## SEWAGE DISPOSAL SYSTEM

### DEPARTMENT OF HEALTH AND MENTAL HYGIENE

P 46468

A REPAIR

DISTRICT \_\_\_\_\_

DATE 10/18/90

#### HOWARD COUNTY HEALTH DEPARTMENT

##### BUREAU OF ENVIRONMENTAL HEALTH

461-9933

INDEXED

DATE SYSTEM APPROVED M. R. F. Kin

INSPECTOR 10/18/90

Dennis Feaga

IS PERMITTED TO INSTALL

ALTER ☒

ADDRESS 1625 Henryton Road, Marriottsville, Maryland 21104

PHONE 442-5623

SUBDIVISION \_\_\_\_\_ LOT \_\_\_\_\_ ROAD 1759 Woodstock Road

PROPERTY OWNER Mrs. David Wanex

ADDRESS 1759 Woodstock Road, Woodstock, Maryland 21164, Phone # 465-0131

SEPTIC TANK CAPACITY 1000 GALLONS

NUMBER OF BEDROOMS 4

2125 SQUARE FEET PER BEDROOM

LINEAR FEET OF TRENCH REQUIRED \_\_\_\_\_

REPAIR - TO ADD TRENCH 320 SQ. FEET TO DRYWELL. CALL FOR INSPECTION WHEN GROUND IS OPENED SO SANITARIAN CAN RECOMMEND REPAIR.

INLET 6 1/2' BOTTOM 12' ~62' TRENCH REQ.

PLANS APPROVED BY Craig Williams

cm

DATE 10/09/90

COVER NO WORK UNTIL INSPECTED AND APPROVED

NEITHER THE HOWARD COUNTY COUNCIL NOR THE HEALTH DEPARTMENT IS RESPONSIBLE FOR THE SUCCESSFUL OPERATION OF ANY SYSTEM

NOTE: CLEANOUT REQUIRED EVERY 70 FEET OF SEWER LINE AND/OR AT 90° SWEEPS IN LINES FROM HOUSE TO DRAIN FIELDS, 90° ELBOWS NOT ACCEPTABLE.

NOTE: ALL PARTS OF SEPTIC SYSTEMS (I.E. TANK, DISTRIBUTION BOX TRENCHES) TO BE 100 FEET FROM WELL (UNLESS OTHERWISE SPECIFICALLY AUTHORIZED)

NOTE: IF DEEP TRENCH(ES) ARE USED CALL FOR INSPECTION BEFORE AND AFTER PLACING GRAVEL IN TRENCH(ES)

NOTE: NO DRY WELL SHALL EXCEED 15 FOOT IN DIAMETER NO ABSORPTION TRENCH TO EXCEED 100 FEET IN LENGTH

NOTE: ALL PIPE FROM HOUSE TO SEPTIC TANK MUST BE CAST IRON OR SCHEDULE 35/40 PVC OR ABS

PERMIT VOID AFTER TWO YEARS

NOTE: INSTALL STAND PIPE ON SEPTIC TANK AND DRY WELL STAND PIPES MUST BE 6 INCHES IN DIAMETER CAST IRON. CONCRETE OR TERRA COTTA OR PVA OR ABS ACCEPTED. IF TOP OF SEPTIC TANK IS DEEPER THAN 3 FEET. MANHOLE TO GRADE REQUIRED.

NOTE: DISTRIBUTION BOXES MUST HAVE BAFFLES

**\*INSTALLER IS RESPONSIBLE FOR OBTAINING FINAL APPROVAL ON THIS PERMIT**

P 46468

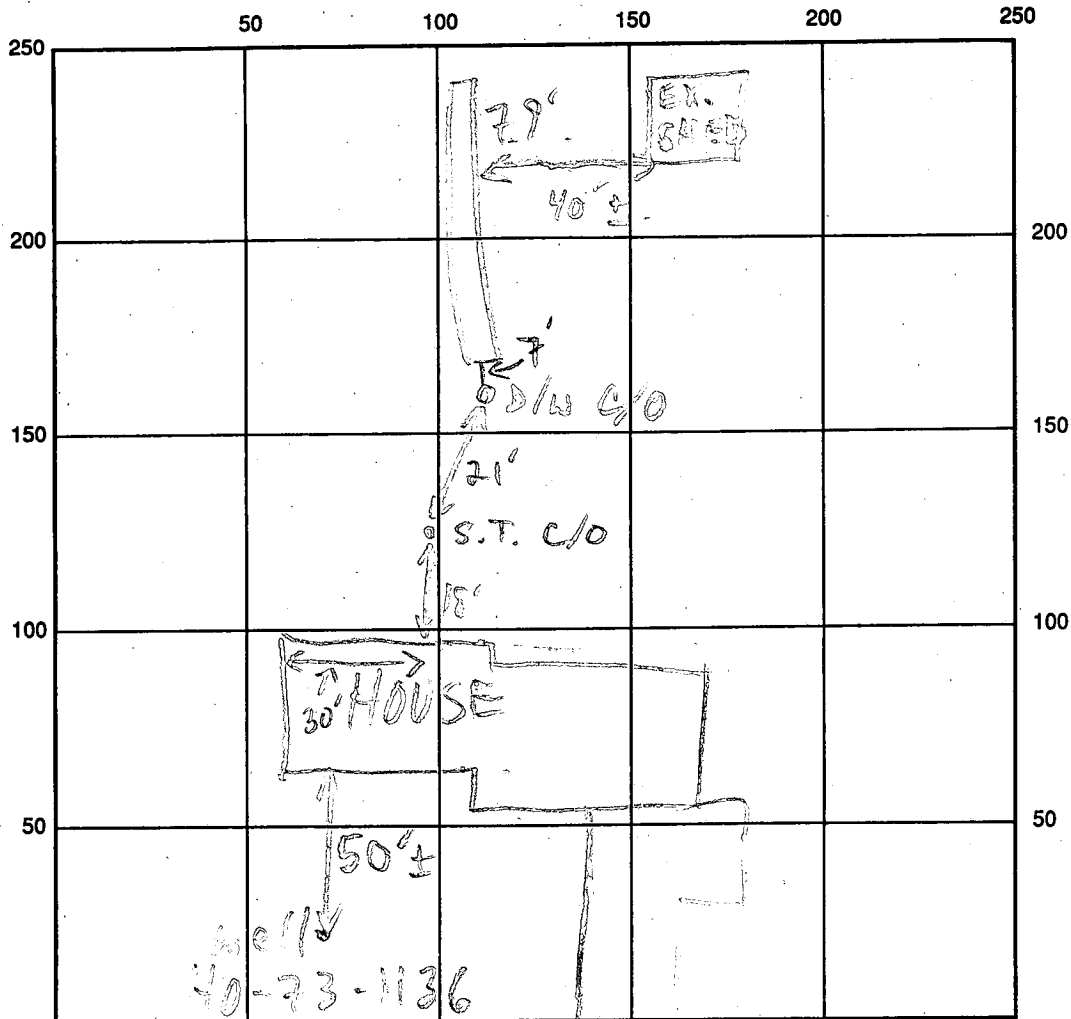

INDICATE NORTH - NAME ADJOINING ROADWAY AS BASE LINE

WOODSTOCK RD

SEPTIC TANK LEVEL 1000 GAL-EXISTING CLEANOUTS NEW C/O ON S.W. 1/4

DISTRIBUTION BOX LEVEL —

DRAIN FIELD/TITLE DEPTH 11.5-12.5 FT. TRENCH WIDTH 2 FT. INLET DEPTH 6.5 FT.

EFFECTIVE GRAVEL DEPTH 5-6 FT. TOTAL LENGTH 79 FT.

NUMBER OF TRENCHES 1 ONE SIDEWALL/BOTTOM AREA 434± SQ. FT. (79' x 5.5')

DRYWALL INSIDE DIAMETER — FT. EFFECTIVE DEPTH BELOW INLET — FT.

ABSORBENT AREA 434± SQ. FT.

REMARKS: 10/18/90 #1 OK TO CONTINUE W/STONE MR  
10/18/90 #2 OK TO COVER ALL MR

DATE SYSTEM APPROVED 10/18/90 INSPECTOR M. Rifkin