

4/13/94 AM  
4/13/94 A.M.

# PERMIT

## SEWAGE DISPOSAL SYSTEM

### DEPARTMENT OF HEALTH AND MENTAL HYGIENE

HOWARD COUNTY HEALTH DEPARTMENT

BUREAU OF ENVIRONMENTAL HEALTH

~~XXXX-9933~~ 313-2640

03-295753

INDEXED

P 49973 E  
A 13307  
A REPAIR

DISTRICT \_\_\_\_\_

DATE 4/19/94

DATE SYSTEM APPROVED 4/15/94

INSPECTOR [Signature]

Jack Fyock Septic Service

IS PERMITTED TO INSTALL \_\_\_\_\_ ALTER ☒

ADDRESS \_\_\_\_\_ PHONE 988-9270

SUBDIVISION \_\_\_\_\_ LOT \_\_\_\_\_ ROAD 560 River Road

PROPERTY OWNER Jacques  
560 River Road

ADDRESS \_\_\_\_\_

SEPTIC TANK CAPACITY existing GALLONS

NUMBER OF BEDROOMS 3

125 SQUARE FEET PER BEDROOM

LINEAR FEET OF TRENCH REQUIRED 58

DIRECTIONS -  
"WAY BACK" RIVER RD  
ALMOST TO PARK.

REPAIR - PURPOSE ---Septic System Has Failed.

Call for inspection when ground is opened so sanitarian can recommend repair. 04/06/94

Install one 58 ft long, 2 ft wide, 10 ft deep, inlet to 3', 7 ft stone fill  
Trench. Connect through existing dry well.

PLANS APPROVED BY [Signature] DATE 4/13/94

COVER NO WORK UNTIL INSPECTED AND APPROVED

NEITHER THE HOWARD COUNTY COUNCIL NOR THE HEALTH DEPARTMENT IS RESPONSIBLE FOR THE SUCCESSFUL OPERATION OF ANY SYSTEM

NOTE: CLEANOUT REQUIRED EVERY 70 FEET OF SEWER LINE AND/OR AT 90° SWEEPS IN LINES FROM HOUSE TO DRAIN FIELDS, 90° ELBOWS NOT ACCEPTABLE.

NOTE: ALL PARTS OF SEPTIC SYSTEMS (I.E. TANK, DISTRIBUTION BOX TRENCHES) TO BE 100 FEET FROM WELL (UNLESS OTHERWISE SPECIFICALLY AUTHORIZED)

NOTE: IF DEEP TRENCH(ES) ARE USED CALL FOR INSPECTION BEFORE AND AFTER PLACING GRAVEL IN TRENCH(ES)

NOTE: NO DRY WELL SHALL EXCEED 15 FOOT IN DIAMETER NO ABSORPTION TRENCH TO EXCEED 100 FEET IN LENGTH

NOTE: ALL PIPE FROM HOUSE TO SEPTIC TANK MUST BE CAST IRON OR SCHEDULE 35/40 PVC OR ABS

PERMIT VOID AFTER TWO YEARS

NOTE: INSTALL STAND PIPE ON SEPTIC TANK AND DRY WELL STAND PIPES MUST BE 6 INCHES IN DIAMETER CAST IRON, CONCRETE OR TERRA COTTA OR PVA OR ABS ACCEPTED. IF TOP OF SEPTIC TANK IS DEEPER THAN 3 FEET, MANHOLE TO GRADE REQUIRED.

NOTE: DISTRIBUTION BOXES MUST HAVE BAFFLES

\*INSTALLER IS RESPONSIBLE FOR OBTAINING FINAL APPROVAL ON THIS PERMIT

49973 E

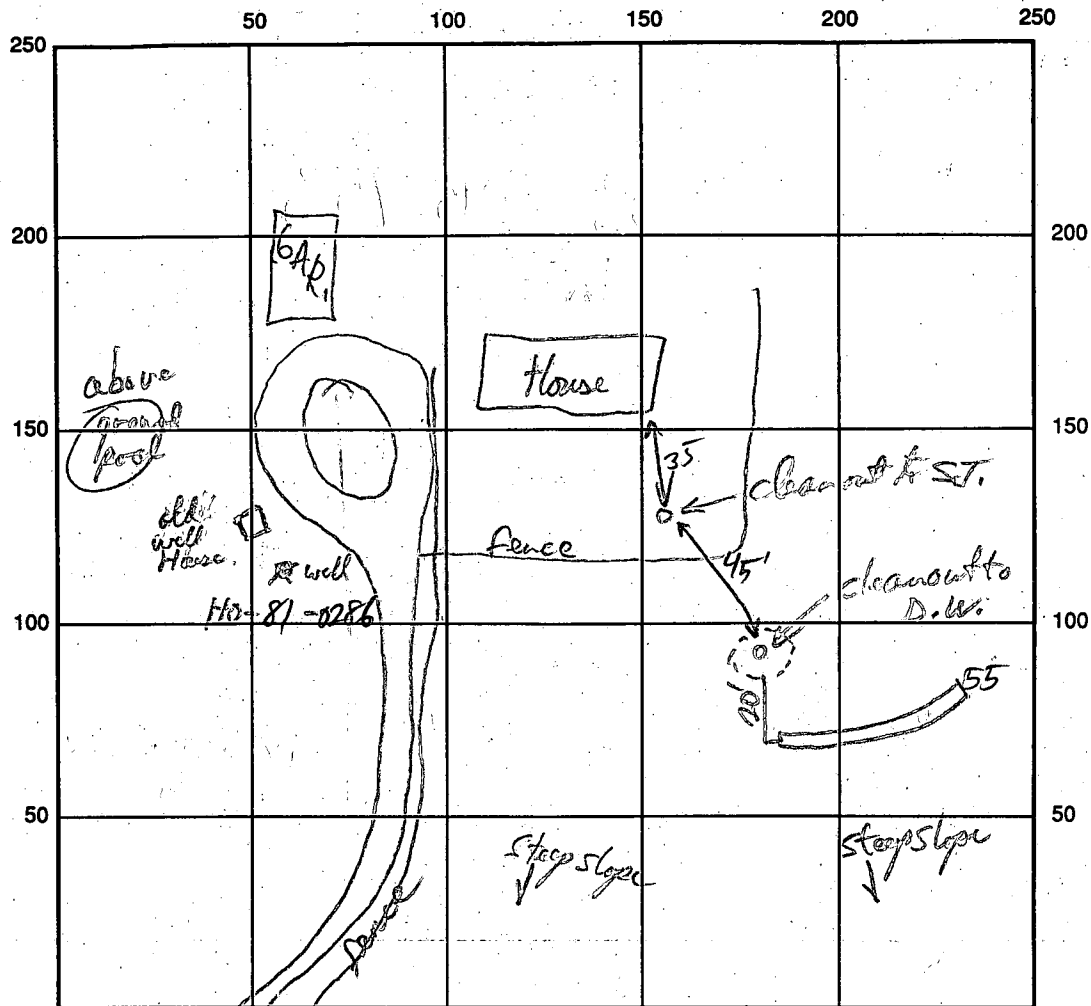

INDICATE NORTH - NAME ADJOINING ROADWAY AS BASE LINE

*river rd*

SEPTIC TANK LEVEL existing CLEANOUTS existing ST., D.W.  
 DISTRIBUTION BOX LEVEL NA. one trench connected thru dry well  
 DRAIN FIELD/TITLE DEPTH 10 FT. TRENCH WIDTH 2 FT. INLET DEPTH 3 FT.  
 EFFECTIVE GRAVEL DEPTH 7 FT. TOTAL LENGTH 55 FT.  
 NUMBER OF TRENCHES 1 ONE SIDEWALL/BOTTOM AREA 385 SQ. FT.  
 DRYWALL INSIDE DIAMETER        FT. EFFECTIVE DEPTH BELOW INLET        FT.  
 ABSORBENT AREA        SQ. FT.

REMARKS: OK to continue around hill in trench. RFP 4/13/94 Call for final design when ready  
OK to cover RFP 4/15/94

DATE SYSTEM APPROVED 4/15/94 INSPECTOR *[Signature]*