

03-297322  
**PERMIT**

SEWAGE DISPOSAL SYSTEM

MARYLAND STATE DEPARTMENT OF HEALTH

P 35558

A REPAIR

**HOWARD COUNTY**  
BUREAU OF ENVIRONMENTAL HEALTH  
992-2330

**ELLICOTT CITY**

DISTRICT \_\_\_\_\_

DATE 5/16/85

INDEXED

R. E. Mytrue IS PERMITTED TO INSTALL \_\_\_\_\_ ALTER X

ADDRESS 1685 Woodstock Road PHONE 465-8551

SUBDIVISION \_\_\_\_\_ ROAD 1685 Woodstock Road LOT \_\_\_\_\_

PROPERTY OWNER R. E. Mytrue

ADDRESS \_\_\_\_\_

IF GARBAGE GRINDER IS USED INCREASE SEPTIC TANK CAPACITY BY 50% AND ABSORPTION AREA BY 22%.

GARBAGE GRINDER? YES \_\_\_\_\_ NO \_\_\_\_\_

SEPTIC TANK CAPACITY \_\_\_\_\_ GALLONS NUMBER OF BEDROOMS \_\_\_\_\_

REPAIR - CALL FOR INSPECTION WHEN GROUND IS OPENED UP SO SANITARIAN CAN RECOMMEND

REPAIR.

(DIRECTIONS: - 1 or 2 Houses down and across street from Post Office)

INSTALL DRYWELL 10' DEEP INLET AT 2' BELOW GRADE,

8' STONE X 60' DIAMETER = 480 SQ FT.

ADD CLEANOUT TO SEPTIC TANK.

PUMP OUT AND ABANDON EXISTING SEEPAGE PIT. CW

PLANS APPROVED BY Craig Williams 3 WKS TO COMPLETE. DATE 7/16/85

COVER NO WORK UNTIL INSPECTED AND APPROVED.

NEITHER THE HOWARD COUNTY COUNCIL NOR THE HEALTH DEPARTMENT IS RESPONSIBLE FOR THE SUCCESSFUL OPERATION OF ANY SYSTEM.

NOTE: IF TRENCH IS USED CALL FOR INSPECTION BEFORE AND AFTER PLACING GRAVEL IN TRENCH.

NOTE: NO DRY WELL SHALL EXCEED 15 FOOT IN DIAMETER. NO ABSORPTION TRENCH TO EXCEED 100 FEET IN LENGTH.

NOTE: ALL PIPE FROM HOUSE TO SEPTIC TANK MUST BE CAST IRON OR SCHEDULE 40 PVC OR ABS.

PERMIT VOID AFTER THREE YEARS.

NOTE: INSTALL STAND PIPE ON SEPTIC TANK AND DRY WELL. STAND PIPES MUST BE 6 INCHES IN DIAMETER. CAST IRON, CONCRETE OR TERRA COTTA, OR PVC OR ABS ACCEPTED. IF TOP OF SEPTIC TANK IS DEEPER THAN 3 FEET MANHOLE TO GRADE REQUIRED.

**\*INSTALLER IS RESPONSIBLE FOR OBTAINING FINAL APROVAL ON THIS PERMIT**

\*CALL 992-2330 FOR INSPECTION OF SEPTIC SYSTEMS.

EH - 2-1082

P 35558

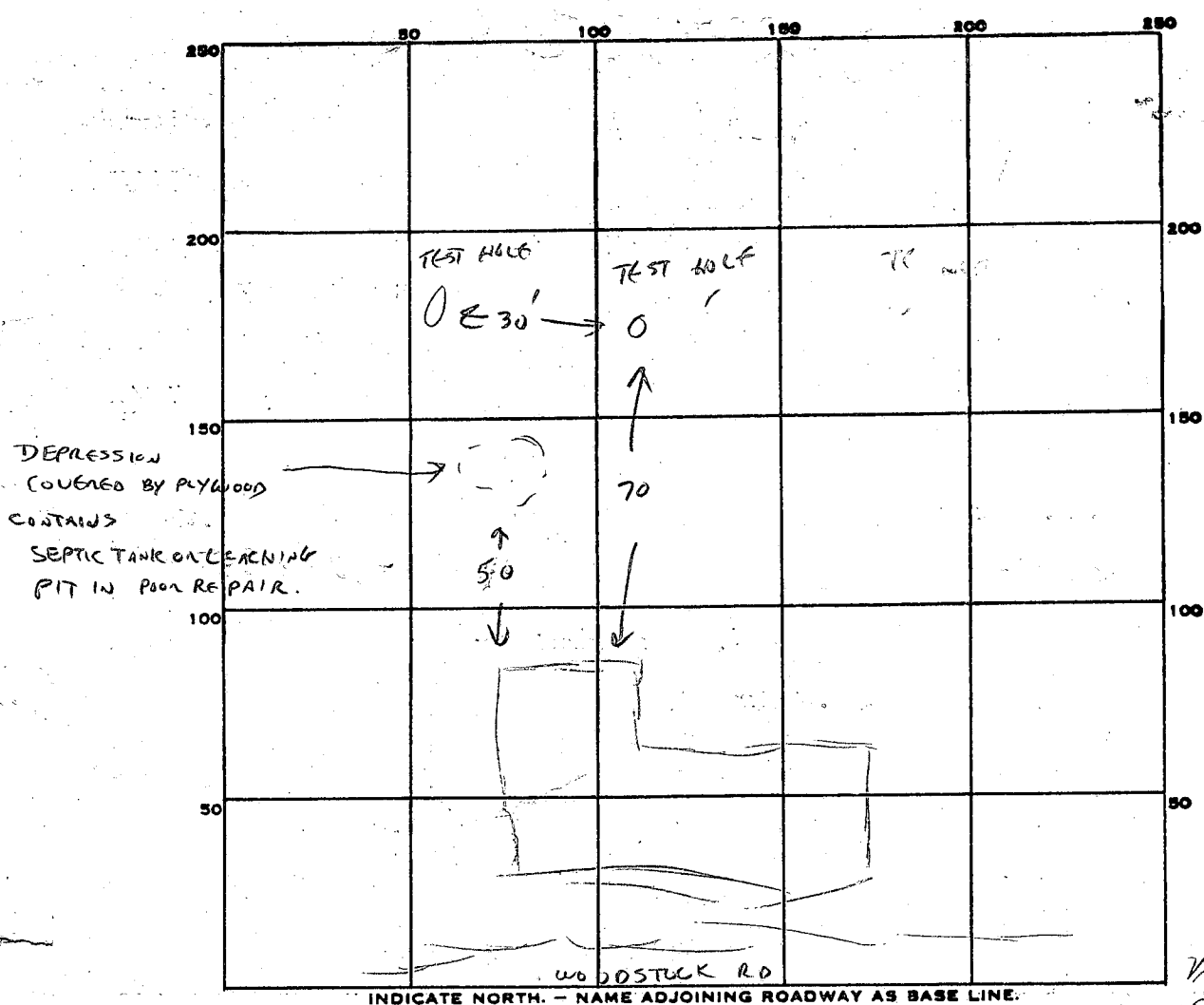

474  
480

8

2-10

PERMIT CARD \_\_\_\_\_

SEPTIC TANK, LEVEL \_\_\_\_\_

CLEANOUTS \_\_\_\_\_

DISTRIBUTION BOX, LEVEL \_\_\_\_\_

TILE FIELD, DEPTH \_\_\_\_\_ FT. TRENCH WIDTH \_\_\_\_\_ FT.

GRAVEL DEPTH \_\_\_\_\_ IN. TOTAL LENGTH \_\_\_\_\_ FT.

NUMBER OF TRENCHES \_\_\_\_\_ TOTAL BOTTOM AREA \_\_\_\_\_

SEEPAGE PITS, INSIDE DIAMETER \_\_\_\_\_ FT. DEPTH BELOW INLET \_\_\_\_\_ FT.

ABSORBENT AREA \_\_\_\_\_ SQ. FT.

REMARKS SOIL - SANDY SILT CLAY 0'-12' DEEP, HIGH GROUND.

RECENT REPAIR NEXT DOOR - ELEVATION SLIGHTLY LOWER, SOIL OK TO 14'

DATE SYSTEM APPROVED \_\_\_\_\_ INSPECTOR \_\_\_\_\_

8/11/85  
ASAP  
8/19/85  
SPM  
late

8-7-85  
approved  
Sick Avel

# PERMIT

SEWAGE DISPOSAL SYSTEM

MARYLAND STATE DEPARTMENT OF HEALTH

HOWARD COUNTY

BUREAU OF ENVIRONMENTAL HEALTH

992-2330

P \_\_\_\_\_

A REPAIR \_\_\_\_\_

ELLICOTT CITY

DISTRICT \_\_\_\_\_

DATE \_\_\_\_\_

\_\_\_\_\_ Myrtue \_\_\_\_\_ IS PERMITTED TO INSTALL \_\_\_\_\_ ALTER ☒

ADDRESS \_\_\_\_\_ PHONE \_\_\_\_\_

SUBDIVISION \_\_\_\_\_ ROAD 1685 Woodstock LOT \_\_\_\_\_

PROPERTY OWNER \_\_\_\_\_ Myrtue \_\_\_\_\_

1685 Woodstock Road

ADDRESS \_\_\_\_\_

IF GARBAGE GRINDER IS USED INCREASE SEPTIC TANK CAPACITY BY 50% AND ABSORPTION AREA BY 22%.

GARBAGE GRINDER? YES \_\_\_\_\_ NO \_\_\_\_\_

SEPTIC TANK CAPACITY \_\_\_\_\_ GALLONS NUMBER OF BEDROOMS \_\_\_\_\_

\_\_\_\_\_  
\_\_\_\_\_  
\_\_\_\_\_  
\_\_\_\_\_  
\_\_\_\_\_  
\_\_\_\_\_  
\_\_\_\_\_  
\_\_\_\_\_  
\_\_\_\_\_  
\_\_\_\_\_

PLANS APPROVED BY \_\_\_\_\_ DATE \_\_\_\_\_

COVER NO WORK UNTIL INSPECTED AND APPROVED.

NEITHER THE HOWARD COUNTY COUNCIL NOR THE HEALTH DEPARTMENT IS RESPONSIBLE FOR THE SUCCESSFUL OPERATION OF ANY SYSTEM.

NOTE: IF TRENCH IS USED CALL FOR INSPECTION BEFORE AND AFTER PLACING GRAVEL IN TRENCH.

NOTE: NO DRY WELL SHALL EXCEED 15 FOOT IN DIAMETER. NO ABSORPTION TRENCH TO EXCEED 100 FEET IN LENGTH.

NOTE: ALL PIPE FROM HOUSE TO SEPTIC TANK MUST BE CAST IRON OR SCHEDULE 40 PVC OR ABS.

PERMIT VOID AFTER THREE YEARS.

NOTE: INSTALL STAND PIPE ON SEPTIC TANK AND DRY WELL. STAND PIPES MUST BE 6 INCHES IN DIAMETER. CAST IRON, CONCRETE OR TERRA COTTA. OR PVC OR ABS ACCEPTED. IF TOP OF SEPTIC TANK IS DEEPER THAN 3 FEET MANHOLE TO GRADE REQUIRED.

**\*INSTALLER IS RESPONSIBLE FOR OBTAINING FINAL APPROVAL ON THIS PERMIT**

\*CALL 992-2330 FOR INSPECTION OF SEPTIC SYSTEMS.

EH - 2-1082

835558

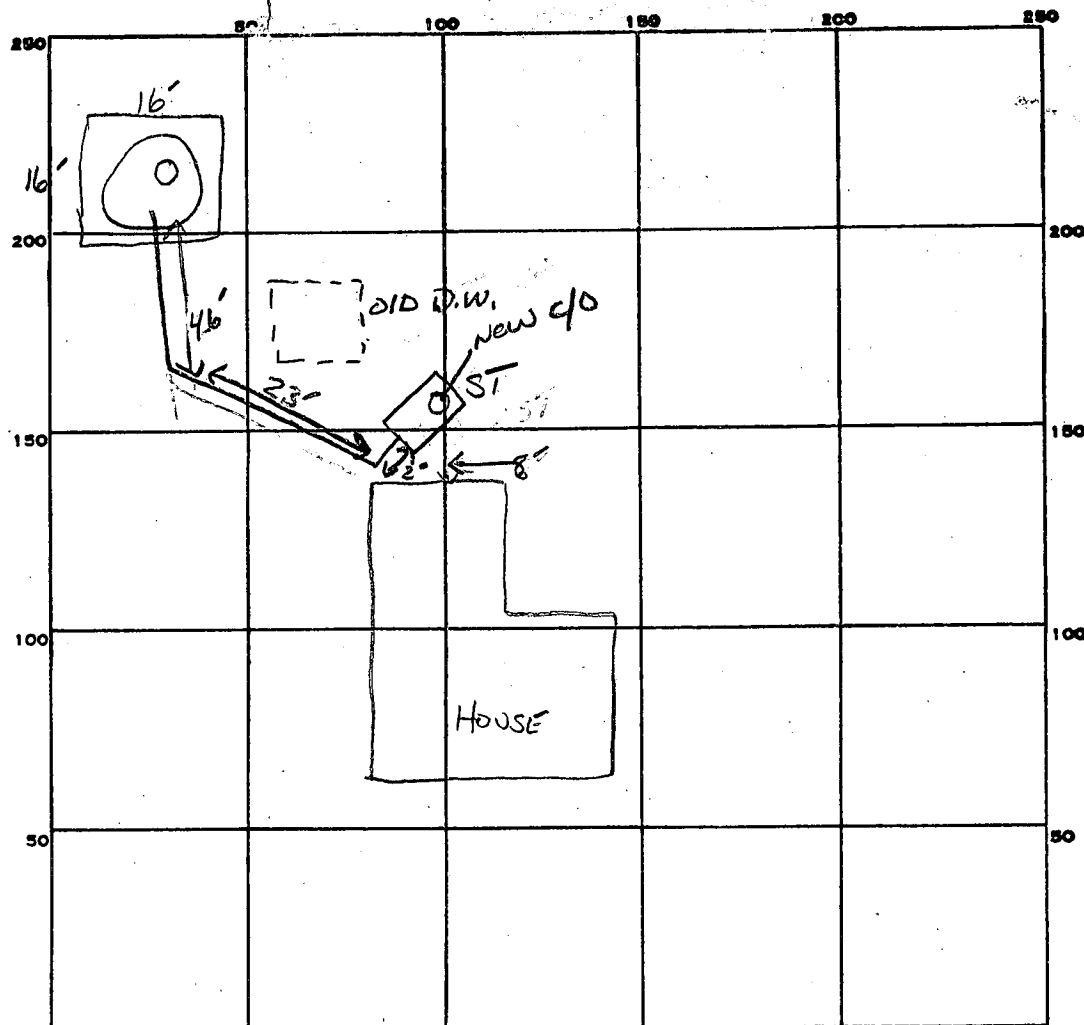

INDICATE NORTH. - NAME ADJOINING ROADWAY AS BASE LINE.  
WOODSTOCK

PERMIT CARD ✓

SEPTIC TANK, LEVEL EXISTING

CLEANOUTS ✓ ON ST + DW

DISTRIBUTION BOX, LEVEL N/A

TILE FIELD, DEPTH        FT. TRENCH WIDTH        FT.

INLET 2'

GRAVEL DEPTH 8 FT ~~IN~~ TOTAL LENGTH        FT.

NUMBER OF TRENCHES        TOTAL BOTTOM AREA       

3  
64  
8  
512

Drywell  
SEEPAGE PITS, INSIDE DIAMETER 16 X 16 FT. DEPTH BELOW INLET 8' FT.

DEPTH TO BOTTOM  
10' Below GRADE

ABSORBENT AREA 512 SQ. FT.

REMARKS 8-1-85 OK TO ADD STONE TO D.W. - CONNECT TANK TO D.W. AND CALL FOR INSPECTION S.A.

8-7-85

DATE SYSTEM APPROVED 8-7-85

INSPECTOR S. Abel