

6/2/83

PERMIT

SEWAGE DISPOSAL SYSTEM

MARYLAND STATE DEPARTMENT OF HEALTH

HOWARD COUNTY

BUREAU OF ENVIRONMENTAL HEALTH
992-2330

05-346495

INDEX

ELLICOTT CITY

DISTRICT 5th

DATE 5/3/83

Robert C. Cole

IS PERMITTED TO INSTALL ☒ ALTER ☐

ADDRESS 6838 Guilford Road, Clarksville, Md. 21029 PHONE 854-3370

SUBDIVISION Cole property ROAD 6838 Route 32 Hall Shop & Guilford Roads LOT

PROPERTY OWNER Robert C. Cole

ADDRESS same as above

IF GARBAGE GRINDER IS USED INCREASE SEPTIC TANK CAPACITY BY 50% AND ABSORPTION AREA BY 22%.

GARBAGE GRINDER? YES ☐ NO ☐

SEPTIC TANK CAPACITY GALLONS NUMBER OF BEDROOMS

REPAIR - Call for an appointment when ground is opened up and Sanitarian will recommend the repair system.

5-9-83 CONDITION FOUND ^{VERY} CACEN BRASS OUTLETS DRYWELL, & SEPTIC TANK.
-INDICATES PERIODIC OVERFLOW CW

6-2-83 14' HOLE - MICA SAND ADD 60 TRENCH - GRAVEL 3'-10' CW

PLANS APPROVED BY Palmer F. Wine

DATE 5/3/83

COVER NO WORK UNTIL INSPECTED AND APPROVED.

NEITHER THE HOWARD COUNTY COUNCIL NOR THE HEALTH DEPARTMENT IS RESPONSIBLE FOR THE SUCCESSFUL OPERATION OF ANY SYSTEM.

NOTE: IF TRENCH IS USED CALL FOR INSPECTION BEFORE AND AFTER PLACING GRAVEL IN TRENCH.

NOTE: NO DRY WELL SHALL EXCEED 15 FOOT IN DIAMETER. NO ABSORPTION TRENCH TO EXCEED 100 FEET IN LENGTH.

NOTE: ALL PIPE FROM HOUSE TO SEPTIC TANK MUST BE CAST IRON OR SCHEDULE 40 PVC OR ABS.

PERMIT VOID AFTER THREE YEARS.

NOTE: INSTALL STAND PIPE ON SEPTIC TANK AND DRY WELL. STAND PIPES MUST BE 6 INCHES IN DIAMETER. CAST IRON, CONCRETE OR TERRA COTTA, OR PVC OR ABS ACCEPTED. IF TOP OF SEPTIC TANK IS DEEPER THAN 3 FEET MANHOLE TO GRADE REQUIRED.

BUDG. PERMIT SIGNED
AND RETURNED 4/28/83
SIGNED 4/28/83
SUN PUCH

*INSTALLER IS RESPONSIBLE FOR OBTAINING FINAL APPROVAL ON THIS PERMIT

*CALL 992-2330 FOR INSPECTION OF SEPTIC SYSTEMS.

EH - 2-1082

832714

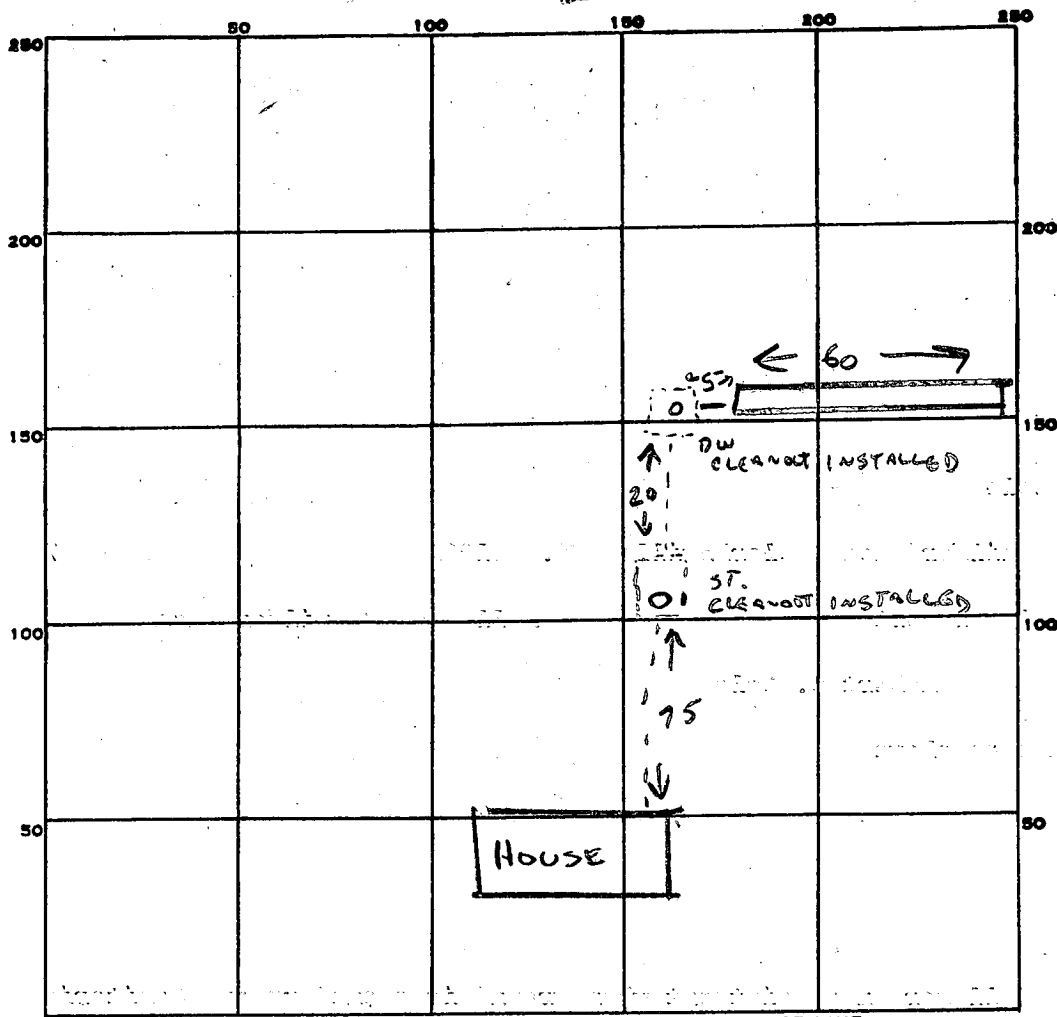

INDICATE NORTH. — NAME ADJOINING ROADWAY AS BASE LINE.

PERMIT CARD ☒

SEPTIC TANK, LEVEL EXISTING

CLEANOUTS ST ☒ DW ☒

DISTRIBUTION BOX, LEVEL N/A

TILE FIELD, DEPTH 10 1/2 FT. TRENCH WIDTH 2 FT.

GRAVEL DEPTH 7 FT. IN. TOTAL LENGTH 60 FT.

NUMBER OF TRENCHES 1 1/2 SIDEWALL TOTAL BOTTOM AREA 420 FT

DRYWELL SEEPAGE PITS, INSIDE DIAMETER EXISTING FT. DEPTH BELOW INLET FT.

ABSORBENT AREA UNKNOWN — EXISTING DRYWELL SQ. FT. + 420 FT ABS AREA IN TRENCH

REMARKS

CLEANOUTS REPAIRED; TRENCH ADDED. CW

DATE SYSTEM APPROVED 6-2-83

INSPECTOR C. Williams

6/2/83
n haw

PERMIT

SEWAGE DISPOSAL SYSTEM

MARYLAND STATE DEPARTMENT OF HEALTH

HOWARD COUNTY

BUREAU OF ENVIRONMENTAL HEALTH
992-2330

ELLICOTT CITY

DISTRICT 5th

DATE 5/3/83

Robert C. Cole

IS PERMITTED TO INSTALL _____ ALTER X

ADDRESS 6838 Guilford Road, Clarksville, Md. 21029 PHONE 854-3370

SUBDIVISION Cole property ROAD Hall Shop & Guilford Roads LOT _____

PROPERTY OWNER Robert C. Cole

ADDRESS same as above

IF GARBAGE GRINDER IS USED INCREASE SEPTIC TANK CAPACITY BY 50% AND ABSORPTION AREA BY 22%.

GARBAGE GRINDER? YES _____ NO _____

SEPTIC TANK CAPACITY _____ GALLONS NUMBER OF BEDROOMS _____

**REPAIR - Call for an appointment when ground is opened up and Sanitarian will
recommend the repair system.**

**CONDITION FOUND - DRY WELL FULL; HEAVY GROWTH VERY GREEN GRASS
INDICATES OVERFLOW - NEED NEW DRYWELL OR TRENCH SYSTEM;
SEPTIC TANK QUESTIONABLE - BELOW GRADE FLOWER POT
SERVES AS CLEANOUT. 5-7-83 CW Williams**

PLANS APPROVED BY Palmer F. Wine

DATE 5/3/83

COVER NO WORK UNTIL INSPECTED AND APPROVED.

NEITHER THE HOWARD COUNTY COUNCIL NOR THE HEALTH DEPARTMENT IS RESPONSIBLE FOR THE SUCCESSFUL OPERATION OF ANY SYSTEM.

NOTE: IF TRENCH IS USED CALL FOR INSPECTION BEFORE AND AFTER PLACING GRAVEL IN TRENCH.

NOTE: NO DRY WELL SHALL EXCEED 15 FOOT IN DIAMETER. NO ABSORPTION TRENCH TO EXCEED 100 FEET IN LENGTH.

NOTE: ALL PIPE FROM HOUSE TO SEPTIC TANK MUST BE CAST IRON OR SCHEDULE 40 PVC OR ABS.

PERMIT VOID AFTER THREE YEARS.

NOTE: INSTALL STAND PIPE ON SEPTIC TANK AND DRY WELL. STAND PIPES MUST BE 6 INCHES IN DIAMETER. CAST IRON, CONCRETE OR TERRA COTTA, OR
PVC OR ABS ACCEPTED. IF TOP OF SEPTIC TANK IS DEEPER THAN 3 FEET MANHOLE TO GRADE REQUIRED.

***INSTALLER IS RESPONSIBLE FOR OBTAINING FINAL APPROVAL ON THIS PERMIT**

***CALL 992-2330 FOR INSPECTION OF SEPTIC SYSTEMS.**

EH - 2-1082

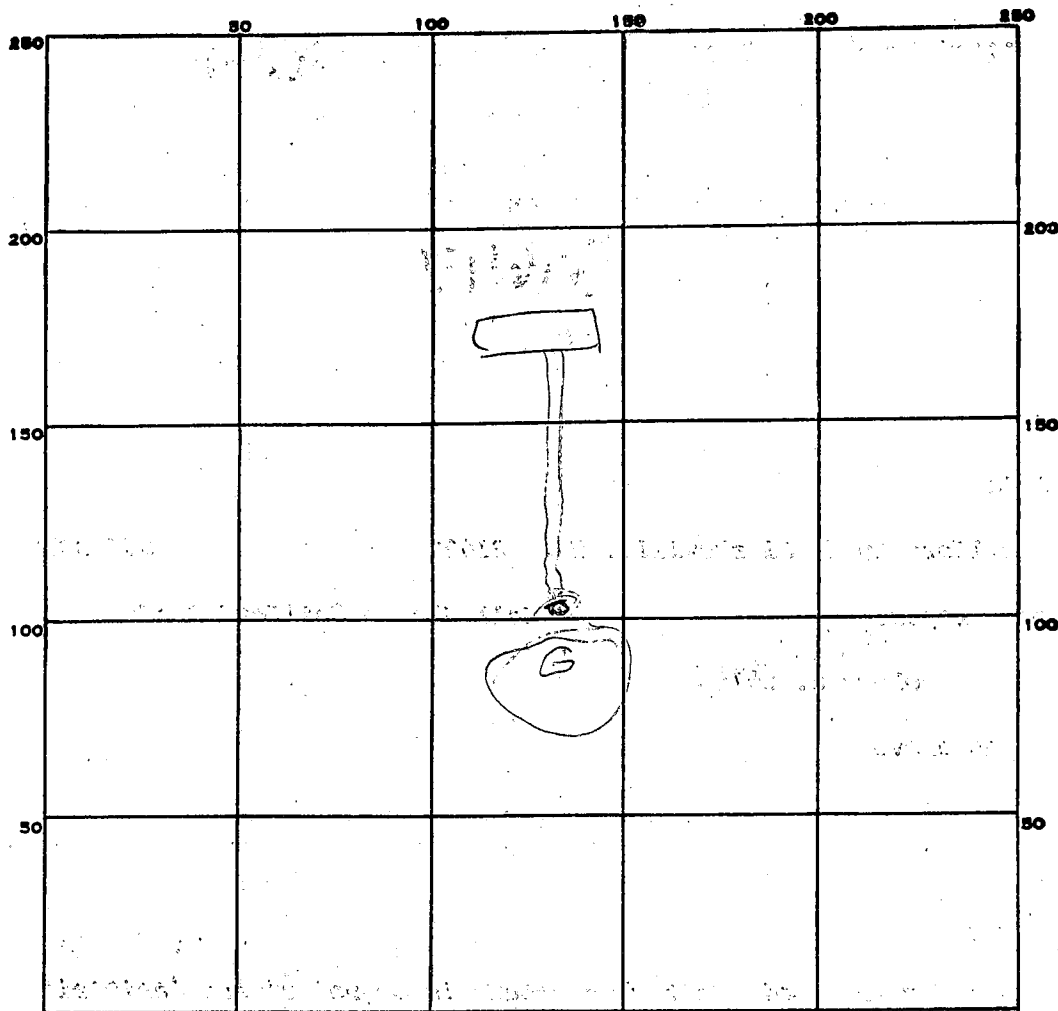

INDICATE NORTH. - NAME ADJOINING ROADWAY AS BASE LINE.

PERMIT CARD _____

SEPTIC TANK, LEVEL _____

CLEANOUTS _____

DISTRIBUTION BOX, LEVEL _____

TILE FIELD, DEPTH _____ FT. TRENCH WIDTH _____ FT.

GRAVEL DEPTH _____ IN. TOTAL LENGTH _____ FT.

NUMBER OF TRENCHES _____ TOTAL BOTTOM AREA _____

SEEPAGE PITS, INSIDE DIAMETER _____ FT. DEPTH BELOW INLET _____ FT.

ABSORBENT AREA _____ SQ. FT.

REMARKS _____

DATE SYSTEM APPROVED _____ INSPECTOR _____

HOWARD COUNTY HEALTH DEPARTMENT

JOYCE M. BOYD, M.D., M.P.H.
COUNTY HEALTH OFFICER



BUREAU OF ENVIRONMENTAL HEALTH
TIBER PLACE
8306B FORREST STREET
ELLCOTT CITY, MARYLAND 21043
TELEPHONE: 992-2330

May 11, 1983

Mr. Robert Cole
6838 Guilford Road
Clarksville, Maryland 21029

Dear Mr. Cole:

On May 9, 1983 perc tests were conducted on Lots 2, 3 and 4 located near Guilford and Hall Shop Roads. Prior to approval of these lots it will be necessary to bring the existing septic system on Lot 1 up to current standards.

A repair permit has already been issued for that lot and the following steps will be necessary to comply with current regulations:

1. Conduct sufficient perc tests to establish a 10,000 square feet septic reserve area as required by Maryland Health Regulations;
2. Replace the present failing dry well with a new disposal system to be detailed by our sanitarian after the above mentioned perc test; and
3. Water test the existing septic tank and house sewer line to determine if they are functioning properly, replace if necessary. (Part of this test is accomplished by running water from the house into the septic tank, so it will be necessary for you or your representative to be home to assist in this test.)

Please contact our office to schedule these tests. If you have any questions, please feel free to call me at 992-2330.

Yours truly,

Craig Williams, Sanitarian
Water and Sewerage Program

CW:hs

cc: Larry Dreyhoff, Riemer-Tracy Associates

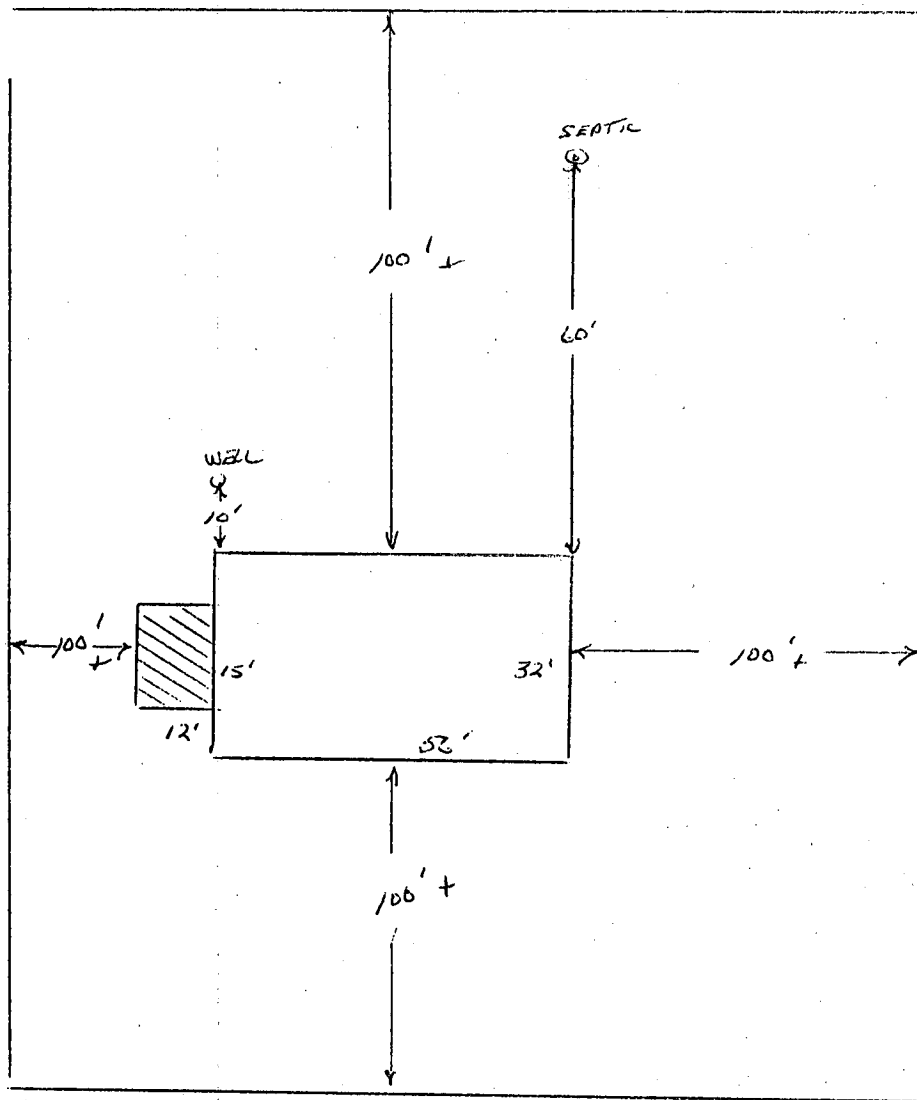

4/26/89

OK.

C.B.A.

Guilford Rd

Scale 1" = 30'
3523

MD STATE ROAD 32
(GUILFORD ROAD)
S 86°30'00" E 792.0

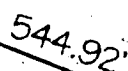

S 86°30'00" E

792.0

364.49

G1B2

One-Story
Brick Dwelling

-470

SEPTIC
COLE PROP
AS PER MR. COLE

☒ Metal/Block
Garage

~~MgC3~~

APPROVED
SEPTIC
AREA

LO
COLE
PLAT

G1B2

LOT 2
COLEVIEW
PLAT 5488

$$\text{MgB}_2$$

#14 / CnB2

APPLICATION

PERCOLATION TESTING

A 513845

P _____

HOWARD COUNTY HEALTH DEPARTMENT

BUREAU OF ENVIRONMENTAL HEALTH

3525-H ELLICOTT MILLS DRIVE/ELLICOTT CITY, MARYLAND 21043
TELEPHONE: 313-2840

DISTRICT _____

DATE _____

TO: THE COUNTY HEALTH OFFICER
ELLICOTT CITY, MARYLAND

I HEREBY APPLY FOR THE NECESSARY TEST PRIOR TO APPLICATION FOR PERMIT TO CONSTRUCT (OR RECONSTRUCT) A SEWAGE DISPOSAL SYSTEM.

PROPERTY OWNER Tom D'ASTO

ADDRESS 12230 Route 216 PHONE _____

AGENT OR PROSPECTIVE BUYER _____

ADDRESS _____ PHONE _____

PROPERTY LOCATION:

SUBDIVISION _____ LOT NO. Existing house

ROAD AND DESCRIPTION 6838 Guilford Road

TAX MAP 35 PARCEL # 68

SIZE OF LOT 60+ acres TYPE BLDG. SFD
(SINGLE FAMILY DWELLING OR COMMERCIAL)

THE SYSTEM INSTALLED UNDER THIS APPLICATION IS ACCEPTABLE ONLY UNTIL PUBLIC FACILITIES BECOME AVAILABLE. I FULLY UNDERSTAND THE FEE CONNECTED WITH THE FILING OF THIS PERC TEST APPLICATION IS NON-REFUNDABLE UNDER ANY CIRCUMSTANCES. I ALSO AGREE TO COMPLY WITH ALL M.O.S.H.A. REQUIREMENTS IN TESTING THIS LOT.

(SIGNATURE OF APPLICANT) _____

APPROVED BY _____ FOR _____ DATE _____

DISAPPROVED BY _____ FOR _____ DATE _____

HOLD PENDING FURTHER TESTS _____

REASONS FOR REJECTION OR HOLDING 6/6/00 PERC OK, HOLD FOR PLAT (RD)

PERCOLATION TEST PLAT/PRELIMINARY PLAT - TITLE OR I.D. # _____ DATE _____

SITE DEVELOPMENT PLAN/FINAL PLAT - TITLE OR I.D. # _____ DATE _____

THIS IS NOT A PERMIT

COUNTY #

SOIL PROFILE

0' ①
orange
brn
cl 1m
3
tan
gray
mice
sa 1m
5% frags
WH. QUARTZ
SAPPHIRE
VEIN 8 1/2 - 9 1/2
12 ROCKY @ 10-10 1/2
BETTER BELOW

TENANT
HOUSE
PERC ⑧

GARAGE

EX.
S.T.
NO. 4/0DRILLED
WELL
NO
TAGEX.
HOUSEEX.
S.T.
NO. 4/0

POND

SOIL PROFILE

INDICATE NORTH - NAME ADJOINING ROADWAY AS BASE LINE.

GUILFORD RD

DATE	TEST NO.	DEPTH	PRE-WET		TEST - 1" DROP		TIME
			START	STOP	START	STOP	
5/2/00	1 V	12	OK	see profile			

REMARKS

TYPE OF SOIL

TESTED BY

M. Rifkin

ALSO PRESENT

owner S.C. Backhoe

TRENCH DESIGN DATA: AVERAGE PERCOLATION TIME

TRENCH WIDTH

2

INLET DEPTH

3

MAXIMUM BOTTOM DEPTH

7

SQ. FT./BEDROOM

180