

4/8/98
10:00

PERMIT

SEWAGE DISPOSAL SYSTEM

DEPARTMENT OF HEALTH AND MENTAL HYGIENE

P 59929-A

A REPAIR

DISTRICT _____

HOWARD COUNTY HEALTH DEPARTMENT
BUREAU OF ENVIRONMENTAL HEALTH

DATE 4.8.98

~~XXXXXXXXXX~~ 410-313-2640

DATE SYSTEM APPROVED 4.8.98

INDEXED

INSPECTOR KM

Hatfield's Equipment Dedication Service, Inc. IS PERMITTED TO INSTALL _____ ALTER X

ADDRESS 13785 Burntwoods Road, Glenelg, Maryland 21737 PHONE 410-854-6172

SUBDIVISION _____ LOT _____ ROAD 11737 Bragdon Woods Court

PROPERTY OWNER Catalano

ADDRESS 11737 Bragdon Woods Court
Clarksville, Maryland 21029

SEPTIC TANK CAPACITY 1000 GALLONS

NUMBER OF BEDROOMS 3

125 SQUARE FEET PER BEDROOM

LINEAR FEET OF TRENCH REQUIRED 75

REPAIR - PURPOSE - Septic system has failed.

Call for inspection when ground is opened so sanitarian can recommend repair.

04/03/98

Existing tank and drywell to remain, septic tank pumped 4/8/98

Bottom at 8.0', inlet at 3.0', 5.0' of stone

two trenches to be installed and connected to existing distribution

PLANS APPROVED BY Kim Marts DATE 4.8.98

COVER NO WORK UNTIL INSPECTED AND APPROVED

NEITHER THE HOWARD COUNTY COUNCIL NOR THE HEALTH DEPARTMENT IS RESPONSIBLE FOR THE SUCCESSFUL OPERATION OF ANY SYSTEM

NOTE: CLEANOUT REQUIRED EVERY 70 FEET OF SEWER LINE AND/OR AT 90° SWEEPS IN LINES FROM HOUSE TO DRAIN FIELDS, 90° ELBOWS NOT ACCEPTABLE.

NOTE: ALL PARTS OF SEPTIC SYSTEMS (I.E. TANK, DISTRIBUTION BOX TRENCHES) TO BE 100 FEET FROM WELL (UNLESS OTHERWISE SPECIFICALLY AUTHORIZED)

NOTE: IF DEEP TRENCH(ES) ARE USED CALL FOR INSPECTION BEFORE AND AFTER PLACING GRAVEL IN TRENCH(ES)

NOTE: NO DRY WELL SHALL EXCEED 15 FOOT IN DIAMETER NO ABSORPTION TRENCH TO EXCEED 100 FEET IN LENGTH

NOTE: ALL PIPE FROM HOUSE TO SEPTIC TANK MUST BE CAST IRON OR SCHEDULE 35/40 PVC OR ABS

PERMIT VOID AFTER TWO YEARS

NOTE: INSTALL STAND PIPE ON SEPTIC TANK AND DRY WELL STAND PIPES MUST BE 6 INCHES IN DIAMETER CAST IRON, CONCRETE OR TERRA COTTA OR PVA OR ABS ACCEPTED. IF TOP OF SEPTIC TANK IS DEEPER THAN 3 FEET, MANHOLE TO GRADE REQUIRED.

NOTE: DISTRIBUTION BOXES MUST HAVE BAFFLES

*INSTALLER IS RESPONSIBLE FOR OBTAINING FINAL APPROVAL ON THIS PERMIT

CALL 461-9933 FOR INSPECTION OF SEPTIC SYSTEM.

P59929A

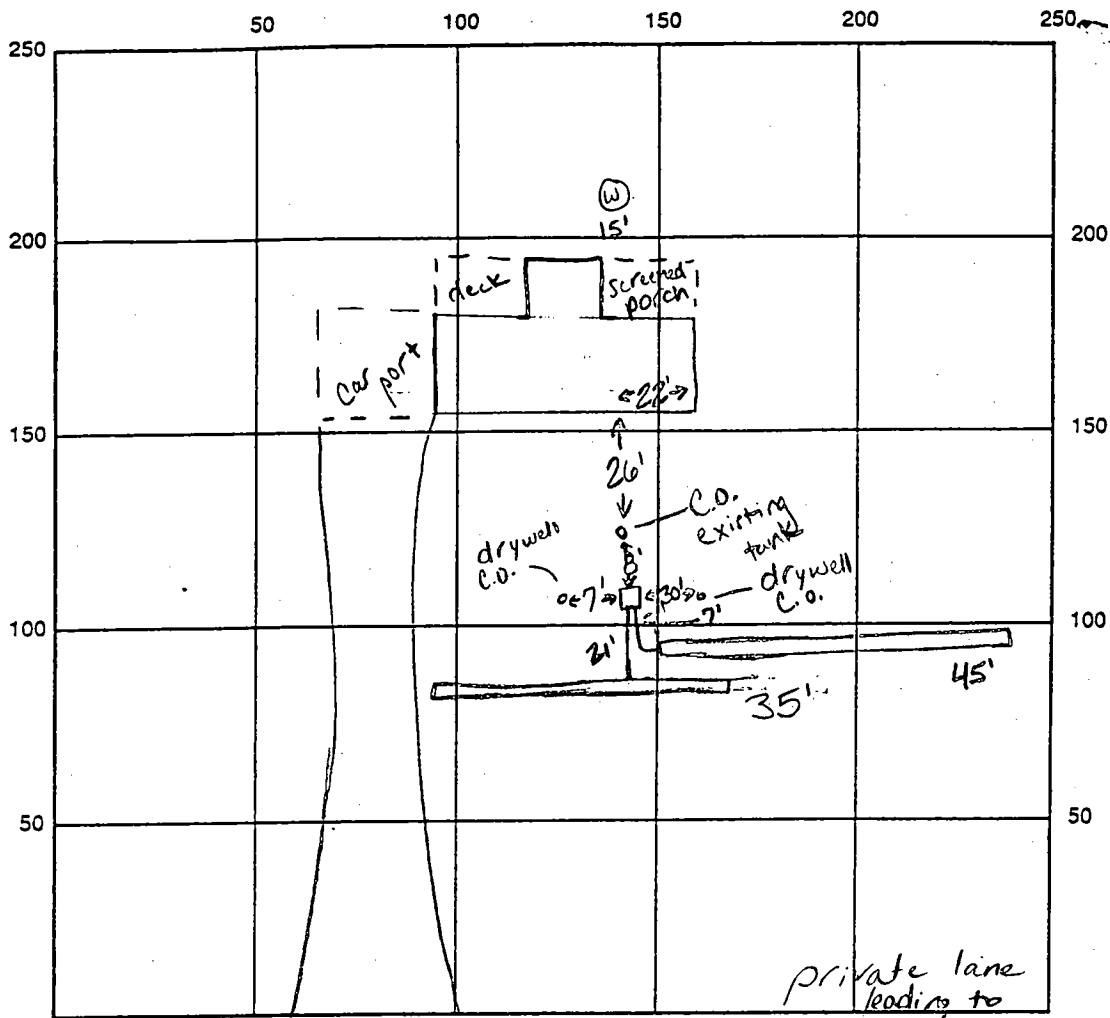

INDICATE NORTH - NAME ADJOINING ROADWAY AS BASE LINE Bragdon Woods Ct.

SEPTIC TANK LEVEL existing CLEANOUTS 1 on tank, 1 on each drywell
 DISTRIBUTION BOX LEVEL OK, buffer in
 DRAIN FIELD/TITLE DEPTH 8.0' FT. TRENCH WIDTH 2.0 FT. INLET DEPTH 3.0' FT.
 EFFECTIVE GRAVEL DEPTH 5.0' FT. TOTAL LENGTH $\frac{1 \times 35}{1 \times 45}$ FT. \rightarrow 75'
 NUMBER OF TRENCHES 2 ONE SIDEWALL/BOTTOM AREA 375 SQ. FT.
 DRYWALL INSIDE DIAMETER — FT. EFFECTIVE DEPTH BELOW INLET — FT.
 ABSORBENT AREA — SQ. FT.

REMARKS: 4.8.98 (pm) initial trench looks good, (see front for installation requirements)
OK to continue (KM)
4.8.98 (pm) OK to continue and cover all work (KM)

DATE SYSTEM APPROVED 4.8.98 INSPECTOR Kim Maisto

PHONE CALL

FOR Man DATE 3/9/93 TIME 3:00 P.M.
 M Mrs. Catalano
 OF _____ TELEPHONED _____
 PHONE 301 + 596 + 9689 RETURNED YOUR CALL _____
 EXT# 2nd left end left white box PLEASE CALL _____
3rd left WILL CALL AGAIN _____
estimate on new drainfields CAME TO SEE YOU _____
11737 Braggdon Road WANTS TO SEE YOU _____
Clarkeville Box left at fork
mile on left white brick split for ever SIGNED SC 1154-20

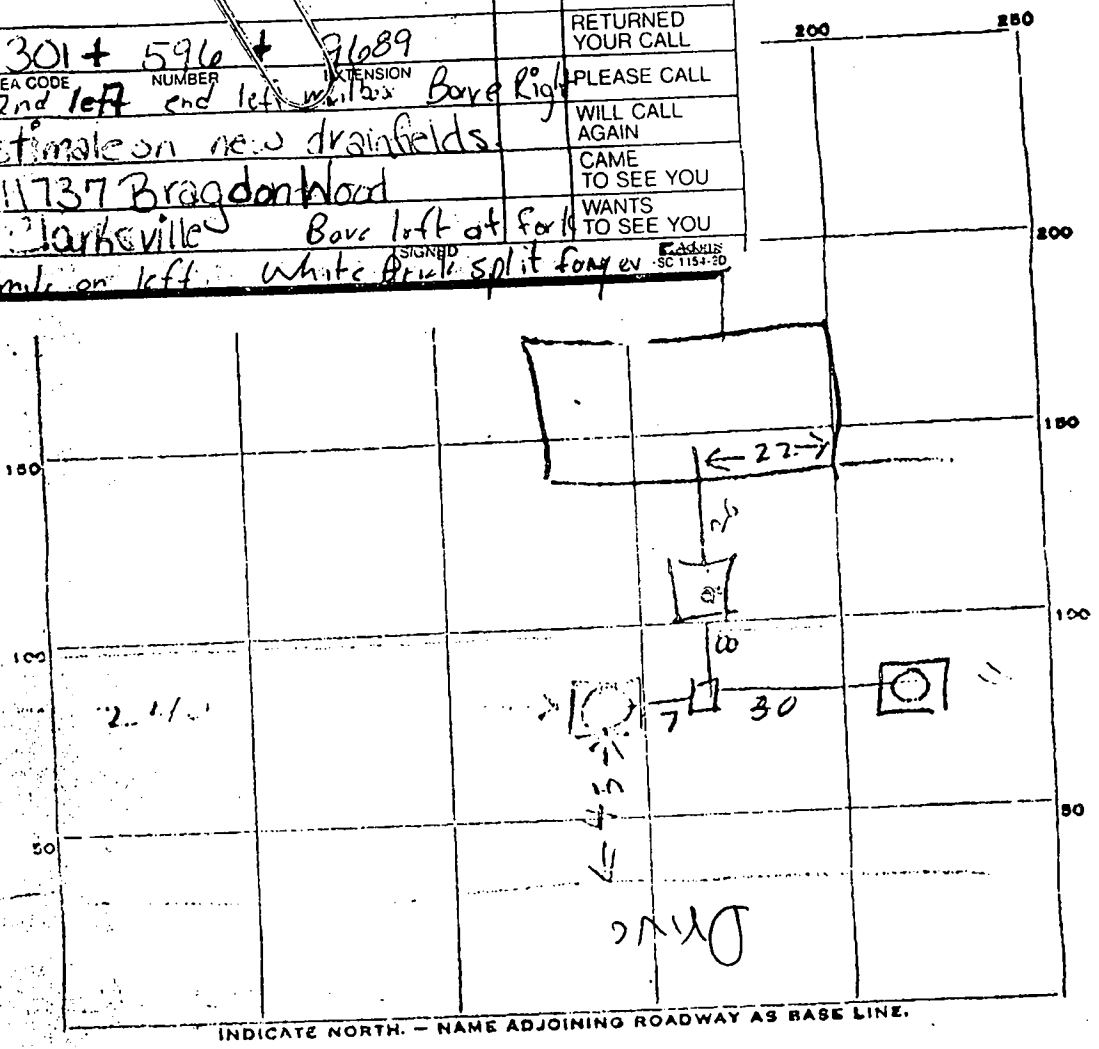

INDICATE NORTH. - NAME ADJOINING ROADWAY AS BASE LINE.

PERMIT CARD _____

SEPTIC TANK, LEVEL 0/1 CLEANOUTS 0/1

DISTRIBUTION BOX, LEVEL 0/1

TILE FIELD, DEPTH _____ FT. TRENCH WIDTH _____ FT.

GRAVEL DEPTH _____ IN. TOTAL LENGTH _____ FT.

NUMBER OF TRENCHES _____ TOTAL BOTTOM AREA _____

SEEPAGE PITS, INSIDE DIAMETER _____ FT. DEPTH BELOW INLET _____ FT.

ABSORBENT AREA 760 SQ. FT. counting stone

REMARKS 310' x 67' - 13' x 10' - 17' x 10' - 17' x 10' - 17' x 10'
20' x 25' - below - 10' x 10' - 3' x 10' - 3' x 10'
no gravel - no counting stone - 40' x 40' - 4' x 10' - 4' x 10'
12' x 10' - 12' x 10' - 12' x 10' - 12' x 10'
at stone - 10' x 10' - 250' x 10' - 250' x 10'

10/15/61

10/15/61

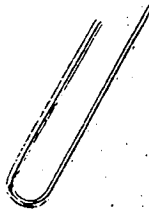

2 loads out of Drywell
1356 branch
Install silt fence

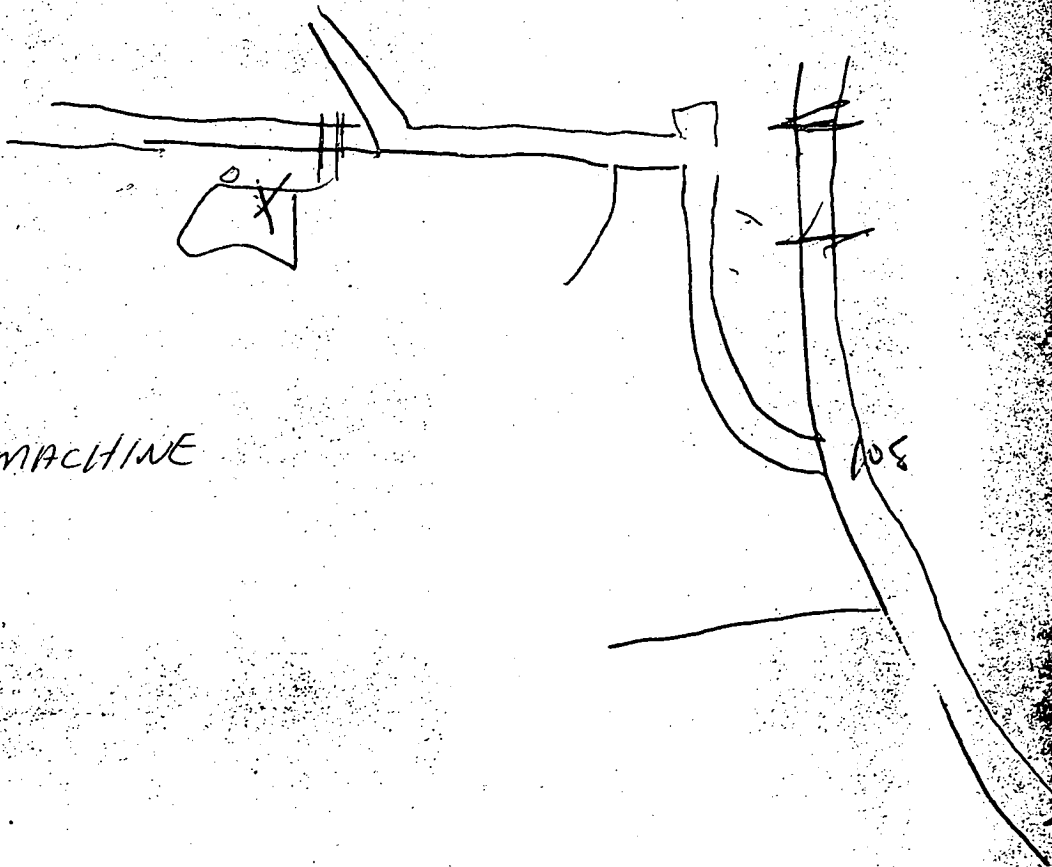

DUMP
TRUCK TRACK MACHINE