

# PERMIT

SEWAGE DISPOSAL SYSTEM

DEPARTMENT OF HEALTH AND MENTAL HYGIENE

05-351685

P. 5/10/67-8

A REPAIR

DISTRICT \_\_\_\_\_

DATE \_\_\_\_\_

DATE SYSTEM APPROVED \_\_\_\_\_

INSPECTOR \_\_\_\_\_

HOWARD COUNTY HEALTH DEPARTMENT

BUREAU OF ENVIRONMENTAL HEALTH

~~XXXXXX~~ 410-313-2640

INDEXED

Jenkins Brothers

IS PERMITTED TO INSTALL \_\_\_\_\_ ALTER

ADDRESS 7670 Smith's Private Road, Sykesville, Maryland 21784 PHONE 410-461-9282

SUBDIVISION \_\_\_\_\_ LOT Tax Map: 29 ROAD 5405 Trotter Road  
Parcel: 51  
Grid: 20

PROPERTY OWNER James Grimes  
ADDRESS 5405 Trotter Road  
Clarksville, Maryland 21029

SEPTIC TANK CAPACITY \_\_\_\_\_ GALLONS

NUMBER OF BEDROOMS \_\_\_\_\_

\_\_\_\_\_ SQUARE FEET PER BEDROOM

LINEAR FEET OF TRENCH REQUIRED \_\_\_\_\_

REPAIR - PURPOSE - SEPTIC SYSTEM FAILING.

Call for inspection when ground is opened so sanitarian can recommend repair. 05/03/99  
MER

PLANS APPROVED BY \_\_\_\_\_ DATE \_\_\_\_\_

COVER NO WORK UNTIL INSPECTED AND APPROVED

NEITHER THE HOWARD COUNTY COUNCIL NOR THE HEALTH DEPARTMENT IS RESPONSIBLE FOR THE SUCCESSFUL OPERATION OF ANY SYSTEM

NOTE: CLEANOUT REQUIRED EVERY 70 FEET OF SEWER LINE AND/OR AT 90° SWEEPS IN LINES FROM HOUSE TO DRAIN FIELDS. 90° ELBOWS NOT ACCEPTABLE.

NOTE: ALL PARTS OF SEPTIC SYSTEMS (I.E. TANK, DISTRIBUTION BOX TRENCHES) TO BE 100 FEET FROM WELL (UNLESS OTHERWISE SPECIFICALLY AUTHORIZED)

NOTE: IF DEEP TRENCH(ES) ARE USED CALL FOR INSPECTION BEFORE AND AFTER PLACING GRAVEL IN TRENCH(ES)

NOTE: NO DRY WELL SHALL EXCEED 15 FOOT IN DIAMETER NO ABSORPTION TRENCH TO EXCEED 100 FEET IN LENGTH

NOTE: ALL PIPE FROM HOUSE TO SEPTIC TANK MUST BE CAST IRON OR SCHEDULE 35/40 PVC OR ABS

PERMIT VOID AFTER TWO YEARS

NOTE: INSTALL STAND PIPE ON SEPTIC TANK AND DRY WELL STAND PIPES MUST BE 6 INCHES IN DIAMETER CAST IRON, CONCRETE OR TERRA COTTA OR PVA OR ABS ACCEPTED. IF TOP OF SEPTIC TANK IS DEEPER THAN 3 FEET, MANHOLE TO GRADE REQUIRED.

NOTE: DISTRIBUTION BOXES MUST HAVE BAFFLES

\*INSTALLER IS RESPONSIBLE FOR OBTAINING FINAL APPROVAL ON THIS PERMIT

\*CALL 461-9933 FOR INSPECTION OF SEPTIC SYSTEM.

5/10/67-8

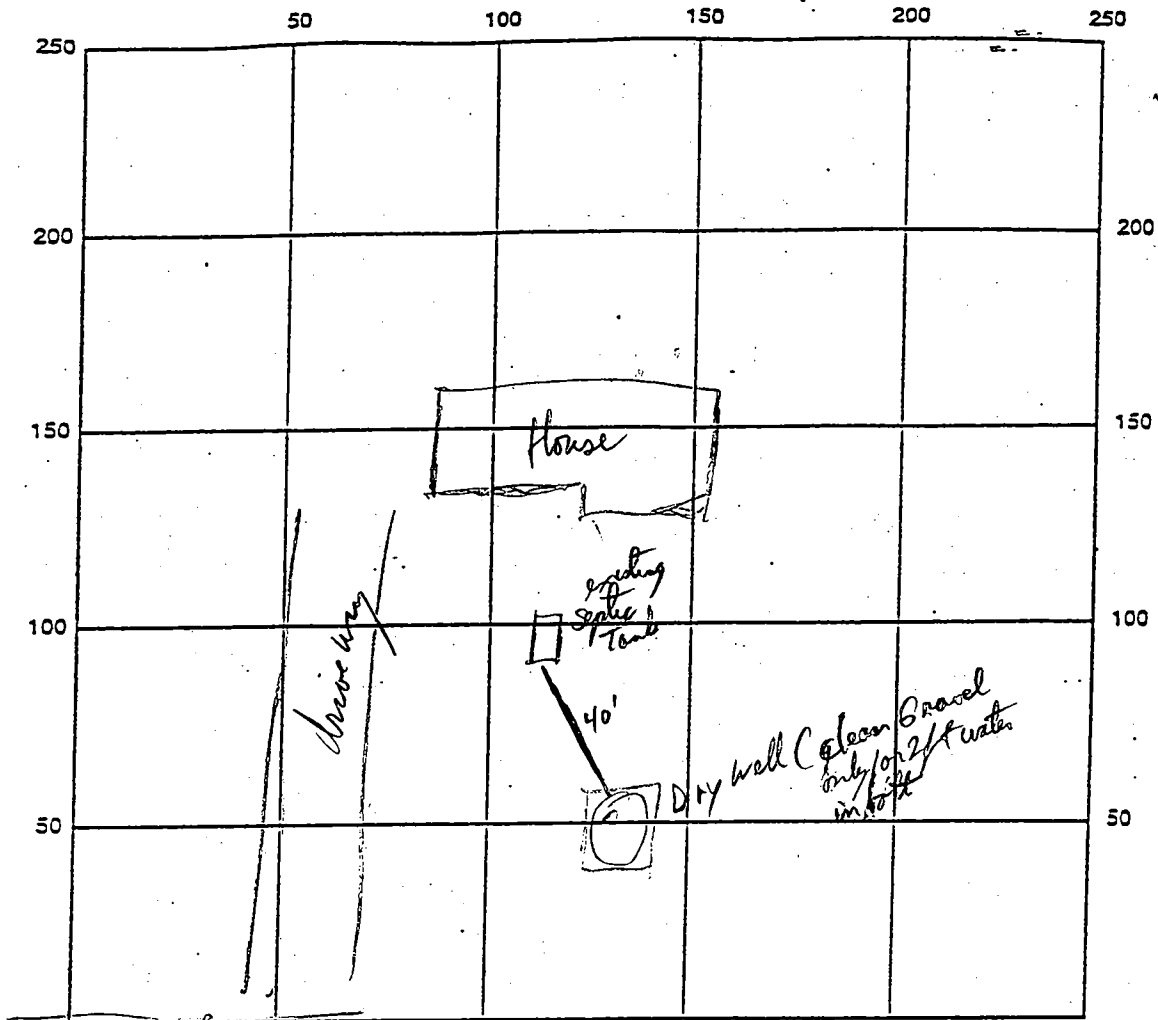

SEPTIC TANK LEVEL existing CLEANOUTS \_\_\_\_\_

DISTRIBUTION BOX LEVEL \_\_\_\_\_

DRAIN FIELD/TITLE DEPTH \_\_\_\_\_ FT. TRENCH WIDTH \_\_\_\_\_ FT. INLET DEPTH \_\_\_\_\_ FT.

EFFECTIVE GRAVEL DEPTH \_\_\_\_\_ FT. TOTAL LENGTH \_\_\_\_\_ FT.

NUMBER OF TRENCHES \_\_\_\_\_ ONE SIDEWALL/BOTTOM AREA \_\_\_\_\_ SQ. FT.

DRYWELL INSIDE DIAMETER existing FT. EFFECTIVE DEPTH BELOW INLET \_\_\_\_\_ FT.

ABSORBENT AREA \_\_\_\_\_ SQ. FT.

REMARKS: Clogged cast iron pipe, water never got to dry well (still very functional condition)  
Replaced old pipe with new solid Schedule 40 PVC. No need to dump S.T. or Dry well  
 JJP 5/5/99

DATE SYSTEM APPROVED 5/5/99 INSPECTOR JJP

30-P.196

MOORE-DR.  
MAP 30  
P.300

MAP 30-  
P.340

14 15  
BROOK  
P.208

MAP 30-  
P.272

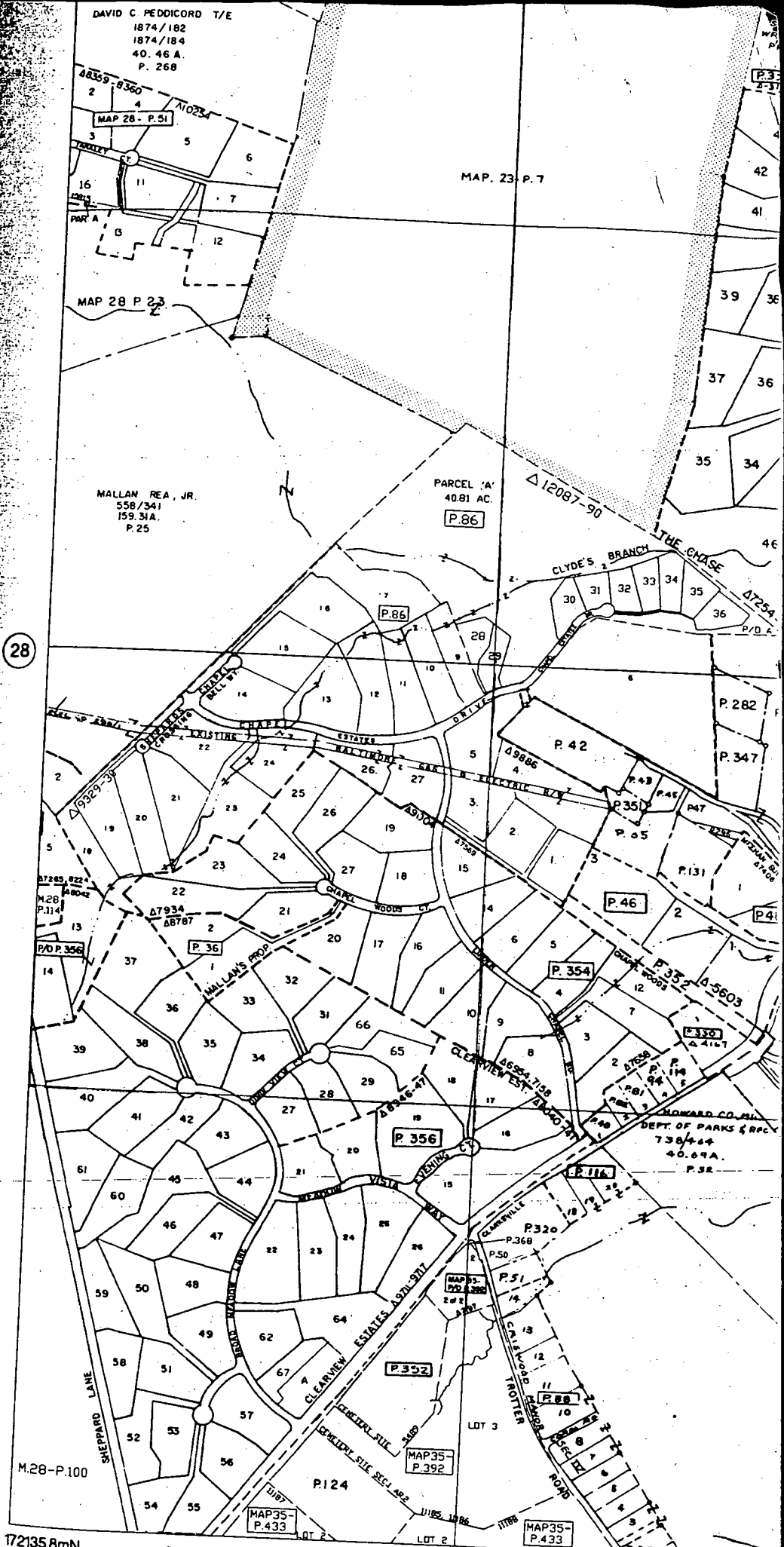

172135.8mN  
4055124mE

COPYRIGHT - 1992 BY THE STATE OF MARYLAND ALL RIGHTS RESERVED.

THESE MAPS ARE PROTECTED BY COPYRIGHT. THEY MAY OR REPRODUCED IN ANY FORM INCLUDING ELECTRONIC DIGITIZING SCANNING VECTORIZING OR ANY OTHER MEANS.

THX MRP - 20  
Guel - 20  
Paved 1/5