

# PERMIT

SEWAGE DISPOSAL SYSTEM

DEPARTMENT OF HEALTH AND MENTAL HYGIENE

P \_\_\_\_\_

A 513699 B

DISTRICT \_\_\_\_\_

DATE \_\_\_\_\_

DATE SYSTEM APPROVED \_\_\_\_\_

INSPECTOR \_\_\_\_\_

HOWARD COUNTY HEALTH DEPARTMENT  
BUREAU OF ENVIRONMENTAL HEALTH  
461-9933

INDEXED

\_\_\_\_\_ IS PERMITTED TO INSTALL \_\_\_\_\_ ALTER \_\_\_\_\_

ADDRESS \_\_\_\_\_ PHONE \_\_\_\_\_

SUBDIVISION \_\_\_\_\_ LOT \_\_\_\_\_ ROAD 6775 Wash. Blvd

PROPERTY OWNER Hall's Hotel

ADDRESS \_\_\_\_\_

PLANS APPROVED BY \_\_\_\_\_ DATE \_\_\_\_\_

COVER NO WORK UNTIL INSPECTED AND APPROVED

NEITHER THE HOWARD COUNTY COUNCIL NOR THE HEALTH DEPARTMENT IS RESPONSIBLE FOR THE SUCCESSFUL OPERATION OF ANY SYSTEM

NOTE: CLEANOUT REQUIRED EVERY 70 FEET OF SEWER LINE AND/OR AT 90° SWEEPS IN LINES FROM HOUSE TO DRAIN FIELDS. 90° ELBOWS NOT ACCEPTABLE.

NOTE: ALL PARTS OF SEPTIC SYSTEMS (I.E. TANK, DISTRIBUTION BOX TRENCHES) TO BE 100 FEET FROM WELL (UNLESS OTHERWISE SPECIFICALLY AUTHORIZED)

NOTE: IF DEEP TRENCH(ES) ARE USED CALL FOR INSPECTION BEFORE AND AFTER PLACING GRAVEL IN TRENCH(ES)

NOTE: NO DRY WELL SHALL EXCEED 15 FOOT IN DIAMETER NO ABSORPTION TRENCH TO EXCEED 100 FEET IN LENGTH

NOTE: ALL PIPE FROM HOUSE TO SEPTIC TANK MUST BE CAST IRON OR SCHEDULE 35/40 PVC OR ABS

PERMIT VOID AFTER TWO YEARS

NOTE: INSTALL STAND PIPE ON SEPTIC TANK AND DRY WELL STAND PIPES MUST BE 6 INCHES IN DIAMETER CAST IRON. CONCRETE OR TERRA COTTA OR PVA OR ABS ACCEPTED. IF TOP OF SEPTIC TANK IS DEEPER THAN 3 FEET. MANHOLE TO GRADE REQUIRED.

NOTE: DISTRIBUTION BOXES MUST HAVE BAFFLES

**\*INSTALLER IS RESPONSIBLE FOR OBTAINING FINAL APPROVAL ON THIS PERMIT**

513699-B



SITE INSPECTION SHEET

MANAGER: <sup>(?)</sup>  
OWNER: Jim Roberts (410) 796-2211

DATE REQUESTED: 5/20/07

ADDRESS: Hall's Motel  
6775 Wash. Blvd.

DRILLER: \_\_\_\_\_  
WELL TAG # \_\_\_\_\_  
COUNTY # \_\_\_\_\_

PROPOSAL: complaint investigation

LOCATION DIAGRAM

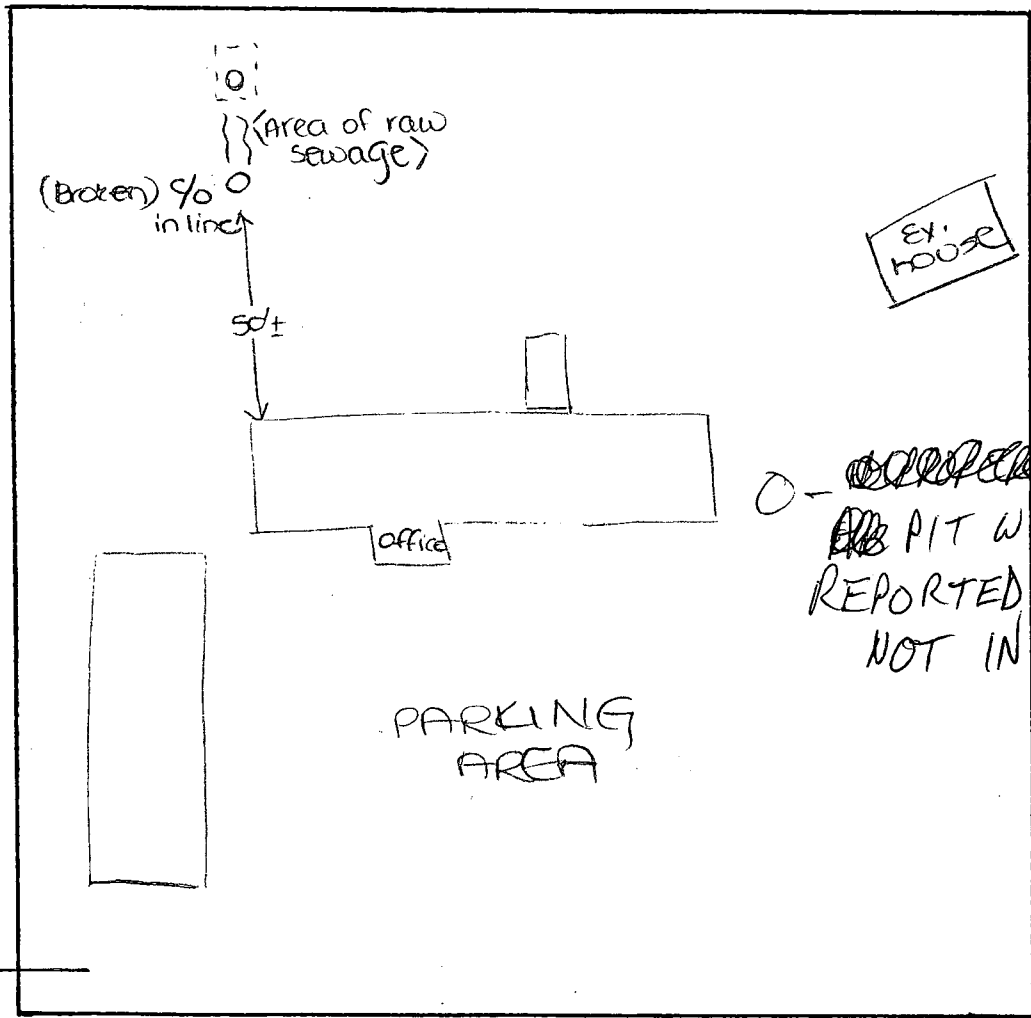

TO ROUTE 1 ←

COMMENTS: \_\_\_\_\_  
\_\_\_\_\_  
\_\_\_\_\_

DATE: \_\_\_\_\_ INSPECTOR: \_\_\_\_\_

REGION \_\_\_\_\_

AREA \_\_\_\_\_ RATING \_\_\_\_\_

ACKNOWLEDGMENT AND CONTROLS	DATE

Howard County Department of Health  
BUREAU OF ENVIRONMENTAL HEALTH

DISPOSITION	DATE

RECORD OF INVESTIGATION

6775

LOCATION 6575 Washington Boulevard (Route 1) ZIP \_\_\_\_\_

OWNER  OCCUPANT  Hall's Hotel ADDRESS \_\_\_\_\_ PHONE \_\_\_\_\_

COMPLAINANT anonymous ADDRESS \_\_\_\_\_ PHONE \_\_\_\_\_

REASON FOR INVESTIGATION Behind the Hall's Hotel, Septic Tank is uncapped, two pipes in leaving the hotel, disconnected to the septic tank, is full of used syringes.

CODES \_\_\_\_\_

RECEIVED BY D. Jane Reeves DATE 05/20/97 ASSIGNED TO \_\_\_\_\_ DATE \_\_\_\_\_

DATE OF INVESTIGATION \_\_\_\_\_ TIME \_\_\_\_\_ WEATHER \_\_\_\_\_

REPORT \_\_\_\_\_  
\_\_\_\_\_  
\_\_\_\_\_  
\_\_\_\_\_  
\_\_\_\_\_  
\_\_\_\_\_  
\_\_\_\_\_  
\_\_\_\_\_

2/11/97 SIGNS OF RECENT EXCAVATION & REPAIRS @ PREVIOUS DISCHARGE LOCATION; NO DISCHARGE OBS'D. OLD DRILLED WELL IN PIT (DISCONNECTED PER CLERK) ALSO OBS'D TO RIGHT OF OFFICE (MR) FILE CLOSED (MR)

DATE SUBMITTED \_\_\_\_\_ SANITARIAN \_\_\_\_\_

REGION \_\_\_\_\_

AREA \_\_\_\_\_ RATING \_\_\_\_\_

ACKNOWLEDGMENT AND CONTROLS	DATE

Howard County Department of Health  
BUREAU OF ENVIRONMENTAL HEALTH

RECORD OF INVESTIGATION

DISPOSITION	DATE

6775

LOCATION 6575 Washington Boulevard (Route 1) ZIP \_\_\_\_\_

OWNER  OCCUPANT  Hall's Hotel ADDRESS \_\_\_\_\_ PHONE \_\_\_\_\_

COMPLAINANT anonymous ADDRESS \_\_\_\_\_ PHONE \_\_\_\_\_

REASON FOR INVESTIGATION Behind the Hall's Hotel, Septic Tank is uncapped, two pipes in leaving the hotel, disconnected to the septic tank, is full of used syringes.

CODES \_\_\_\_\_

RECEIVED BY D. Jane Reeves DATE 05/20/97 ASSIGNED TO \_\_\_\_\_ DATE \_\_\_\_\_

DATE OF INVESTIGATION \_\_\_\_\_ TIME \_\_\_\_\_ WEATHER \_\_\_\_\_

REPORT \_\_\_\_\_

2/11/97 SIGNS OF RECENT EXCAVATION & REPAIRS @ PREVIOUS DISCHARGE LOCATION; NO DISCHARGE OBS'D. OLD DRILLED WELL IN PIT (DISCONNECTED PER CLERK) ALSO OBS'D TO RIGHT OF OFFICE (MR) FILE CLOSED (MR)

DATE SUBMITTED \_\_\_\_\_ SANITARIAN \_\_\_\_\_