

1/4/61 Approved R H

# PERMIT

P 04676  
514195-D  
A 04280

SEWAGE DISPOSAL SYSTEM

MARYLAND STATE DEPARTMENT OF HEALTH

**INDEXED**

HOWARD COUNTY

ELLICOTT CITY

DISTRICT 5

DATE 12/26/61

Long & Foster  
Sharon Keeny 854-0924  
730-3456

**INDEXED**

R. D. Shilling

IS PERMITTED TO INSTALL  ALTER

ADDRESS \_\_\_\_\_ PHONE \_\_\_\_\_

A SEWAGE DISPOSAL SYSTEM LOCATED AT the nearest intersecting road in Old Rt. 29, ab out

1 mile from Old 29 on the left on Trotter Rd. joins the Hobbs Farm.

SUBDIVISION now Trotter Ridge Ct ROAD 6045 Trotter Rd LOT \_\_\_\_\_

PROPERTY OWNER Ella & Ira H. Beall Stupp 531-3627

ADDRESS Trotter Road, Clarksville 997-8075

**SPECIFICATIONS**

DRAIN FIELD \_\_\_\_\_ DEPTH \_\_\_\_\_ FEET, BOTTOM AREA \_\_\_\_\_ SQ. FT.

SEEPAGE PITS \_\_\_\_\_ ABSORBENT SIDE-WALL AREA \_\_\_\_\_ SQ. FT.

SEPTIC TANK CAPACITY 750 500 GALLONS

FOR GARBAGE GRINDER, INCREASE DISPOSAL AREA 22% & TANK CAPACITY 50%.

OTHER one drywell 11 ft. in diameter/ by 10 ft. deep below the inlet located

35 ft. directly south of the right front corner of building. Right front

corner determined when facing lot from Trotter Rd. Inlet to be placed 4 ft.

from below original ground.

PLANS APPROVED BY James E. Hermigan /dma DATE 10/17/61

FILL SEPTIC TANK AND DISTRIBUTION BOX WITH WATER BEFORE CALLING FOR AN INSPECTION. COVER NO WORK UNTIL INSPECTED AND APPROVED.

NEITHER THE HOWARD COUNTY COMMISSIONERS NOR THE HEALTH DEPARTMENT IS RESPONSIBLE FOR THE SUCCESSFUL OPERATION OF ANY SYSTEM.

SPOKE TO MR. STUPP  
S.T. TO BE ABANDONED BY END OF YR  
ME 9/24/92  
A 514195-D  
~~04280~~

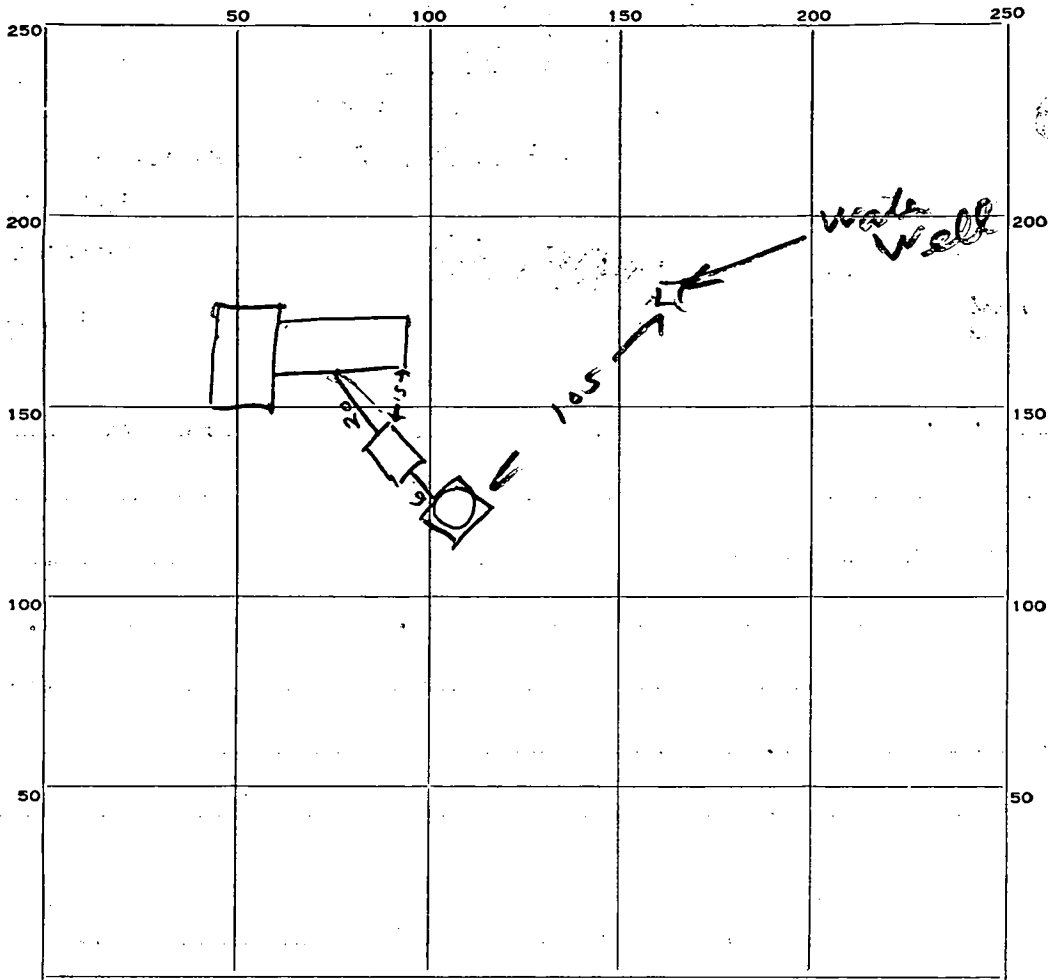

INDICATE NORTH. — NAME ADJOINING ROADWAY AS BASE LINE.

PERMIT CARD yes

SEPTIC TANK, LEVEL OK 500 gal CLEANOUTS OK  
Top is 3 ft below grade

DISTRIBUTION BOX, LEVEL \_\_\_\_\_

TILE FIELD, DEPTH \_\_\_\_\_ FT. TRENCH WIDTH \_\_\_\_\_ FT.

GRAVEL DEPTH \_\_\_\_\_ IN. TOTAL LENGTH \_\_\_\_\_ FT.

NUMBER OF TRENCHES \_\_\_\_\_ TOTAL BOTTOM AREA \_\_\_\_\_

SEEPAGE PITS, INSIDE DIAMETER 10 FT. DEPTH BELOW INLET 10 FT.

ABSORBENT AREA 310 SQ. FT.

31  
10

REMARKS Inlet 3 ft below grade  
Dry well has 1 ft to 3 ft stone around outside

DATE SYSTEM APPROVED 4 Jan 62 INSPECTOR Raymond Hodges

# APPLICATION

A 04280

SEWAGE DISPOSAL TESTING

P \_\_\_\_\_

MARYLAND STATE DEPARTMENT OF HEALTH

HOWARD COUNTY

ELLICOTT CITY

*one dry well 11 ft in dia. by 10 ft deep below the inlet located 35 ft directly south of the right front corner of building. Right front corner determined when facing lot from Trotter road. Inlet to be placed 4 FT below original ground.*

*750 gal. septic tank*

DISTRICT \_\_\_\_\_

DATE 9-21-61

TO: THE COUNTY HEALTH OFFICER  
ELLICOTT CITY, MARYLAND

I, HEREBY, APPLY FOR THE NECESSARY TESTS IN ORDER TO CONSTRUCT (OR RECONSTRUCT) A SEWAGE DISPOSAL SYSTEM.

PROPERTY OWNER Ella Irl H. Beall

ADDRESS Trotter Road Clarksville PHONE \_\_\_\_\_

PROPERTY LOCATION:

SUBDIVISION \_\_\_\_\_ LOT NO. \_\_\_\_\_

ROAD AND DESCRIPTION The nearest intersecting road is Rt. Old Rt. 29 about 1 mile from Old 29 on the left on Trotter Road joins the Hobbs Farms

OCCUPANT \_\_\_\_\_ PHONE \_\_\_\_\_

PERSON TO CONSTRUCT SYSTEM \_\_\_\_\_

ADDRESS \_\_\_\_\_ PHONE \_\_\_\_\_

SIZE OF LOT 15 acre TYPE BLDG. 2 NUMBER OF BEDROOMS \_\_\_\_\_

IF NOT SINGLE RESIDENCE DESCRIBE \_\_\_\_\_

SIGNATURE OF APPLICANT *John G. Arnold*

APPROVED BY *J. Hennigan* FOR Dry Well DATE 10-17-61

REJECTED BY \_\_\_\_\_ FOR \_\_\_\_\_ DATE \_\_\_\_\_

HOLD. PENDING FURTHER TESTS 9-26-61 DATE \_\_\_\_\_

REASONS FOR REJECTION OR HOLDING 9-26-61 5 shallow holes drilled in sec. Trying for dry well

# THIS IS NOT A PERMIT

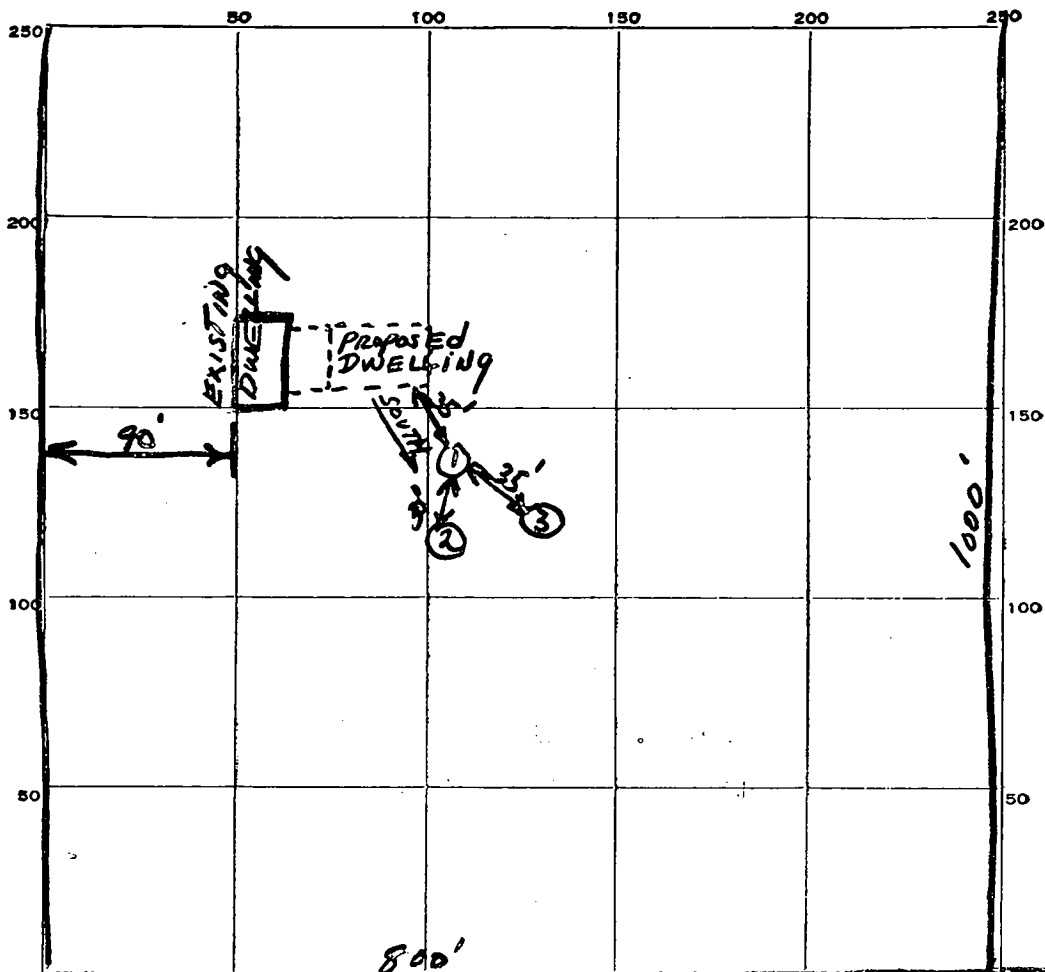

INDICATE NORTH. - NAME ADJOINING ROADWAY AS BASE LINE.

TROTTER ROAD

DATE	TEST NO.	DEPTH	PRE-WET		TEST - 1" DROP		TIME
			START	STOP	START	STOP	
9-25-61	1	3 FT	1:10	1:42	1:42	2:26	overtime 44 Min.
	2		1:12	2:23	overtime		
	3		1:56	Slow.			
10-17-61	4	10 FT	9:42	9:46	9:45	9:54	97 Min.

10-17-61  
John T. Arnold

SOIL AUGER FINDING  
TESTED BY J.T.A.

REMARKS: Hole 4, same location as hole 1 good ground starts at 4 ft down.

ALSO PRESENT: John Arnold

LOT NO.

PROPOSED BATHS - TO PRESENT - 750 GAL - TANK

FIELD-DRAIN  
180'

PRESENT 750 GAL SEPTIC-TANK

PRESENT-WELL

90'

PRESENT BLOCK GARAGE  
22'  
44'

PROPOSED DWELLING

110'

59'

31'-4"

135'

PROPOSED - 500 GAL. SEPTIC-TANK  
FOR TOILET AND TUBS IN BASEMENT

ELLA - IRL - H BEALL  
15 ACRES

BUILDER  
JOHN AROLD

1623 SULPHUR-SPRING-ROAD

800° TEL. C. 1-2-6026

TROTTER

ROAD

1000'

HOBBS FARM

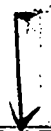

REGION \_\_\_\_\_

AREA \_\_\_\_\_ RATING \_\_\_\_\_

ACKNOWLEDGMENT AND CONTROLS	DATE

Howard County Department of Health  
BUREAU OF ENVIRONMENTAL HEALTH

DISPOSITION	DATE

RECORD OF INVESTIGATION

LOCATION 6045 Trotter Rd ZIP \_\_\_\_\_  
 OWNER  STUP - owner  
 OCCUPANT  Beth Schaffer - occupant ADDRESS same PHONE 997-8075  
 COMPLAINT Ed Zepp ADDRESS \_\_\_\_\_ PHONE 531-1139  
 \_\_\_\_\_ ADDRESS \_\_\_\_\_ PHONE 531-6712

REASON FOR INVESTIGATION Entire septic system overflowing

Mr Zepp said the septic tank could cave at any time; owner cancelled repair after plumber's CODES \_\_\_\_\_

RECEIVED BY Amy McMillen DATE 4-10-95 ASSIGNED TO M. Ritkin DATE 4/10/95

DATE OF INVESTIGATION 4/10/95 TIME 4:30 WEATHER cool, cloudy

REPORT report of serious situation (hoping for sewer); per Jean Reed sewer is closest at Leaves of Grass Ct/Red Clover La; other line may be serving prop. to North but no right-of-way est'd (HR & D prop) => NO SEWER AVAILABILITY MR

4/10/95 ~~PROPR~~ PROPERTY IS ~~OFFICE~~; ~~PER~~ OWNER, TOILET HAS BEEN RUNNING FOR MONTHS => SATURATED DRAINFIELD; SEWER CONN BEING ENGINEERED ~~THRU~~ THRU REAR OF PROP, EASEMENT THRU MID. PATUX. ENV. AREA OWNED BY Ho Co. Rec & Parks); <sup>HAD</sup> MEETING ~~W/~~ w/ SHUCK ECKER & JIM IRVIN TO FACILITATE SEWER CONN.; 3 OCCUPANTS, ~~W/~~ ALL OF WHOM WORK HERE ALSO, MR

DATE SUBMITTED \_\_\_\_\_ SANITARIAN \_\_\_\_\_

SITE INSPECTION SHEET

OWNER: Stupp

DATE REQUESTED: \_\_\_\_\_

PHONE #: \_\_\_\_\_

CONTRACTOR: \_\_\_\_\_

ADDRESS: 6045 Trotter Rd

WELL TAG #: \_\_\_\_\_

COUNTY #: \_\_\_\_\_

PROPOSAL: see attached complaint sheet

DRAINFIELDS?

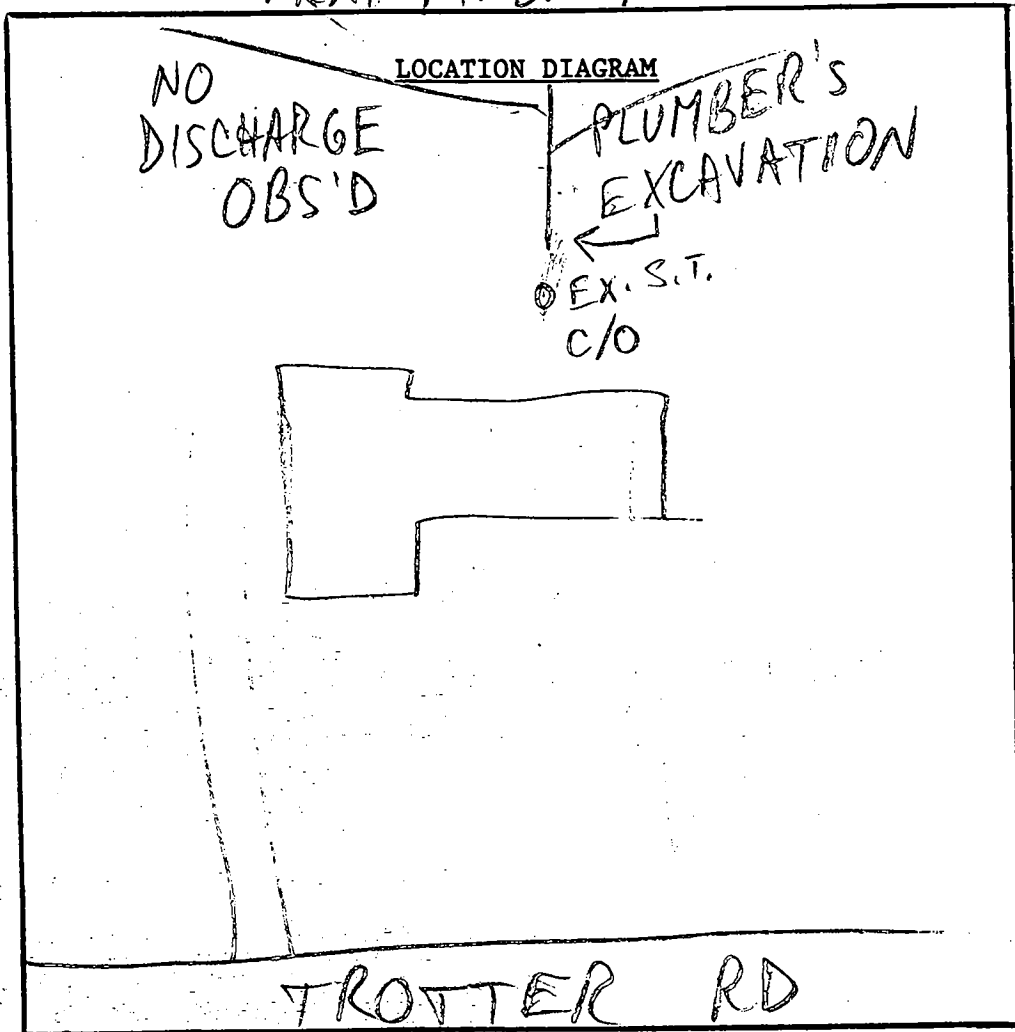

COMMENTS: \_\_\_\_\_

\_\_\_\_\_

\_\_\_\_\_

DATE: \_\_\_\_\_

INSPECTOR: \_\_\_\_\_

\*\*\*\*\*  
 WATER WELL ABANDONMENT-SEALING REPORT FORM  
 \*\*\*\*\*

SUBMIT COPIES OF COMPLETED FORM TO:

- \* COUNTY ENVIRONMENT AGENCY (contact MDE, WMA if address needed)
- \* WELL OWNER
- \* MDE, WATER MANAGEMENT ADMINISTRATION, WELL PROGRAM

DATE WELL ABANDONED: 10/3/96 (month/day/year)

--	--	--	--	--	--	--	--

\* PERMIT NUMBER OF ABANDONED WELL (if any)

--	--	--	--	--	--	--	--

\* PERMIT NUMBER OF REPLACEMENT WELL

\* PERSON ABANDONING WELL: RLO Contractors

WELL DRILLERS LICENSE NUMBER: \_\_\_\_\_  
 CIRCLE: MWD/MSD/MGD

\* OWNER'S NAME: Stup

\* WELL LOCATION: 6045 Trotter Rd

COUNTY: Howard  
 NEAREST TOWN: Clarksville  
 TAX MAP 35 BLOCK 8 PARCEL 27  
 SUBDIVISION: \_\_\_\_\_  
 SECTION: \_\_\_\_\_ LOT: \_\_\_\_\_

⊗	
000	000

SHOW WELL LOCATION BY X WITHIN BOX

MARYLAND GRID COORDINATES

BOX NUMBER E 823  
 N 499

\* TYPE OF WELL BEING ABANDONED:

- DRILLED
- BORED/AUGURED
- OTHER (specify) \_\_\_\_\_
- JETTED
- HAND DUG

\* USE CODE:

- DOMESTIC
- IRRIGATION
- TEST/OBSERVATION
- MUNICIPAL/PUBLIC
- INDUSTRIAL

\* TYPE OF CASING:

- STEEL
- CONCRETE
- PLASTIC
- OTHER (specify) \_\_\_\_\_

\* SIZE OF CASING: 6 INCHES IN DIAMETER

\* DEPTH OF WELL: 48 FEET DEEP

\* WAS ANY CASING REMOVED?  YES  NO  
 if yes, length removed, in feet: \_\_\_\_\_

\* WAS CASING RIPPED OR PERFORATED?  YES  NO

SIGNATURE Mark E. Killeen  
 MASTER WELL DRILLER OR SUPERVISING SANITARIAN

LICENSE # \_\_\_\_\_

MWD/MSD/MGD CIRCLE ONE

10/3/96  
 DATE

LOG OF SEALING MATERIAL

MATERIAL	FEET	
	FROM	TO
<u>3000 psi Cement mix</u>	<u>48</u>	<u>0</u>