

4/21/89 ASAP
10:00
4-27-89 ASAP

OS-400090

PERMIT

SEWAGE DISPOSAL SYSTEM

MARYLAND STATE DEPARTMENT OF HEALTH

P. 44108
A. 26634
DISTRICT 5th

HOWARD COUNTY
BUREAU OF ENVIRONMENTAL HEALTH
461-9933

Pride Plumbing
Taneytown?

896-0005 office
Heritage Construction
978-5144 John (site)

DATE 4/19/89
DATE SYSTEM APPROVED 4-27-89
INSPECTOR JEN

INDEXED

R. I. Myers & Sons

IS PERMITTED TO INSTALL ALTER

ADDRESS P. O. Box 29 New Windsor, Maryland 21776 PHONE 635-2133

SUBDIVISION Dayton Meadows ROAD 13826 Dayton Meadows Ct LOT 10, Sec. 1, Area 1

PROPERTY OWNER Mathew Penniman

ADDRESS _____

IF GARBAGE GRINDER IS USED INCREASE SEPTIC TANK CAPACITY BY 50% AND ABSORPTION AREA BY 22%

GARBAGE GRINDER? YES _____ NO X

3 180 ft
4
720

SEPTIC TANK CAPACITY 1250 GALLONS NUMBER OF BEDROOMS 4

TRENCHES - 180 sq. ft. per bedroom. Trench to be 2 feet wide. Inlet 4 feet below original grade. Bottom maximum depth 8 feet below original grade. Effective area begins at 4 feet below original grade. 4 Feet of stone below distribution pipe.

LOCATION - Place the distribution box on the 488' contour interval, approximately 75 feet from the left (170') lot line and 125 feet from the left-rear (275') lot line. Run trenches along contour toward left side of lot.

NOTE - No trench to exceed 100 feet in length. provide 6" - 8" diameter cleanout and cap to grade or above on septic tank. OK/CW

***** SITE INSPECTION REQUIRED BEFORE BEGINNING INSTALLATION:

PLANS APPROVED BY C. Williams DATE 12/14/88

COVER NO WORK UNTIL INSPECTED AND APPROVED

NEITHER THE HOWARD COUNTY COUNCIL NOR THE HEALTH DEPARTMENT IS RESPONSIBLE FOR THE SUCCESSFUL OPERATION OF ANY SYSTEM

NOTE: CLEANOUT REQUIRED EVERY 70 FEET OF SEWER LINE AND/OR AT 90° SWEEPS IN LINES FROM HOUSE TO DRAIN FIELDS

NOTE: ALL PARTS OF SEPTIC SYSTEMS (I.E. TANK, DISTRIBUTION BOX, TRENCHES) TO BE 100 FEET FROM WELL (UNLESS OTHERWISE SPECIFICALLY AUTHORIZED)

NOTE: IF DEEP TRENCHES ARE USED CALL FOR INSPECTION BEFORE AND AFTER PLACING GRAVEL IN TRENCHES)

NOTE: NO DRY WELL SHALL EXCEED 15 FOOT IN DIAMETER NO ABSORPTION TRENCH TO EXCEED 100 FEET IN LENGTH.

NOTE: ALL PIPE FROM HOUSE TO SEPTIC TANK MUST BE CAST IRON OR SCHEDULE 40 PVC OR ABS

PERMIT VOID AFTER TWO YEARS

NOTE: INSTALL STAND PIPE ON SEPTIC TANK AND DRY WELL. STAND PIPES MUST BE 6 INCHES IN DIAMETER. CAST IRON, CONCRETE OR TERRA COTTA OR PVC OR ABS ACCEPTED. IF TOP OF SEPTIC TANK IS DEEPER THAN 3 FEET, MANHOLE TO GRADE REQUIRED

NOTE: DISTRIBUTION BOXES MUST HAVE BAFFLES

Addition Swimming Pool
BLDG. PERMIT SIGNED
AND RETURNED 3-13-96
Serial # 63822

BLDG. PERMIT SIGNED
AND RETURNED 11-21-99
Serial # 128974

*INSTALLER IS RESPONSIBLE FOR OBTAINING FINAL APPROVAL ON THIS PERMIT

*CALL 461-9933 FOR INSPECTION OF SEPTIC SYSTEMS.

26634
44108

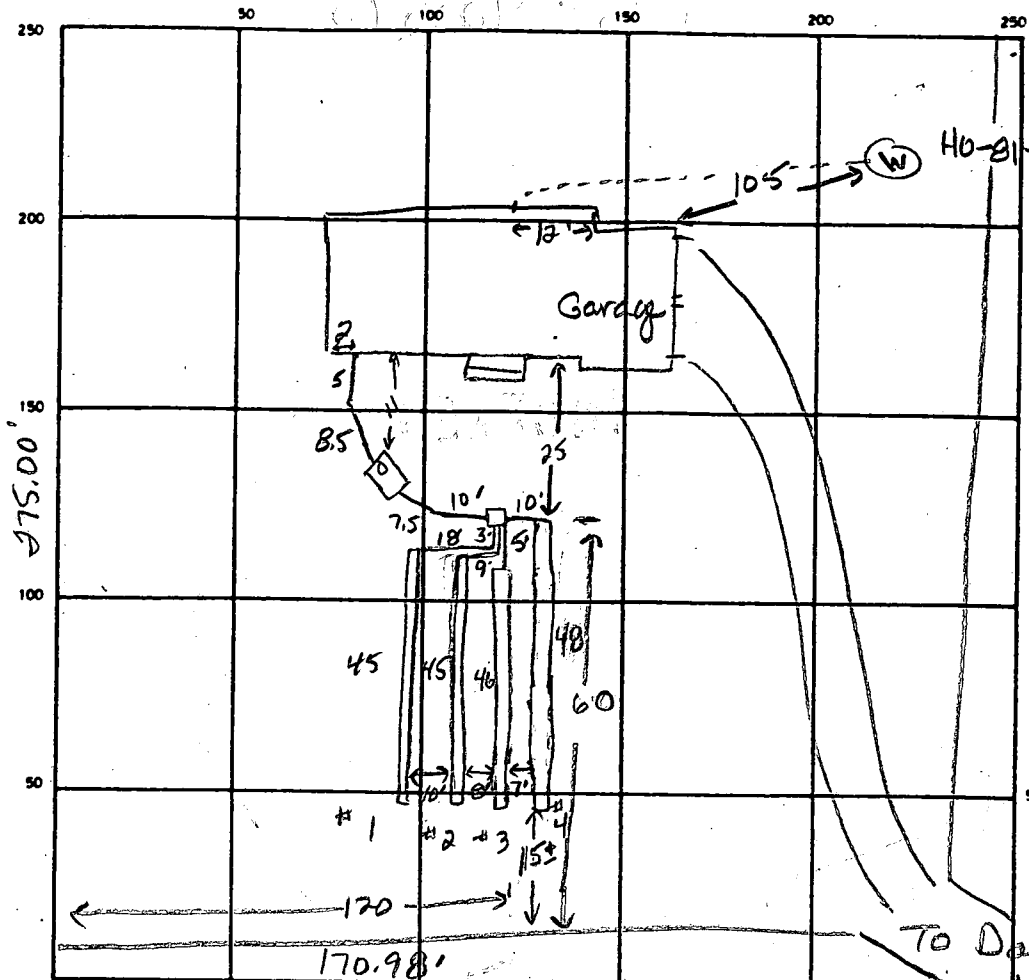

INDICATE NORTH - NAME ADJOINING ROADWAY AS BASE LINE

SEPTIC TANK LEVEL 1250 gal CLEANOUTS 1 on septic tank

DISTRIBUTION BOX LEVEL OK (with baffle)

DRAIN FIELD TILE FIELD DEPTH 3.5 4.5 4.5 6.0 FT. TRENCH WIDTH 2 FT. INLET DEPTH 3.5 4.5 4.5 6.0 FT.

EFFECTIVE GRAVEL DEPTH 4.5 5.0 4.0 4.0 FT. TOTAL LENGTH 45 45 46 48 FT.

NUMBER OF TRENCHES 4 ONE SIDEWALL/BOTTOM AREA 202.5 225 184 192 SQ. FT.

DRYWELL INSIDE DIAMETER _____ FT. EFFECTIVE DEPTH BELOW INLET _____ FT.

ABSORBENT AREA 803.5 SQ. FT.

REMARKS 4-21-89 OK to stone trenches 1-3, leave trench #4 open at ends. Cement around tank and box. JEN

4-21-89 OK to cover trenches #1 & 2, Stone #3 leaving inlet open at ends of trenches #3 & 4. JEN

4-24-89 OK to stone trench #4. JEN

4-26-89 Must raise inlet to 4.0 ft in trench #4. OK to cover septic tank. JEN

4-27-89 Trench #4 inlet at 6.0 ft and level. OK to cover all work. JEN

DATE SYSTEM APPROVED 4-27-89 INSPECTOR Jane E Madegan

3
48
4
192
184
202.5
225
803.5

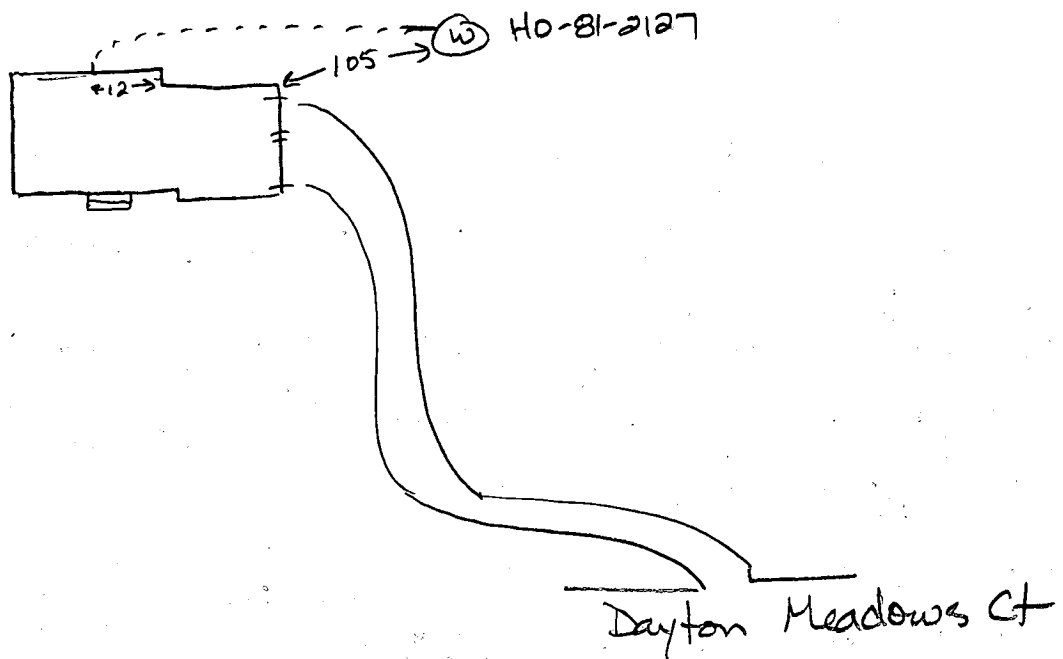

4-21-89

Pitless adaptor at 41 inches. Ground line and electric line attached. Trench covered as well as house connection. Pump tank w/ relief valve installed. JENadeau