

COUNTY #

SOIL PROFILE
470

Red Br Loam 3' 3.5'

Red Br Si Loam and Beige Sa Loam ~15% Rock 5.5'

Very Fine Tan Sa Loam 15-25% Saprolite

Caving Water 11'

408

Dark Brown Top Soil 6"

Brown Loam 1'

Light Brown Si Loam 4'

Tan Brown Loamy Sand < 5% Chert fragments 12'

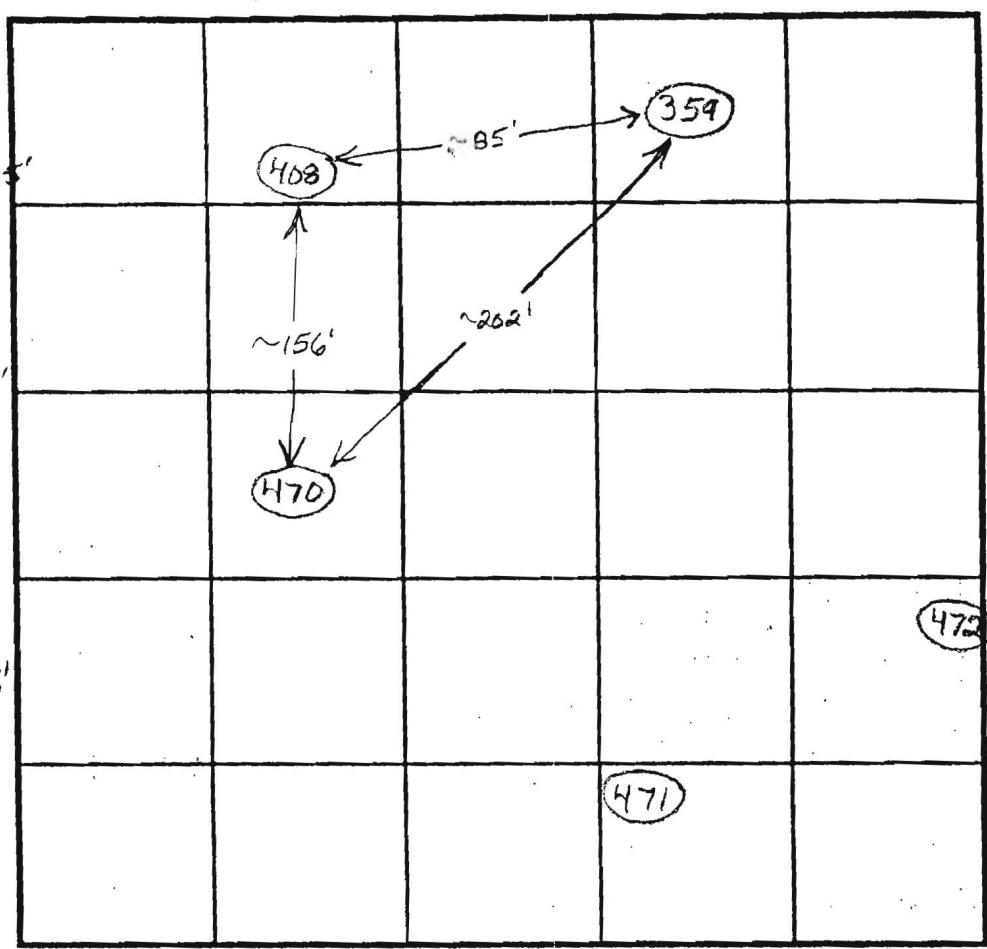

SOIL PROFILE

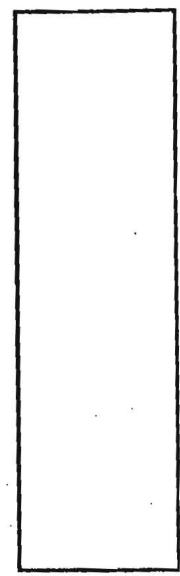

INDICATE NORTH - NAME ADJOINING ROADWAY AS BASE LINE.

DATE	TEST NO.	DEPTH	PRE-WET		TEST - 1" DROP		TIME
			START	STOP	START	STOP	
4/28/03	470	4' / 13V	12:57	1:03:30	1:03:30	1:18	14 1/2
		7'	12:57	1:01:30	1:01:30	1:08:30	7
4/29/03	408	3.0'	1:36	1:38	1:38	1:41	3min

O.K.

O.K.

REMARKS _____

TYPE OF SOIL _____

TESTED BY F. Alfonso/B. Baker ALSO PRESENT _____

TRENCH DESIGN DATA: AVERAGE PERCOLATION TIME _____ TRENCH WIDTH _____

INLET DEPTH _____ MAXIMUM BOTTOM DEPTH _____ SQ. FT./BEDROOM _____

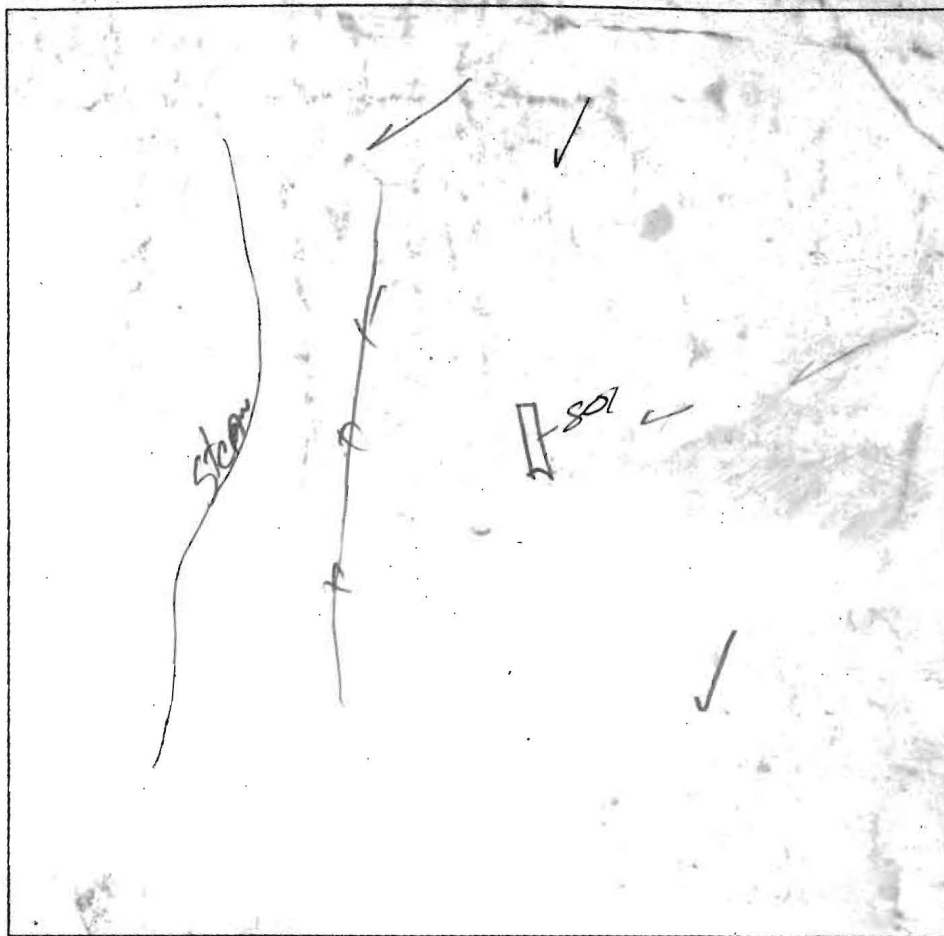

801

Barrow L 1'

Red/Barrow
mic
Sial 3'

Yellow/Barrow
Sill 9'

Barrow/Yellow
mic on sil
w/ fine sand
- water 12 1/2'

water 14 1/2'

DATE	TEST #	DEPTH	START	BREAK 1" DROP	STOP 2" DROP	TIME OF 2nd INCH	P/F/H
8/30/01	801	4' 14 1/2	1:25	1:30	1:50	20 min	P

REMARKS hole dug per plan

SANITARIAN KJB PJ BACKHOE Donnie OTHERS _____

TEST HOLES USED IN SDA _____ AVG. PERC TIME _____ SQ. FT/BR _____

TRENCH WIDTH _____ INLET DEPTH _____ MAX. BOT DEPTH _____ EFFECTIVE SW _____

COUNTY#

SOIL PROFILE

(534)
 Red Br Heavy Loam 3.5'
 Red Br Si Loam and Si Cl Loam Trace Rock 6.5'
 Red Br Sa Loam ~25% Saprolite 8'
 Caving Water 10'

(536)
 Red Br Heavy Loam 2'
 Red Br Si Cl 4'
 Red Br Si Cl Loam and Sa Cl Loam Trace Rock 5'
 Red Br Sa Loam ~15% Saprolite 13'
 Water

(535)
 Red Br Heavy Loam 3.5'
 Red Br Si Cl Loam Trace Rock 6'
 Red Br Si Loam Trace Rock 6.5'
 Red Br Si Loam and Sa Loam Getting Sandier With Depth ~20% Saprolite 13'
 Water

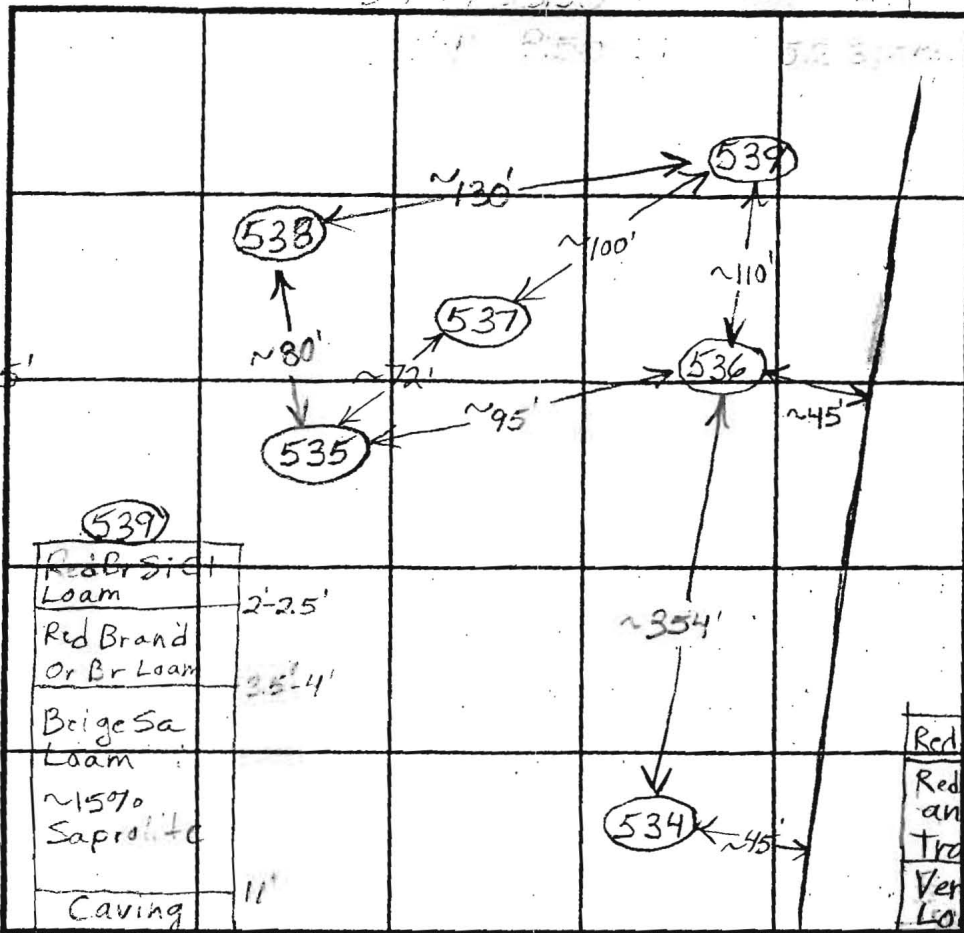

SOIL PROFILE

(537)
 Red Br Heavy Loam and Si Cl Loam ~10% Rock 5'
 Red Br Si Loam Trace Rock 6.5'
 Beige Sa Loam ~25% Saprolite 12'
 Caving Water 13'

(538)
 Red Br Heavy Loam 4'
 Red Br Si Cl Loam and Dense Sa Loam Trace Rock 3.55'
 Very Fine Br Sa Loam, 15% Saprolite 10.5'
 Caving Water 11.5'

Water INDICATE NORTH - NAME ADJOINING ROADWAY AS BASE LINE.

DATE	TEST NO.	DEPTH	PRE-WET		TEST - 1" DROP		TIME	
			START	STOP	START	STOP		
1/9/04	534	5.5'/10"V	1:54	~3/4" in 20 minutes				Slow (F)
		7.5'	1:53:30	1:56:30	1:56:30	2:00:30	4	
	536	5' /13"V	2:21:30	2:24:15	2:24:15	2:29:15	5	O.K.
		7.5'	2:22:15	2:24:15	2:24:15	2:27:15	3	
	535	6'8" /13"V	2:41	>25 minutes for 1st inch				Slow O.K.
		7'8"	2:41:30	2:46:15	2:46:15	2:53:45	7 1/2	
	537	5.5' /13"V	3:03	3:13:30	3:13:30	3:32	18 1/2	O.K.
		7.5'	3:03:15	3:06	3:06	3:16:45	5	
	539	4.5' /12"V	3:24	3:27:15	3:27:15	3:34:15	7	O.K.
		7.5'	3:24	3:25:45	3:25:45	3:28:15	2 1/2	
	528	5' /12"V	3:50	4:00	4:00	4:19	19	
		7'4"	3:50	3:52	3:52	3:55:30	3 1/2	

REMARKS _____
 TYPE OF SOIL _____
 TESTED BY B. Baker ALSO PRESENT _____
 TRENCH DESIGN DATA: AVERAGE PERCOLATION TIME _____ TRENCH WIDTH _____
 INLET DEPTH _____ MAXIMUM BOTTOM DEPTH _____ SQ. FT./BEDROOM _____

SEE SHEET 1

8750

ChB2

Bc

Approved revised
Percent plan
12-28-07

MgC3

LOT 9
46,414 S.F.

LOT 8
45,407 S.F.

LOT 10
46,129 S.F.

GRID NORTH

CL STREAM

MgC3

GROVEWOOD COURT

LOT 14
51,111 S.F.

EKB2

12
S.F.

N/E
JEAN N. WERFIELD
262378 1/2
P. 43
ZONED: RR/EC

AGRICULTURAL EASEMENT
HO-91-14-E

LOT 13
48,763 S.F.

EKA

APRES
HOWARD
HOMEOWNERS

Le
Recon
Injwre
Site
HO-95

MgC3

EKB2

EnB2

BLACK GULL
COND.