

12/17/79

around lunch
Time please

PERMIT

SEWAGE DISPOSAL SYSTEM

MARYLAND STATE DEPARTMENT OF HEALTH

HOWARD COUNTY

ELLICOTT CITY

DISTRICT 5th

DATE 12/10/79

INDEXED

12/17/79 Filed
P 30424

A Repair

Jack Fyock

IS PERMITTED TO INSTALL ALTER X

ADDRESS 13775 Triadelphia Road, Glenelg, Md. 21737 PHONE 988-9270

SUBDIVISION _____ ROAD 14339 Triadelphia Mill Rd LOT _____

PROPERTY OWNER Robert Conolly Conolly Wayton, Md.

ADDRESS 14339 Triadelphia Mill Road

SPECIFICATIONS

SEPTIC TANK CAPACITY _____ GALLONS

DRAIN FIELD _____ DEPTH _____ FEET, BOTTOM AREA _____ SQ. FT.

DEEP TRENCH 55' DEPTH 12 FEET, BOTTOM AREA _____ SQ. FT.

SEEPAGE PITS _____ ABSORBENT SIDE-WALL AREA _____ SQ. FT.

INLET PIPE 3 FT. BELOW ORIGINAL GRADE, MAXIMUM DEPTH 12 FT. BELOW ORIGINAL GRADE

EFFECTIVE DEPTH AT _____ FT. BELOW ORIGINAL GRADE.

☒ LOCATE DISPOSAL AREA _____ FT. FROM _____ LOT LINE AND _____ FT. FROM _____ LOT LINE AS SEEN WHEN
FACING LOT FROM

REPAIR - Call for an appointment when ground is opened up and Sanitarian will
recommend the repair system.

☒ TRENCH 55' LONG 12' DEEP
COMING OFF OLD DRY WELL. 7' + STONE UNDER PIPE.
C.B.S.

PLANS APPROVED BY Palmer F. Wine DATE 12/10/79

COVER NO WORK UNTIL INSPECTED AND APPROVED.

NEITHER THE HOWARD COUNTY COUNCIL NOR THE HEALTH DEPARTMENT IS RESPONSIBLE FOR THE SUCCESSFUL OPERATION OF ANY SYSTEM.

NOTE: IF TRENCH IS USED CALL FOR INSPECTION BEFORE PLACING GRAVEL IN TRENCH.

NOTE: NO DRY WELL SHALL EXCEED 15 FOOT IN DIAMETER.

NOTE: ALL PIPE FROM HOUSE TO DISPOSAL AREA MUST BE CAST IRON.

PERMIT VOID AFTER THREE YEARS.

NOTE: INSTALL STAND PIPE ON SEPTIC TANK AND DRY WELL. STAND PIPES MUST BE 6 INCHES IN DIAMETER. CAST IRON, CONCRETE OR TERRA
COTTA ACCEPTED.

***INSTALLER IS RESPONSIBLE FOR OBTAINING FINAL APPROVAL ON THIS PERMIT.**

P30424

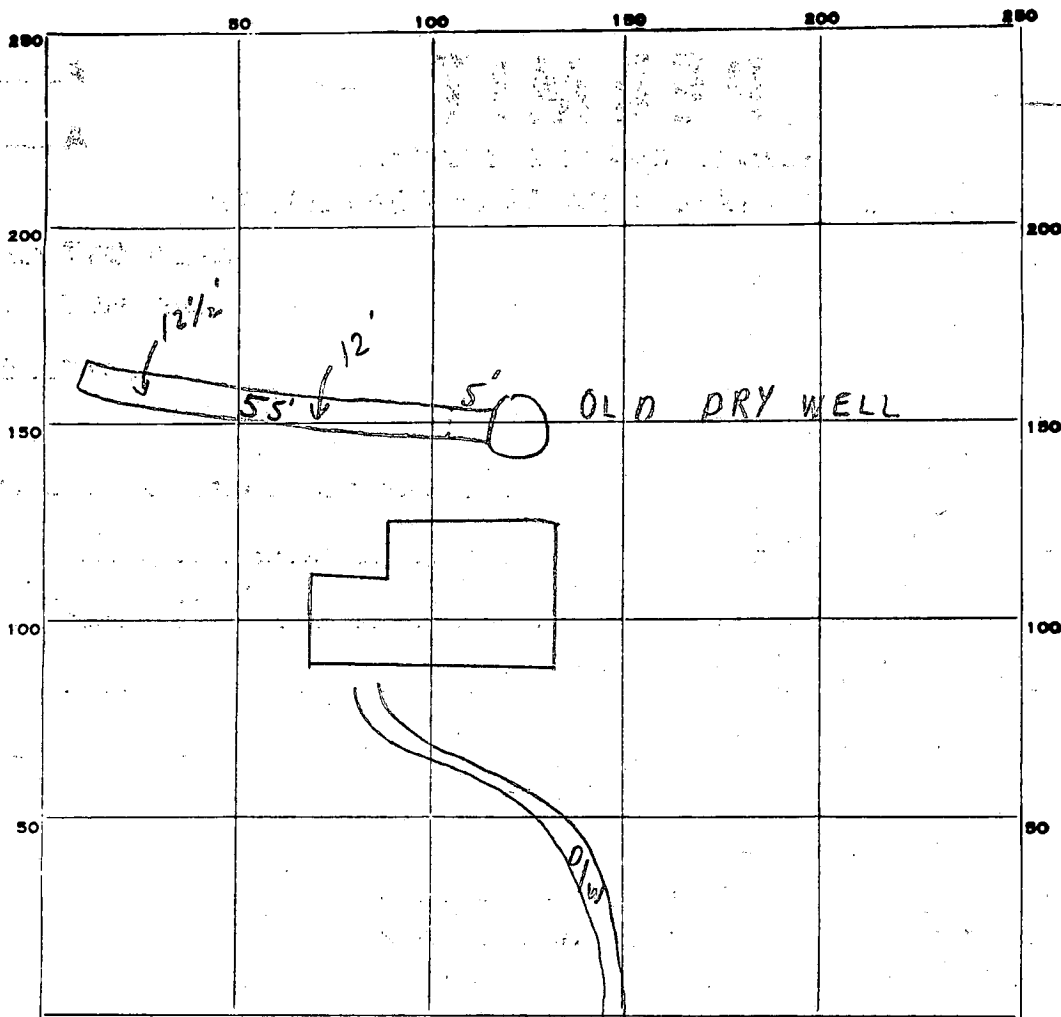

INDICATE NORTH. - NAME ADJOINING ROADWAY AS BASE LINE.

TRIADELPHIA MILL ROAD

PERMIT CARD ☒

SEPTIC TANK, LEVEL _____

CLEANOUTS _____

DISTRIBUTION BOX, LEVEL _____

TILE FIELD, DEPTH 12 FT. TRENCH WIDTH 2 FT.

GRAVEL DEPTH 10'-3" 8' avg. TOTAL LENGTH 55 FT.

NUMBER OF TRENCHES 1 TOTAL BOTTOM AREA _____

SEEPAGE PITS, INSIDE DIAMETER _____ FT. DEPTH BELOW INLET _____ FT.

ABSORBENT AREA 440+ SQ. FT.

REMARKS 12/17/79 Trench ok for stone; TRENCH COMPLETED
To 55' C.B.S.

DATE SYSTEM APPROVED

12/17/79

INSPECTOR

C. B. Stenken