

Permit # 42003 - have signed after repair.

2/15/80 FILE
APPROVED.
C.B.C.

2/15/80
a.m. please

PERMIT

SEWAGE DISPOSAL SYSTEM

MARYLAND STATE DEPARTMENT OF HEALTH*

HOWARD COUNTY

05-346274

ELLICOTT CITY

DISTRICT _____

DATE 2/6/80

INDEXED

James Gue

IS PERMITTED TO INSTALL _____ ALTER X

ADDRESS _____ PHONE _____

SUBDIVISION _____ ROAD 13801 Triadelphia Road LOT _____

PROPERTY OWNER Clark

ADDRESS 13801 Triadelphia Road, 1/2 mile past intersection at Glenelg on left hand side.

SPECIFICATIONS

SEPTIC TANK CAPACITY _____ GALLONS

DRAIN FIELD _____ DEPTH _____ FEET. BOTTOM AREA _____ SQ. FT.

DEEP TRENCH _____ DEPTH _____ FEET. BOTTOM AREA _____ SQ. FT.

SEEPAGE PITS _____ ABSORBENT SIDE-WALL AREA _____ SQ. FT.

INLET PIPE _____ FT. BELOW ORIGINAL GRADE. MAXIMUM DEPTH _____ FT. BELOW ORIGINAL GRADE

EFFECTIVE DEPTH AT _____ FT. BELOW ORIGINAL GRADE.

LOCATE DISPOSAL AREA _____ FT. FROM _____ LOT LINE AND _____ FT. FROM _____ LOT LINE AS SEEN WHEN
FACING LOT FROM

REPAIR- Trench to be 18 inches wide, 10 ft. deep, 75 feet long with 5 ft. of stone
under pipe. Trench to run on contour. Two inspections needed; before and after
gravel is installed.

PLANS APPROVED BY D.W. Monaghan DATE 2/6/80

COVER NO WORK UNTIL INSPECTED AND APPROVED.

NEITHER THE HOWARD COUNTY COUNCIL NOR THE HEALTH DEPARTMENT IS RESPONSIBLE FOR THE SUCCESSFUL OPERATION OF ANY SYSTEM.

NOTE: IF TRENCH IS USED CALL FOR INSPECTION BEFORE PLACING GRAVEL IN TRENCH.

NOTE: NO DRY WELL SHALL EXCEED 15 FOOT IN DIAMETER.

NOTE: ALL PIPE FROM HOUSE TO DISPOSAL AREA MUST BE CAST IRON.

PERMIT VOID AFTER THREE YEARS.

NOTE: INSTALL STAND PIPE ON SEPTIC TANK AND DRY WELL. STAND PIPES MUST BE 6 INCHES IN DIAMETER. CAST IRON, CONCRETE OR TERRA
COTTA ACCEPTED.

BLDG. PERMIT SIGNED
AND RETURNED 2/21/80

Serial No. 42003

*INSTALLER IS RESPONSIBLE FOR OBTAINING FINAL APPROVAL ON THIS PERMIT.

130520

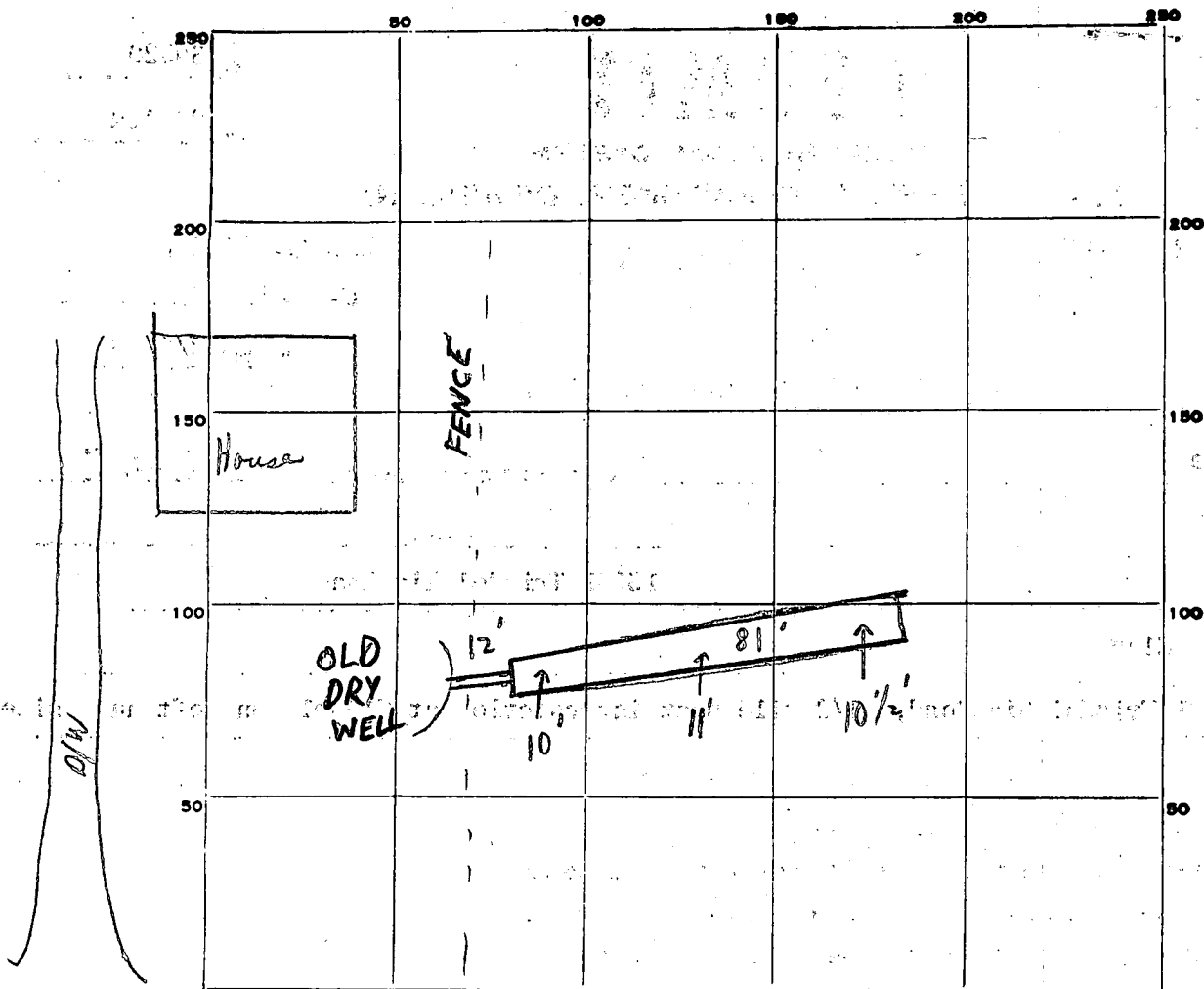

INDICATE NORTH. - NAME ADJOINING ROADWAY AS BASE LINE.

TRIADELPHIA ROAD

PERMIT CARD ☒

SEPTIC TANK, LEVEL _____

CLEANOUTS _____

DISTRIBUTION BOX, LEVEL _____

TILE FIELD, DEPTH 10 1/2 avg FT. TRENCH WIDTH 2 ⁺ FT.

GRAVEL DEPTH 5 IN. TOTAL LENGTH 81 FT.

NUMBER OF TRENCHES 1 TOTAL BOTTOM AREA _____

SEEPAGE PITS, INSIDE DIAMETER _____ FT. DEPTH BELOW INLET _____ FT.

ABSORBENT AREA 405 ⁺ SQ. FT.

REMARKS 2/15/80 CHECKED - TRENCH OPEN - OK FOR STONE NOTE
COMING OFF OLD DRY WELL. OK TO COVER FIRST 60'
SYSTEM COMPLETE. C.B.S.
C.B.S.

DATE SYSTEM APPROVED

2/15/80

INSPECTOR

C. B. Stucker