

5/8/80 Files approved.
C.B.J.

PERMIT

P 30667

A Repair

SEWAGE DISPOSAL SYSTEM

MARYLAND STATE DEPARTMENT OF HEALTH

HOWARD COUNTY

ELLICOTT CITY

DISTRICT 5th

DATE 5/7/80

INDEXED

*5/8/80
See note attached.*

Jack Fyock

IS PERMITTED TO INSTALL ALTER **X**

ADDRESS 13775 Triadelphia Road, Glenelg, Md. 21737 PHONE 988-9270

SUBDIVISION Green Hill Manor ROAD 13951 Villa d'est Drive LOT _____

PROPERTY OWNER Mr. Eugene C. Parker

ADDRESS 13951 Villa d'est Drive, Highland, Md. 20777 Phone: 286-2109

SPECIFICATIONS

SEPTIC TANK CAPACITY _____ GALLONS

DRAIN FIELD _____ DEPTH _____ FEET, BOTTOM AREA _____ SQ. FT.

DEEP TRENCH _____ DEPTH _____ FEET, BOTTOM AREA _____ SQ. FT.

SEEPAGE PITS _____ ABSORBENT SIDE-WALL AREA _____ SQ. FT.

INLET PIPE _____ FT. BELOW ORIGINAL GRADE. MAXIMUM DEPTH _____ FT. BELOW ORIGINAL GRADE

EFFECTIVE DEPTH AT _____ FT. BELOW ORIGINAL GRADE.

LOCATE DISPOSAL AREA _____ FT. FROM _____ LOT LINE AND _____ FT. FROM _____ LOT LINE AS SEEN WHEN FACING LOT FROM

REPAIR - Call for an appointment when ground is opened up and Sanitarian will recommend the repair system.

*(5/8/80 Trench completed see back)
C.B.J.*

PLANS APPROVED BY Palmer F. Wine DATE 5/7/80

COVER NO WORK UNTIL INSPECTED AND APPROVED.

NEITHER THE HOWARD COUNTY COUNCIL NOR THE HEALTH DEPARTMENT IS RESPONSIBLE FOR THE SUCCESSFUL OPERATION OF ANY SYSTEM.

NOTE: IF TRENCH IS USED CALL FOR INSPECTION BEFORE PLACING GRAVEL IN TRENCH.

NOTE: NO DRY WELL SHALL EXCEED 15 FOOT IN DIAMETER.

NOTE: ALL PIPE FROM HOUSE TO DISPOSAL AREA MUST BE CAST IRON.

PERMIT VOID AFTER THREE YEARS.

NOTE: INSTALL STAND PIPE ON SEPTIC TANK AND DRY WELL. STAND PIPES MUST BE 6 INCHES IN DIAMETER. CAST IRON, CONCRETE OR TERRA COTTA ACCEPTED.

***INSTALLER IS RESPONSIBLE FOR OBTAINING FINAL APPROVAL ON THIS PERMIT.**

P-30667

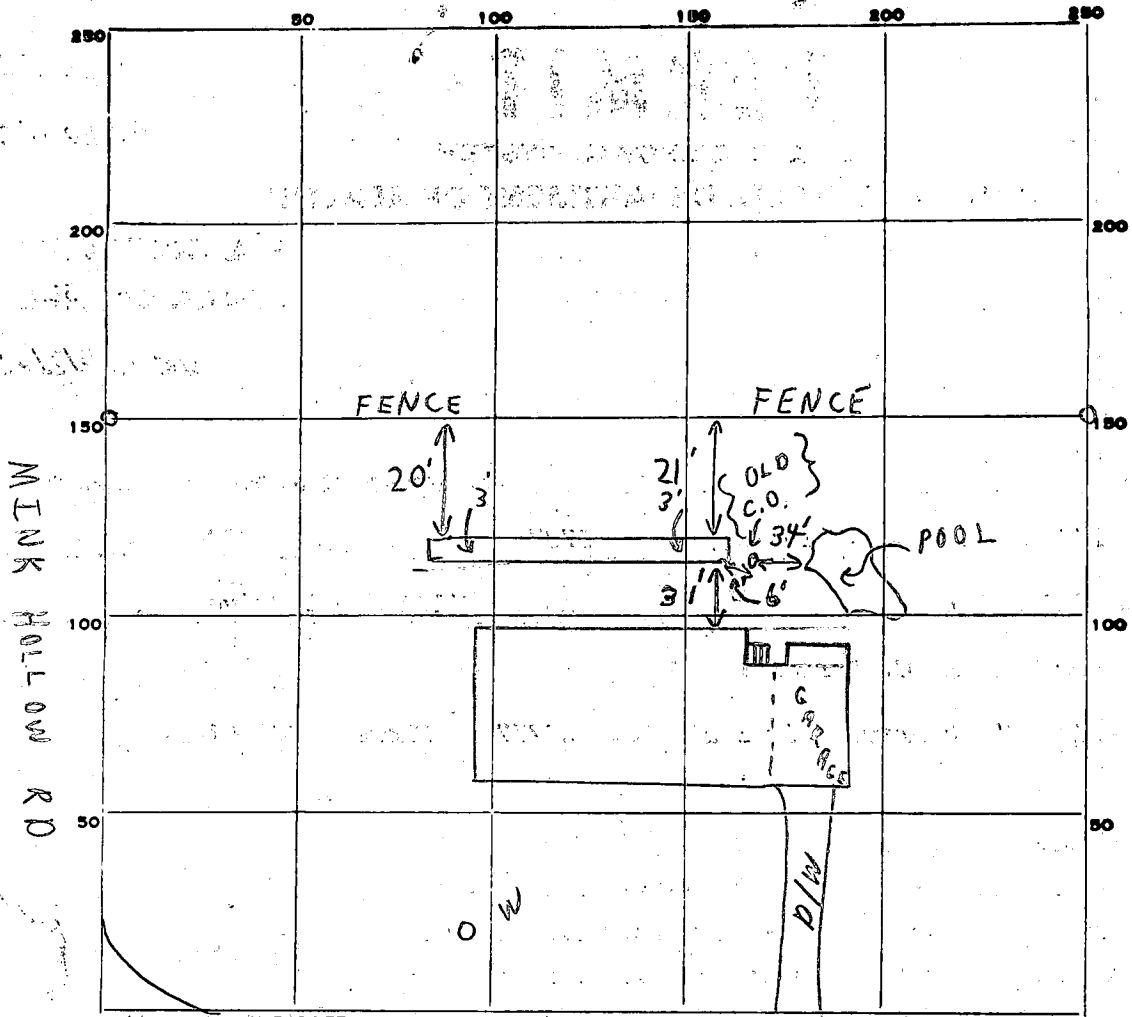

INDICATE NORTH. - NAME ADJOINING ROADWAY AS BASE LINE.

VILLA d'est Drive

PERMIT CARD

SEPTIC TANK, LEVEL

CLEANOUTS

DISTRIBUTION BOX, LEVEL

TILE FIELD, DEPTH 11 FT. TRENCH WIDTH 2 FT.
per note of owner

GRAVEL DEPTH 8 IN. TOTAL LENGTH 77 FT.

NUMBER OF TRENCHES 1 TOTAL BOTTOM AREA _____

SEEPAGE PITS, INSIDE DIAMETER _____ FT. DEPTH BELOW INLET _____ FT.

ABSORBENT AREA 6/6 SQ. FT.

REMARKS 5/8/80 CHECKED FOUND TRENCH COMPLETE TO 3' OF SURFACE,
OFF OLD DRY WELL. APPROVED WITH OWNER'S NOTE ONLY CONCERNING
DEPTH OF TRENCH. C.B.D.

DATE SYSTEM APPROVED 5/8/80 INSPECTOR C. B. D. Truher