

9/18/80 FILE APPROVED C.B.

PERMIT

SEWAGE DISPOSAL SYSTEM

MARYLAND STATE DEPARTMENT OF HEALTH

HOWARD COUNTY

ELLICOTT CITY

DISTRICT 5th.

DATE 9/15/80

INDEXED

05-361966

P 30931

A REPAIR

(as soon as possible)

Jack Fyock

IS PERMITTED TO INSTALL _____ ALTER X

ADDRESS 13775 Triadelphia Road

PHONE 988-9270

SUBDIVISION Forest Hills Lot 20

ROAD 5644 Trotter Road

LOT _____

PROPERTY OWNER Arthur Novotny

ADDRESS 5744 Trotter Road, Clarksville, Md.

SPECIFICATIONS

SEPTIC TANK CAPACITY _____ GALLONS

DRAIN FIELD _____ DEPTH _____ FEET, BOTTOM AREA _____ SQ. FT.

DEEP TRENCH _____ DEPTH _____ FEET, BOTTOM AREA _____ SQ. FT.

SEEPAGE PITS _____ ABSORBENT SIDE-WALL AREA _____ SQ. FT.

INLET PIPE _____ FT. BELOW ORIGINAL GRADE. MAXIMUM DEPTH _____ FT. BELOW ORIGINAL GRADE

EFFECTIVE DEPTH AT _____ FT. BELOW ORIGINAL GRADE.

LOCATE DISPOSAL AREA _____ FT. FROM _____ LOT LINE AND _____ FT. FROM _____ LOT LINE AS SEEN WHEN FACING LOT FROM

REPAIR - CALL FOR INSPECTION WHEN GROUND IS OPENED UP SO SANITARIAN CAN RECOMMEND REPAIR.

PLANS APPROVED BY Palmer F. Wine

DATE September 15, 1980

COVER NO WORK UNTIL INSPECTED AND APPROVED.

NEITHER THE HOWARD COUNTY COUNCIL NOR THE HEALTH DEPARTMENT IS RESPONSIBLE FOR THE SUCCESSFUL OPERATION OF ANY SYSTEM.

NOTE: IF TRENCH IS USED CALL FOR INSPECTION BEFORE PLACING GRAVEL IN TRENCH.

NOTE: NO DRY WELL SHALL EXCEED 15 FOOT IN DIAMETER.

NOTE: ALL PIPE FROM HOUSE TO DISPOSAL AREA MUST BE CAST IRON.

PERMIT VOID AFTER THREE YEARS.

NOTE: INSTALL STAND PIPE ON SEPTIC TANK AND DRY WELL. STAND PIPES MUST BE 8 INCHES IN DIAMETER. CAST IRON, CONCRETE OR TERRA COTTA ACCEPTED.

***INSTALLER IS RESPONSIBLE FOR OBTAINING FINAL APPROVAL ON THIS PERMIT.**

30931

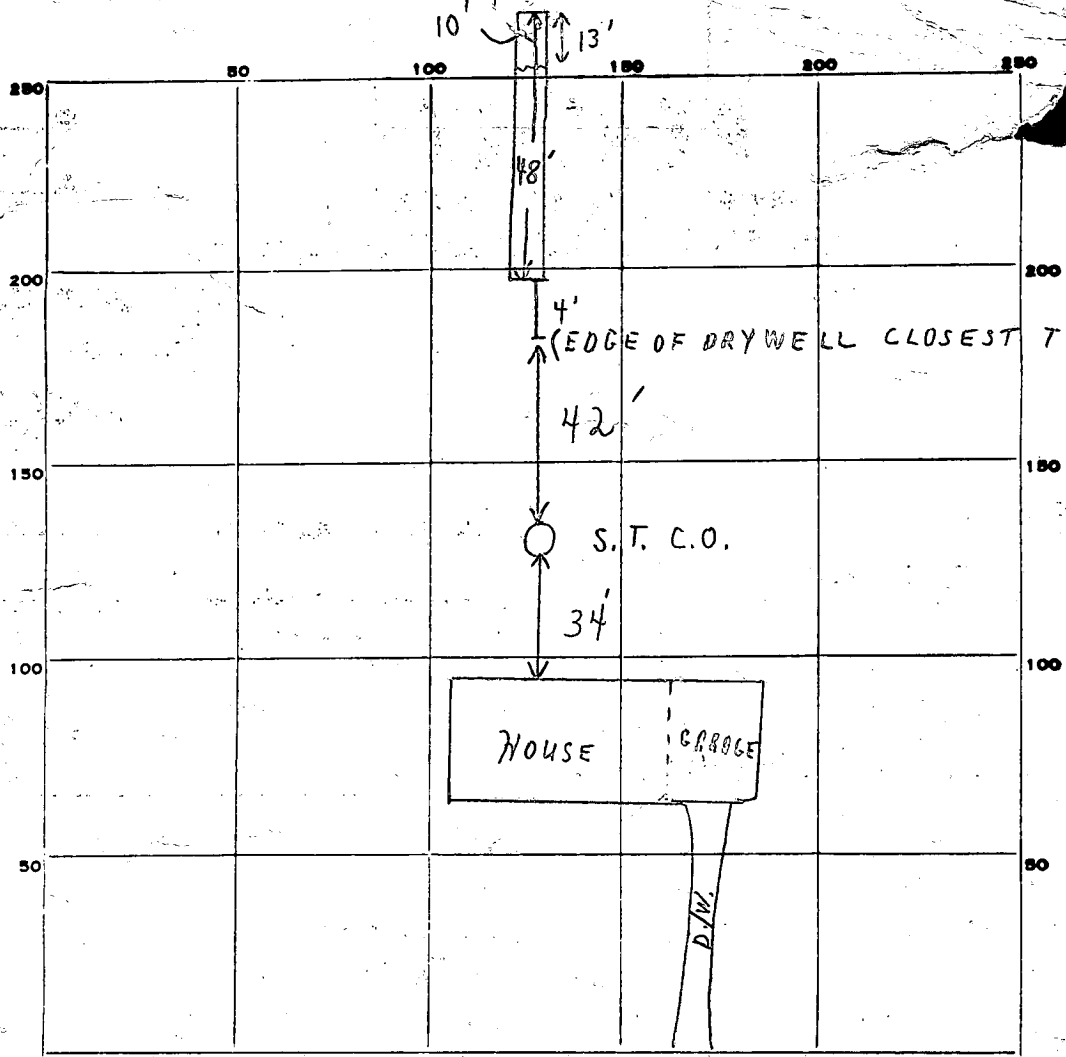

INDICATE NORTH. - NAME ADJOINING ROADWAY AS BASE LINE.

PERMIT CARD:

SEPTIC TANK, LEVEL _____ CLEANOUTS _____

DISTRIBUTION BOX, LEVEL _____

TILE FIELD, DEPTH 10 FT. TRENCH WIDTH 2 FT.

GRAVEL DEPTH 8' IN. TOTAL LENGTH 48 FT.

NUMBER OF TRENCHES 1 TOTAL BOTTOM AREA _____

SEEPAGE PITS, INSIDE DIAMETER _____ FT. DEPTH BELOW INLET _____ FT.

ABSORBENT AREA 384⁺ SQ. FT.

REMARKS 9/18/80 (C) CHECKED TRENCH - 48' LONG; STONE IN TO 13' OF
LAST PART OF TRENCH; OWNER TO CERTIFY DEPTH OF TRENCH; LENGTH
OF TRENCH; AND STONE DEPTH; (2) TRENCH COMPLETE; OWNER
CERTIFIED TRENCH DEPTH; LENGTH; AND AMOUNT OF STONE. FILE
COMPLETE. (SEE ATTACHED NOTE FROM OWNER)
C.B.S.

DATE SYSTEM APPROVED 9/18/80 as per above INSPECTOR C.B. Stecker