

7/4/79
7/13/79
afternoon please

File

PERMIT

P 29587

A Repair

SEWAGE DISPOSAL SYSTEM

MARYLAND STATE DEPARTMENT OF HEALTH*

HOWARD COUNTY

05-353025

ELLICOTT CITY

DISTRICT 5th.

INDEXED ✓

DATE 7/11/79

Olen Ketterman

IS PERMITTED TO INSTALL _____ ALTER X

ADDRESS 6119 Jerry's Drive, Columbia, Md.

PHONE 997-8740 442-1336

SUBDIVISION _____ ROAD 14230 Triadelphia Mill Road LOT _____

PROPERTY OWNER Bernard Henley / Joyce Stohlman

ADDRESS 14230 Triadelphia Mill Road, Dayton, Md.

SPECIFICATIONS

SEPTIC TANK CAPACITY _____ GALLONS

DRAIN FIELD _____ DEPTH _____ FEET, BOTTOM AREA _____ SQ. FT.

DEEP TRENCH _____ DEPTH _____ FEET, BOTTOM AREA _____ SQ. FT.

SEEPAGE PITS _____ ABSORBENT SIDE-WALL AREA _____ SQ. FT.

INLET PIPE _____ FT. BELOW ORIGINAL GRADE. MAXIMUM DEPTH _____ FT. BELOW ORIGINAL GRADE

EFFECTIVE DEPTH AT _____ FT. BELOW ORIGINAL GRADE.

LOCATE DISPOSAL AREA _____ FT. FROM _____ LOT LINE AND _____ FT. FROM _____ LOT LINE AS SEEN WHEN FACING LOT FROM

REPAIR - CALL FOR INSPECTION WHEN GROUND IS OPENED UP SO SANITARIAN CAN

RECOMMEND REPAIR. Shallow tile field - 360

Sq. ft. per P.F.W. / ha 7/11/79

Recommend 2 trenches 1150' - all sq ft

PLANS APPROVED BY Palmer F. Wine

DATE 7/11/79

COVER NO WORK UNTIL INSPECTED AND APPROVED.

NEITHER THE HOWARD COUNTY COUNCIL NOR THE HEALTH DEPARTMENT IS RESPONSIBLE FOR THE SUCCESSFUL OPERATION OF ANY SYSTEM.

NOTE: IF TRENCH IS USED CALL FOR INSPECTION BEFORE PLACING GRAVEL IN TRENCH.

NOTE: NO DRY WELL SHALL EXCEED 15 FOOT IN DIAMETER.

NOTE: ALL PIPE FROM HOUSE TO DISPOSAL AREA MUST BE CAST IRON.

PERMIT VOID AFTER THREE YEARS.

NOTE: INSTALL STAND PIPE ON SEPTIC TANK AND DRY WELL. STAND PIPES MUST BE 8 INCHES IN DIAMETER. CAST IRON, CONCRETE OR TERRA COTTA ACCEPTED.

OLD PERMIT SIGNED AND RETURNED 3-27-78

Serial # 370 110635
alteration of 2 bedrooms

*INSTALLER IS RESPONSIBLE FOR OBTAINING FINAL APPROVAL ON THIS PERMIT.

P 29587

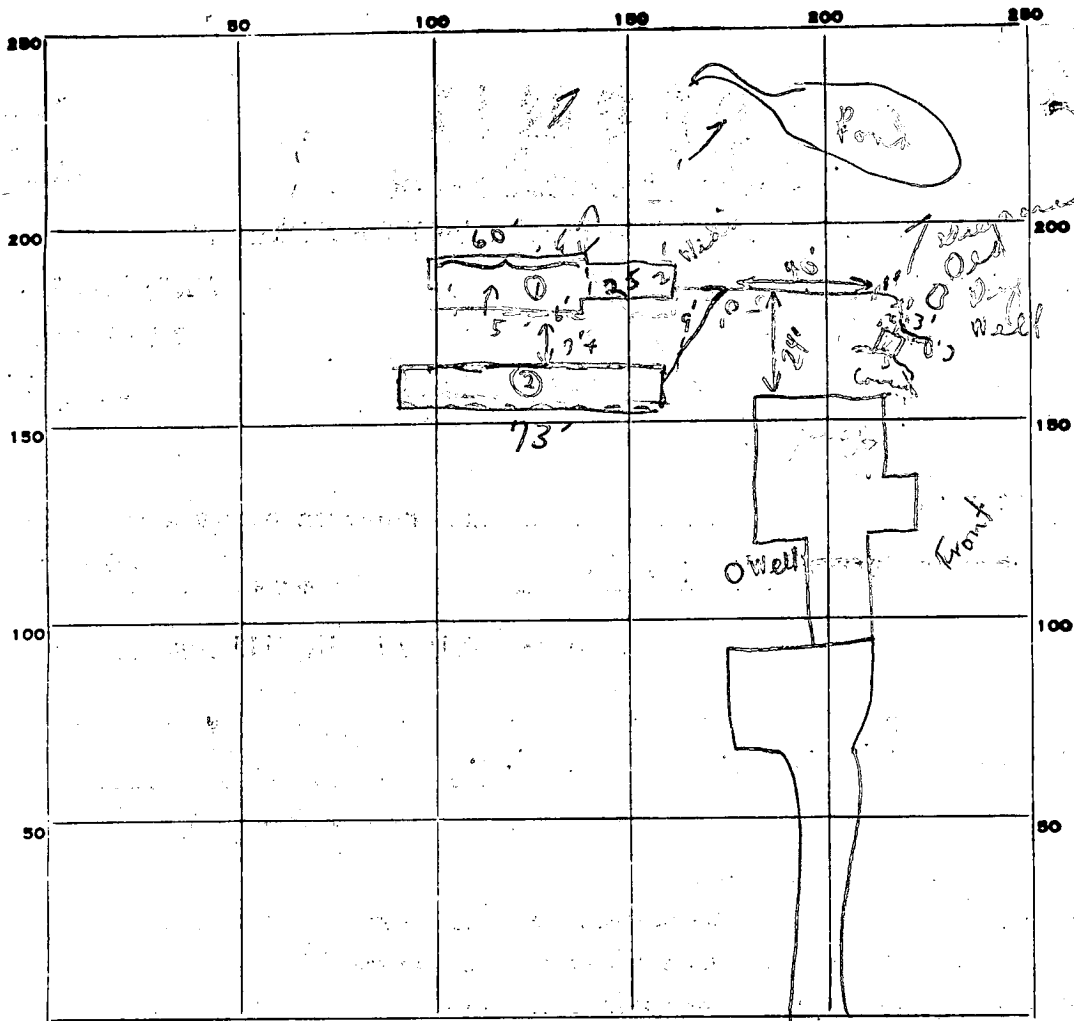

INDICATE NORTH - NAME ADJOINING ROADWAY AS BASE LINE.

PERMIT CARD (E.N. Green) Triadelphia Mill Road

SEPTIC TANK, LEVEL N/A (yes, final) CLEANOUTS (1 in. ✓ CI)

DISTRIBUTION BOX, LEVEL N/A

TILE FIELD, DEPTH 25' 10' Deep TRENCH WIDTH 3' wide FT. 180

Trench 73' 5-6' deep TRENCH WIDTH 3' wide FT. 219

GRAVEL DEPTH 1/2-2' IN. TOTAL LENGTH 15.8 FT. in (2 trenches)

NUMBER OF TRENCHES 2 TOTAL BOTTOM AREA 100 sq. ft.

SEEPAGE PITS, INSIDE DIAMETER - FT. DEPTH BELOW INLET - FT.

ABSORBENT AREA 449 SQ. FT.

REMARKS 7/12/79 A. stop found 50 CI to #1 trench.)
Partial B. stop found #1 Trench - oh p. 20 - 3' wide do stone
Partial C. stop found #1 Trench - paper on to 4' of surface - 60' 3' wide 25' 2' wide
for #2 Trench - They are to call for inspection of #2 before
+ after stones in; #2 trench to be 65' long + 3' wide 5'-6' deep.
7/13/79 only 30' seen paper on trench to 4' 5' of surface. O wells
verified project #2 Trench by signature of [Signature]
 DATE SYSTEM APPROVED 7/13/79 as per drawing INSPECTOR C.B. [Signature] D.W.M. stated at to cover from [Signature]

